

For Lease

# Warehouse/Manufacturing

±39,923 - 108,893 SF Available



ARDEN | GROUP

CBRE

60 Maple Street  
Mansfield, Massachusetts

# Building Specifications

Total Building	±227,166 SF
Available SF	±108,893 SF <b>SUITE A : ±68,970 SF (Vacant)</b> <b>SUITE B : ±39,923 SF, Warehouse: ±32,723 SF, Mezzanine: ±7,200 SF (Available 7/1/2025)</b>
Land	±15.90 acres
Clear Height	<b>SUITE A : 16'8" - 21'6"</b> <b>SUITE B : 16'8"</b>
Column Spacing	40' x 40'
Loading Docks	<b>SUITE A : Five (5) tailboard loading docks, One (1) drive-in door</b> <b>SUITE B : One (1) tailboard loading dock, One (1) drive-in door</b> Ability to add additional loading docks
Sprinklers	100% wet system
Year Built	1968 (renovated in 1999/2014/2015)
Parking	±0.88/1,000 SF (200 automobile spaces plus truck court)
Roof	Rubber EPDM
Zoning	Industrial
Lighting	LED
Power	<b>Suite A: 1,200 amps</b>
Heating	Gas-fired radiant heat and rooftop units
Utilities	Gas: Columbia Gas Electric: Mansfield Municipal Electric Department Water/Sewer: Town of Mansfield



**6**  
**Loading Docks**



**3 Miles**  
**From I-95**



**Outdoor Storage**  
**Available**

# Site Plan

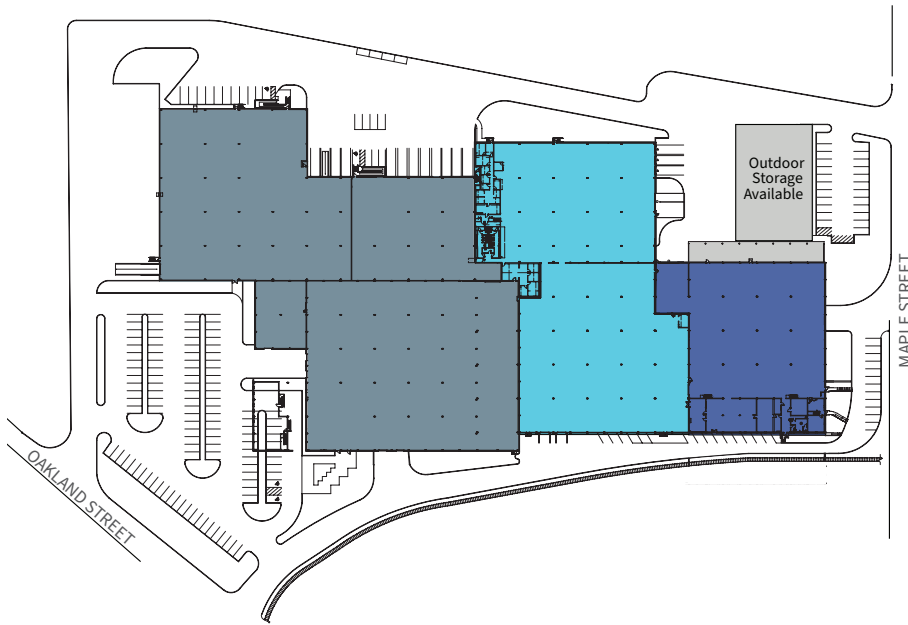

## Floor Plan

### Suite A:

±68,970 SF

### Suite B:

±39,923 SF

Warehouse: ±32,723 SF  
(Additional ±7,200 SF of Mezzanine)

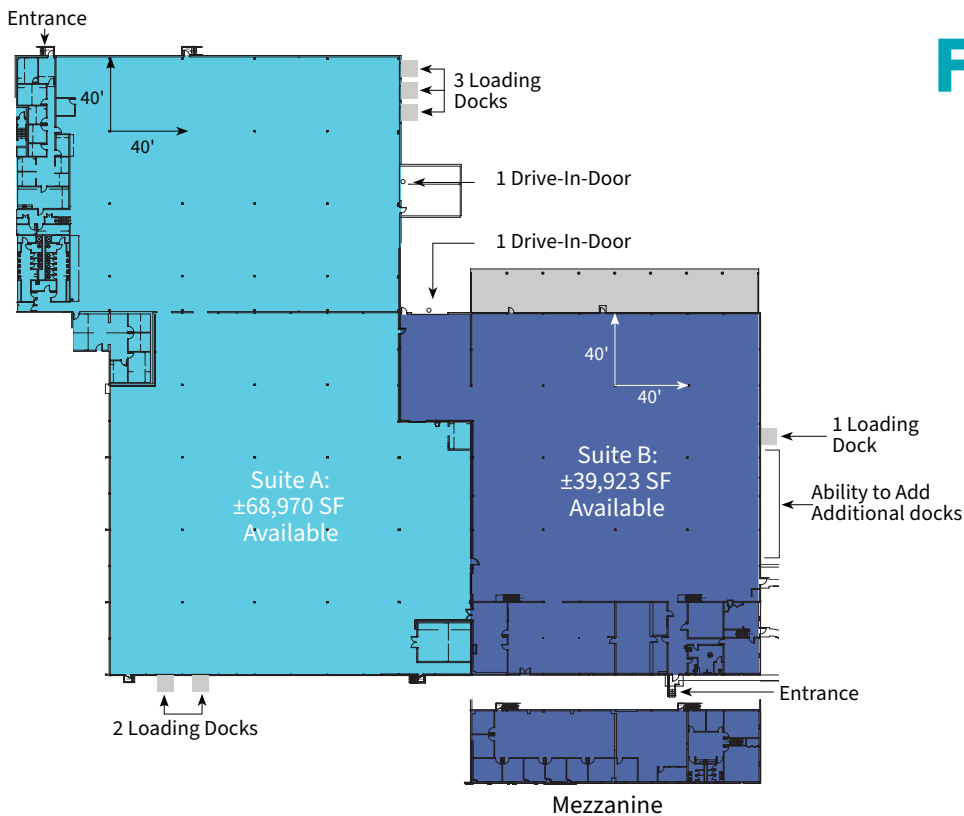

Commercial Rail Line & Providence/  
Stoughton Commuter Rail Line

**Tighe**Logistics  
GROUP

**CAR-O-LINER®**

**FUTURE  
FOAM**

**60 Maple  
Street**

**AMERISTAR®**

**ASSA ABLOY**

**VIKING®**

**dgs**  
retail

**Clopay**

**NATIONAL  
Lumber**  
Builders  
FirstSource

**KITCHEN  
VIEWS**

**ADVANCED WAREHOUSES, INC.**  
Public Warehousing and Distribution Experts

**BASS RESORT SALES CORP.**

**Michael J Connolly & Sons**

**BIO MANSFIELD INCUBATOR**

**SHEEHAN**  
PERSONAL TRAINING  
Strength. Endurance. Motivation.

**DOORSCAPES, INC.**

**MINI WAREHOUSING, INC.**

**INTRANSIT  
CONTAINER**

**VAM REALTY TRUST**

**PRECISION  
BIOSCIENCES**

**ELM**

**2.0 MILES TO CABOT BUSINESS PARK**

#### TRAVEL DISTANCES

<b>T</b>	Mansfield Commuter Rail Station	1.1 Miles
<b>140</b>	Route 140	1.7 Miles
<b>95</b>	I-95	2.7 Miles
<b>495</b>	I-495	2.8 Miles
<b>City</b>	Providence, RI	21.1 Miles
<b>City</b>	Boston, MA	25.5 Miles

## Contacts

**Chris Mullen**

Senior Vice President

+1 781 801 4432

chris.mullen2@cbre.com

**Kendall Lynch**

Vice President

+1 781 812 6435

kendall.lynch@cbre.com

**Caroline Munn**

Senior Associate

+1 516 851 6261

caroline.munn@cbre.com

**ARDEN** | GROUP

**CBRE**

© 2025 CBRE, Inc. All rights reserved. This information has been obtained from sources believed reliable, but has not been verified for accuracy or completeness. You should conduct a careful, independent investigation of the property and verify all information. Any reliance on this information is solely at your own risk. CBRE and the CBRE logo are service marks of CBRE, Inc. All other marks displayed on this document are the property of their respective owners, and the use of such logos does not imply any affiliation with or endorsement of CBRE. Photos herein are the property of their respective owners. Use of these images without the express written consent of the owner is prohibited.