

WASHINGTON OFFICE CENTER

409 3rd Street, SW
Washington, DC 20024

Office For Lease

19,065 SF



Leasing Information:
202.513.6700

Lincoln

Adam Biberaj
202.513.6736
abiberaj@lpc.com

Merrill Turnbull
202.513.6713
mturnbull@lpc.com

Jae Lee
202.513.6718
jlee@lpc.com

William Ruppe
202.513.6722
wruppe@lpc.com

Lincoln Property Company
101 Constitution Avenue, NW Suite 325 East
Washington, DC 20001

www.lpc.com

WASHINGTON OFFICE CENTER

409 3rd Street, SW | Washington, DC 20024

Office For Lease

Size

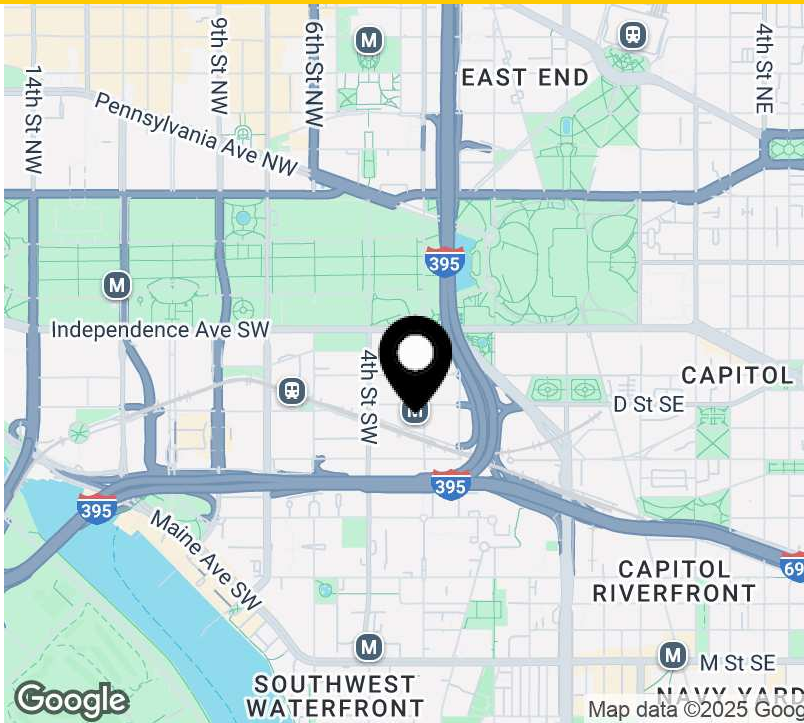

Property Highlights

- Located in Federal Center, surrounded by many federal agencies, museums, the botanic gardens and near Capitol Hill
- Boasts over 30,000 daytime employees within a walking distance
- 84 Walk Score - "Very Walkable"
- Sits atop Federal Center SW Metro Station with over 5,800 riders per day
- Perfect for five-day per week businesses

Availabilities

Suite 100

Size

19,065 SF

Lease Rate

Negotiable

Date Available

Immediately

Adam Biberaj

202.513.6736
abiberaj@lpc.com

Merrill Turnbull

202.513.6713
mturnbull@lpc.com

Jae Lee

202.513.6718
jlee@lpc.com

William Ruppe

202.513.6722
wruppe@lpc.com

Lincoln

WASHINGTON OFFICE CENTER

409 3rd Street, SW | Washington, DC 20024

Suite 100
19,065 SF

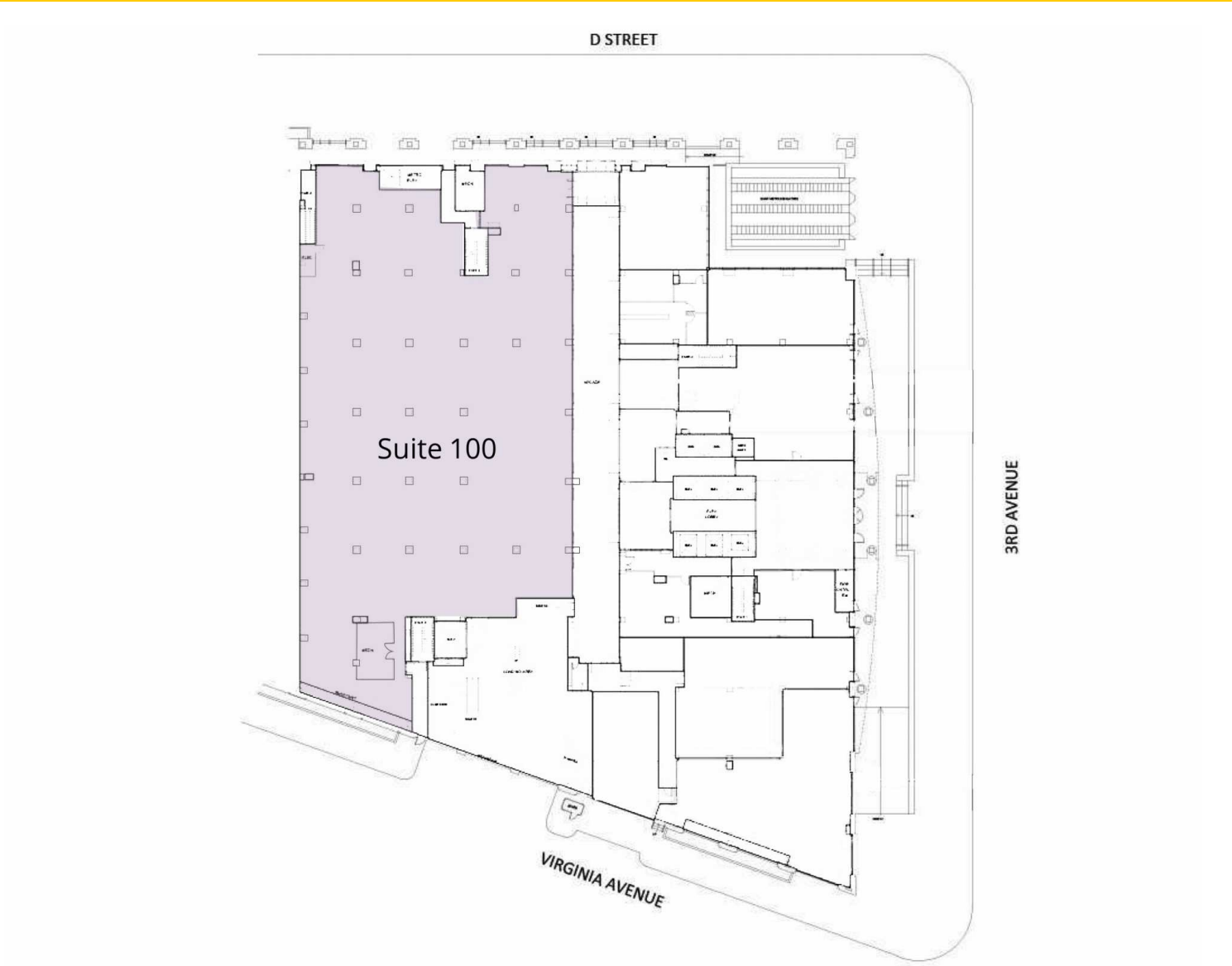

Suite	Size	Lease Rate	Description
■ Suite 100	19,065 SF	Negotiable	Ground floor office space with private ground floor entry. Former Gold's Gym.

Adam Biberaj
202.513.6736
abiberaj@lpc.com

Merrill Turnbull
202.513.6713
mturnbull@lpc.com

Jae Lee
202.513.6718
jlee@lpc.com

William Ruppe
202.513.6722
wruppe@lpc.com

Lincoln

WASHINGTON OFFICE CENTER

409 3rd Street, SW | Washington, DC 20024

Location Map

420,122 SF



Adam Biberaj

202.513.6736
abiberaj@lpc.com

Merrill Turnbull

202.513.6713
mturnbull@lpc.com

Jae Lee

202.513.6718
jlee@lpc.com

William Ruppe

202.513.6722
wruppe@lpc.com

Lincoln



WASHINGTON OFFICE CENTER

409 3rd Street, SW
Washington, DC 20024

Leasing Information:
202.513.6700

Adam Biberaj
202.513.6736
abiberaj@lpc.com

Merrill Turnbull
202.513.6713
mturnbull@lpc.com

Jae Lee
202.513.6718
jlee@lpc.com

William Ruppe
202.513.6722
wruppe@lpc.com

Lincoln

Lincoln Property Company
101 Constitution Avenue, NW Suite 325 East
Washington, DC 20001

www.lpc.com