



PARKING PATIENT DROP OFF / VALET  
CLEARANCE 6' 10" CAUTION CLEARANCE 10' 6"

# GREENPARK ONE

SPEC SUITE LOOK BOOK

7515 S. MAIN ST. | HOUSTON, TX 77030



BIG | SKY<sup>®</sup>

MEDICAL

# Available July '26

Suite 620 | +/- 2,319 RSF

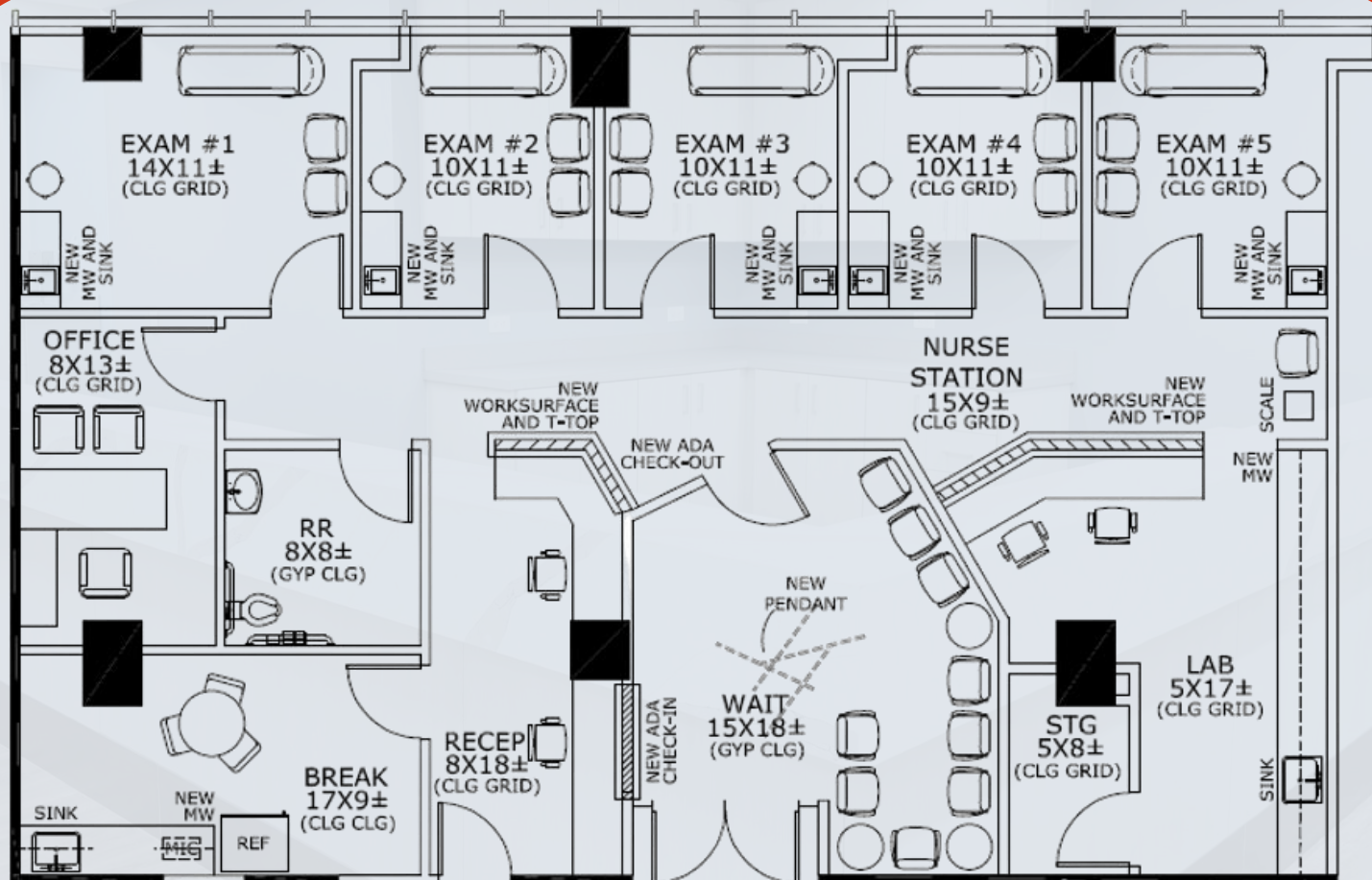

- 5 EXAM ROOMS
- PHYSICIAN'S OFFICE
- NURSE STATION
- LARGE WAITING ROOM
- CLINICAL LAB
- PRIVATE RESTROOM

# Available September '26

Suite 630 | +/- 4,483 RSF

- 5 EXAM ROOMS
- 2 PHYSICIAN'S OFFICES
- NURSE STATION / LAB
- PROCEDURE ROOM
- LARGE WAITING ROOM
- PRIVATE RESTROOM
- BREAK ROOM



# Available July '26

Suite 630 | +/- 2,683 RSF

- 5 EXAM ROOMS
- PHYSICIAN'S OFFICE
- NURSE STATION
- BUSINESS OFFICE
- LARGE WAITING ROOM
- PRIVATE RESTROOM
- BREAK ROOM





# RENDERINGS – SUITE 620 & 630



# 3D RENDERING – SUITE 620





# RENDERINGS – SUITE 195



HEIGHTS VENTURE ARCHITECTURE

HEIGHTS VENTURE ARCHITECTURE



**DISCOVER BIG SKY'S  
PAST SPEC SUITES**



# GREENPARK ONE



## For Leasing Information:



**NABIL ARABI**  
*Associate*

D | 469.949.8294  
M | 865.382.8883  
nabil@bigskymed.com