



LAKE MARY

RETAIL DEVELOPMENT

RETAIL FOR LEASE
1400 Encore Pl, Lake Mary, FL 32746



Conceptual rendering of the adjacent Lake Mary Apartments being built with the retail site on the same property.

Significant population growth in Lake Mary has been set into motion by the number of developments both underway and newly online in the area, generating quality jobs, housing demand and traffic across the City.



Colonial Town Park off International Parkway

The Lake Mary Retail Development is directly off Interstate 4 and Wekiva Parkway, surrounded by numerous residential and multifamily communities in addition to major workplaces in proximity, including Deloitte Consulting LLP (2,100 employees), JPMorganChase (1,800 employees), the Seminole State College of Florida (1,455 employees), Convergys (1,100 employees) and the new Orlando Health - Lake Mary location slated to open in early 2025.

The site is also across the street from the Colonial Center at Town Park, a 36-acre site with approx. 1M s.f. of rentable office space across its six, Class-A buildings.

Its prime location on International Parkway (approx. 168' of frontage), paired with the multifamily development underway alongside the retail site by the same developer, guarantees the opportunity for strong vehicle and foot traffic driving customers to the retail location.

54,852
Estimated
Population

73,046
Daytime
Population

39.7
Median
Age

22,083
Estimated
Households

\$144,835
Average
Household
Income

3,703
Total
Businesses



Adjacent apartment complex, Allure on Parkway

WELCOME

TO LAKE MARY

WHERE BUSINESS THRIVES



RANKED IN CNN MONEY'S
'BEST PLACES TO LIVE'



25 MINUTES FROM
DOWNTOWN ORLANDO



LOWEST PROPERTY TAXES
IN SEMINOLE COUNTY



A-RATED PUBLIC
SCHOOL SYSTEM



CLASS-A OFFICE
HEADQUARTERS AND
TALENT POOL



NOMINATED AS ONE OF
THE 'BEST PLACES FOR
FAMILIES'

PROPERTY PREVIEW

PROPOSED

LAKE MARY RETAIL DEVELOPMENT

- 13,593 s.f. of retail space and a courtyard of 6,275 s.f. available
- Adjacent component of a larger living development (Lake Mary Apartments) that will continue to increase traffic with ±179 units upon completion; the apartments serve as an active living community for 55+
- Both the retail development and Lake Mary Apartments are part of the same property and PUD
- Also adjacent to Allure on Parkway, which has 290 Class-A units; the subject site has 329' of frontage on Allure Ln, the roadway leading to both apartments
- Construction will begin in Q1 2025
- Comprised of a 28' building height in painted stucco, metal canopies, accent uplights and an overall modern, wooden aesthetic (See Site Elevation)
- Directly located on International Parkway (±14,500 VPD) with 168' of frontage
- Great visibility and access from International Parkway with ±65 parking spaces for retail; the site caters to most retail uses
- Direct access to the Seminole Wekiva Trail, a 26.5-mile rail-trail spanning from Apopka to Lake Mary to Sorrento
- Seminole County is one of the most affluent counties in Florida, filled with well-established neighborhoods and a growing population as demonstrated by the surrounding developments and the \$1.6B Wekiva Parkway expansion to accommodate the population influx



Conceptual rendering of the adjacent Lake Mary Apartments being built with the retail site on the same property.

PRELIMINARY SITE PLAN



NOT PART

AIURE

ON PARKWAY

Luxury Apartments
290 Class A units

Courtyard
6,275 s.f.

Restaurant/Retail
13,593 s.f.

← Seminole Wekiva Trail Access

PRELIMINARY FLOOR PLAN

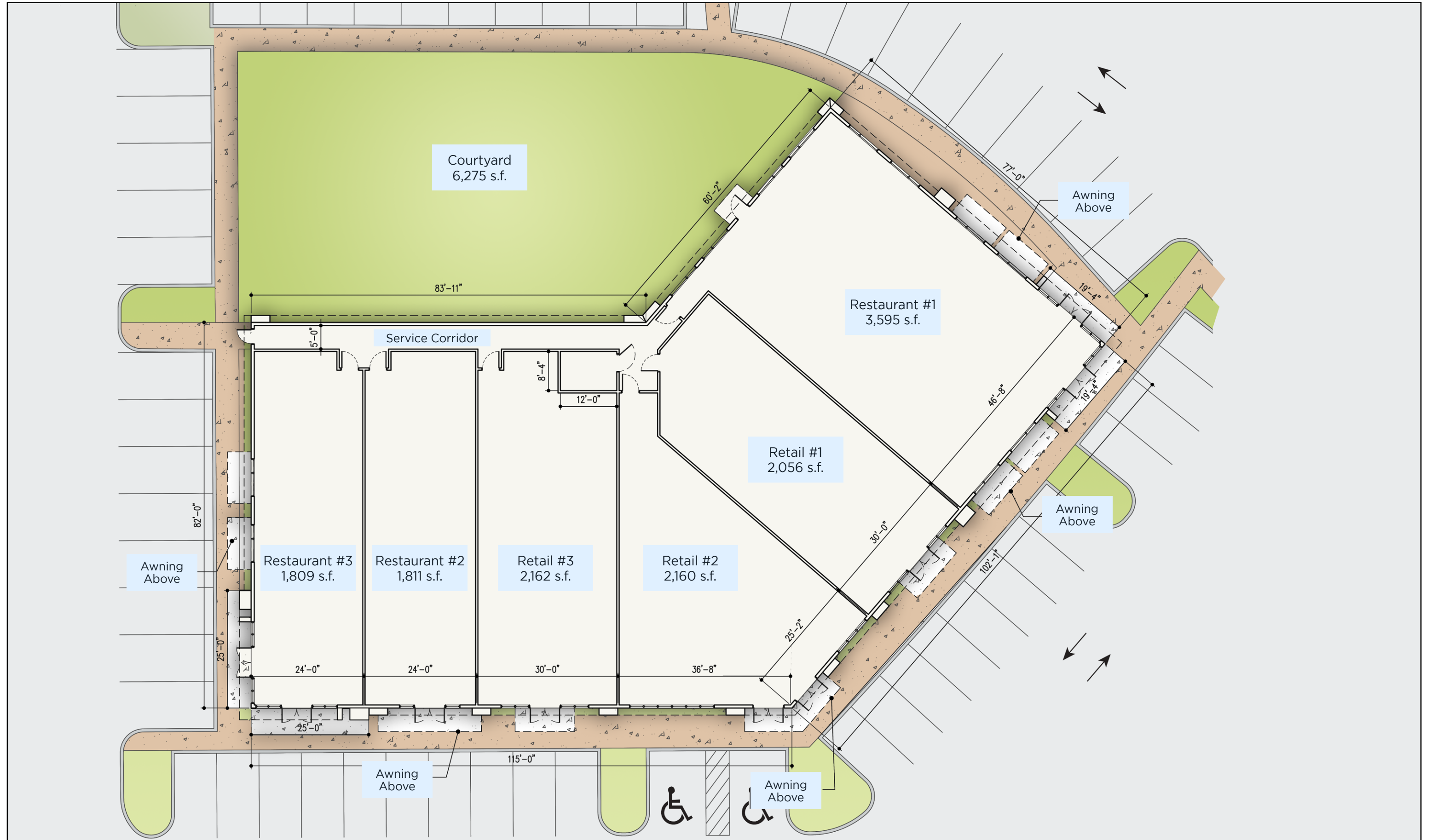

SITE ELEVATION

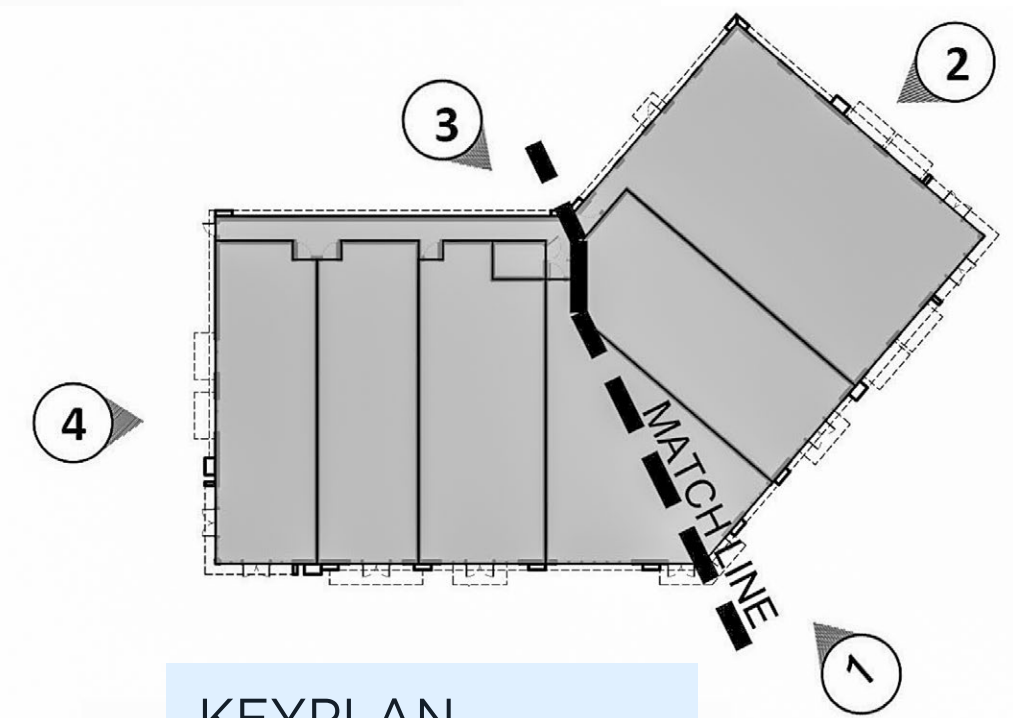

KEYPLAN
NTS

RETAIL-RESTAURANT
ELEVATIONS
SCALE: 1/8" = 1' - 0"

POINTS OF INTEREST



TRADE AREA

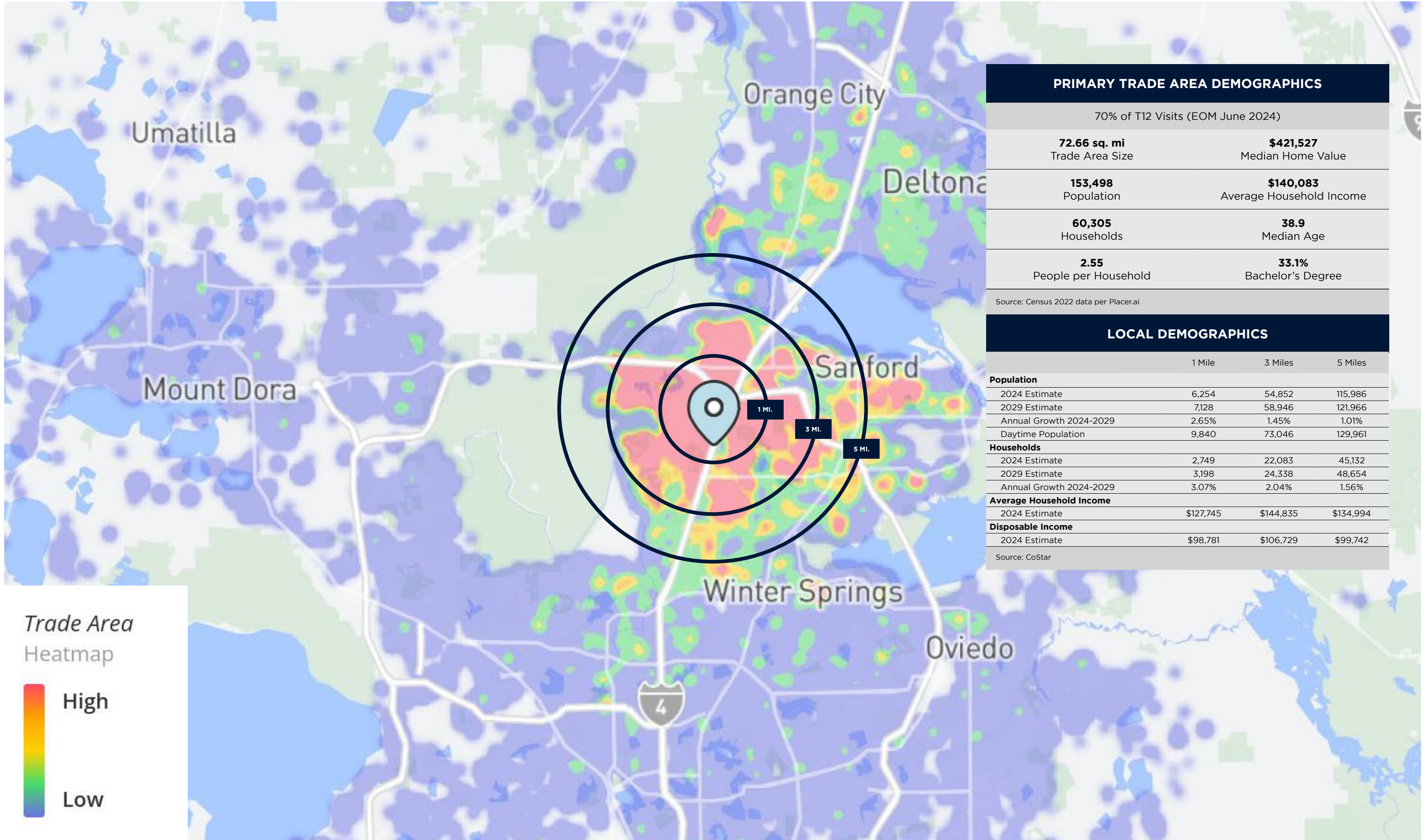

PRIMARY TRADE AREA DEMOGRAPHICS

70% of T12 Visits (EOM June 2024)

72.66 sq. mi Trade Area Size	\$421,527 Median Home Value
153,498 Population	\$140,083 Average Household Income
60,305 Households	38.9 Median Age
2.55 People per Household	33.1% Bachelor's Degree

Source: Census 2022 data per Placer.ai

LOCAL DEMOGRAPHICS

	1 Mile	3 Miles	5 Miles
Population			
2024 Estimate	6,254	54,852	115,986
2029 Estimate	7,128	58,946	121,966
Annual Growth 2024-2029	2.65%	1.45%	1.01%
Daytime Population	9,840	73,046	129,961
Households			
2024 Estimate	2,749	22,083	45,132
2029 Estimate	3,198	24,338	48,654
Annual Growth 2024-2029	3.07%	2.04%	1.56%
Average Household Income			
2024 Estimate	\$127,745	\$144,835	\$134,994
Disposable Income			
2024 Estimate	\$98,781	\$106,729	\$99,742

Source: CoStar

Trade Area
Heatmap

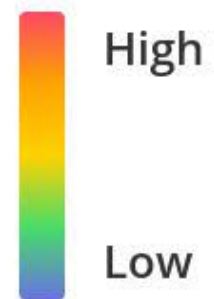

LAKE MARY

RETAIL DEVELOPMENT



To learn more about this retail opportunity, please contact:



BRANDON MCCALLA

Vice President
brandon.mccalla@jll.com
+1 954 665 3113



COLETTE SANTANA

Senior Vice President
colette.santana@jll.com
+1 813 777 8611



BILLY RODRIGUEZ

Senior Vice President
billy.rodriguez@jll.com
+1 407 443 3925



TAYLAR LING

Associate
taylar.ling@jll.com
+1 407 271 3067

us.jll.com/retail

© 2024 Jones Lang LaSalle Brokerage, Inc. All rights reserved. All information contained herein is from sources deemed reliable; however, no representation or warranty is made to the accuracy thereof.

