

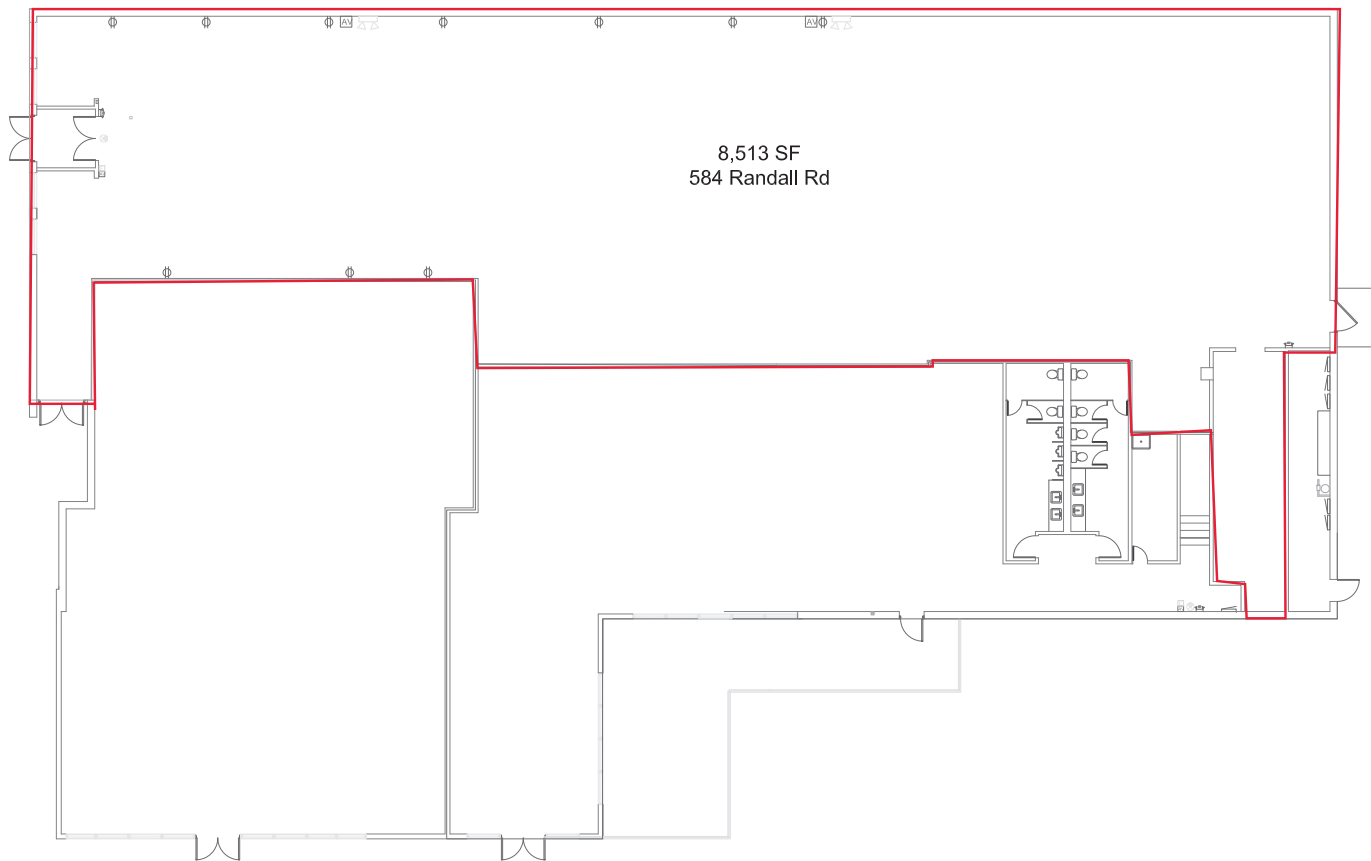

Dan Soltis
dsoltis@CIMADevelopers.org
www.CIMADevelopers.org



FLOOR PLAN - 584 RANDALL RD

SCALE: 1/8"=1'-0"



GLEASON
ARCHITECTS, P.C.

769 Heartland Drive, Unit 4
Sugar Grove, Illinois 60054
Phone: 630-466-8740
Fax: 630-466-8700

E-mail: thad@gleasonarchitectspc.com

THESE DRAWINGS, INCLUDING ALL SPECIFICATIONS, SCHEDULES, AND NOTATIONS, ARE THE SOLE PROPERTY OF GLEASON ARCHITECTS, P.C. AND ARE FOR THE USE OF THE CLIENT ONLY. NO PART OF THESE DRAWINGS SHALL BE REPRODUCED OR USED IN ANY MANNER WITHOUT THE WRITTEN PERMISSION OF GLEASON ARCHITECTS, P.C.

ISSUED	DATE
FOR APPROVAL	
FOR PERMIT	
FOR BID	
FOR CONST.	

REVISED	DATE

PROJECT: Randall Plaza Remodel
OWNER: St. Charles, IL
ARCHITECT: Gleason Architects, P.C.
381 East St. Charles Rd
East St. Charles, IL

JOB NO. 13-037
DATE 04/16/13
FILE 13141
PLOT SCALE 1/8"

OWNER APPROVAL

Signature _____
DATE _____

SHEET TITLE
FLOOR PLAN

SHEET NUMBER
A1

Site plan for Parcel 2, showing parking spaces, building footprints, and surrounding streets. The plan includes dimensions, area calculations, and labels for various features like "LIGHT", "Pylon Sign", "Colonial To-Go Pick Up Station", and "ELEC. EQUIP. SLAB". The site is bounded by Randall Road to the west, Prairie Street to the south, and Wessel Court West to the east. A north arrow is located in the top left corner.

DEPRESSED CURB

PAVEMENT THICKNESS 9" MIN.

12" 7"

3/4"

1 1/2" (1/2" AT HANDICAP RAMPS)

2 NO. 6 SMOOTH DOWEL BARS WITH GREASED CAPS AT EXPANSION JOINTS.

4" 11" 4"

IDOT CA-6 CRUSHED STONE BASE (4" MIN) (WHERE APPLICABLE)

B6.12 CURB & GUTTER

EDGE OF PAVEMENT

12" 1" 6"

1/4" 2" RAD. 3" RAD. 3/4" PER 1'

PAVEMENT THICKNESS 9" MIN.

4" 11" 4"

2 NO. 6 SMOOTH DOWEL BARS WITH GREASED CAPS AT EXPANSION JOINTS.

IDOT CA-6 CRUSHED STONE BASE (4" MIN) (WHERE APPLICABLE)

NOTES:

- CONTRACTION JOINTS SHALL BE PLACED AT 15' INTERVALS, AND SHALL BE GROOVED WITH AN EDGING TOOL. SEE ARTICLE 420.10 OF IDOT STANDARD SPECIFICATIONS.
- EXPANSION JOINTS SHALL BE PLACED AT 60' (MAX) INTERVALS, AT ALL P.C.'S AND P.T.'S, CURB RETURNS, AND AT THE END OF EACH POUR
- P.C.C. SHALL CONSIST OF IDOT CLASS SI (6.1 BAG MIX) CONCRETE, WITH 5% TO 8% AIR ENTRAINMENT, AND A MINIMUM COMPRESSIVE STRENGTH OF 3,500 PSI AT 14 DAYS. (NO FLY ASH ALLOWED)

NOT TO SCALE

FOR RESIDENTIAL STREETS ONLY

COMB. CONCRETE CURB AND GUTTER (SPECIAL)
P.C.C. INTEGRAL CURB AND GUTTER (SPECIAL)

- Pear Trees (26 Total)
 - 15 Current
 - 11 NEW
- Gold Cedar Mulch

$$1'' = 30'$$