

# Sovereign Associates, Inc.

New York City Real Estate Experts  
www.sovereignrealestate.com

Principal Broker: **Gregory Healy**  
Contact: **917.709.1491**  
Email: **ghealy@sovereignrealestate.com**  
Receptionist: **646.559.9001**  
Email: **info@sovereignrealestate.com**

Morningside Office  
3135 Broadway Front A  
New York, NY 10027

Hudson Heights Office  
710 West 187th St  
New York, NY 10033



**COMMERCIAL OFFICE SPACE  
FOR LEASE**

**205 West 106th Street  
New York, NY 10025**

## About the Space

Great space to open a neighborhood business with little retail competition on the same street. With a spacious interior in a quiet residential area, there's high foot traffic just one avenue over on Amsterdam. The space has 1 private restroom and basement storage.

## Property Highlights

- ✓ Located in the 10025 area of Manhattan, New York
- ✓ Quiet residential neighborhood
- ✓ Restaurants and amenities available within walking distance



**Nearby Subway Trains**  
1 Train - 103rd Station



**Nearby School/University 0.8 Miles**  
Columbia University



**Square Feet**  
650



**Community and Restaurants**

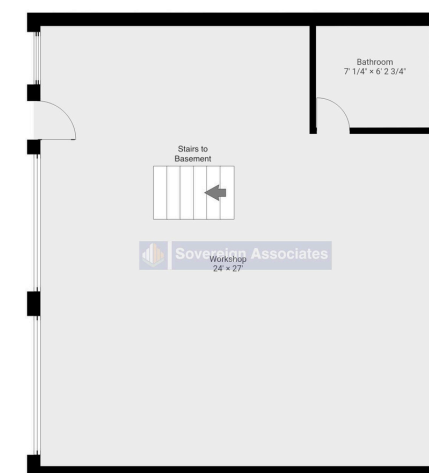

**Contact us**

**Gregory Healy**  
Principal Broker  
917.709.1491  
ghealy@sovereignrealestate.com  
www.sovereignrealestate.com



**\*to schedule viewing or any general questions, please scan me!**



*All information contained herein is based upon the information which we consider reliable, but because it has been supplied by third parties, we cannot represent that it is accurate and complete, and it should not be relied upon as such. The offerings are subject to errors, commissions, changes, including price, or withdrawal without notice. The content is provided without warranties of any kind, whether expressed or implied. Sovereign Associates, Inc. and its agents or employees shall not be held liable to anyone for any errors, commissions, or inaccuracies under any circumstances. You and your advisors should conduct a careful, independent examination of any property to determine to your satisfaction it's suitability to your needs.*