

# PROPERTY FEATURES

# FOR LEASE

5162 WESTERN WAY  
PERRIS, CA 92571



## BUILDING SIZE:

±8,871 sq.ft.

## LOT SIZE

±17,859 sq.ft.



## PARCELS

APN: 294-190-074



## ZONING

Light Industrial (LI) of the Perris Valley Commerce Center (PVCC) per the City of Perris, CA



## PROPERTY HIGHLIGHTS

- 1 Ground Level Door (10' x 12')
- ±18' Clear Height
- ±400 AMPS, 277/480v 3-Phase Power (verify)
- Private Secured Yard
- Next to March Air Reserve Base
- Excellent Access to I-215 Freeway from the Harley Knox Blvd. On/Off Ramp, Close Proximity to 60 Freeway



**INLAND  
EMPIRE**

CAL DRE # 02120868

KW COMMERCIAL  
3595-1 Inland Empire  
Blvd. Suite 1250  
Ontario, CA 91764  
**909.980.6868**

**Rene Ramos, Jr.**  
**909.980.6868**  
Rene.Ramos@kwcommercial.com  
CalDRE Lic. #01836872

**Jacob B. Bernardy**  
**909.935.0935**  
Jacob.Bernardy@kwcommercial.com  
CalDRE Lic. #02039512

**Robert D. Bagley III**  
**909.935.0938**  
Robert.Bagley@kwcommercial.com  
CalDRE Lic. #02131874

**Daniel W. Richards**  
**909.980.6868**  
Daniel.Richards@kwcommercial.com  
CalDRE Lic. #00803221

WE OBTAINED THE INFORMATION ABOVE FROM SOURCES WE BELIEVE TO BE RELIABLE. HOWEVER, WE HAVE NOT VERIFIED ITS ACCURACY AND MAKE NO GUARANTEE, WARRANTY, OR REPRESENTATION ABOUT IT. IT IS SUBMITTED SUBJECT TO THE POSSIBILITY OF ERRORS, OMISSIONS, CHANGE OF PRICE, RENTAL OR OTHER CONDITIONS, PRIOR SALE, LEASE OR FINANCING, OR WITHDRAWAL WITHOUT NOTICE. WE INCLUDE PROJECTIONS, OPINIONS, ASSUMPTIONS OR ESTIMATES FOR EXAMPLE ONLY, AND THEY MAY NOT REPRESENT CURRENT OR FUTURE PERFORMANCE OF THE PROPERTY. YOU AND YOUR TAX AND LEGAL ADVISORS SHOULD CONDUCT YOUR OWN INVESTIGATION OF THE PROPERTY AND TRANSACTION.



## AERIAL MAP



## LOCAL MAP



## REGIONAL MAP

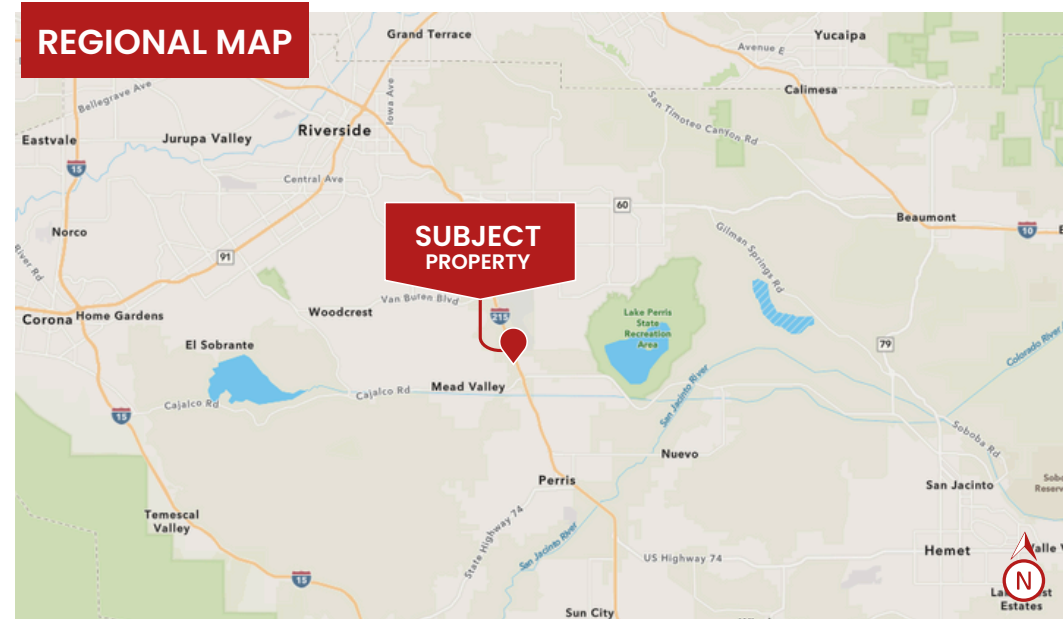

Rene Ramos, Jr.  
909.980.6868  
Rene.Ramos@kwcommercial.com  
CalDRE Lic. #01836872

Jacob B. Bernardy  
909.935.0935  
Jacob.Bernardy@kwcommercial.com  
CalDRE Lic. #02039512

Robert D. Bagley III  
909.935.0938  
Robert.Bagley@kwcommercial.com  
CalDRE Lic. #02131874

Daniel W. Richards  
909.980.6868  
Daniel.Richards@kwcommercial.com  
CalDRE Lic. #00803221



**INLAND  
EMPIRE**

**CAL DRE # 02120868**





**Rene Ramos, Jr.**  
**909.980.6868**  
Rene.Ramos@kwcommercial.com  
CalDRE Lic. #01836872

**Jacob B. Bernardy**  
**909.935.0935**  
Jacob.Bernardy@kwcommercial.com  
CalDRE Lic. #02039512

**Robert D. Bagley III**  
**909.935.0938**  
Robert.Bagley@kwcommercial.com  
CalDRE Lic. #02131874

**Daniel W. Richards**  
**909.980.6868**  
Daniel.Richards@kwcommercial.com  
CalDRE Lic. #00803221



**INLAND  
EMPIRE**

**CAL DRE # 02120868**





**Rene Ramos, Jr.**  
**909.980.6868**  
Rene.Ramos@kwcommercial.com  
CalDRE Lic. #01836872

**Jacob B. Bernardy**  
**909.935.0935**  
Jacob.Bernardy@kwcommercial.com  
CalDRE Lic. #02039512

**Robert D. Bagley III**  
**909.935.0938**  
Robert.Bagley@kwcommercial.com  
CalDRE Lic. #02131874

**Daniel W. Richards**  
**909.980.6868**  
Daniel.Richards@kwcommercial.com  
CalDRE Lic. #00803221



**INLAND  
EMPIRE**

**CAL DRE # 02120868**





**Rene Ramos, Jr.**  
**909.980.6868**  
Rene.Ramos@kwcommercial.com  
CalDRE Lic. #01836872

**Jacob B. Bernardy**  
**909.935.0935**  
Jacob.Bernardy@kwcommercial.com  
CalDRE Lic. #02039512

**Robert D. Bagley III**  
**909.935.0938**  
Robert.Bagley@kwcommercial.com  
CalDRE Lic. #02131874

**Daniel W. Richards**  
**909.980.6868**  
Daniel.Richards@kwcommercial.com  
CalDRE Lic. #00803221



**INLAND  
EMPIRE**

**CAL DRE # 02120868**





Rene Ramos, Jr.  
909.980.6868  
Rene.Ramos@kwcommercial.com  
CalDRE Lic. #01836872

Jacob B. Bernardy  
909.935.0935  
Jacob.Bernardy@kwcommercial.com  
CalDRE Lic. #02039512

Robert D. Bagley III  
909.935.0938  
Robert.Bagley@kwcommercial.com  
CalDRE Lic. #02131874

Daniel W. Richards  
909.980.6868  
Daniel.Richards@kwcommercial.com  
CalDRE Lic. #00803221



**INLAND  
EMPIRE**

**CAL DRE # 02120868**





Rene Ramos, Jr.  
909.980.6868  
Rene.Ramos@kwcommercial.com  
CalDRE Lic. #01836872

Jacob B. Bernardy  
909.935.0935  
Jacob.Bernardy@kwcommercial.com  
CalDRE Lic. #02039512

Robert D. Bagley III  
909.935.0938  
Robert.Bagley@kwcommercial.com  
CalDRE Lic. #02131874

Daniel W. Richards  
909.980.6868  
Daniel.Richards@kwcommercial.com  
CalDRE Lic. #00803221



**INLAND  
EMPIRE**

**CAL DRE # 02120868**





**Rene Ramos, Jr.**  
**909.980.6868**  
Rene.Ramos@kwcommercial.com  
CalDRE Lic. #01836872

**Jacob B. Bernardy**  
**909.935.0935**  
Jacob.Bernardy@kwcommercial.com  
CalDRE Lic. #02039512

**Robert D. Bagley III**  
**909.935.0938**  
Robert.Bagley@kwcommercial.com  
CalDRE Lic. #02131874

**Daniel W. Richards**  
**909.980.6868**  
Daniel.Richards@kwcommercial.com  
CalDRE Lic. #00803221



**INLAND  
EMPIRE**

**CAL DRE # 02120868**





Rene Ramos, Jr.  
909.980.6868  
Rene.Ramos@kwcommercial.com  
CalDRE Lic. #01836872

Jacob B. Bernardy  
909.935.0935  
Jacob.Bernardy@kwcommercial.com  
CalDRE Lic. #02039512

Robert D. Bagley III  
909.935.0938  
Robert.Bagley@kwcommercial.com  
CalDRE Lic. #02131874

Daniel W. Richards  
909.980.6868  
Daniel.Richards@kwcommercial.com  
CalDRE Lic. #00803221



**INLAND  
EMPIRE**

**CAL DRE # 02120868**





Rene Ramos, Jr.  
909.980.6868  
Rene.Ramos@kwcommercial.com  
CalDRE Lic. #01836872

Jacob B. Bernardy  
909.935.0935  
Jacob.Bernardy@kwcommercial.com  
CalDRE Lic. #02039512

Robert D. Bagley III  
909.935.0938  
Robert.Bagley@kwcommercial.com  
CalDRE Lic. #02131874

Daniel W. Richards  
909.980.6868  
Daniel.Richards@kwcommercial.com  
CalDRE Lic. #00803221



**INLAND  
EMPIRE**

**CAL DRE # 02120868**