

# FOR SALE OR LEASE

3220 E. 59TH ST. | LONG BEACH, CA



## PROPERTY FEATURES

- ± 17,782 SF Freestanding Industrial Building
- Large, Fenced, Paved and Secured Yard
- Possible Cannabis Related Business Location (Verify)
- One (1) Truckwell
- Four (4) Ground Level Doors (Oversized)
- 400 Amps, 120/208V, 3-Phase, 4-Wire (Verify)
- 15' - 17' Clearance
- Office SF TBD
- 28 Parking Spaces (Verify)
- Close Proximity to the 91 Freeway
- Available 4/1/2026, Do Not Disturb Occupant

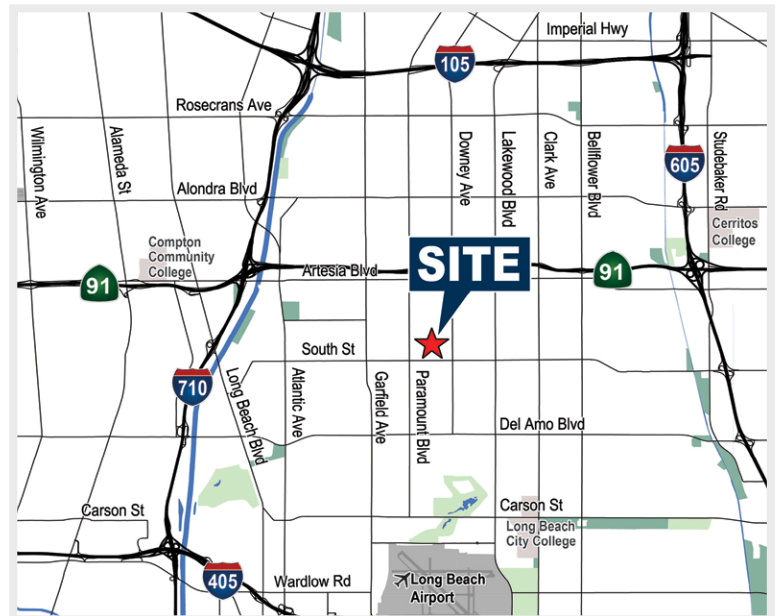

**ERIC SMITH, SIOR**  
Senior Vice President | Partner  
714.935.2310  
Lic. #01940591  
esmith@voitco.com

**Voit**  
REAL ESTATE SERVICES

2400 E. Katella Avenue  
Suite 750  
Anaheim, CA 92806  
Lic #01991785  
[www.VoitCo.com](http://www.VoitCo.com)



3220 E. 59TH ST. | LONG BEACH, CA

## PROPERTY PHOTOS



**ERIC SMITH, SIOR**  
Senior Vice President | Partner  
714.935.2310  
Lic. #01940591  
esmith@voitco.com

**Voit**  
REAL ESTATE SERVICES

2400 E. Katella Avenue  
Suite 750  
Anaheim, CA 92806  
Lic #01991785  
[www.VoitCo.com](http://www.VoitCo.com)

The information contained herein has been obtained from sources we deem reliable. While we have no reason to doubt its accuracy, we do not guarantee it.  
Licensed as Real Estate Broker and Salesperson by the DRE. ©2026 Voit Real Estate Services, Inc. All Rights Reserved. License #01991785



## SITE PLAN

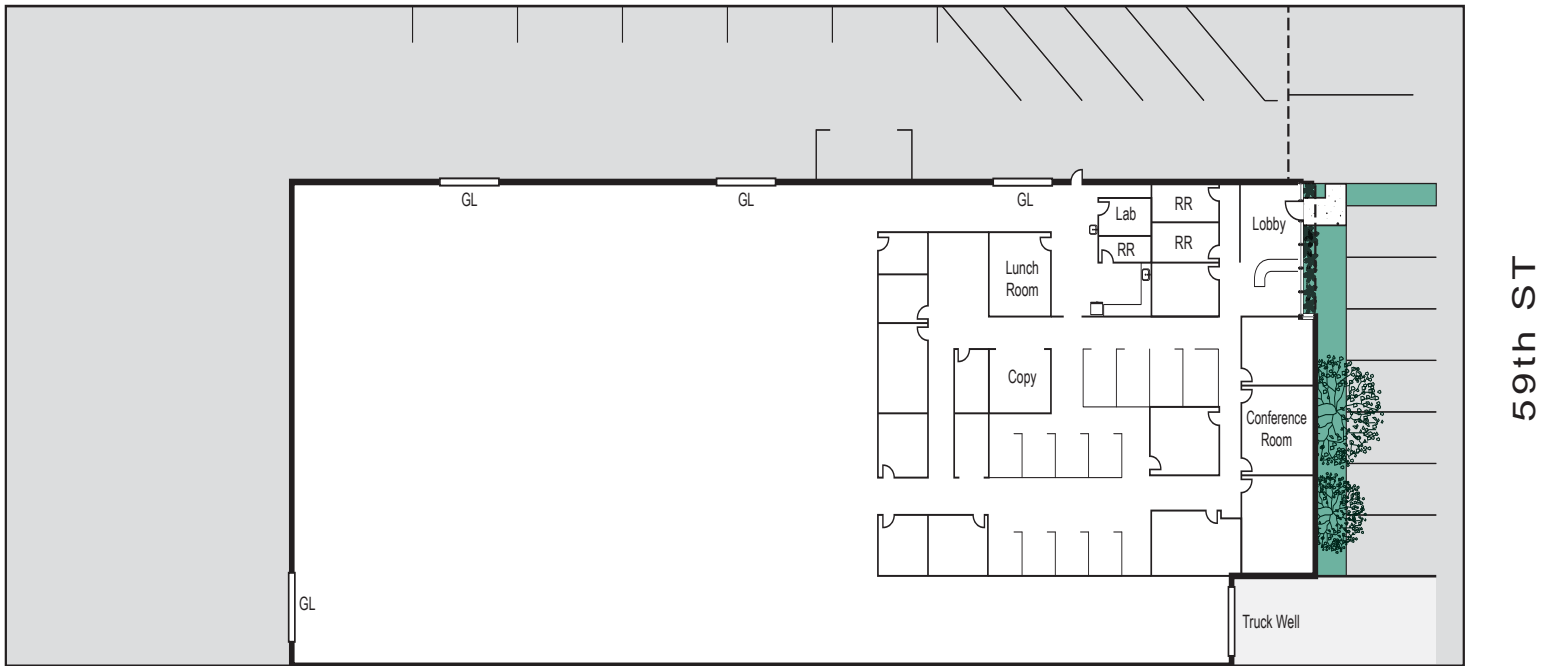

\*Site Plan Not to Scale



**ERIC SMITH, SIOR**  
Senior Vice President | Partner  
714.935.2310  
Lic. #01940591  
esmith@voitco.com

**Voit**  
REAL ESTATE SERVICES

2400 E. Katella Avenue  
Suite 750  
Anaheim, CA 92806  
Lic #01991785  
[www.VoitCo.com](http://www.VoitCo.com)