



## 2,598 SF INDUSTRIAL BUILDING & ADJACENT LOT FOR SALE

2607-2609 S El Camino Real  
San Clemente

**2,598 SF** freestanding  
industrial building

**PROPOSED EXCLUSIVE  
PARKING LOT** to replace  
residential building at 2609

**2 PARCELS** total 7,874 sf

**MIXED USE ZONING** allows  
neighborhood-serving  
commercial or residential uses

**ROLL-UP LOADING DOOR**  
2nd loading door was  
converted to back door &  
windows

**VIRTUAL TOUR** available at  
[WynneCRE.com](http://WynneCRE.com)

**OCCUPIED** please contact  
Jim to tour

**JIM WYNNE**  
949-374-2052  
[jim@wynnecre.com](mailto:jim@wynnecre.com)  
License 01242705  
[WynneCRE.com](http://WynneCRE.com)



**PROPOSED  
EXCLUSIVE  
PARKING LOT**



PROPOSED  
EXCLUSIVE PARKING LOT  
TO REPLACE  
EXISTING RESIDENTIAL





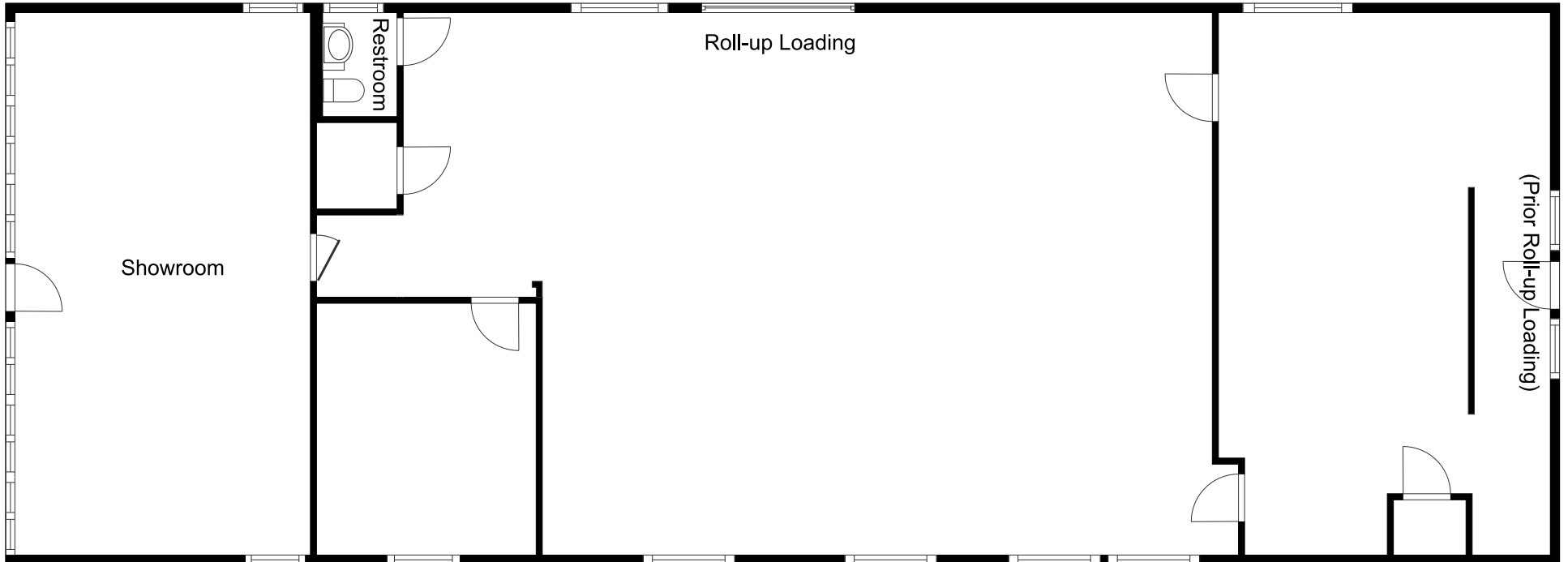

**JIM WYNNE**  
 949-374-2052  
 jim@wynnecre.com  
 License 01242705

**2607-2609 S El Camino Real**  
**San Clemente**

WYNNECRE.COM

Approximate floor plan shown. The information supplied herein is from sources we deem reliable. It is provided without any representation, warranty, or guarantee, expressed or implied as to its accuracy. A prospective buyer should conduct an independent investigation and verification of all matters deemed to be material. Consult your attorney, accountant, or other professional advisor.