

GENERAL OFFICE | SUBLEASE OPPORTUNITY

5540 PARK BLVD. PINELLAS PARK, FL 33781



BUILDING HIGHLIGHTS

- 14,363 SF Available
- Lease expires March 31, 2026
- Numerous large offices/classroom space
- Large Café
- Building signage
- Rate: Negotiable



FLOORPLAN | 14,363 SF

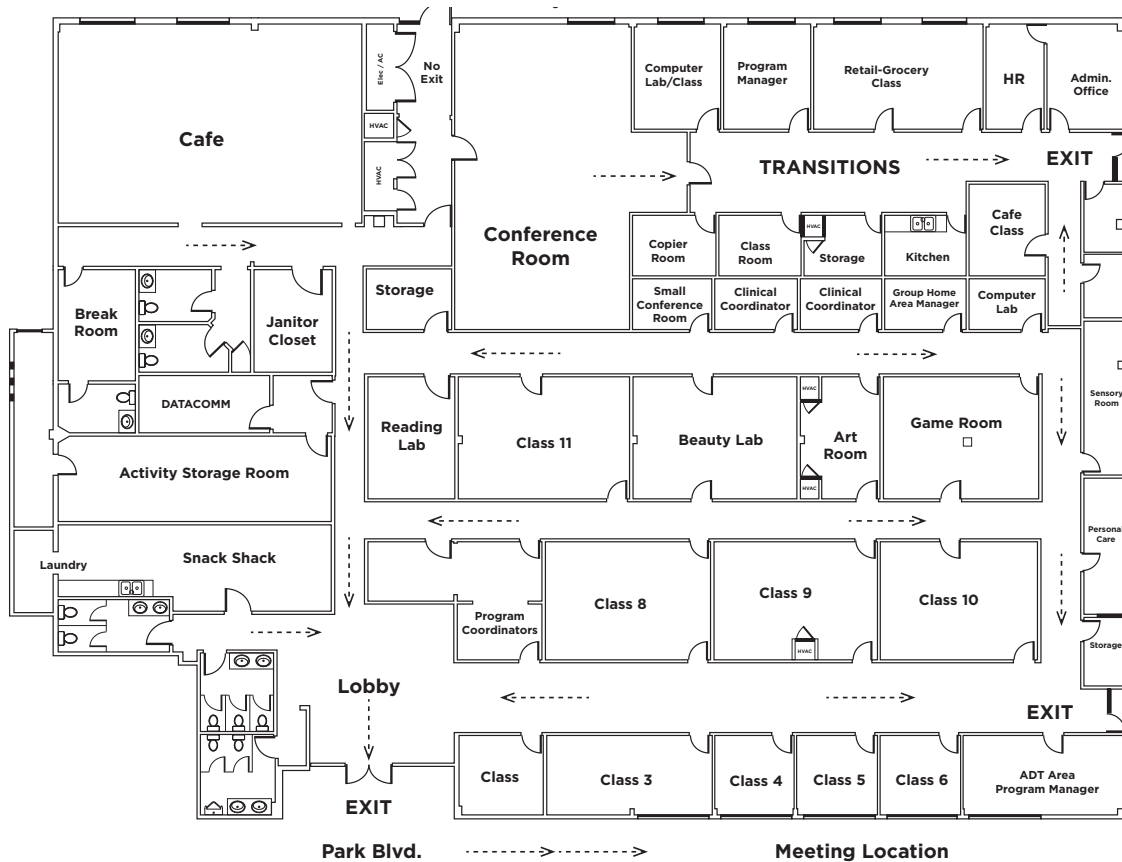

AREA AMENITIES

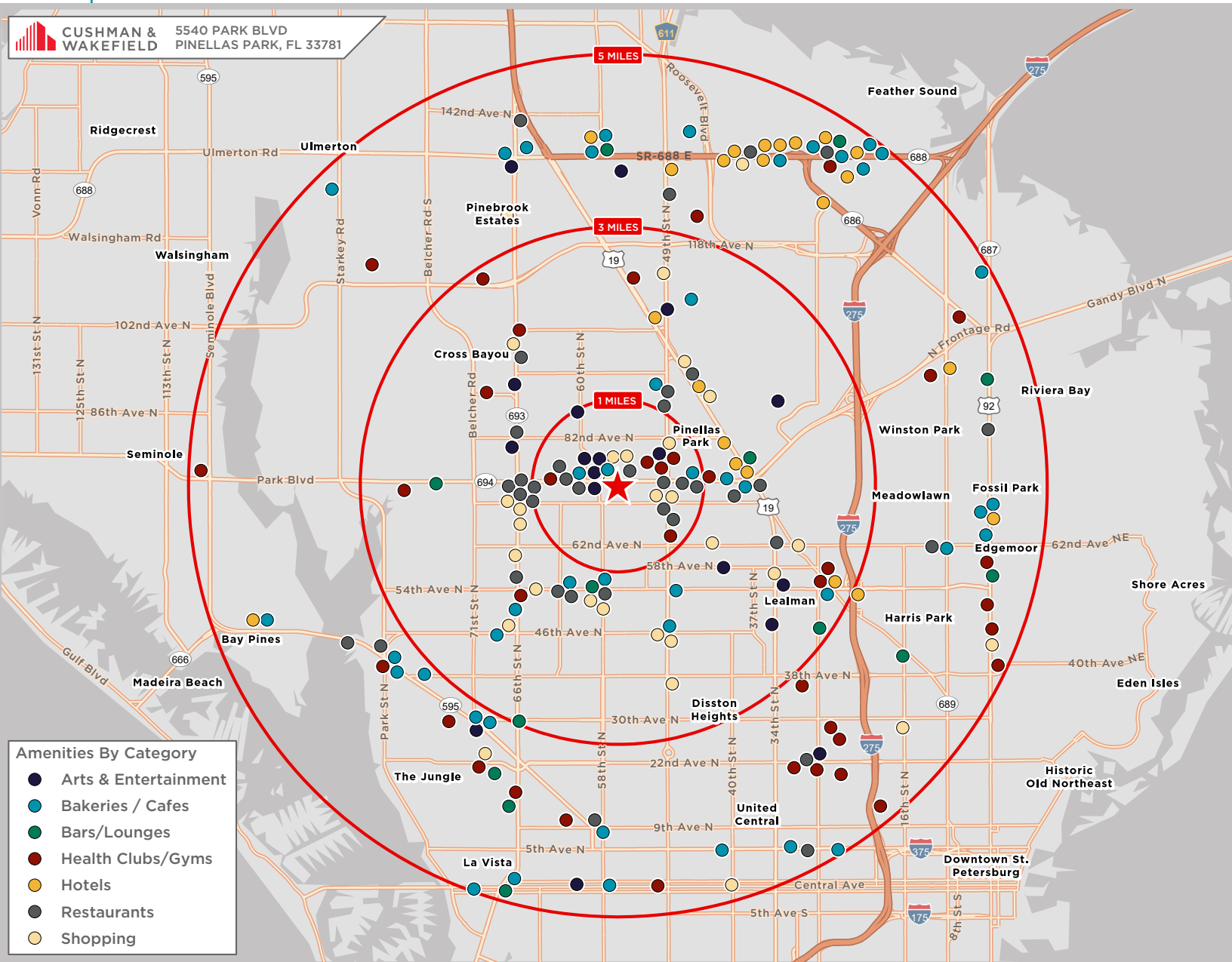

22
HOTELS
within 5 miles

30+
RESTAURANTS
within 5 miles

3
PHARMACIES
within 5 miles

279,603
TOTAL POPULATION
within 5 miles

\$94,704
HOUSEHOLD INCOME
within 5 miles

45.9
MEDIAN AGE
within 5 miles

*based on 2024 data

5540 PARK BLVD

FOR MORE INFORMATION,

PLEASE CONTACT:

BRIAN BREEDING, CCIM
SENIOR DIRECTOR
FLORIDA HEALTHCARE ADVISORY PRACTICE

Direct: +1 813 204 5369

Mobile: +1 813 440 3715

brian.breeding@cushwake.com

ASHLEY JAMES
SENIOR ASSOCIATE

Direct: +1 813 349 8376

Mobile: +1 813 846 6527

ashley.n.james@cushwake.com

201 North Franklin Street
One Tampa City Center
Tampa, Florida 33602-5163
Office: +1 813 204 5369
cushmanwakefield.com



©2024 Cushman & Wakefield. All rights reserved. The information contained in this communication is strictly confidential. This information has been obtained from sources believed to be reliable but has not been verified. No warranty or representation, express or implied, is made as to the condition of the property (or properties) referenced herein or as to the accuracy or completeness of the information contained herein, and same is submitted subject to errors, omissions, change of price, rental or other conditions, withdrawal without notice, and to any special listing conditions imposed by the property owner(s). Any projections, opinions or estimates are subject to uncertainty and do not signify current or future property performance.