

*Coming Soon*

**Retail Development |  
Pads & Anchor Space  
Available**

**SWC**  
**Whitemore & Morgan**  
Ceres, CA

**Property Highlights**

- 25,415± AADT at the Intersection
- Co-tenants with McDonald's, gas c-store, incoming Mister Car Wash, Dollar General, O'Reilly's Auto Parts, and Pending Drive-Thru QSR
- Surrounded by over +3M SF of Industrial Distribution Centers and surrounding residential



The information contained herein may have been obtained from sources other than ASU Commercial. We have not verified such information and make no guarantees, warranties or representations about such information. It is your responsibility to independently confirm its accuracy and completeness prior to purchasing/leasing the property.



**Jonathon Ortiz** • Associate • 661 885 6948 direct • [jonathon@asuassociates.com](mailto:jonathon@asuassociates.com) • CA RE #02069258  
11601 Bolthouse Drive Suite 110 • Bakersfield, CA 93311 • 661 862 5454 main • 661 862 5444 fax

# Retail Development Available For Sale or Lease

## Site Plan

SWC Whitmore & Morgan • Ceres, CA

- (Pad) Parcel 2 42,751 SF / 0.98 Acres
- (Pad) Parcel 5 55,321 SF / 1.27 Acres
- (Phase II Anchor) Parcel 3 4.75 Acres

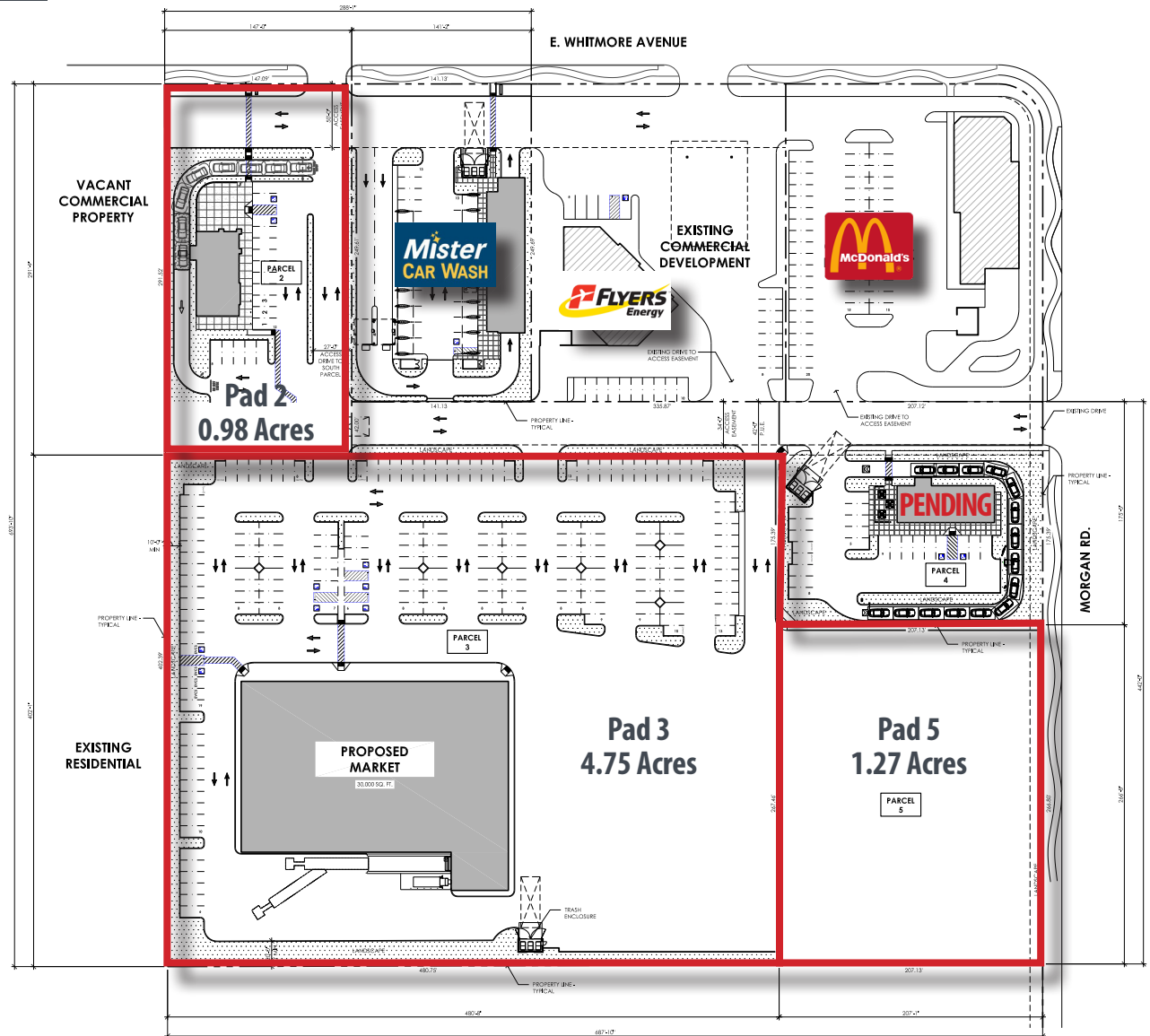

\*Plans deemed to be accurate, but not guaranteed. Plan not to scale.



# Retail Development Available For Sale or Lease

## Aerial Map

SWC Whitmore & Morgan - Ceres, CA



Demographics	1 Mile	3 Mile	5 Mile
Total Population	13,530	94,222	176,793
Total Households	3,510	25,530	53,479
Average Household Income	\$94,890	\$86,534	\$92,184
Median Household Income	\$78,418	\$70,629	\$75,289