

**AVISON  
YOUNG**

# Mercury Plaza Shopping Center

1002 Dr. Martin Luther King Jr. Boulevard | Murfreesboro, Tennessee



---

**2,000 - 31,700-sf retail space available**

**Adam Dennis**  
Senior Associate  
+1 615 869 9560  
[adam.dennis@avisonyoung.com](mailto:adam.dennis@avisonyoung.com)

**Amanda Hayes**  
Associate  
+1 929 386 4026  
[amanda.hayes@avisonyoung.com](mailto:amanda.hayes@avisonyoung.com)

# Area overview

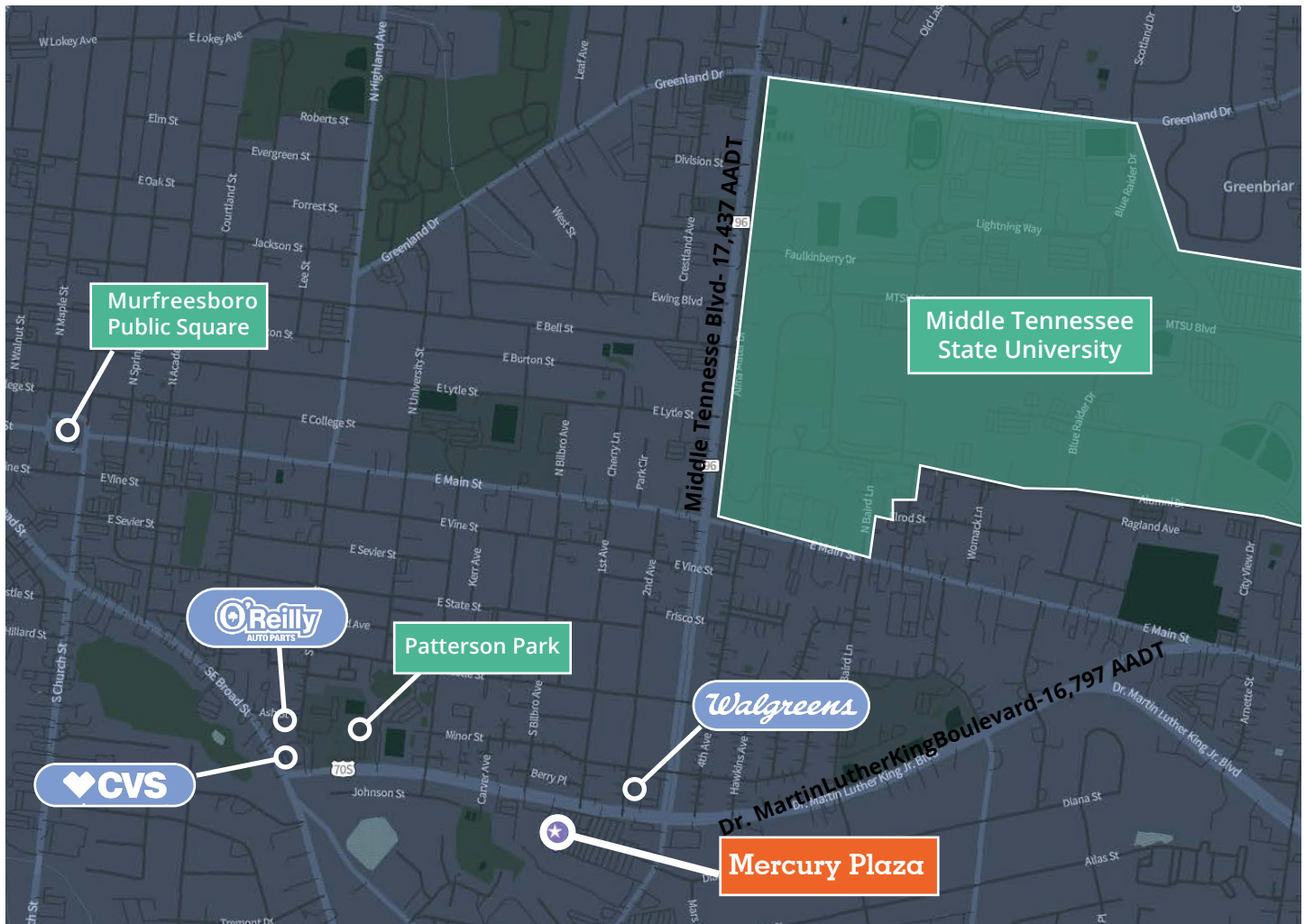

## HIGHLIGHTS

**Size** 2,000 - 31,700 sf available

**Details** Available suites in shopping center

## Area

Located in the geographic center of Tennessee and just 15 miles southeast of Nashville, Rutherford County is the sixth-largest county in the state. Mercury Plaza is located on a prominent corner location at Middle Tennessee Boulevard and Dr. Martin Luther King Jr. Boulevard.



Located less than one mile from MTSU with over 21,000 students



Heavy retail trade area with national retailers



Allows for multiple types of uses including retail, medical, office, and F&B / drive-thru available



High-traffic corridor with over 25,000 VPD



# Site plan

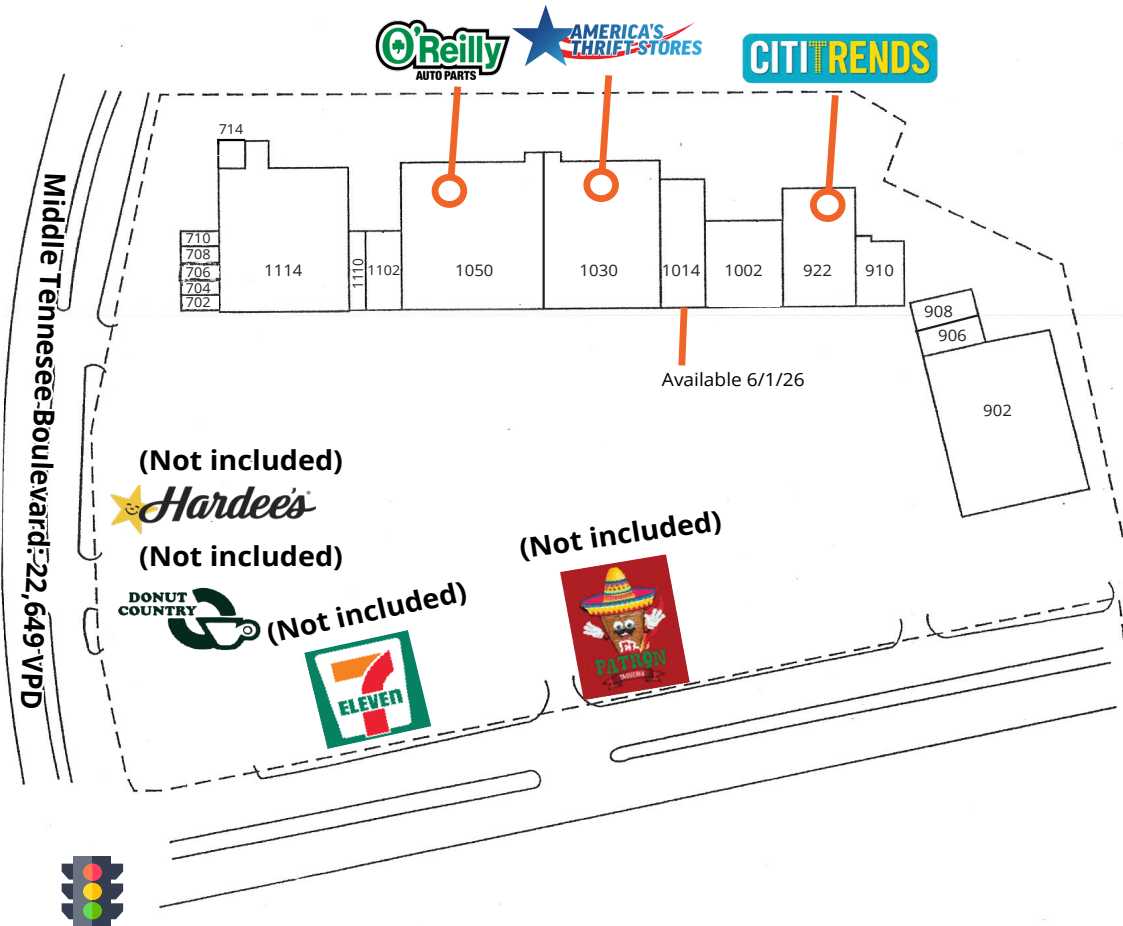

# Suite 1114

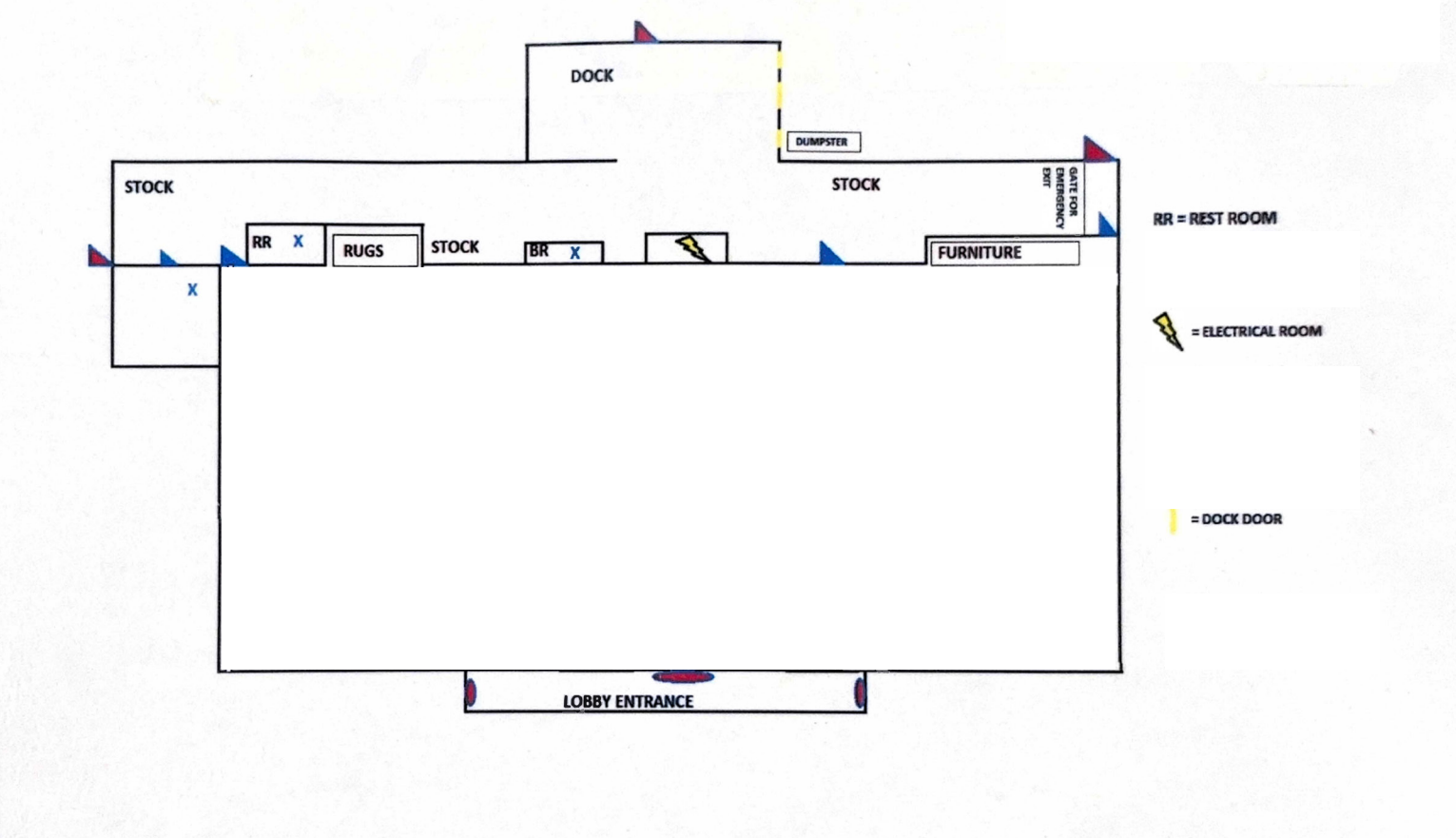

# Availability

Suite	Tenant	sf
702	Alo Michoacana	1,000
704	Lei's Nails	1,000
706	TreeHouse Vape Shop	1,000
708	Valencia Insurance	1,000
710	Cricket Wireless	1,000
714	Available	3,400
902	Under contract	34,560
906	Bella Flory La Chapincita	2,400
908	Barber School and Company	2,800
910	KCI Beauty Supply	4,400
922	CitiTrends	12,600
1002	Available	7,000
1014	Cabinet Brokers	11,990
1030	America's Thrift Store	30,000
1050	O'Reilly Auto Parts	30,000
1102	Lotus Hall	5,000
1110	Available	2,000
1114	Available	31,700

Available 6/1/26

# AVISON YOUNG

**Learn more**

**Adam Dennis**

Senior Associate

+1 615 727 0003

[adam.dennis@avisonyoung.com](mailto:adam.dennis@avisonyoung.com)

**Amanda Hayes**

Associate

+1 929 386 4026

[amanda.hayes@avisonyoung.com](mailto:amanda.hayes@avisonyoung.com)

©2026 Avison Young – Tennessee, LLC. All rights reserved.

E. & O.E.: The information contained herein was obtained from sources which we deem reliable and, while thought to be correct, is not guaranteed by Avison Young.

700 12th Avenue South | Suite 200 | Nashville, TN 37203