

# CLOCK TOWER CONDOMINIUMS

A.P. 54, LOT 897  
RANDALL ST. GEORGE ST. & DELANEY ST.  
PAWTUCKET, RHODE ISLAND  
APRIL, 2016

## INDEX SHEET:

SHEET 1      CLOCK TOWER CONDOMINIUMS - LAND UNITS

### CONDOMINIUM PLAT CERTIFICATION

I HEREBY CERTIFY THAT THIS CONDOMINIUM PLAT CONTAINS THE PLAT  
INFORMATION REQUIRED BY R.I. GENERAL LAW 34-36 § 2-2.09

  
RICHARD S. LIPSITZ  
WATERMAN ENGINEERING COMPANY

4/20/2016

ID HOLDINGS LLC, A RHODE ISLAND LIMITED LIABILITY COMPANY, DECLARANT OF CLOCK TOWER  
CONDOMINIUMS, CONSENTS TO THE RECORDATION OF THIS CONDOMINIUM PLAT IN THE PAWTUCKET,  
RHODE ISLAND LAND EVIDENCE RECORDS IN WITNESS WHEREOF SAID DECLARANT HAS CAUSED THESE  
PRESENTS, TO BE EXECUTED THIS      DAY OF      A.D. 2016.

STATE OF \_\_\_\_\_  
COUNTY OF \_\_\_\_\_

ON THIS      DAY OF      2016 BEFORE ME, THE UNDERSIGNED NOTARY PUBLIC,  
PERSONALLY APPEARED ALIA A. FADILI, AS MANAGER OF ID HOLDINGS LLC, PROVED TO THE NOTARY THROUGH  
SATISFACTORY EVIDENCE OF IDENTIFICATION, WHICH WAS PHOTOGRAPHIC IDENTIFICATION WITH SIGNATURE  
ISSUED BY A FEDERAL OR STATE GOVERNMENTAL AGENCY, OATH OR AFFIRMATION OF A CREDIBLE WITNESS  
PERSONAL KNOWLEDGE OF THE UNDERSIGNED, WHOSE NAME IS SIGNED ON THE PRECEDING OR ATTACHED  
DOCUMENT, AND ACKNOWLEDGED TO ME THAT HE SIGNED IT VOLUNTARILY FOR ITS STATED PURPOSE AS MANAGER  
OF ID HOLDINGS LLC.

NOTARY PUBLIC

PRINTED NAME: \_\_\_\_\_

MY COMMISSION EXPIRES: \_\_\_\_\_

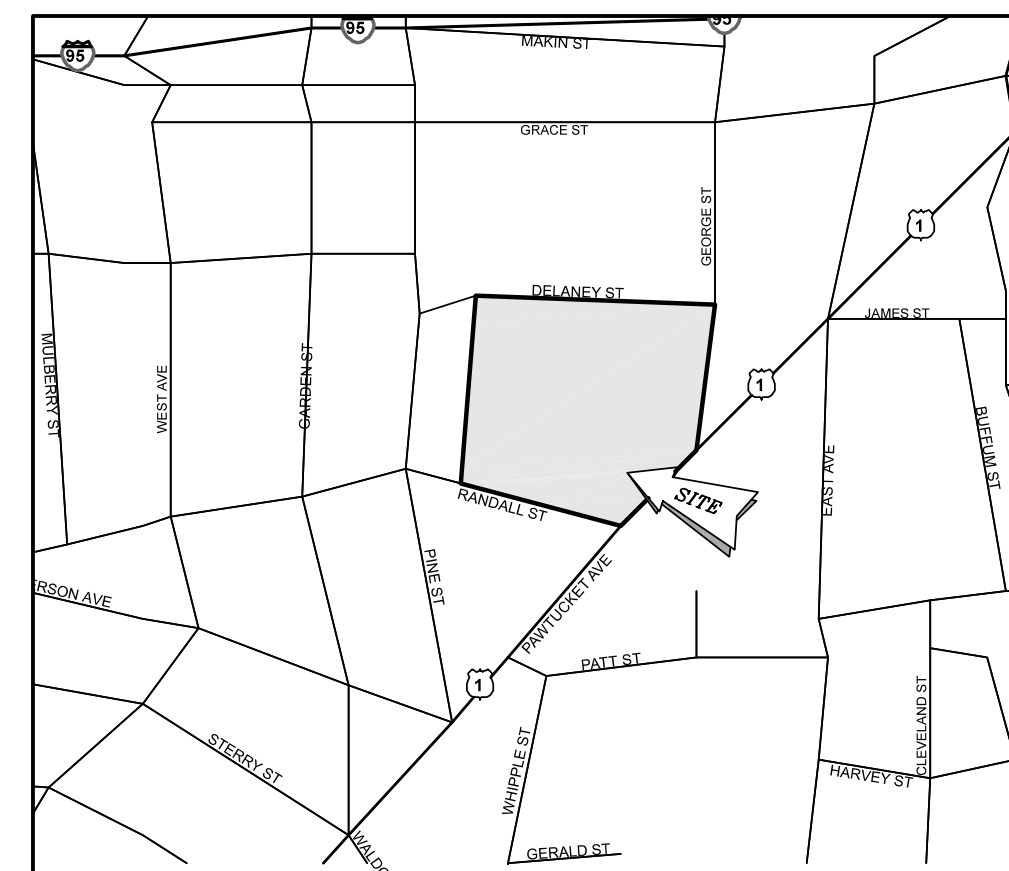
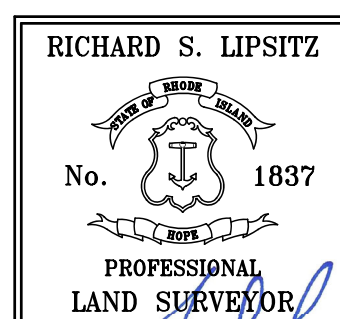

LOCATION MAP

OWNER: ID HOLDINGS LLC  
169 GEORGE STREET  
PAWTUCKET, RHODE ISLAND 02860

COPYRIGHT



THESE DRAWINGS ARE THE PROPERTY OF THE  
ENGINEER SURVEYOR AND HAVE BEEN PREPARED  
FOR THE OWNER, FOR THIS PROJECT AT THIS SITE  
AND ARE NOT TO BE USED FOR ANY OTHER  
PURPOSE, LOCATION OR OWNER WITHOUT WRITTEN  
CONSENT OF THIS OWNER OR ONE OF ITS  
DIRECTORS.

WATERMAN ENGINEERING CO.  
CIVIL ENGINEERS & SURVEYORS  
46 SUTTON AVENUE  
EAST PROVIDENCE, RI 02914-2096

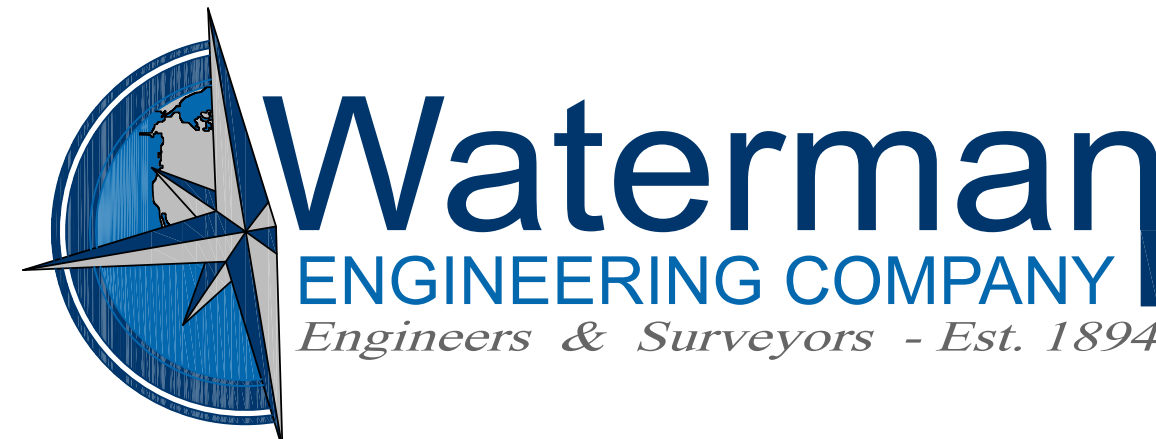

46 Sutton Avenue  
East Providence, RI  
Phone: (401) - 438 - 5775  
Fax: (401) - 438 - 5773  
www.watermanengineering.net



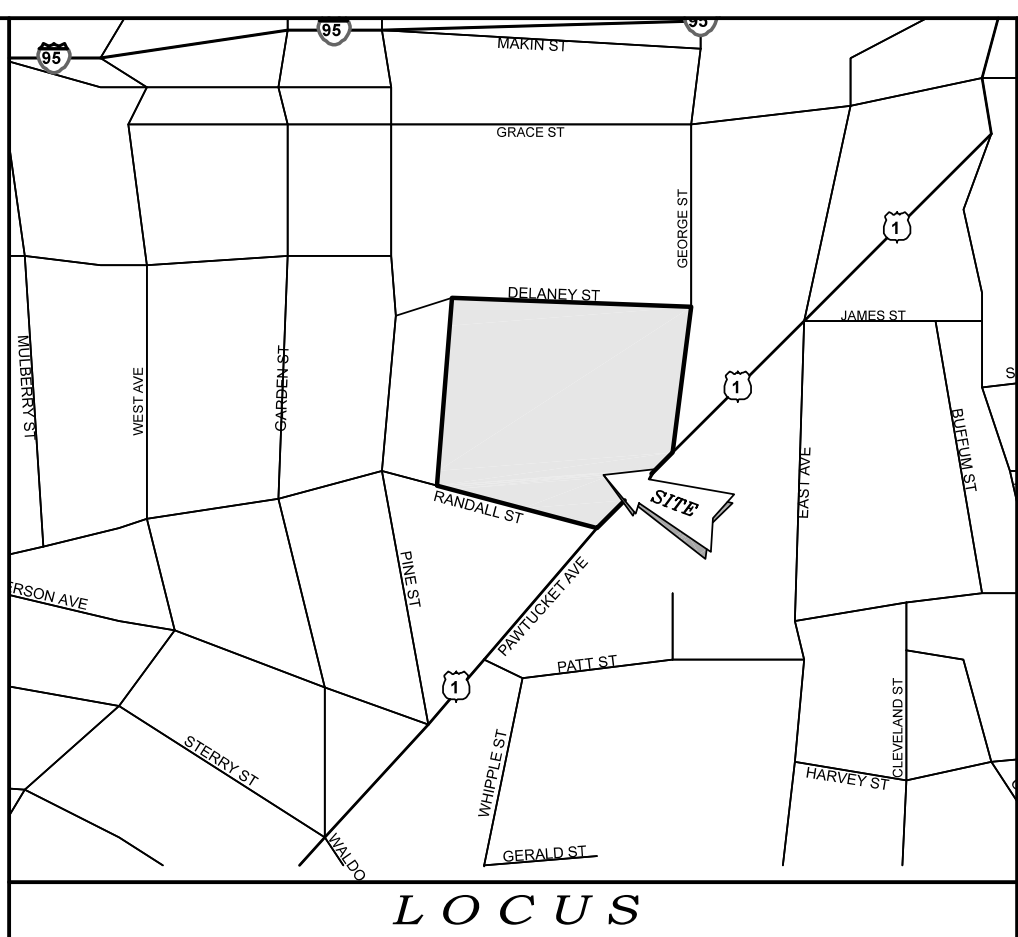

1. REFERENCE IS MADE TO THE FOLLOWING MAPS AND PLANS OF RECORD:

- \*\* SIGNATURES MUST BE IN BLUE INK  
TO CONSTITUTE AN ORIGINAL PLAN**

THIS SURVEY AND PLAN CONFORM TO THE FOLLOWING CLASS STANDARDS AS ADOPTED BY THE RHODE ISLAND BOARD OF REGISTRATION FOR PROFESSIONAL LAND SURVEYORS, EFFECTIVE APRIL 1, 1994.

BOUNDARY SURVEY - CLASS I  
TOPOGRAPHIC SURVEY - CLASS III (F.F. ELEVATIONS ONLY)

	1837	4/20/2016
RICHARD S. LIPSITZ	REG. NO.	DATE
WATERMAN ENGINEERING COMPANY		

NO.	DATE	REVISION			CHECKED BY
<p><i>CLOCK TOWER CONDOMINIUMS</i>  <i>A.P. 54, LOT 897</i>  <i>RANDALL ST., GEORGE ST. &amp; DELANEY ST.</i>  <i>PAWTUCKET, RHODE ISLAND</i>  <i>PAWTUCKET, RHODE ISLAND</i></p>					
<p>PROJECT NO: <i>12-052</i>  SCALE: <i>1" = 20'</i>  DATE: <i>02/22/16</i>  DRAWN BY: <i>BJT/MS</i></p>					
<p>CHECKED BY: <i>RSL</i></p>					
<p>FILENAME: <i>12-052_CP_LAND_ONLY</i>  <i>1</i> of <i>1</i> SHTS  DRAWING # <i>CPI</i></p>					

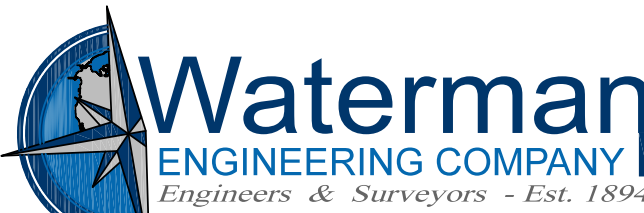

46 Sutton Avenue  
East Providence, RI  
Phone: (401) - 438 - 5775  
Fax: (401) - 438 - 5773  
[www.watermanengineering.net](http://www.watermanengineering.net)

*RIGL 34-13-1*  
*TING STREET INDEX*

1. RANDALL STREET
2. GEORGE STREET
3. DELANEY STREET

NF	- NOW OR FORMERLY	_____	- PROPERTY LINE
A.P.	- ASSESSORS PLAT	_____	- ZONING SETBACK LINE
S.F.	- SQUARE FEET	_____	- EXISTING CONTOUR
A.C.	- ACRES	_____	- NEW CONTOUR
±	- PLUS OR MINUS	○○○○○○○○	- STONE WALL
STY	- STORY	X	- FENCE
WF	- WOOD FRAMED	S	- SEWER LINE
SHP	- STATE HIGHWAY PLAT	D	- DRAIN LINE
RET.	- RETAINING WALL	W	- WATER LINE
PED	- PEDESTRIAN	G	- GAS LINE
(FND)	- FOUND	E	- ELECTRIC LINE
RHB	- RI HIGHWAY BOUND	S	- SANITARY SEWER MANHOLE
PK NAIL	- MASONRY NAIL	C	- CATCH BASIN
FE	- FLARED END	D	- STORM DRAIN MANHOLE
RCV	- REINFORCED CONCRETE PIPE	G	- GAS VALVE
CLF	- CHAIN LINK FENCE	W	- WATER GATE
INP	- INVERT	E	- ELECTRIC MANHOLE
x 10.80	- EXISTING SPOT GRADE	G	- GRANITE BOUND
10.80	- NEW SPOT GRADE	●	- DRILL HOLE

(in feet)

1 INCH EQUALS 20 FEET

*COPYRIGHT*



THESE DRAWINGS ARE THE PROPERTY OF THE ENGINEER/SURVEYOR AND HAVE BEEN PREPARED FOR THE OWNER, FOR THIS PROJECT AT THIS SITE AND ARE NOT TO BE USED FOR ANY OTHER PURPOSE, LOCATION OR OWNER WITHOUT WRITTEN CONSENT OF THIS OWNER OR ONE OF ITS DIRECTORS.