

# 30 East 33rd Street, New York, NY 10016, 12th Fl.

Sublet from current tenant.

**Full Floor Furnished Office**

**8,500 SF**

**Inquire for Rent**

## Property Information

30 East 33rd Street - The Crystal Building

30 East 33rd Street's 8500 SF 12th floor provides multiple amenities that make the space ideal for accountants, attorneys, most service firms and non-profit headquarters:

- Full, light-filled top floor with direct elevator access and 12' ceilings, in a super convenient Midtown location
- Fully-built and furnished space with 15 windowed and carpeted offices, a skylit conference room with flexible configurations for 24-plus meeting participants, a windowed wet pantry, a large open work area with 35 work stations, and storage space
- Multiple fiber providers, central heating, tenant-controlled A/C, operable windows
- 24-hour, 7-day access, security system, and property manager on site
- Steps to the 4, 5, 6, N, Q, R, S, W, and 7 subway lines at Bryant Park and Grand Central, all fewer than 10 minutes away. Penn Station and Port Authority are walkable within 15 minutes.
- Employees at 30 East 33rd Street will appreciate nearby conveniences, such as upscale dining spots, grab-and-go options, and daily shopping amenities.
- For hosting clients or guests, businesses have their pick from a number of renowned hospitality options.

Sublease ending December 31, 2029, is available immediately.

The tenant would also consider subletting all the 12th floor space except the six offices and hallway adjoining the reception area on the north side of the building.

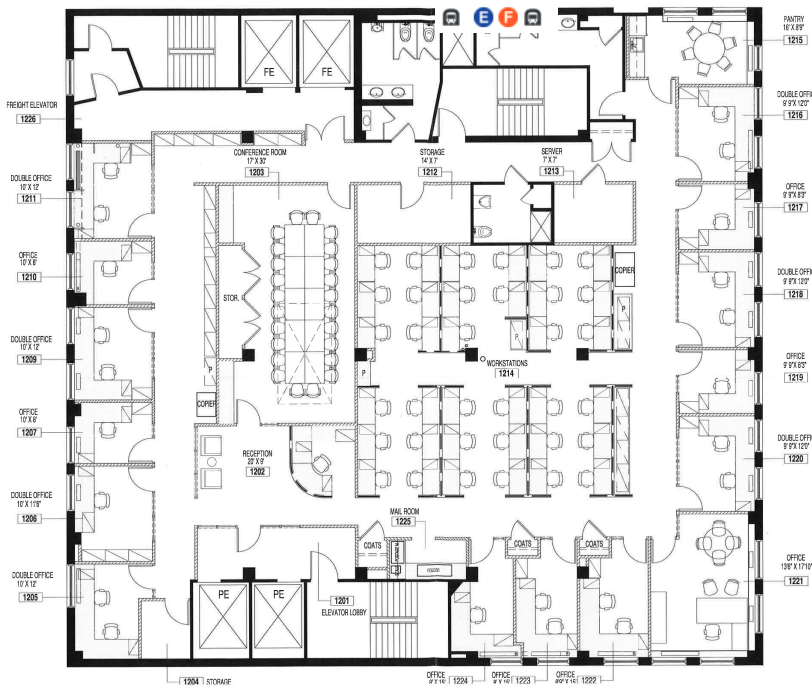

## COMPASS COMMERCIAL

Information contained herein is from sources deemed reliable but is subject to errors, omissions, change of price or terms, and withdrawal without prior notice at any time. (AP/102221)

**Mary Hardin**  
**Lic. Assoc. RE Broker**

10 East 53rd Street New York, NY 10022  
m. 917-575-3444 | o. 646-854-3801  
mary.hardin@compass.com