



**TJ YALDO**  
ASSOCIATE

[tyaldo@cmprealestategroup.com](mailto:tyaldo@cmprealestategroup.com)

**ANDREW ROYE**  
ASSOCIATE

[aroye@cmprealestategroup.com](mailto:aroye@cmprealestategroup.com)

**ANTHONY SESI**  
VICE PRESIDENT

[asesi@cmprealestategroup.com](mailto:asesi@cmprealestategroup.com)

6476 Orchard Lake Road | Suite A | West Bloomfield | Michigan | 48322

Phone: 248.538.2000 | [www.cmprealestategroup.com](http://www.cmprealestategroup.com)

PROPERTY INFORMATION

Property Address	17020-17124 Fort Street
City/Township	Riverview
Building Size	29,843 SF
Space Available	2,014 SF
Minimum Available	1,000 SF
Maximum Available	1,014 SF
Asking Rental Rate	Contact Broker
Estimated NNN's	\$6.00 PSF
Parking	Surface



**POPULATION**  
81,572 PEOPLE



**MEDIAN AGE**  
41.2 YEARS OLD



**HOUSEHOLDS**  
77,760



**CONSUMER SPENDING**  
\$2.5 BILLION ANNUALLY



**AVG HOUSEHOLD INCOME**  
\$77,866/ANNUALLY



**DAYTIME POPULATION**  
65,444 PEOPLE

JOIN



Great Clips®



ATHLETICO  
PHYSICAL THERAPY



AREA TENANTS & EMPLOYERS



Walgreens

PROPERTY HIGHLIGHTS

- Join Starbucks at Riverview Center, a new retail redevelopment positioned on the SWC of Fort Street and Pennsylvania Road.
- The site is surrounded by many big-box retailers operating in the immediate vicinity including Kroger, Lowe's, and Meijer.
- Riverview Center is located within minutes of the I-75 freeway and provides tremendous visibility and accessibility.



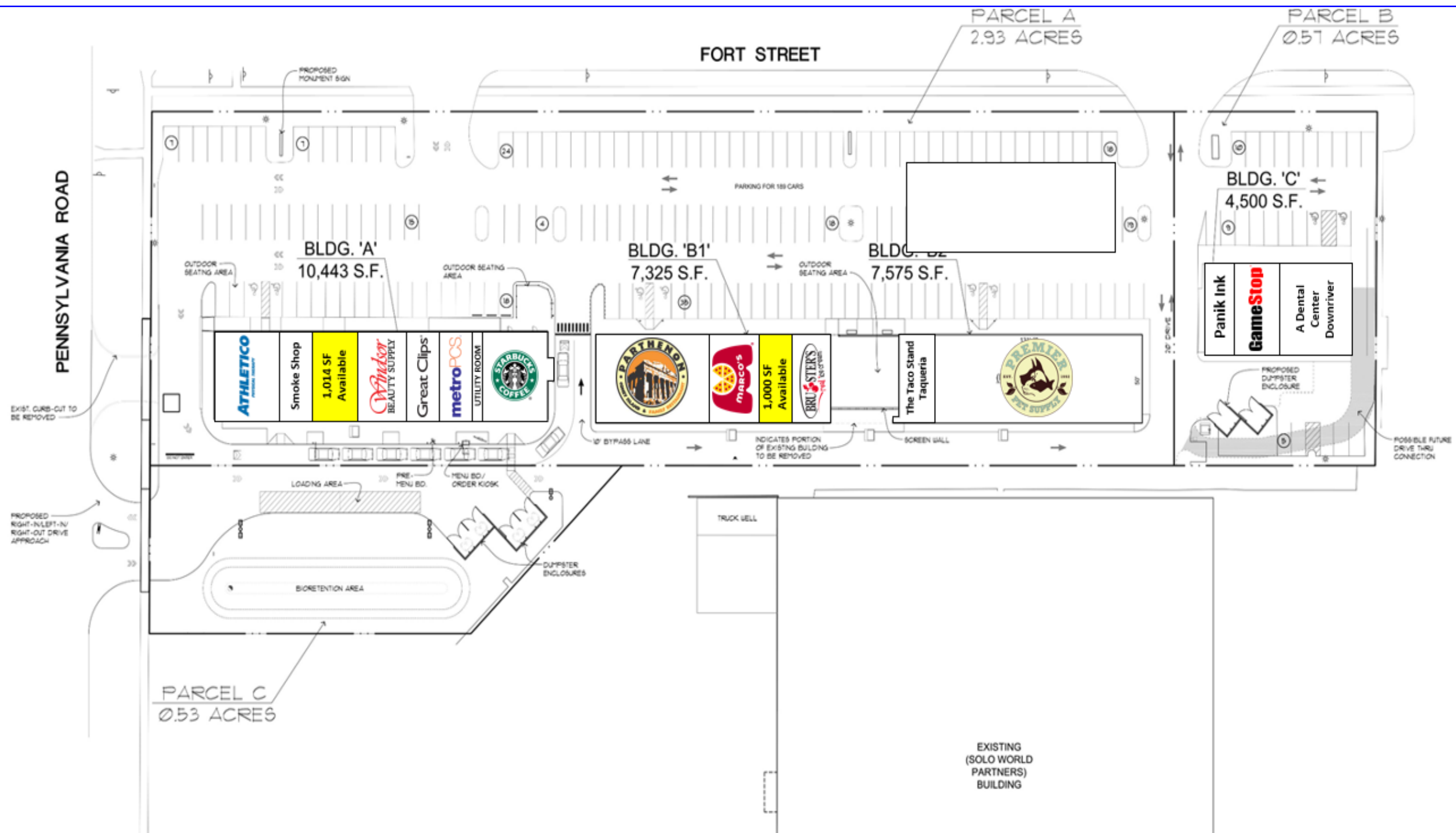









Leroy Street

Trenton Road

Pennsylvania Road

Fort Street





POPULATION	1 MILE	3 MILE	5 MILE
2010 Population	14,618	82,786	188,783
2023 Population	14,249	81,572	189,332
2028 Population Projection	14,381	82,497	192,145
Annual Growth 2010-2023	-0.2%	-0.1%	0%
Annual Growth 2023-2028	0.2%	0.2%	0.3%
Median Age	41.7	42.1	41.2
Bachelor's Degree or Higher	14%	19%	19%

POPULATION BY RACE	1 MILE	3 MILE	5 MILE
White	12,872	74,783	167089
Black	784	3,002	11,962
American Indian/Alaskan Native	89	558	1,317
Asian	233	1,490	4,337
Hawaiian & Pacific Islander	0	4	20
Two or More Races	270	1,735	4,607
Hispanic Origin	1,042	6,410	18,715

HOUSEHOLDS	1 MILE	3 MILE	5 MILE
2010 Households	6,222	34,996	77,432
2023 Households	6,077	34,528	77,760
2028 Household Projection	6,137	34,937	78,949
Owner Occupied Households	3,695	24,439	56,692
Renter Occupied Households	2,442	10,497	22,258
Avg Household Income	\$74,204	\$78,262	\$77,866
Median Household Income	\$61,681	\$62,040	\$61,685

INCOME	1 MILE	3 MILE	5 MILE
\$25,000 - 50,000	1,249	7,637	17,270
\$50,000 - 75,000	1,551	7,143	15,554
\$75,000 - 100,000	762	4,464	9,791
\$100,000 - 125,000	624	3,861	8,497
\$125,000 - 150,000	283	1,789	4,869
\$150,000 - 200,000	305	1,811	4,302
\$200,000+	206	1,585	3,226

DAYTIME EMPLOYMENT	ONE MILE			THREE MILE			FIVE MILE		
	TOTAL EMPLOYEES	TOTAL BUSINESSES	EMPLOYEES PER BUSINESS	TOTAL EMPLOYEES	TOTAL BUSINESSES	EMPLOYEES PER BUSINESS	TOTAL EMPLOYEES	TOTAL BUSINESSES	EMPLOYEES PER BUSINESS
Service-Producing Industries	5,327	424	13	30,310	3,591	8	60,846	6,725	9
Trade Transportation & Utilities	1,511	72	21	4,991	472	11	12,334	1,067	12
Information	51	7	7	638	46	14	990	92	11
Financial Activities	237	57	4	1,927	383	5	3,642	742	5
Professional & Business Services	136	38	4	4,206	339	12	6,565	688	10
Education & Health Services	2,092	141	15	10,181	1,605	6	19,297	2,523	8
Leisure & Hospitality	822	39	21	4,892	302	16	10,007	642	16
Other Services	207	47	4	2,181	359	6	4,937	790	6
Public Administration	271	23	12	1,297	85	15	3,074	181	17
Goods-Producing Industries	119	18	7	2,255	239	9	4,598	486	9
Natural Resources & Mining	0	0	-	2	1	2	69	7	10
Construction	30	9	3	1,001	160	6	1,944	329	6
Manufacturing	89	9	10	1,252	78	16	2,585	150	17
Total	5,446	442	12	32,565	3,830	9	65,444	7,211	9



## EXCLUSIVELY LISTED BY:

**TJ YALDO**

ASSOCIATE

[tyaldo@cmprealestategroup.com](mailto:tyaldo@cmprealestategroup.com)

**ANDREW ROYE**

ASSOCIATE

[aroye@cmprealestategroup.com](mailto:aroye@cmprealestategroup.com)

**ANTHONY SESI**

VICE PRESIDENT

[asesi@cmprealestategroup.com](mailto:asesi@cmprealestategroup.com)

## CONTACT US:



6476 Orchard Lake Road, Suite A  
West Bloomfield, Michigan 48322



(P): 248.538.2000  
(F): 248.538.9905



Email: [info@cmprealestategroup.com](mailto:info@cmprealestategroup.com)  
Website: [www.cmprealestategroup.com](http://www.cmprealestategroup.com)

The information contained in this Marketing Package does not purport to provide a complete or fully accurate summary of the Property or any of the documents related thereto, nor does it purport to all inclusive or to contain all the information, which a potential tenant may need or desire. All information contained herein has been secured by sources we believe to be reliable; however, CMP Real Estate Group, LLC ("Broker") has not independently verified any of the information. This Marketing Package prepared by Broker, does not constitute an indication that there has been no change in the Property or the market conditions since the date of preparation of the information herein. Additional information and an opportunity to inspect the Property will be made available to the interested and qualified prospective tenant/purchaser, if available.

Neither Owner nor Broker nor any of there respective officers, Agents or principals has made or will make any representations or warranties, express or implied, as to the accuracy or completeness of this Marketing Package or any of its contents, and no legal commitment or obligation shall arise by reason of the Marketing Package or its contents. Analysis and verification of the information contained in the Marketing Package is solely the responsibility of the prospective tenant/purchaser.

Owner and Broker expressly reserve the right, at their sole discretion, to reject any or all expressions of interest or offers to lease/purchase the Property and/or terminate discussions with any entity at anytime with or without notice. Owner has no legal commitment or obligation to any entity reviewing this Marketing Package or making an offer to lease/purchase the Property unless and until such lease/sale of the Property is approved by Owner in its sole discretion, a written agreement for lease/purchase of the Property unless and until such sale of the Property is approved by Owner in its sole discretion, a written agreement for leased/purchase of the Property has been fully delivered, and approve by Owner, its legal counsel and any conditions to the Owner's obligations thereunder have been satisfied or waived.



**RETAIL LEASING**

*Landlord Representation  
& New Project Leasing*



**TENANT REPRESENTATION**

*Site Selection &  
Negotiations*



**INVESTMENT SALES**

*STNL & Multi-Tenant, Multi-  
Family, Carwashes, etc.*



**ACQUISITIONS/DISPOSITIONS**

*Single & Full Portfolio  
Transactions*



**MARKET ANALYSIS**

*Market Research  
& Site Evaluations*



**NATIONAL RELATIONSHIPS**

*Retailers & Investors  
across the U.S.*



**TEAMWORK**

*Innovative  
Solutions*



**SHARED DATABASE**

*Retailers & Investors  
across the U.S.*