

40,043 Sq. Ft.
FOR LEASE

VOIT LA MIRADA DISTRIBUTION CENTER

14385 INDUSTRY CIRCLE | LA MIRADA, CA 90638



EXTENSIVE RENOVATION: New ESFR Sprinkler System, LED Lighting, Office, and Restrooms

HAYDEN SOCCI, SIOR, CCIM
Senior Vice President, Partner
P 714.935.2379
hsocci@voitco.com
Lic # 01705038

PETER CASTLETON
Executive Vice President, Partner
P 714.935.2353
pcastleton@voitco.com
Lic # 00908641

Voit
REAL ESTATE SERVICES



**±40,043
Total Sq. Ft.**



**±1,200 Sq. Ft. of
NEW Office Space**



**Extensive
Building Renovations**



**NEW LED
Lighting**



**NEW ESFR Sprinkler
System Upgrade**

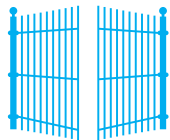

Fenced Yard

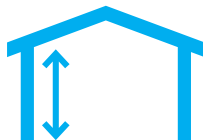

**28' Warehouse
Clearance**



**Excellent
Distribution Space**

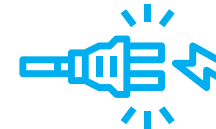

**4,000 Amps, 480 Volt,
3-Phase (verify)**

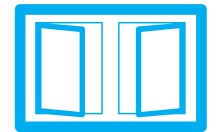

Skylights



**4 Dock High Doors
1 Ground Level
Loading Door**



**Rail Served
(Union Pacific)**



**Easy Access to
Major Freeways
(5, 91, 605)**



**Access to
Ports**



**Low Nets
(±\$0.22 PSF)**

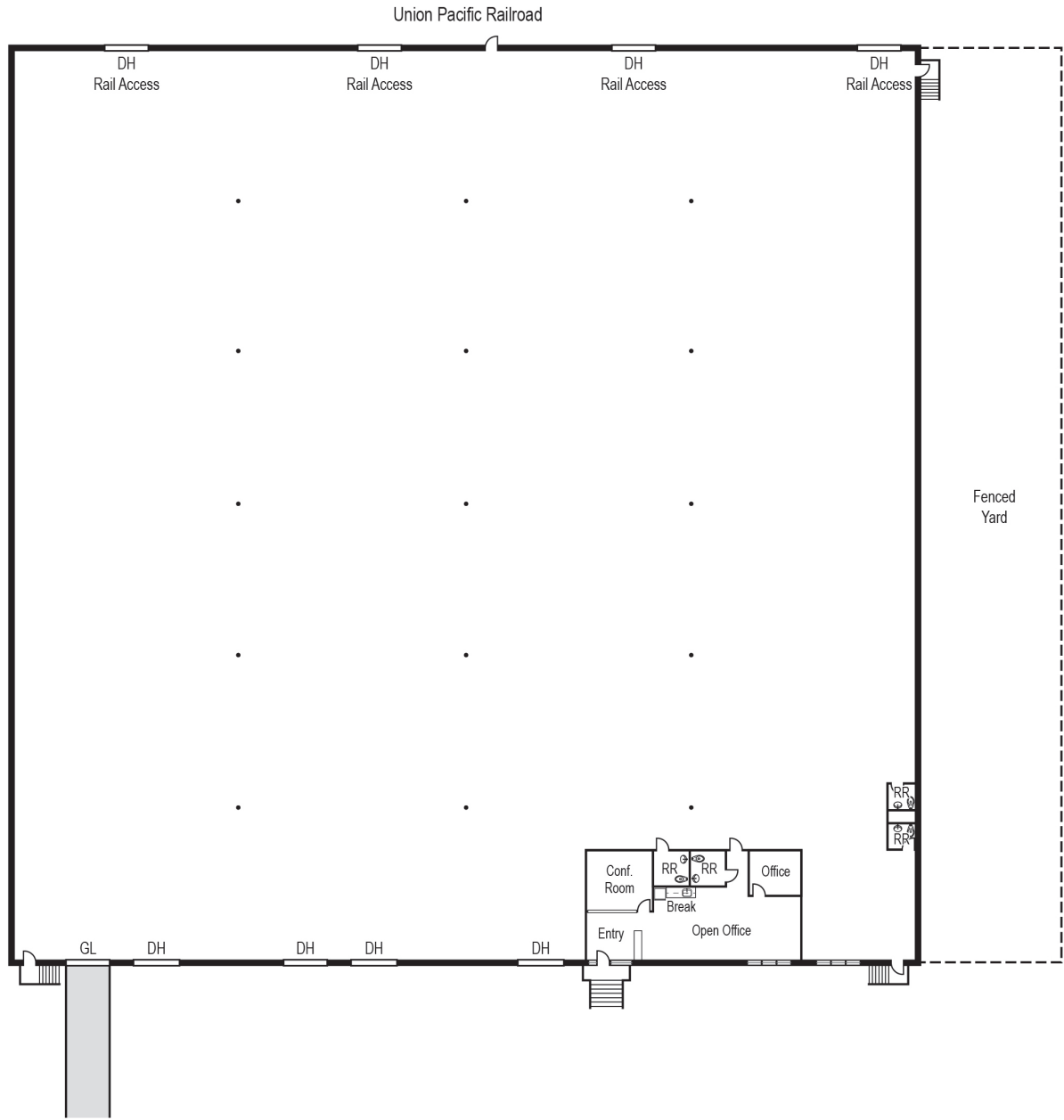

FLOOR PLAN

**Please Note: Plan is approximate, not to scale, and is subject to change.*

SITE PLAN

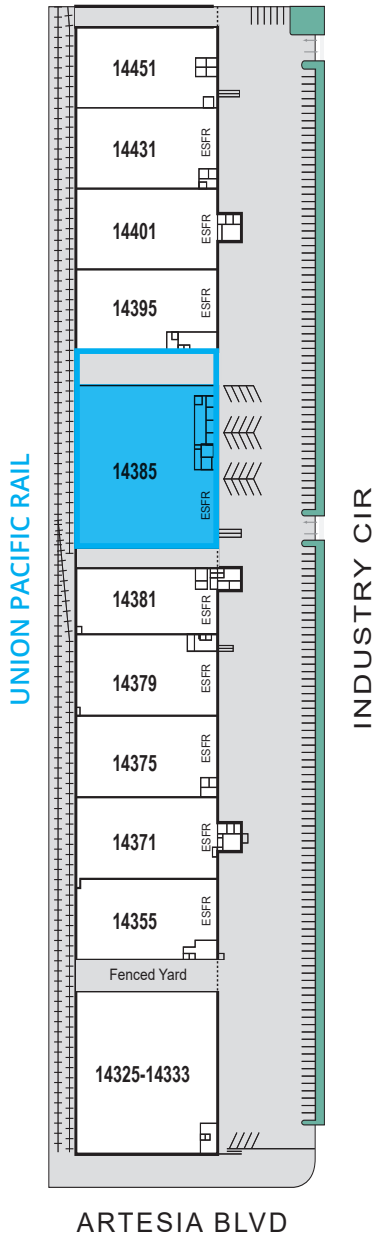

ARTESIA BLVD

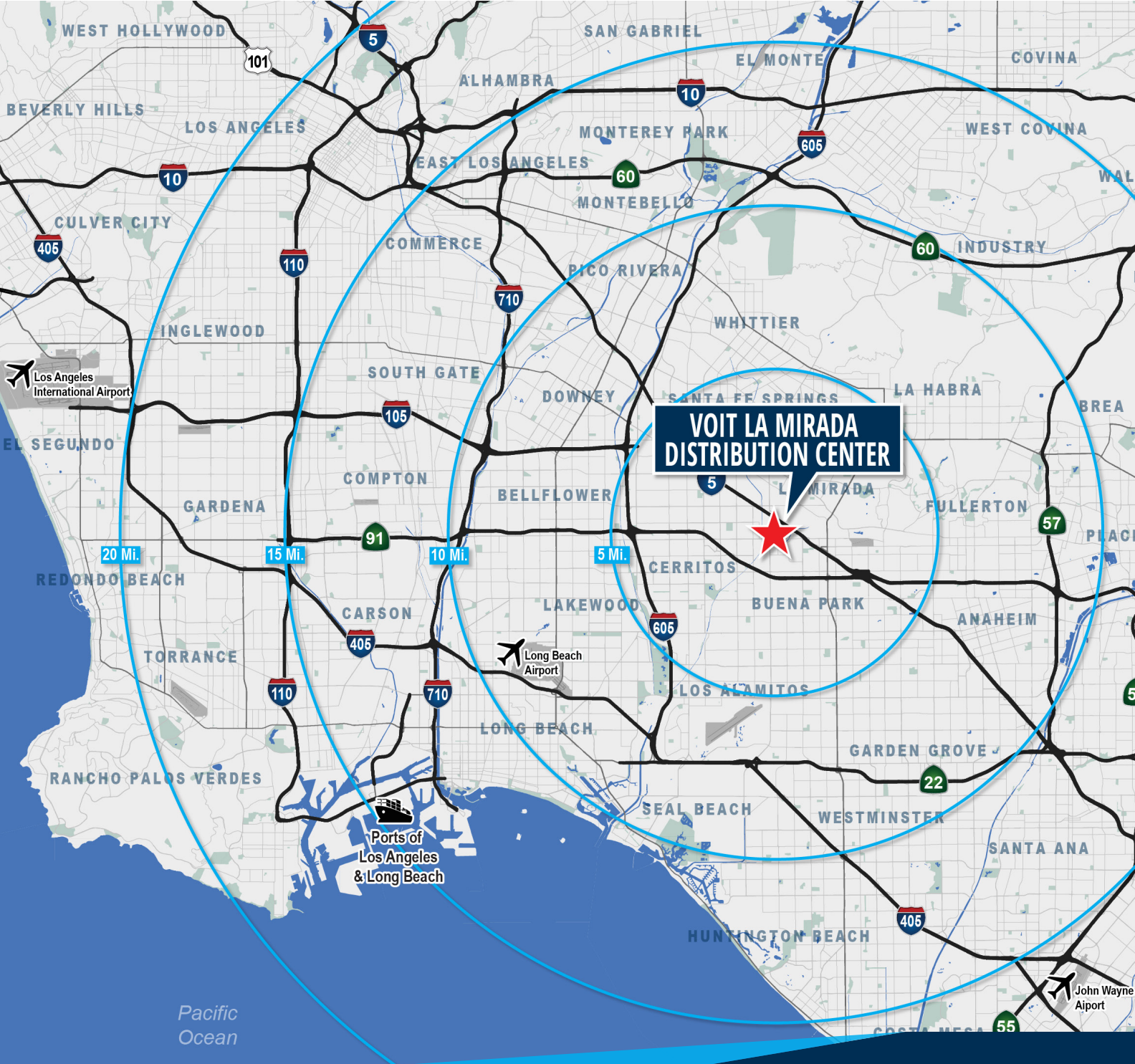

KEY DRIVE DISTANCES



±22.4 MILES
PORT OF LOS ANGELES

±21.0 MILES
PORT OF LONG BEACH



±26. MILES
LOS ANGELES
INTERNATIONAL AIRPORT

±11.0 MILES
LONG BEACH AIRPORT

±21.2 MILES
ORANGE COUNTY
JOHN WAYNE AIRPORT



±0.8 MILES
CA-5 FREEWAY

±1.7 MILES
CA-91 FREEWAY

±4.6 MILES
CA-605 FREEWAY

SITE ACCESS



**VOIT LA MIRADA
DISTRIBUTION CENTER**

FOR LEASE

14385 INDUSTRY CIRCLE | LA MIRADA, CA 90638

Voit

REAL ESTATE SERVICES

2400 E. Katella Ave., Suite 750, Anaheim, CA 92806
714.978.7880 • 714.978.0431 Fax • www.VoitCo.com

Licensed as Real Estate Salespersons by the DRE. The information contained herein has been obtained from sources we deem reliable. While we have no reason to doubt its accuracy, we do not guarantee it. ©2025 Voit Real Estate Services, Inc. All Rights Reserved. Lic. #01991785

HAYDEN SOCCI, SIOR, CCIM
Senior Vice President, Partner
P 714.935.2379
hsocci@voitco.com
Lic # 01705038

PETER CASTLETON
Executive Vice President, Partner
P 714.935.2353
pcastleton@voitco.com
Lic # 00908641