

# LINEBAUGH DISTRIBUTION CENTER



FOR LEASE – 20,351 SF of Fully Air-Conditioned Space + Dock High & Grade Level Loading  
5650 W Linebaugh Ave, Tampa, FL 33624 (SUITES A + B)

CLASS A NEW CONSTRUCTION WAREHOUSE – TAMPA AIRPORT

Robbie Lober  
Managing Member  
727 - 999 - 1806  
[Robbie@LoberRealEstate.com](mailto:Robbie@LoberRealEstate.com)

**LOBER**  
REAL ESTATE

# Property Overview

Google Maps Link: [Click Link Here!](#)

Address: 5650 W Linebaugh Ave  
Tampa, FL 33624 (Suites A + B)

Total Available: 20,351 SF

Park Size: 73,934 total in two (2) buildings

Available: April 1, 2026

Loading: 2 oversized drive-in doors (12'x14')  
3 dock high doors

Power: 600 amps 480 Volt 3 Phase

Clear Height: 24 ft

Zoning: "M" – Manufacturing, per Hillsborough County permitted uses

Submarket: Tampa Airport

Parking: 1.14/ 1,000

Lights + Sprinklers: LED Lights + ESFR Sprinklers

Air Condition: 100% Fully AC'd space

Location: Less than 5 miles to TIA, SR 589, I-275, and FL 60

## FLOOR PLAN

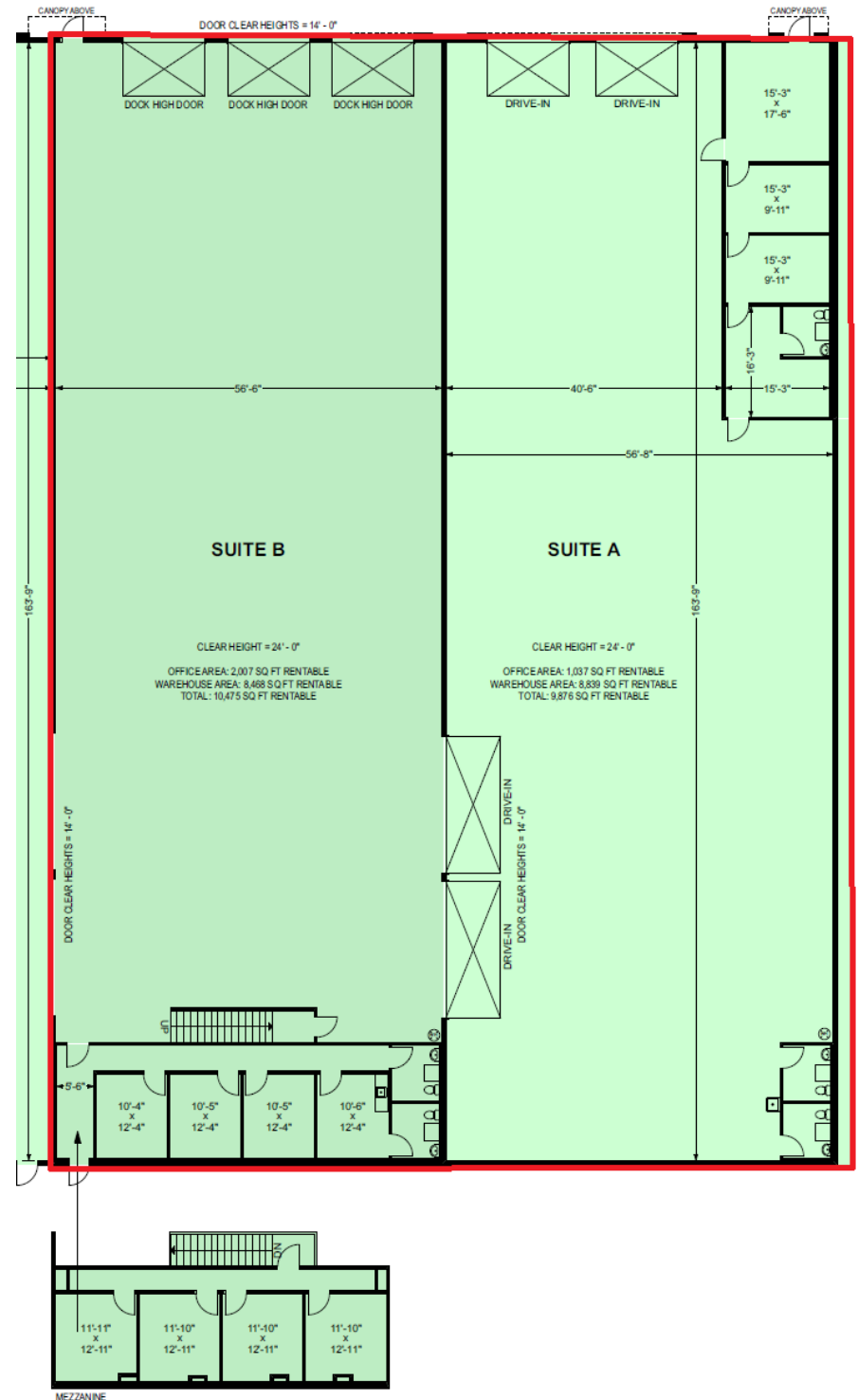



# Quick Access to TIA, I-275, I-4, SR 589, FL60, and Port of Tampa

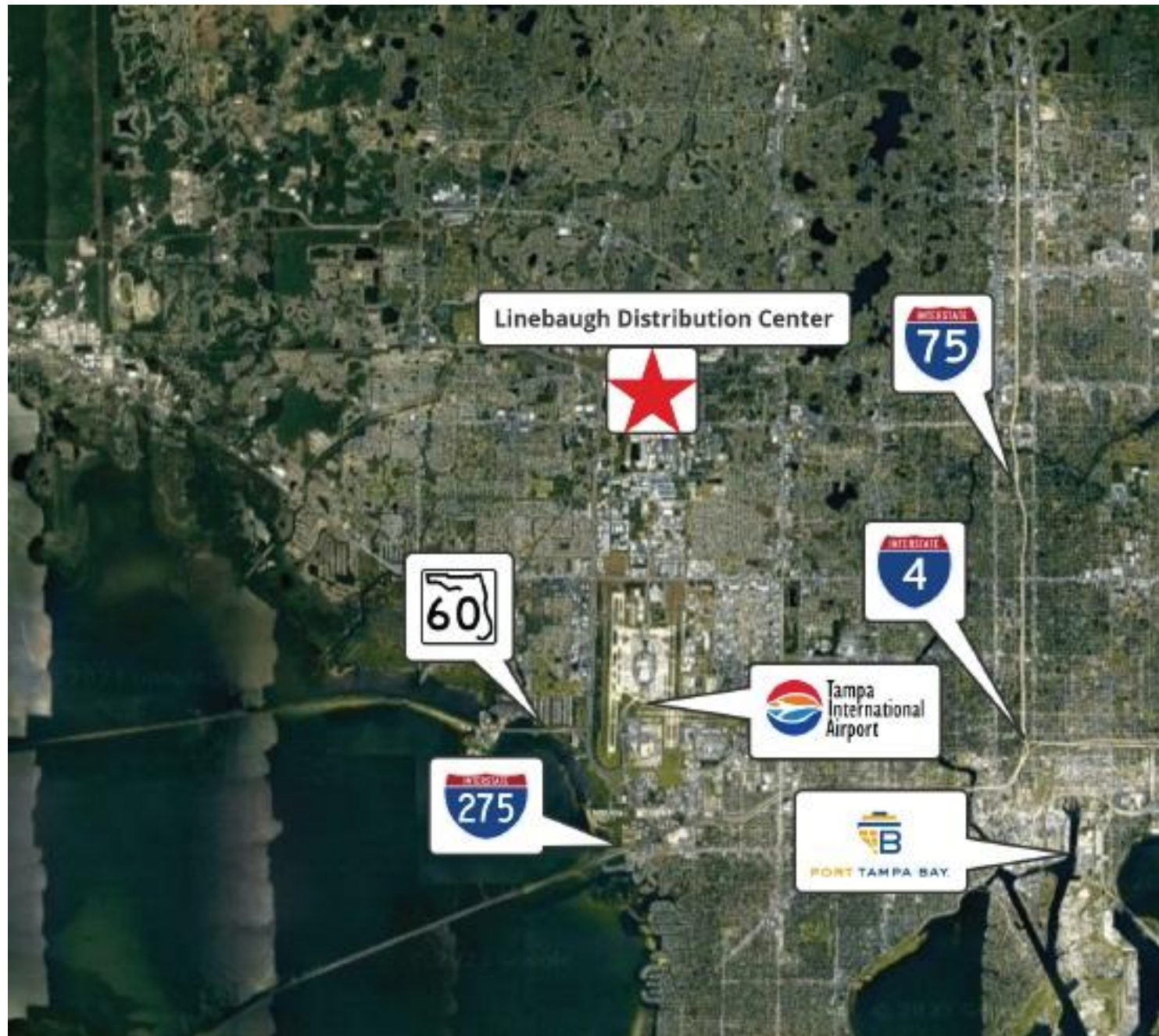



# Photos

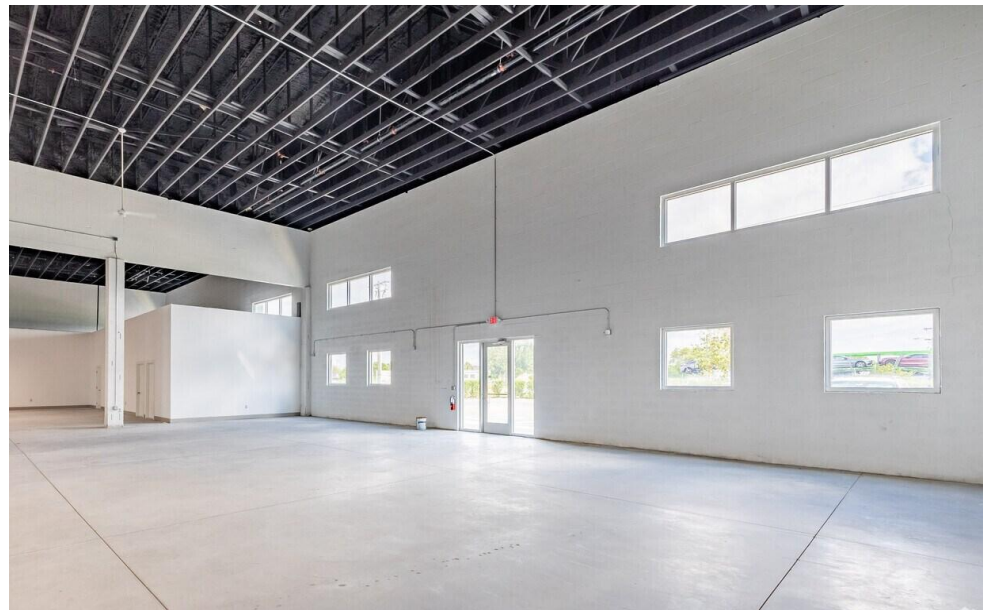
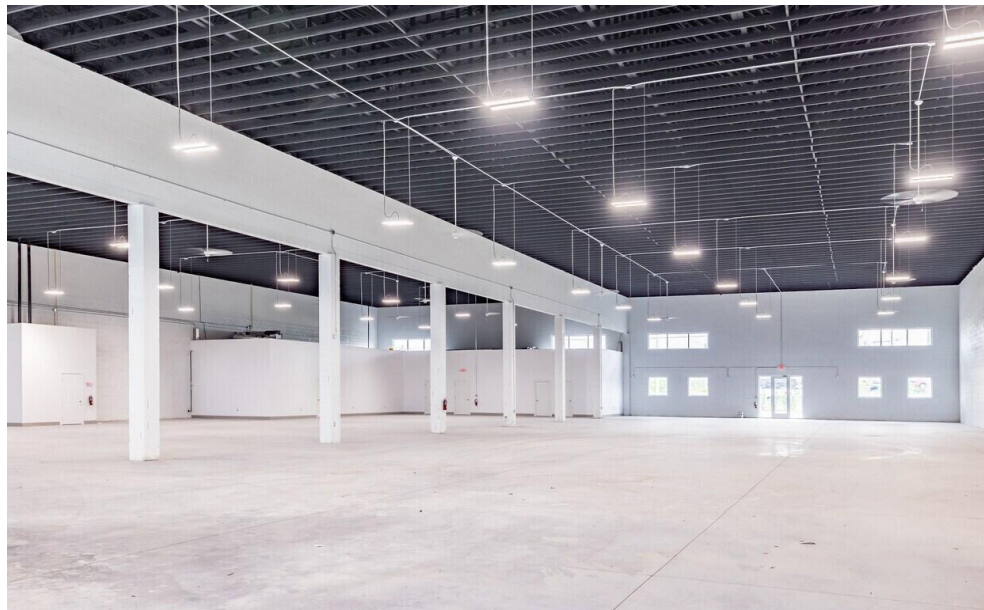



**AVAILABLE**



Contact for pricing and more info:

Robbie Lober  
Managing Member  
727 - 999 - 1806  
Robbie@LoberRealEstate.com

**LOBER**  
REAL ESTATE

The information contained in this document has been obtained from sources believed reliable. While Lober Real Estate LLC does not doubt its accuracy, Lober Real Estate LLC has not verified it and makes no guarantee, warranty, or representation about it. It is your responsibility to independently confirm its accuracy and completeness. Any projections, opinions, assumptions, or estimates used are for example only and do not represent the current or future performance of the property. The value of this transaction to you depends on tax and other factors which should be evaluated by your tax, financial, and legal advisors. You and your advisors should conduct a careful, independent investigation of the property to determine to your satisfaction the suitability of the property for your needs.