



**CANNIZZARO**  
REALTY

# 3 DESIREABLE STOREFRONTS

IN THE HEART OF FISHERMAN'S WHARF

269 JEFFERSON ST 1,000 SF (20'w x50'd)

275 JEFFERSON ST 1,000 SF (20'w x50'd)

281 JEFFERSON ST 1,000 SF (20'w x50'd)

275 JEFFERSON ST AND 281 JEFFERSON ST  
CAN BE COMBINED TO ONE 2,000 SF SPACE



275 JEFFERSON ST



269 JEFFERSON ST



281 JEFFERSON ST

# IN THE HEART OF SAN FRANCISCO'S FISHERMAN'S WHARF



- 3,000 SF RETAIL IN HEART OF FISHERMAN'S WHARF
- 1/2 BLOCK FROM F-LINE & E-LINE STREET CAR STOP
- ACROSS THE STREET FROM HISTORIC FISHING FLEET
- STEPS FROM FISHERMAN'S WHARF CRAB WHEEL SIGN

# INVESTMENT HIGHLIGHTS

- ESTIMATED 16 MILLION ANNUAL VISITORS, 35% BAY AREA RESIDENTS
- VISITORS AVERAGE HOUSEHOLD INCOME OVER \$91,503
- 13 HOTELS WITH OVER 3200 GUEST ROOMS
- ANNUAL CELEBRATIONS: FLEET WEEK, INDEPENDENCE DAY FIREWORKS AND WHARF FEST

## FLOOR PLAN

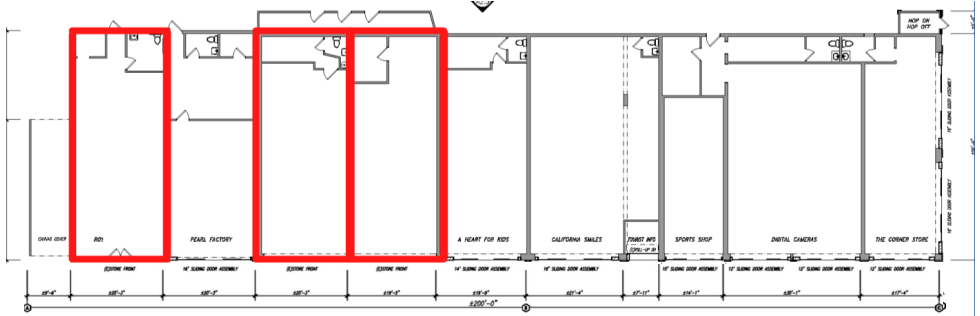

John Cannizzaro | Lic 01898995 | 415.795.2360  
John@cannizzaro-realty.com