

AVAILABLE Q3 2025

200 NEWBURY STREET

Boston, Massachusetts



5,371 SF AVAILABLE

BUILDING FEATURES

- Located on the corner of Newbury and Exeter Streets
- Newbury Street facing window line with balcony
- Hourly parking in the building
- Easy access to Green Line and Back Bay MBTA Station



5,371 RSF AVAILABLE FOR LEASE

200 NEWBURY STREET

Boston, Massachusetts

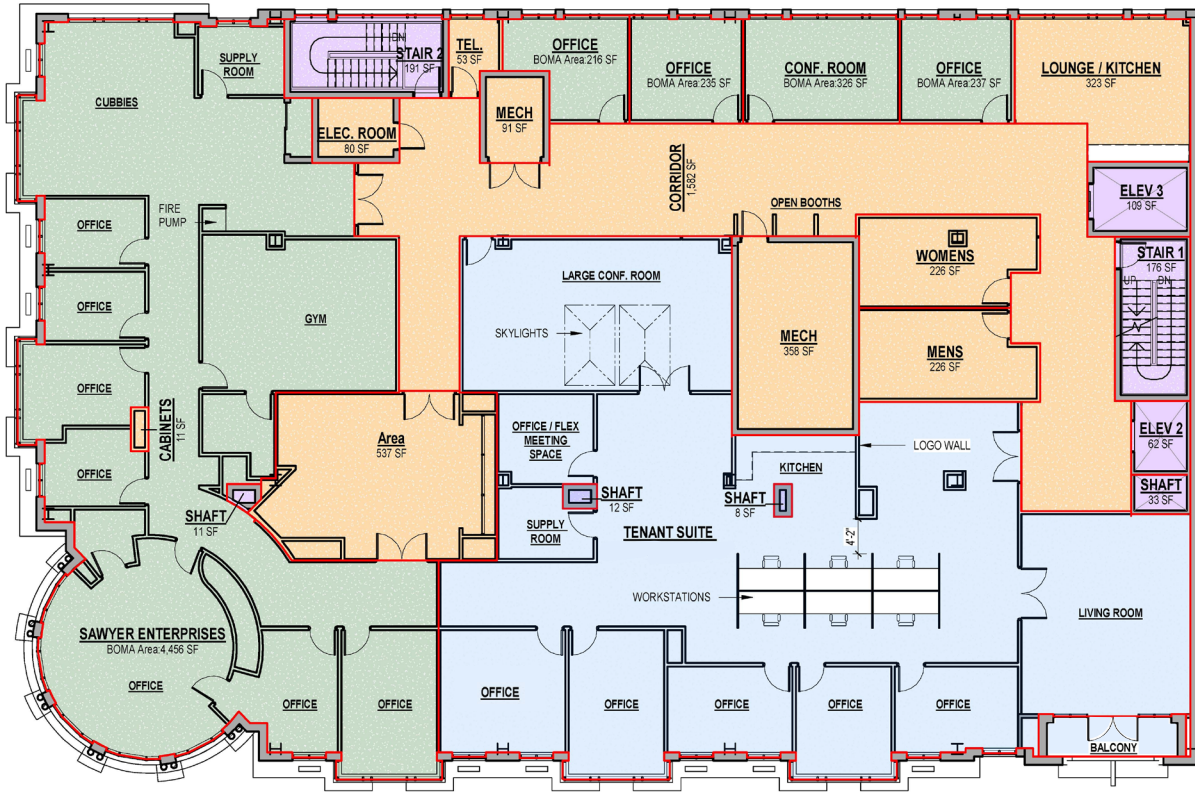

RENDERINGS



For more information, please contact:

PETER BEAN
781.771.7715 | pbean@hunnemanre.com



@2024 Hunneman. All rights reserved. All information has been obtained from sources believed reliable but no warranty or representation is verified for accuracy or completeness. Caution and independent investigation of property and information should be verified. Reliance on this information is at your own risk.