



KELLER WILLIAMS® REALTY

FOR SUBLEASE – ±12,474 SF
525 W TERRACE Dr.
SAN DIMAS CA



Highlights

- 1 Dock / 1 GL / ±1,850 SF office
- Short term until 12/2024
- 18' minimum clear height
- Ample parking
- Immediate access to CA-57
- Sublease rate \$0.99 / PSF



John Lee
626.433.3353
realtorjohnlee@gmail.com
License 01971979

FLOOR PLAN

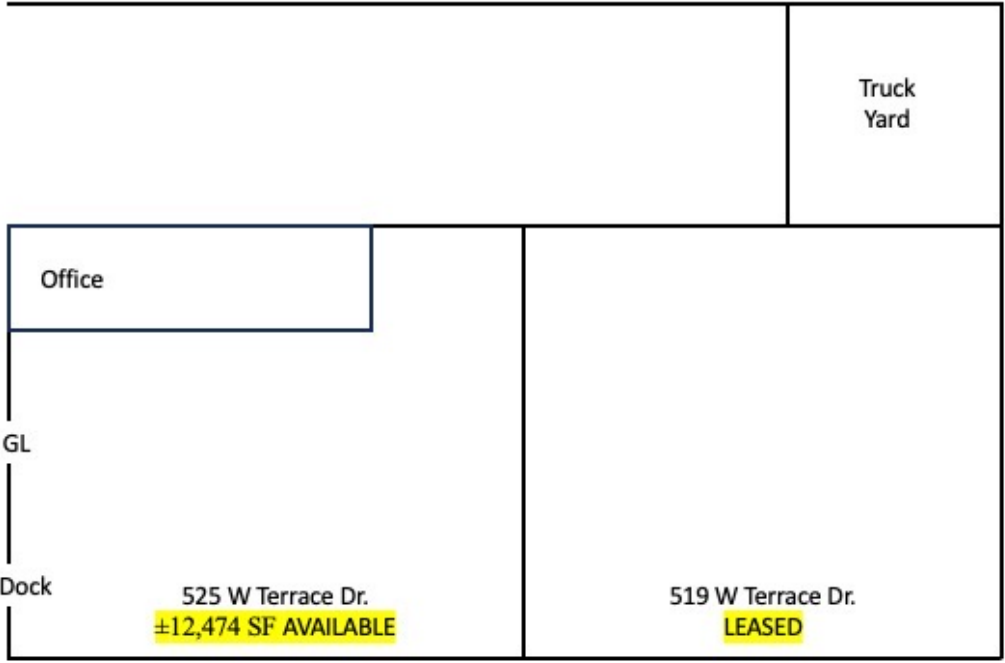

AVAILABLE
FOR
SUBLEASE

525 W.
Terrace Dr.
San Dimas
CA 91773



No warranty or representation, express or implied, is made as to the accuracy of the information contained herein, and same is submitted subject to errors omissions, change of price, rental or other conditions withdrawal without notice, and to any specific listing conditions, imposed by our principals.