

CLASSIC BRICK  
AND TIMBER LOBBY

1ST FLOOR UNIQUE RETAIL  
-OR- CREATIVE OFFICE SPACE



LINCOLN PROPERTY COMPANY

Scott Caldwell  
Senior Vice President  
303.226.8205 | scaldwell@lpc.com

Mark Homlish  
Vice President  
303.226.8207 | mhomlish@lpc.com



## FLOOR PLAN

6,635 SF

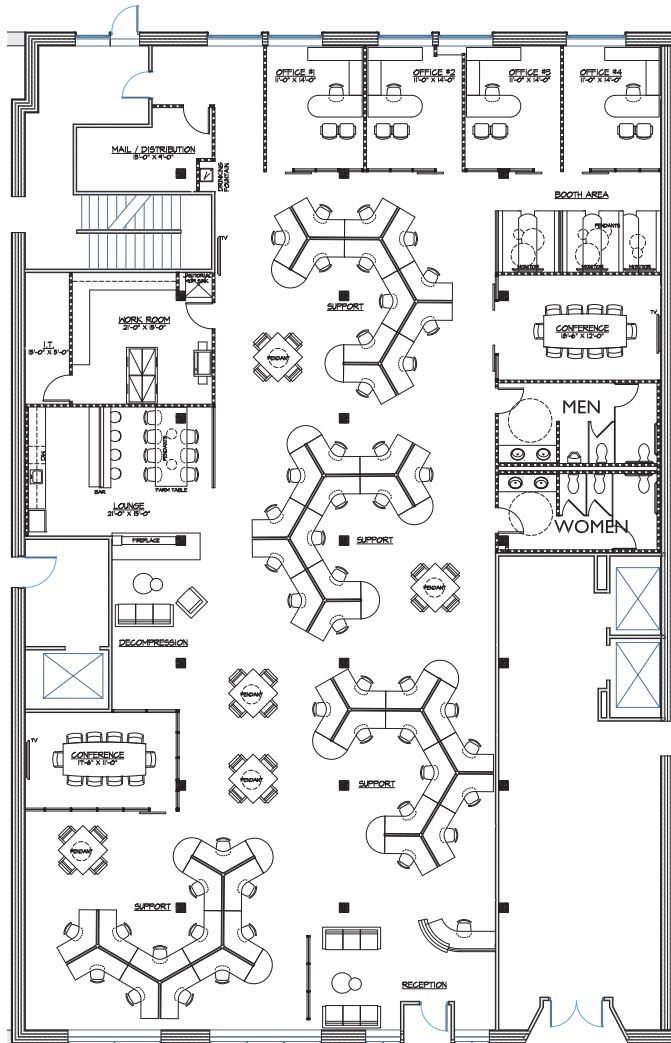

## CREATIVE SPACE





1/2 BLOCK FROM UNION  
STATION



1/2 BLOCK FROM 16<sup>TH</sup>  
STREET MALL

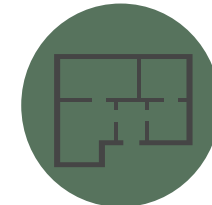

EXPOSED CEILING, BRICK  
& TIMBER



UNDERGROUND  
PARKING



## BUILDING INFORMATION

- Four Story Office Building in LODO
- Year Built: 1895 | Renovated: 2001
- Parking Ratio: 1/1,000 SF
- 41 Underground Parking Spaces @ \$220/each
- Est. 2018 OPEX: \$14.10
- Asking Rates: \$38.00 - \$40.00 FSG