



13819 Meridian Ave E

13819 Meridian East, Puyallup, WA

FOR LEASE

Exclusively Listed by

Rick Brown - Commercial Broker | (253) 840-5574 | rickbrown@kw.com | Lic: 27026, WA
Simranjit Kaur - Associate | **Lee & Associates** | (425) 577-1347 | skaur@lee-associates.com

Each Office is Independently Owned and Operated
www.kwcommercial.com

KELLER WILLIAMS COMMERCIAL
1029 E Main, Suite 201
Puyallup, WA 98372

The calculations and data presented are deemed to be accurate, but not guaranteed. They are intended for the purpose of illustrative projections and analysis. The information provided is not intended to replace or serve as substitute for any legal, accounting, investment, real estate, tax or other professional advice, consultation or service. The user of this software should consult with a professional in the respective legal, accounting, tax or other professional area before making any decisions.

DISCLAIMER

13819 Meridian Ave E
13819 Meridian East | Puyallup, WA 98373

All materials and information received or derived from Keller Williams Commercial its directors, officers, agents, advisors, affiliates and/or any third party sources are provided without representation or warranty as to completeness, veracity, or accuracy, condition of the property, compliance or lack of compliance with applicable governmental requirements, developability or suitability, financial performance of the property, projected financial performance of the property for any party's intended use or any and all other matters.

Neither Keller Williams Commercial its directors, officers, agents, advisors, or affiliates makes any representation or warranty, express or implied, as to accuracy or completeness of the materials or information provided, derived, or received. Materials and information from any source, whether written or verbal, that may be furnished for review are not a substitute for a party's active conduct of its own due diligence to determine these and other matters of significance to such party. Keller Williams Commercial will not investigate or verify any such matters or conduct due diligence for a party unless otherwise agreed in writing.

EACH PARTY SHALL CONDUCT ITS OWN INDEPENDENT INVESTIGATION AND DUE DILIGENCE.

Any party contemplating or under contract or in escrow for a transaction is urged to verify all information and to conduct their own inspections and investigations including through appropriate third-party independent professionals selected by such party. All financial data should be verified by the party including by obtaining and reading applicable documents and reports and consulting appropriate independent professionals. Keller Williams Commercial makes no warranties and/or representations regarding the veracity, completeness, or relevance of any financial data or assumptions. Keller Williams Commercial does not serve as a financial advisor to any party regarding any proposed transaction.

All data and assumptions regarding financial performance, including that used for financial modeling purposes, may differ from actual data or performance. Any estimates of market rents and/or projected rents that may be provided to a party do not necessarily mean that rents can be established at or increased to that level. Parties must evaluate any applicable contractual and governmental limitations as well as market conditions, vacancy factors and other issues in order to determine rents from or for the property. Legal questions should be discussed by the party with an attorney. Tax questions should be discussed by the party with a certified public accountant or tax attorney. Title questions should be discussed by the party with a title officer or attorney. Questions regarding the condition of the property and whether the property complies with applicable governmental requirements should be discussed by the party with appropriate engineers, architects, contractors, other consultants, and governmental agencies. All properties and services are marketed by Keller Williams Commercial in compliance with all applicable fair housing and equal opportunity laws.

EXECUTIVE SUMMARY

13819 Meridian Ave E

13819 Meridian East | Puyallup, WA 98373

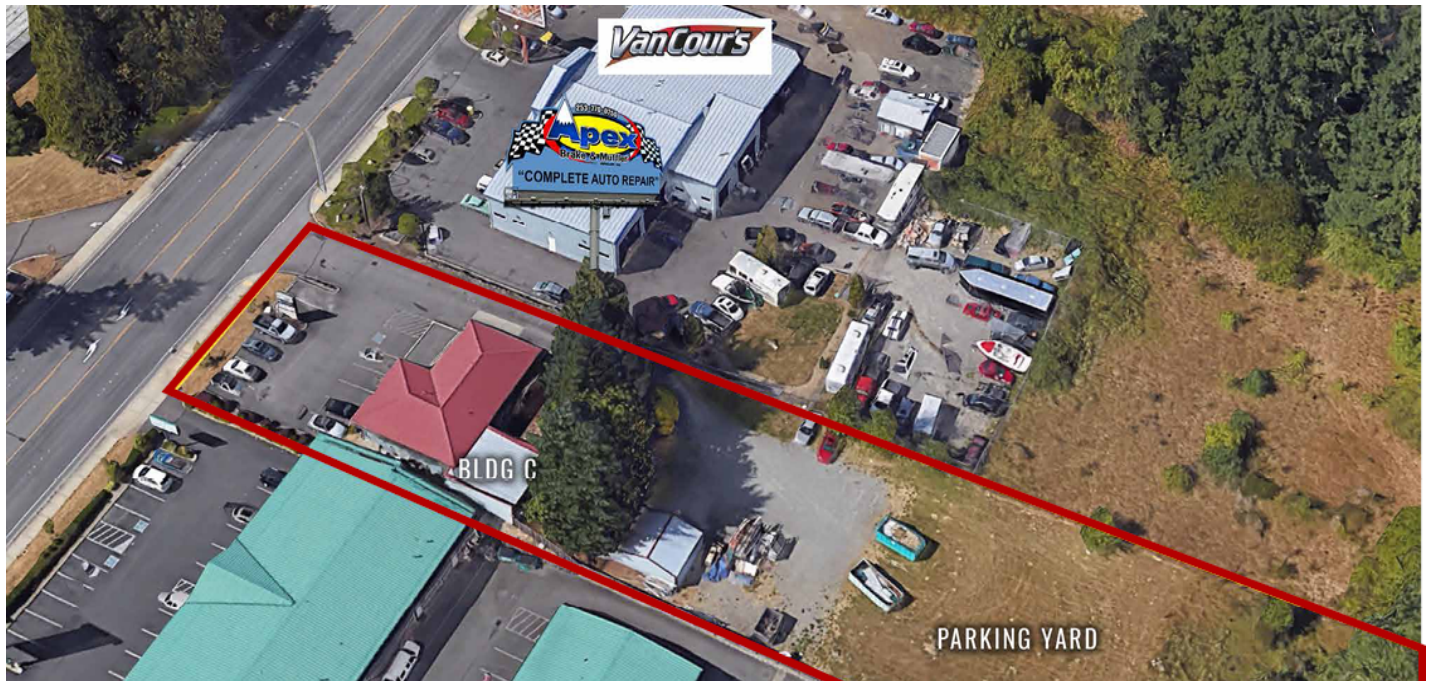

OFFERING SUMMARY

LEASE RATE: \$24.00/SF/YR, NNN

LEASE TERM: 3 - 5 Years

BUILDING SF: 1,053

AVAILABLE SF: 813 SF of Office
240 SF of Storage

PARKING: On-Site

PROPERTY OVERVIEW

This versatile commercial space is perfect for construction-related businesses, contractors, or professional offices needing additional storage. Situated along Meridian Ave E, ensuring excellent visibility and accessibility. Easy access for staff and clients with available parking on-site. This space offers the perfect balance of office and storage, catering to businesses that need efficiency and convenience. Don't miss this opportunity to establish your operations in a prime Puyallup location!



RICK BROWN
(253) 840-5574
rickbrown@kw.com

SIMRANJIT KAUR
(425) 577-1347
skaur@lee-associates.com



LOCATION & HIGHLIGHTS

13819 Meridian Ave E

13819 Meridian East | Puyallup, WA 98373



LOCATION INFORMATION

Building Name: 13819 Meridian Ave E

Street Address: 13819 Meridian East

City, State, Zip Puyallup, WA 98373

County: WA - Pierce

Market: Pierce County

Sub-market: Puyallup

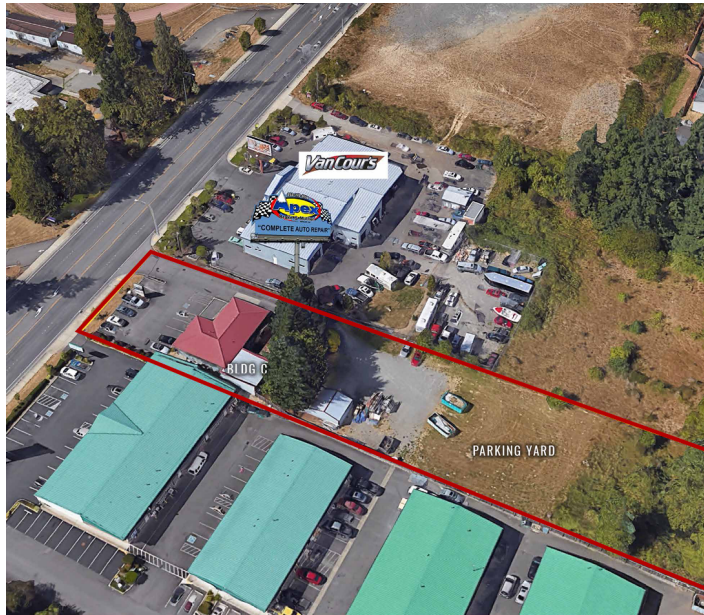

LOCATION OVERVIEW

Strategically located on Meridian, this commercial property offers excellent visibility and accessibility along one of the area's busiest thoroughfares. Easy connections to SR-512 and surrounding business hubs, making it ideal for contractors, service businesses, and office operations. Surrounded by retail centers, industrial businesses, and residential neighborhoods, ensuring a steady customer and workforce base. Close to restaurants, banks, hardware stores, and other essential services to support daily business needs.



PROPERTY HIGHLIGHTS

- Private entry located behind Permabilt
- Ideal space for construction related offices
- Fenced & secured contractor yard for vehicle parking
- Centrally located in South Hill's Meridian corridor

PROPERTY PHOTOS

13819 Meridian Ave E
13819 Meridian East | Puyallup, WA 98373

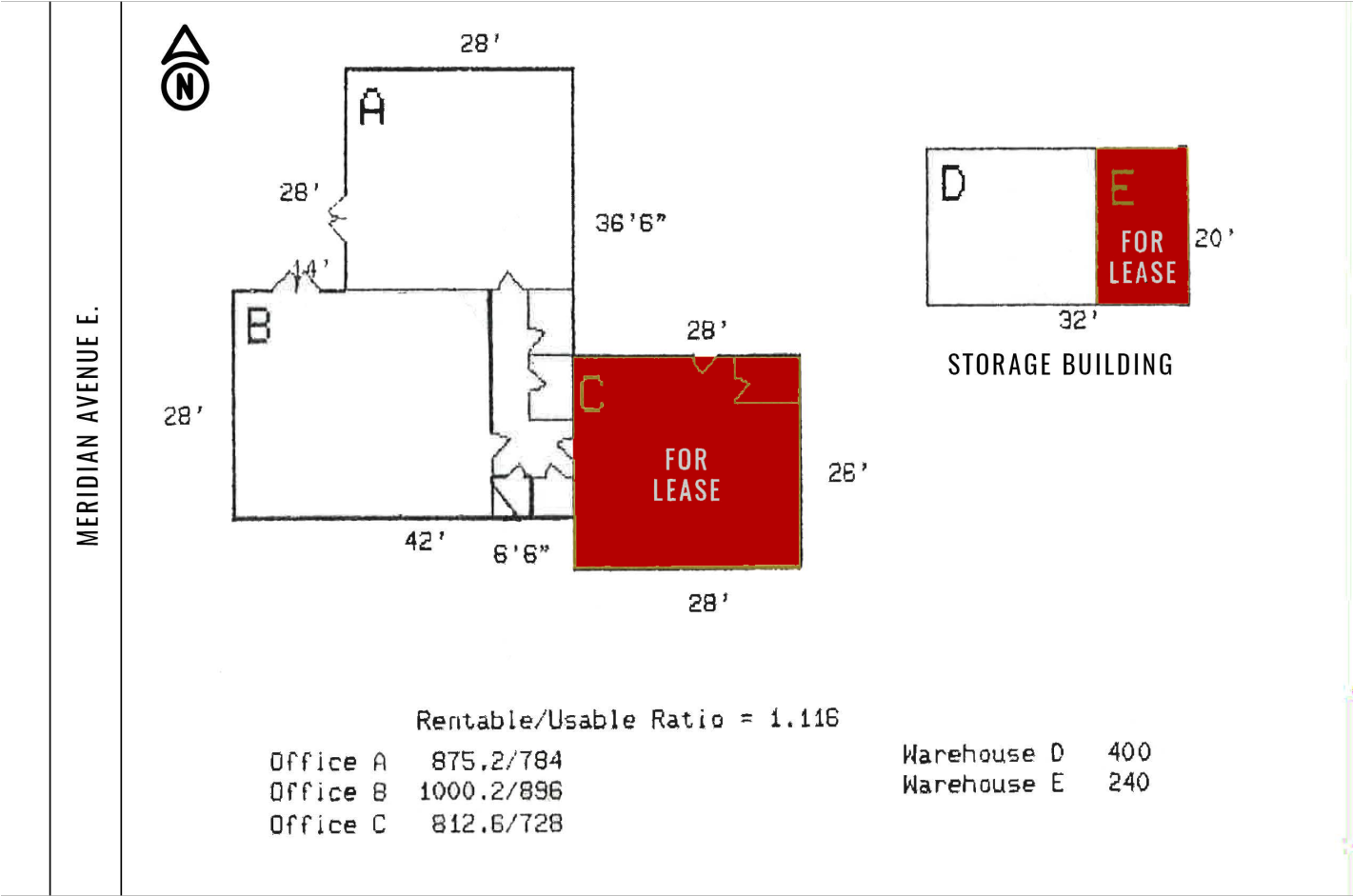

LOCATION MAPS

13819 Meridian Ave E

13819 Meridian East | Puyallup, WA 98373

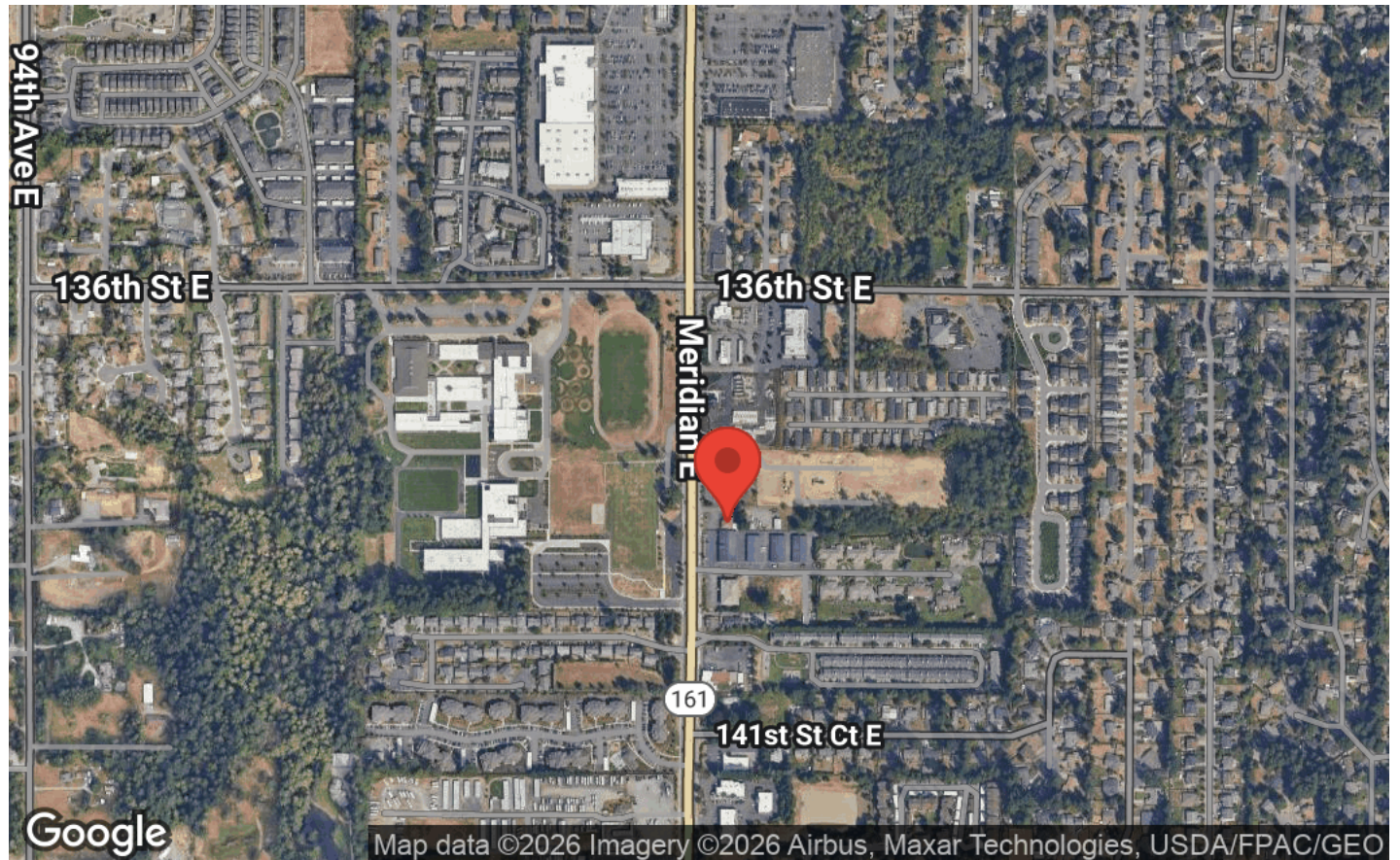
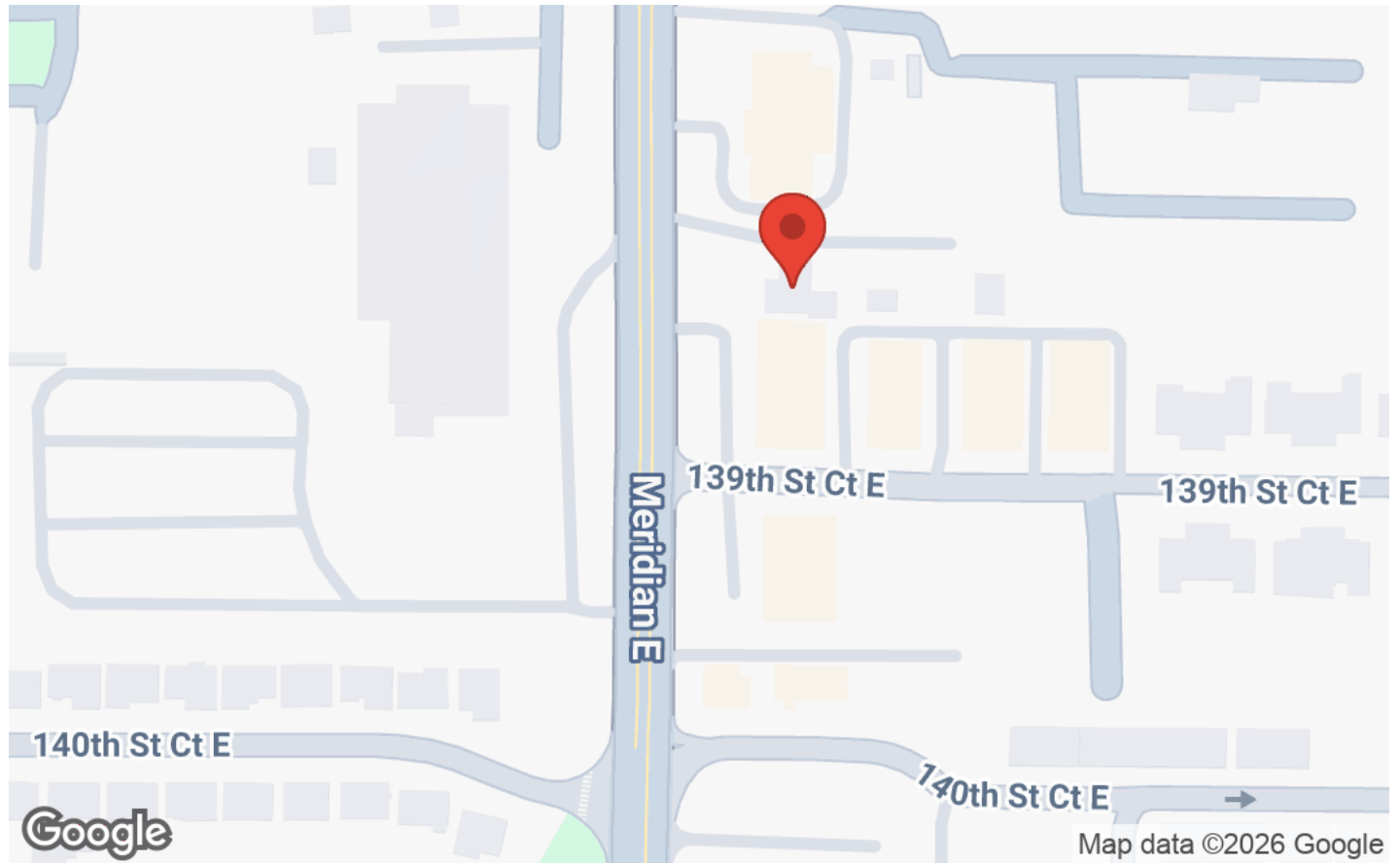

RICK BROWN
(253) 840-5574
rickbrown@kw.com

SIMRANJIT KAUR
(425) 577-1347
skaur@lee-associates.com



BUSINESS MAP

13819 Meridian Ave E

13819 Meridian East | Puyallup, WA 98373

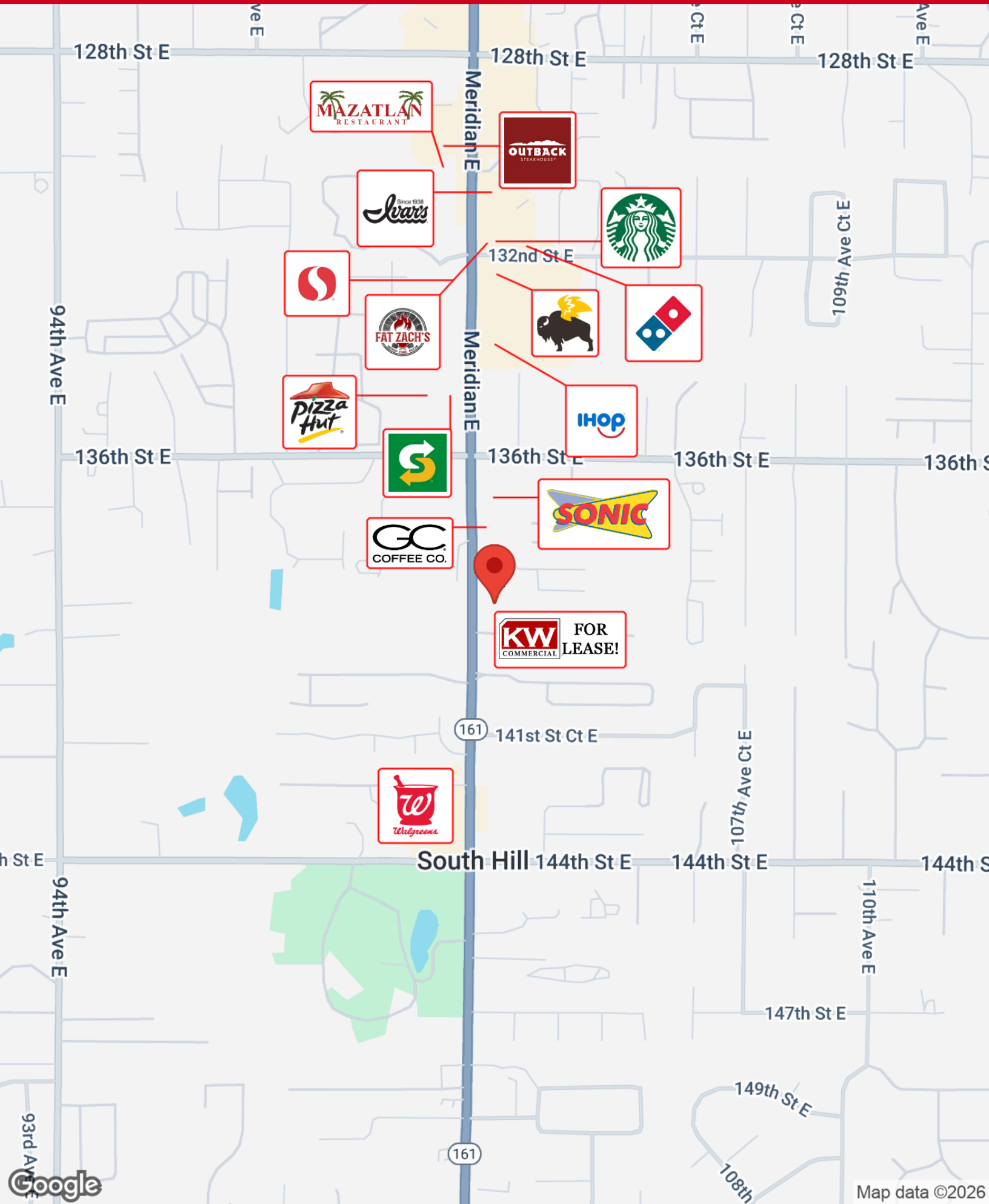

REGIONAL MAP

13819 Meridian Ave E

13819 Meridian East | Puyallup, WA 98373

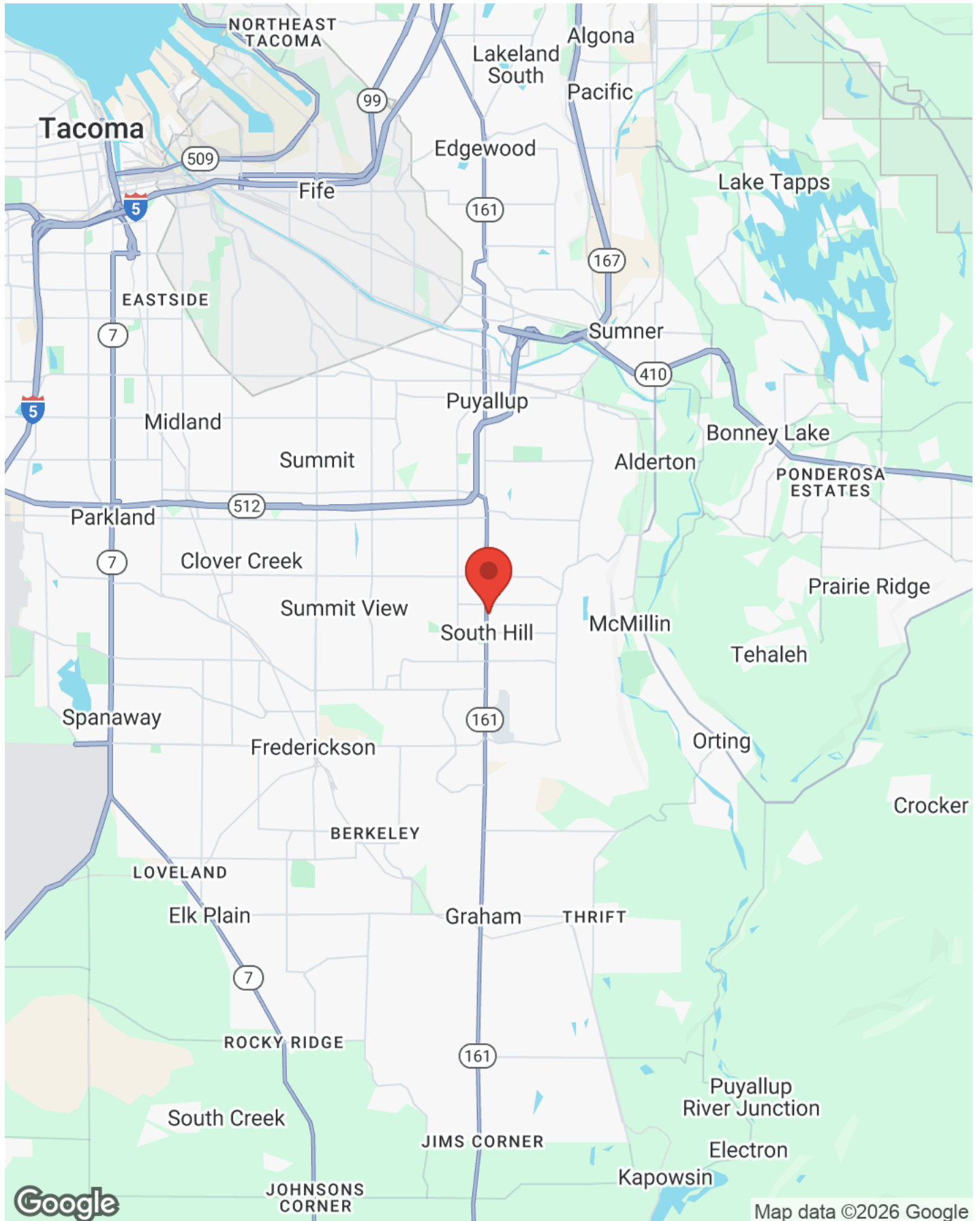

RICK BROWN
(253) 840-5574
rickbrown@kw.com

SIMRANJIT KAUR
(425) 577-1347
skaur@lee-associates.com



DEMOGRAPHICS

13819 Meridian Ave E

13819 Meridian East | Puyallup, WA 98373

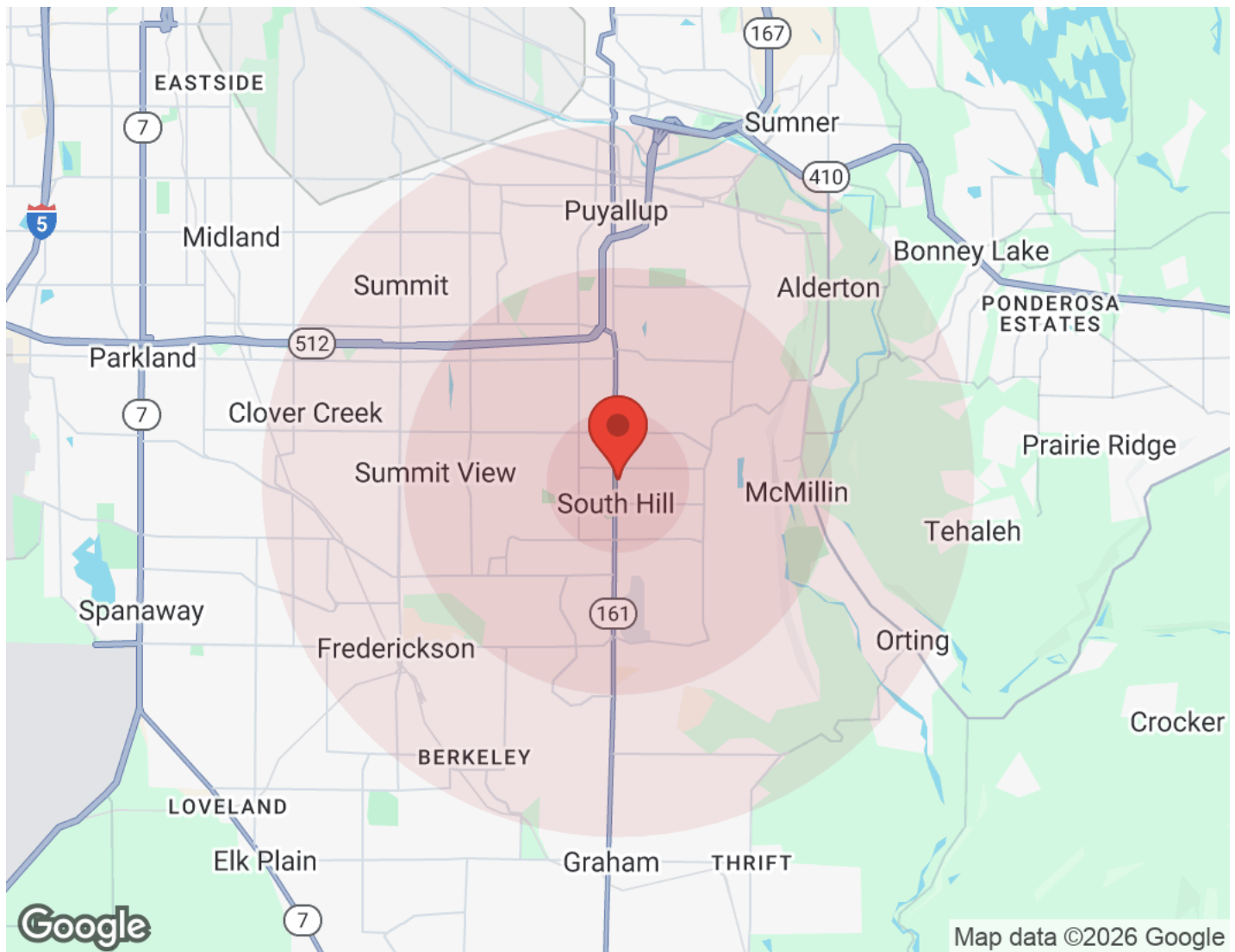

| Population | 1 Mile | 3 Miles | 5 Miles | Income | 1 Mile | 3 Miles | 5 Miles |
|------------------|--------|---------|---------|---------------------|----------|-----------|-----------|
| Male | 7,098 | 47,519 | 94,805 | Median | \$91,200 | \$111,226 | \$110,309 |
| Female | 7,419 | 48,891 | 95,993 | < \$15,000 | 184 | 1,405 | 2,580 |
| Total Population | 14,517 | 96,410 | 190,798 | \$15,000-\$24,999 | 164 | 1,151 | 2,133 |
| | | | | \$25,000-\$34,999 | 194 | 1,065 | 2,274 |
| | | | | \$35,000-\$49,999 | 337 | 2,244 | 4,557 |
| | | | | \$50,000-\$74,999 | 1,115 | 4,312 | 8,314 |
| | | | | \$75,000-\$99,999 | 1,046 | 5,076 | 10,775 |
| | | | | \$100,000-\$149,999 | 1,140 | 7,673 | 16,508 |
| | | | | \$150,000-\$199,999 | 612 | 5,664 | 10,628 |
| | | | | > \$200,000 | 553 | 6,063 | 11,341 |
| | | | | | | | |
| Age | 1 Mile | 3 Miles | 5 Miles | Housing | 1 Mile | 3 Miles | 5 Miles |
| Ages 0-14 | 3,019 | 19,798 | 38,669 | Total Units | 5,679 | 36,777 | 73,518 |
| Ages 15-24 | 1,860 | 11,863 | 22,950 | Occupied | 5,346 | 34,652 | 69,110 |
| Ages 25-54 | 6,440 | 41,693 | 81,909 | Owner Occupied | 2,918 | 23,041 | 46,745 |
| Ages 55-64 | 1,382 | 9,901 | 20,505 | Renter Occupied | 2,428 | 11,611 | 22,365 |
| Ages 65+ | 1,816 | 13,153 | 26,766 | Vacant | 333 | 2,124 | 4,407 |
| | | | | | | | |
| Race | 1 Mile | 3 Miles | 5 Miles | | | | |
| White | 8,857 | 58,993 | 120,794 | | | | |
| Black | 1,128 | 7,086 | 12,745 | | | | |
| Am In/AK Nat | 109 | 646 | 1,355 | | | | |
| Hawaiian | 244 | 1,369 | 2,595 | | | | |
| Hispanic | 1,966 | 12,533 | 24,117 | | | | |
| Asian | 1,121 | 8,224 | 14,253 | | | | |
| Multi-Racial | 1,060 | 7,318 | 14,367 | | | | |
| Other | 33 | 231 | 572 | | | | |