

FOR SALE & FOR LEASE



MAHONEY  
& ASSOCIATES  
COMMERCIAL REAL ESTATE

UNDER REMODEL | S. MAIN ST. OFFICE/RETAIL

10 Katherine Ave. | Salinas, CA

\*Representative Rendering

## TABLE OF CONTENTS

Executive Summary	3
Proposed Floor Plan	4
Plat Map	5
Aerial Map	6
Monterey County Overview	7
Mahoney & Associates	8
Disclaimer	9

## EXCLUSIVELY LISTED BY:

### IAN JONES

Sales Associate | DRE #02165792  
ijones@mahoneycommercial.com  
831.646.1919 ext. 109

### CHRIS TONINI

Sales Associate | DRE #02088036  
ctonini@mahoneycommercial.com  
831.646.1919 ext. 104

### MAHONEY & ASSOCIATES

501 Abrego St | Monterey, CA  
www.mahoneycommercial.com  
831.646.1919



# EXECUTIVE SUMMARY

10 KATHERINE AVE.  
SALINAS, CA 93901

Asking Sale Price

**\$1,225,000**

**\*CALL FOR LEASE DETAILS\***



TOTAL BUILDING SIZE  
**± 3,100 SF**



TOTAL LOT SIZE  
**± 4,150 SF**



YEAR BUILT  
**1950**



ZONING  
**MIXED USE**



PARKING  
**ABUNDANT IN REAR  
PARKING LOT**



REMODEL  
**2024**

**Mahoney & Associates** is pleased to present to the market 10 Katherine Ave. in Salinas, California. The property's desirable South Main St. location offers versatile zoning, perfect for a range of businesses seeking to establish or expand their presence. Formerly home to Century 21, the building has been vacant since 2019. Under recent renovation the office space remains flexible with the current owner open to building to suit the new owner's needs. The front Mid-Century facade adds to the property's appeal, making it an attractive option for tenants and investors alike.

## PROPERTY DETAILS

APN	002-605-003
Address	10 Katherine Ave. Salinas, CA
Year Built	1950
Total Building Size	±3,100 SF
Total Lot Size	±4,150 SF
Parking	Shared Parking in Rear of Building
Property Remodel	Currenty Under Construction

# PROPOSED FLOORPLAN

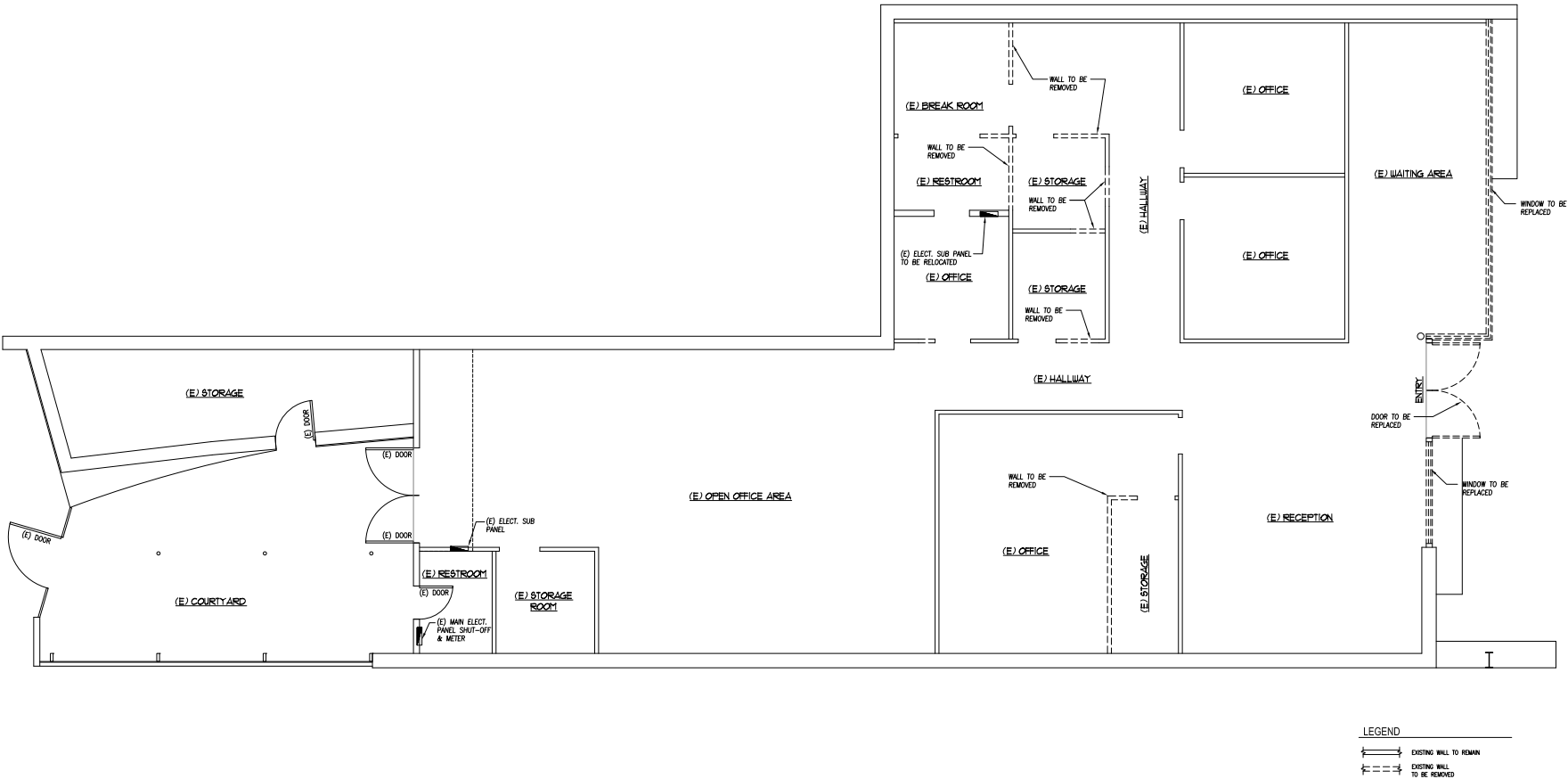

**\*Approved by City of Salinas**





# AERIAL MAP



S. Main St.

Katherine Ave

San Miguel St.

E Acacia St

E Acacia St

Hawthorne St

E Romie Ln

E Romie Ln

E Romie Ln

Katherine Ave

Katherine Ave

San Juan Dr

10 Katherine Ave. | 6



## ABOUT SALINAS, CA

Salinas, known as the “Salad Bowl of the World,” is a city with a rich agricultural heritage and a diverse economy. The city is located in Monterey County, California, and is renowned for its fertile soil and ideal climate for growing crops. Agriculture plays a significant role in Salinas’ economy, with the region producing a variety of crops such as lettuce, broccoli, and strawberries. The city’s agricultural industry not only contributes to local employment but also plays a crucial role in supplying produce to markets across the United States.

In addition to agriculture, Salinas has a growing healthcare and education sector. The city is home to several healthcare facilities and educational institutions, including Hartnell College and the Natividad Medical Center. These institutions not only provide essential services to the community but also contribute to job creation and economic growth in the area. The healthcare and education sectors in Salinas continue to expand, offering opportunities for further economic development in the city.

Salinas has experienced steady population growth over the years, leading to increased demand for housing, services, and infrastructure. The city has implemented various initiatives to support this growth, including urban development projects and improvements to transportation infrastructure. As Salinas continues to grow, it remains a vibrant and diverse community with a strong economy supported by its agricultural heritage, healthcare, education sectors, and ongoing urban development efforts.



# MONTEREY COUNTY

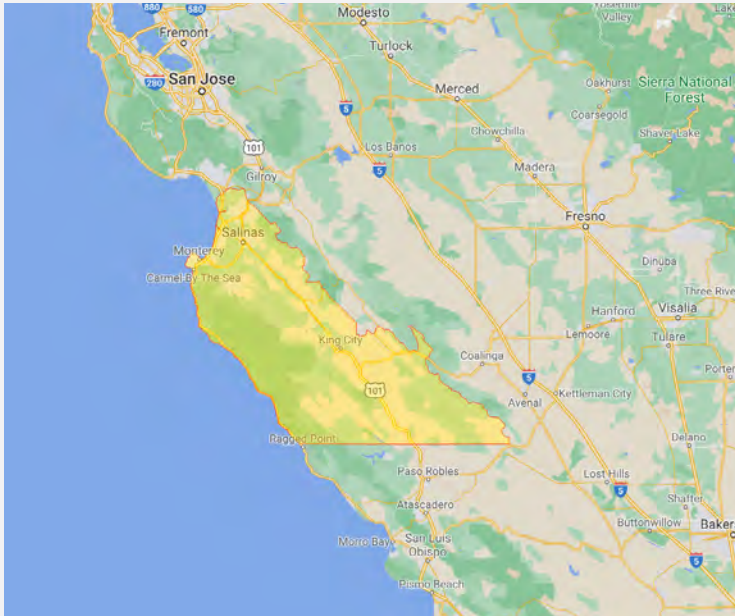

Monterey County is located on the central coast of California. It borders the Monterey Bay, Big Sur, State Route 1, and the 17 Mile Drive. The area attracts an estimated 4.6 million visitors a year. The city of Monterey is approximately 100 miles south of San Francisco and 300 miles north of Los Angeles. Monterey County boasts both beautiful coastlines as well as a booming agricultural industry. The city of Salinas is the center of the county's growing Ag industry and also the county's most populous city.



## REGIONAL HIGHLIGHTS



Major US  
Agricultural  
Hub



Large  
Tourism  
Sector



Military  
Presence



## ECONOMY

- Salinas agriculture brings ±\$8 billion into the local economy.
- Tourism in the area makes up a large part of the local economy with sites such as Big Sur, the 17 Mile Drive, Pebble Beach Golf Links, numerous state and national parks and wineries.
- There are three regional airports in the county: Monterey, Salinas, and Marina Municipal.



## 2020 DEMOGRAPHICS

436,000

Population

135,000

Households

34.7

Median Age

\$76,900

Median Household  
Income



# MAHONEY & ASSOCIATES

**UNEQUALED COMMITMENT TO OUR CLIENTS' NEEDS AND SATISFACTION...  
MAHONEY & ASSOCIATES WORKS TIRELESSLY ON MAXIMIZING REAL ESTATE  
VALUES.**

With our collaborative team of real estate professionals and consultants, Mahoney & Associates works to maximize your property's potential, whether for selling, leasing or trading. In everything we do, there is just one driving principle: client satisfaction.

For over 40 years, Mahoney & Associates has been known as a local and regional trusted industry leader, founded by John Mahoney. Our clients span every industry, so we serve them with broad, creative and diverse expertise and a market knowledge that touches every facet of commercial real estate, from raw land development to sophisticated 1031 Single-and Multi-Tenant Net Leased exchanges in other states. In every transaction we enter, beyond the beams and masonry or ROI, one mission alone drives us all and that is representing your interests as if they were our own.

It will be our pleasure and duty to sit with you and listen...so we can understand your motivation, background, needs, challenges and goals in discussing potential solutions for your properties. We have learned that one solution does not fit all situations and look forward to working with you to develop a strategy that encompasses all stakeholders' interests. Nothing is more satisfying than driving by a property with which we have partnered with owners, knowing there is now a new business, a greater stream of income, a legacy honoring a family member, a community treasure restored...the list is endless in how we work with our valued clients to enrich their lives and the community in which their property sits.

## SOLD PROPERTY HIGHLIGHTS

40+ Years of Commercial Real Estate Represented

**\$4 BILLION**  
IN TRANSACTION VOLUME

**2,000+**  
ASSETS SOLD

**6,000,000**  
SQUARE FEET LEASED

**1,750+**  
LEASE TRANSACTIONS

# DISCLAIMER

Mahoney & Associates (M&A) hereby advises all prospective purchasers of property as follows: All materials and information received or derived from M&A and its directors, officers, agents, advisors, affiliates and/or any third party sources are provided without representation or warranty as to completeness, veracity, or accuracy, condition of the property, compliance or lack of compliance with applicable governmental requirements, developability or suitability, financial performance of the property, projected financial performance of the property for any party's intended use or any and all other matters. Neither M&A and its directors, officers, agents, advisors, or affiliates makes any representation or warranty, express or implied, as to accuracy or completeness of the any materials or information provided, derived, or received. Materials and information from any source, whether written or verbal, that may be furnished for review are not a substitute for a party's active conduct of its own due diligence to determine these and other matters of significance to such party. M&A will not investigate or verify any such matters or conduct due diligence for a party unless otherwise agreed in writing. EACH PARTY SHALL CONDUCT ITS OWN INDEPENDENT INVESTIGATION AND DUE DILIGENCE. Any party contemplating or under contract or in escrow for a transaction is urged to verify all information and to conduct their own inspections and investigations including through appropriate third party independent professionals selected by such party. All financial data should be verified by the party including by obtaining and reading applicable documents and reports and consulting appropriate independent professionals. M&A makes no warranties and/or representations regarding the veracity, completeness, or relevance of any financial data or assumptions. M&A do not serve as financial advisors to any party regarding any proposed transaction. All data and assumptions regarding financial performance, including that used for financial modeling purposes, may differ from actual data or performance. Any estimates of market rents and/ or projected rents that may be provided to a party do not necessarily mean that rents can be established at or increased to that level. Parties must evaluate any applicable contractual and governmental limitations as well as market conditions, vacancy factors and other issues in order to determine rents from or for the property. Legal questions should be discussed by the party with an attorney. Tax questions should be discussed by the party with a certified public accountant or tax attorney. Title questions should be discussed by the party with a title officer or attorney. Questions regarding the condition of the property and whether the property complies with applicable governmental requirements should be discussed by the party with appropriate engineers, architects, contractors, other consultants and governmental agencies. All properties and services are marketed by M&A and in compliance with all applicable fair housing and equal opportunity laws.

## EXCLUSIVELY LISTED BY:

---

### IAN JONES

Sales Associate | DRE #02165792  
ijones@mahoneycommercial.com  
831.646.1919 ext. 109

### CHRIS TONINI

Sales Associate | DRE #02088036  
ctonini@mahoneycommercial.com  
831.646.1919 ext. 104

### MAHONEY & ASSOCIATES

501 Abrego St | Monterey, CA  
www.mahoneycommercial.com  
831.646.1919

**MAHONEY  
& ASSOCIATES**

---

COMMERCIAL REAL ESTATE