



AVAILABLE FOR LEASE

4301 RESNIK COURT
BAKERSFIELD, CA

BUILDING A

FOR LEASE

4301 RESNIK CT.



Functional industrial-flex space available in multi-tenant complex, in southwest Bakersfield.

Features office space and fenced yard space.

Close proximity to a variety of amenities providing convenience to users—restaurants, gas stations, retail stores, breweries, and other industrial users.

PROPERTY HIGHLIGHTS

Total Available:	±15,600 SF
Office:	±11,580 SF
Lot Size:	1 Acre
Loading:	(2) Roll-Up Doors
Main Power Panel:	1200 Amps, 208 V, 3 Ph
Zoning:	M-2, City of Bakersfield
Asking Rent:	\$1.45psf/month, Industrial Gross



FOR LEASE

4301 RESNIK CT.



FLOOR PLAN / AERIAL VIEW

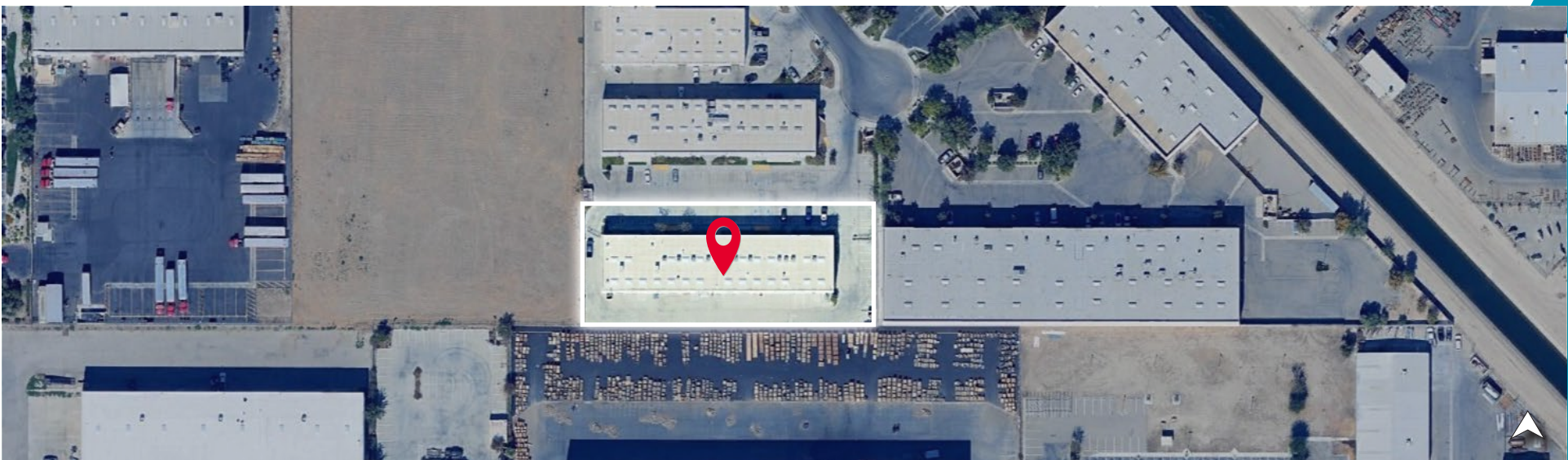
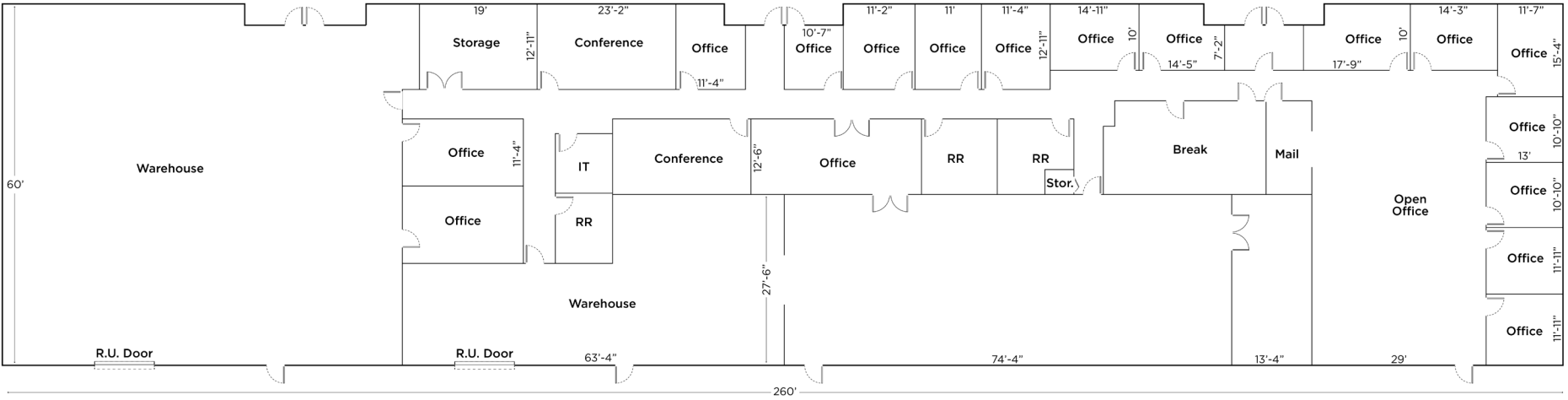



For more information, please contact:

Wayne Kress, SIOR

Executive Director
wayne.kress@cushwake.com
+1 661 706 5692
Lic. #00834680

Coby Vance

Senior Director
coby.vance@cushwake.com
+1 661 203 4400
Lic. #01449929

Scott Reynolds

Director
scott.reynolds@cushwake.com
+1 661 330 7616
Lic. #01382493

5060 California Ave, Suite 1000
Bakersfield, CA
PH: +1 661 327 2263
cushmanwakefield.com
Lic. #01880493

©2025 Cushman & Wakefield. All rights reserved. The information contained in this communication is strictly confidential. This information has been obtained from sources believed to be reliable but has not been verified. NO WARRANTY OR REPRESENTATION, EXPRESS OR IMPLIED, IS MADE AS TO THE CONDITION OF THE PROPERTY (OR PROPERTIES) REFERENCED HEREIN OR AS TO THE ACCURACY OR COMPLETENESS OF THE INFORMATION CONTAINED HEREIN, AND SAME IS SUBMITTED SUBJECT TO ERRORS, OMISSIONS, CHANGE OF PRICE, RENTAL OR OTHER CONDITIONS, WITHDRAWAL WITHOUT NOTICE, AND TO ANY SPECIAL LISTING CONDITIONS IMPOSED BY THE PROPERTY OWNER(S). ANY PROJECTIONS, OPINIONS OR ESTIMATES ARE SUBJECT TO UNCERTAINTY AND DO NOT SIGNIFY CURRENT OR FUTURE PROPERTY PERFORMANCE.

