



15053 Ventura Blvd. #101

Sherman Oaks, California 91403

Lease Highlights

- Parking: 4/1,000 Ratio - Surface & Subterranean
- Prime Sherman Oaks Location
- Signalized Corner
- Excellent Signage - Up to 90 Feet of Frontage
- Strong Demographics

Available Spaces

Spaces	Lease Rate	Size (SF)
101	\$3.75	1,231 SF

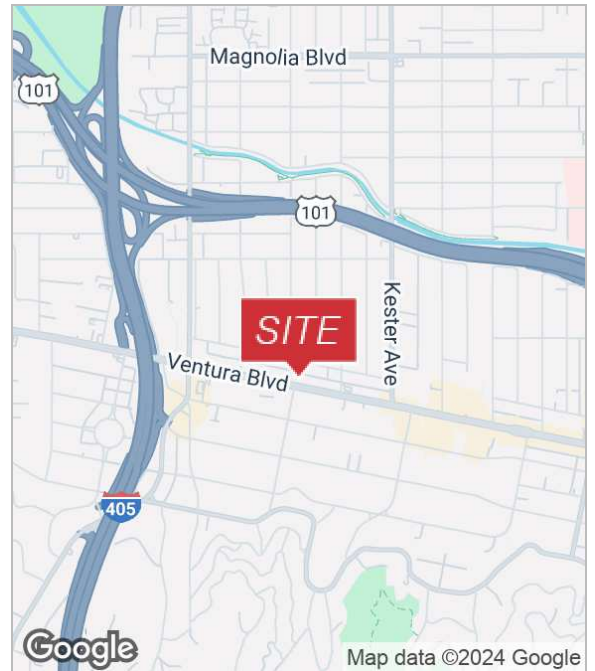

For more information

Adam Comora

O: 818.742.1610
acomora@naicapital.com | CalDRE #01312271

Todd Rizzardi

O: 310.310.1227
trizzardi@naicapital.com | CalDRE #01506894

No warranty, express or implied, is made as to the accuracy of the information contained herein. This information is submitted subject to errors, omissions, change of price, rental or other conditions, withdrawal without notice, and is subject to any special listing conditions imposed by our principals. Cooperating brokers, buyers, tenants and other parties who receive this document should not rely on it, but should use it as a starting point of analysis, and should independently confirm the accuracy of the information contained herein through a due diligence review of the books, records, files and documents that constitute reliable sources of the information described herein. Logos are for identification purposes only and may be trademarks of their respective companies. NAI Capital Commercial, Inc. CAL DRE Lic. #02130474

For Lease

15053 Ventura Blvd #101



Adam Comora

818.742.1610

acomora@naicapital.com

CalDRE #01312271

Todd Rizzardi

310.310.1227

trizzardi@naicapital.com

CalDRE #01506894

NAICapital
COMMERCIAL REAL ESTATE SERVICES, WORLDWIDE

For Lease

15053 Ventura Blvd #101



Adam Comora

818.742.1610

acomora@naicapital.com

CalDRE #01312271

Todd Rizzardi

310.310.1227

trizzardi@naicapital.com

CalDRE #01506894

NAICapital
COMMERCIAL REAL ESTATE SERVICES, WORLDWIDE

For Lease

15053 Ventura Blvd #101



Adam Comora

818.742.1610

acomora@naicapital.com

CalDRE #01312271

Todd Rizzardi

310.310.1227

trizzardi@naicapital.com

CalDRE #01506894

NAICapital
COMMERCIAL REAL ESTATE SERVICES, WORLDWIDE

For Lease

15053 Ventura Blvd #101

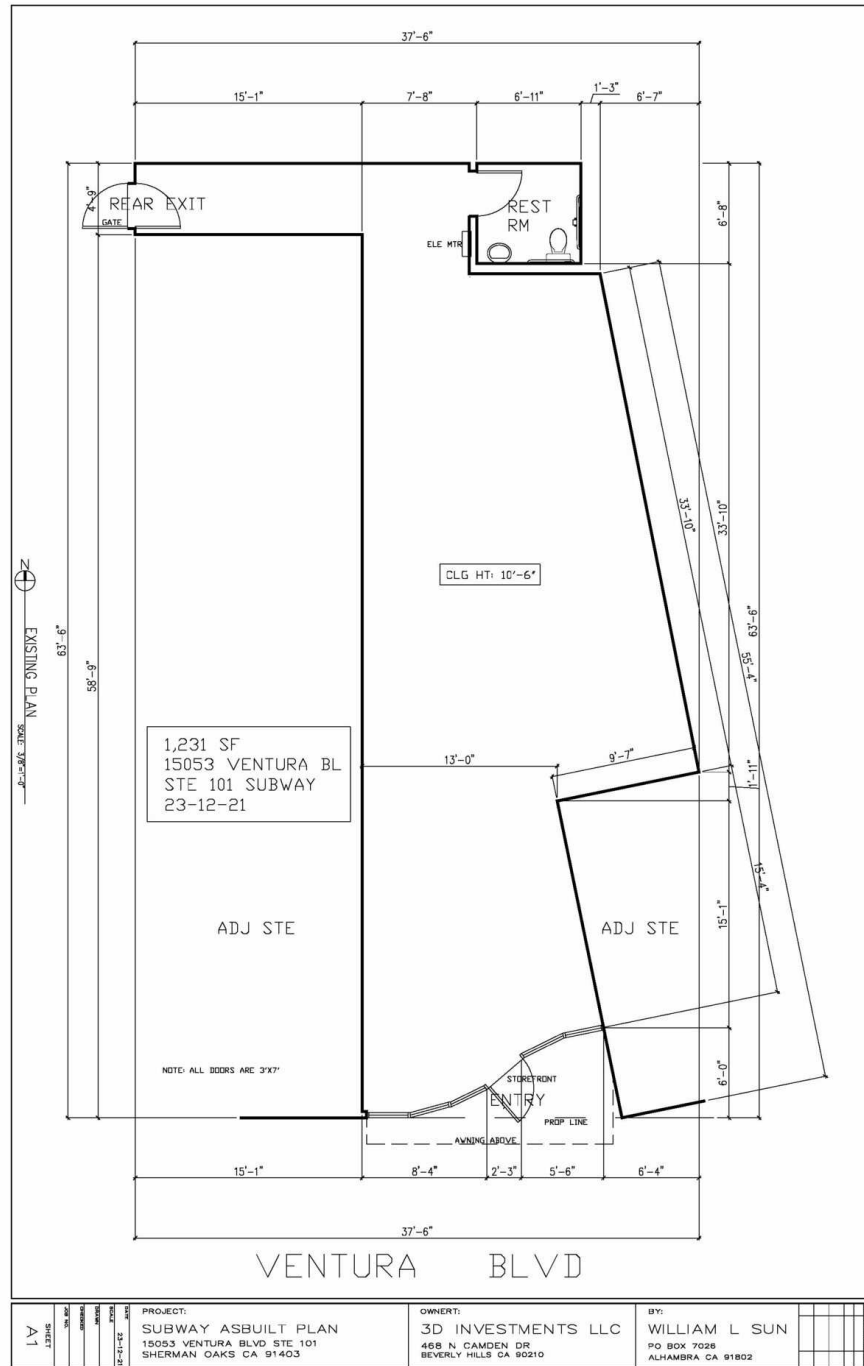

Adam Comora
818.742.1610
acomora@naicapital.com
CalDRE #01312271

Todd Rizzardi
310.310.1227
trizzardi@naicapital.com
CalDRE #01506894

For Lease

15053 Ventura Blvd #101

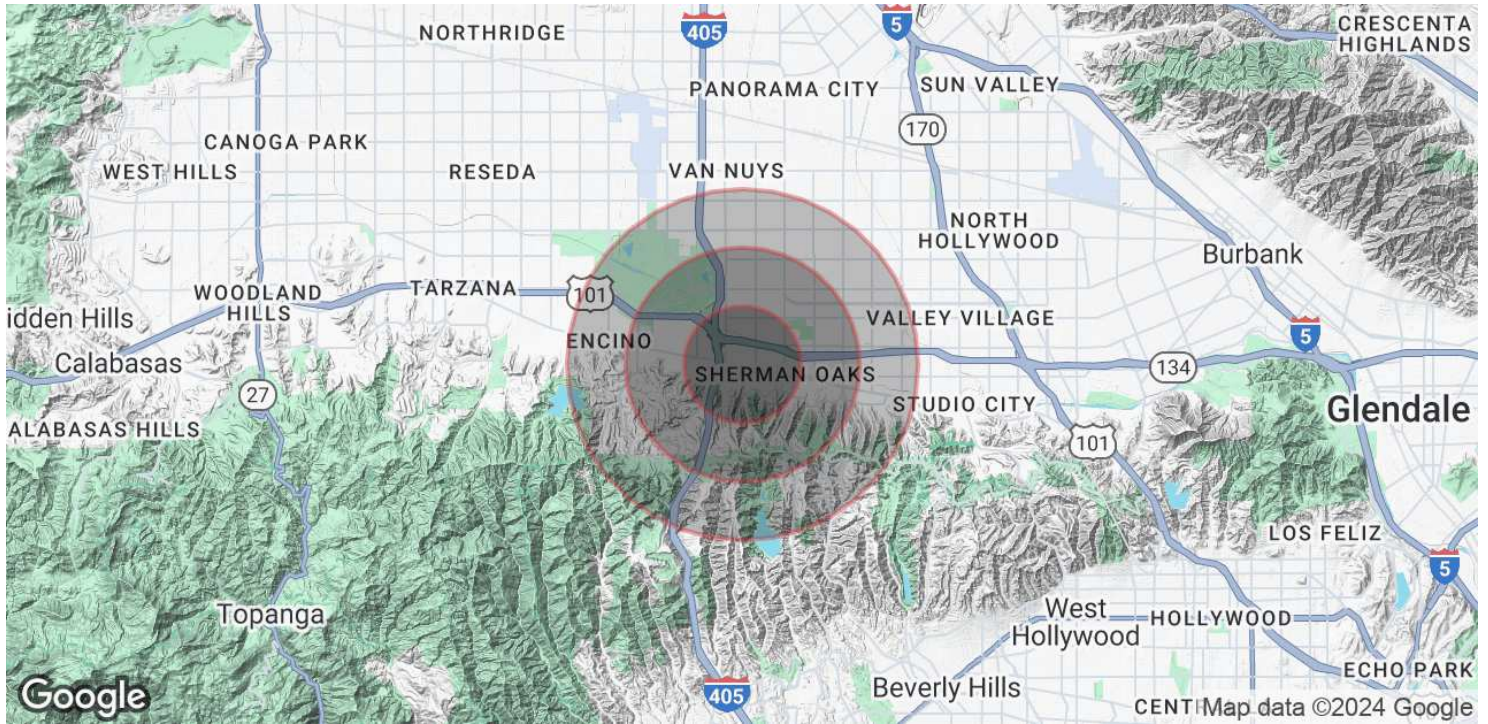

POPULATION

	1 MILE	2 MILES	3 MILES
Total Population	27,439	76,762	159,176
Average Age	42	42	41
Average Age (Male)	41	41	40
Average Age (Female)	43	43	42

HOUSEHOLDS & INCOME

	1 MILE	2 MILES	3 MILES
Total Households	13,021	34,460	65,664
# of Persons per HH	2.1	2.2	2.4
Average HH Income	\$153,888	\$160,577	\$145,093
Average House Value	\$1,374,759	\$1,351,932	\$1,257,977

Demographics data derived from AlphaMap

Adam Comora

818.742.1610
acomora@naicapital.com
CalDRE #01312271

Todd Rizzardi

310.310.1227
trizzardi@naicapital.com
CalDRE #01506894

NAICapital
COMMERCIAL REAL ESTATE SERVICES, WORLDWIDE