

31175 KENDALL AVENUE  
FRASER, MICHIGAN

INDUSTRIAL FOR LEASE  
4,080 Square Feet Available



**SIGNATURE  
ASSOCIATES**  
KNOW SIGNATURE | KNOW RESULTS



## PROPERTY FEATURES

- 4,080 square feet available
- 400 square feet office
- 17' clear height
- (2) 12' x 14', 10' x 12' grade level doors
- 1000 amps, 240 volts, buss duct
- 100% air-conditioned
- Immaculate food grade industrial facility
- Must see to appreciate
- Rare opportunity
- Lease Rate: \$9.95/sq. ft. NNN

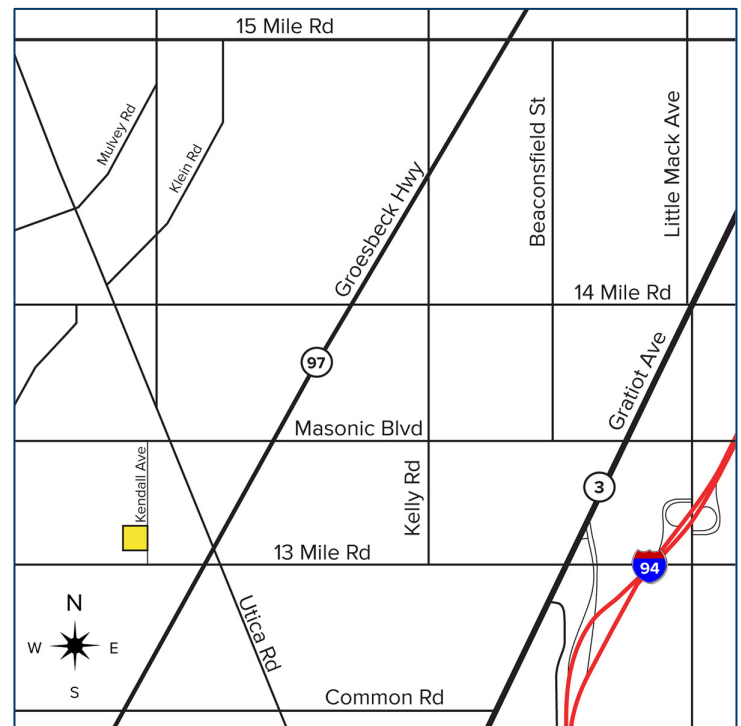

For more information, please contact:

**BEN WILKIEMEYER**  
(248) 359 0624  
bwilkiemeyer@signatureassociates.com

**PAUL SAAD**  
(248) 359 0652  
psaad@signatureassociates.com

**SIGNATURE ASSOCIATES**  
One Towne Square, Suite 1200  
Southfield, MI 48076  
www.signatureassociates.com

# 31175 Kendall Avenue – Fraser, Michigan

## Industrial For Lease

4,080  
Square Feet  
AVAILABLE

### Interior Photos

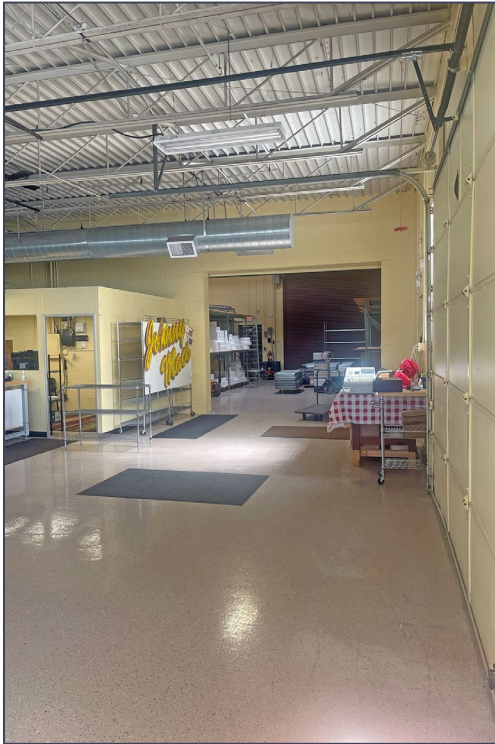

For more information, please contact:

**BEN WILKIEMEYER**

(248) 359 0624

[bwilkiemeyer@signatureassociates.com](mailto:bwilkiemeyer@signatureassociates.com)

**PAUL SAAD**

(248) 359 0652

[psaad@signatureassociates.com](mailto:psaad@signatureassociates.com)

**SIGNATURE ASSOCIATES**

One Towne Square, Suite 1200

Southfield, MI 48076

[www.signatureassociates.com](http://www.signatureassociates.com)

# 31175 Kendall Avenue – Fraser, Michigan

Industrial For Lease

4,080  
Square Feet  
AVAILABLE

## Site Plan

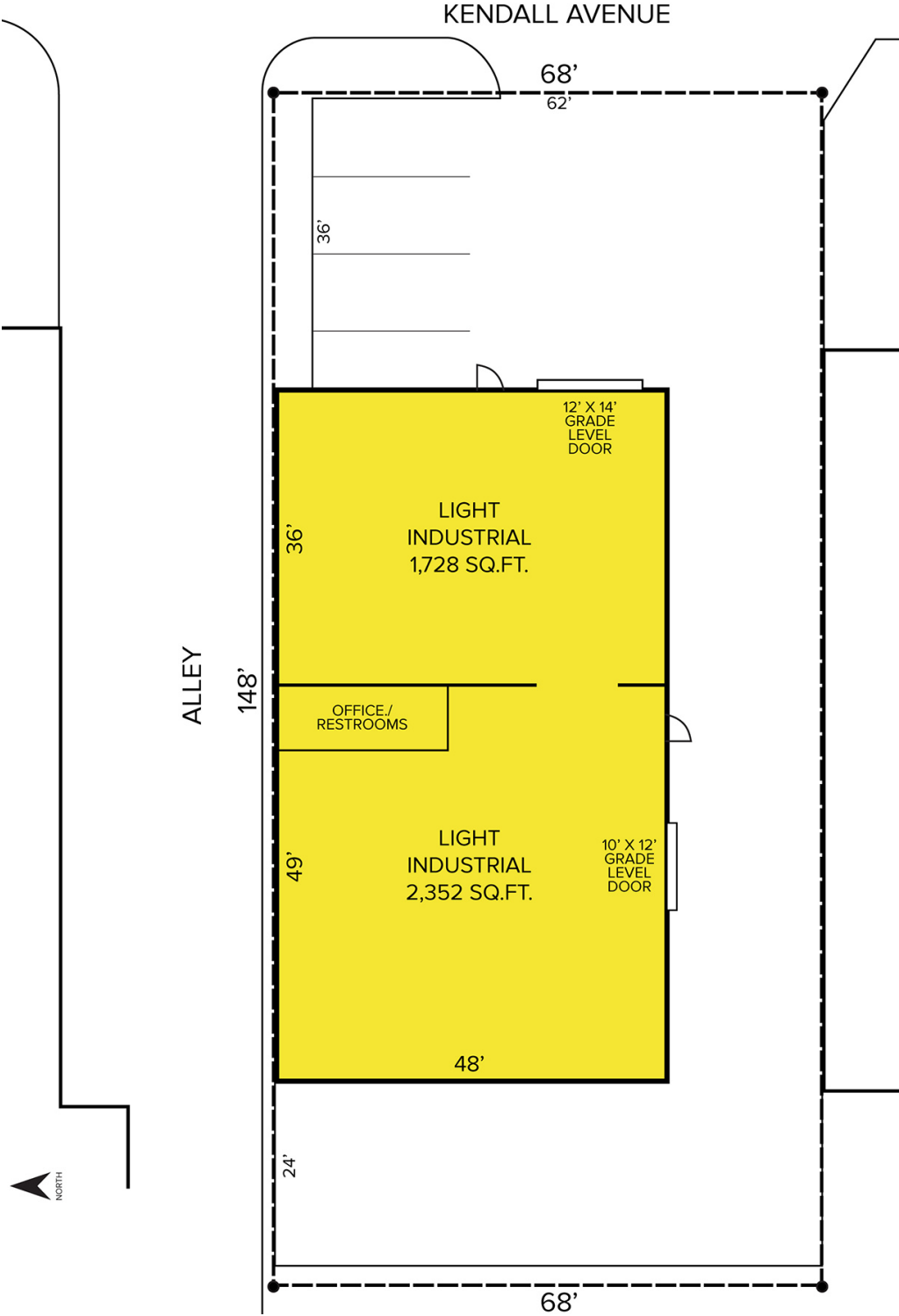

For more information, please contact:

**BEN WILKIEMEYER**  
(248) 359 0624  
bwilkiemeyer@signatureassociates.com

**PAUL SAAD**  
(248) 359 0652  
psaad@signatureassociates.com

**SIGNATURE ASSOCIATES**  
One Towne Square, Suite 1200  
Southfield, MI 48076  
www.signatureassociates.com

Information is subject to verification and no liability for errors or omissions is assumed. Price is subject to change and listing withdrawal.

# 31175 Kendall Avenue – Fraser, Michigan

Industrial For Lease

4,080  
Square Feet  
AVAILABLE

Aerial



For more information, please contact:

**BEN WILKIEMEYER**

(248) 359 0624

[bwilkiemeyer@signatureassociates.com](mailto:bwilkiemeyer@signatureassociates.com)

**PAUL SAAD**

(248) 359 0652

[psaad@signatureassociates.com](mailto:psaad@signatureassociates.com)

**SIGNATURE ASSOCIATES**

One Towne Square, Suite 1200

Southfield, MI 48076

[www.signatureassociates.com](http://www.signatureassociates.com)