

CUSHMAN &  
WAKEFIELD

UnitedHealthcare

OPTUM

PLUG & PLAY OFFICE SPACE

FOR SUBLEASE  
**18,400 RSF**

**10175**

**LITTLE PATUXENT PKWY**

COLUMBIA, MD 21044



# PROPERTY DETAILS

This trophy space in the highly desirable Merriweather District in Columbia, MD is a vibrant workspace that will surely energize and inspire employees. The move-in ready space includes a mix of private offices and meeting spaces, as well as several distinct and open workstations. Breakout areas are scattered throughout the space, and there is an abundance of natural light. This Class A+ office space is a rare opportunity to join a popular neighborhood that is easily accessible and walkable to amenities.

## SPACE HIGHLIGHTS

- Excellent combination of open office, with huddle and conference rooms scattered throughout
- Creative breakout areas located within the space to allow for flexible workspaces
- Open kitchen area that promotes collaboration and excitement
- High-end finishes, including lots of glass, polished concrete floors & high ceilings
- Move-in ready

## BUILDING HIGHLIGHTS

- Luxury gym with Peloton Bikes, showers and towel service
- Free parking in the in-building garage
- Easy access to Rte. 175, Rte. 29 and I-95

## LEASE INFORMATION

- 18,400 RSF
- Lease Term: 3/31/29

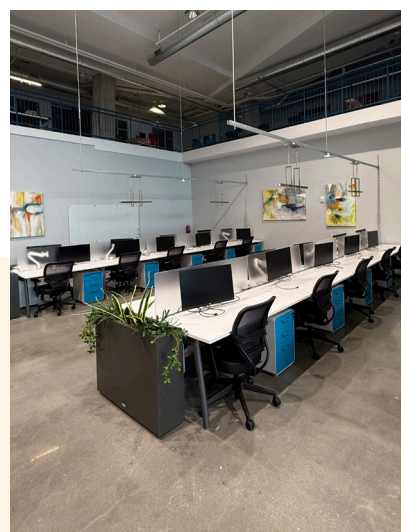

# FLOOR PLAN

## GROUND FLOOR

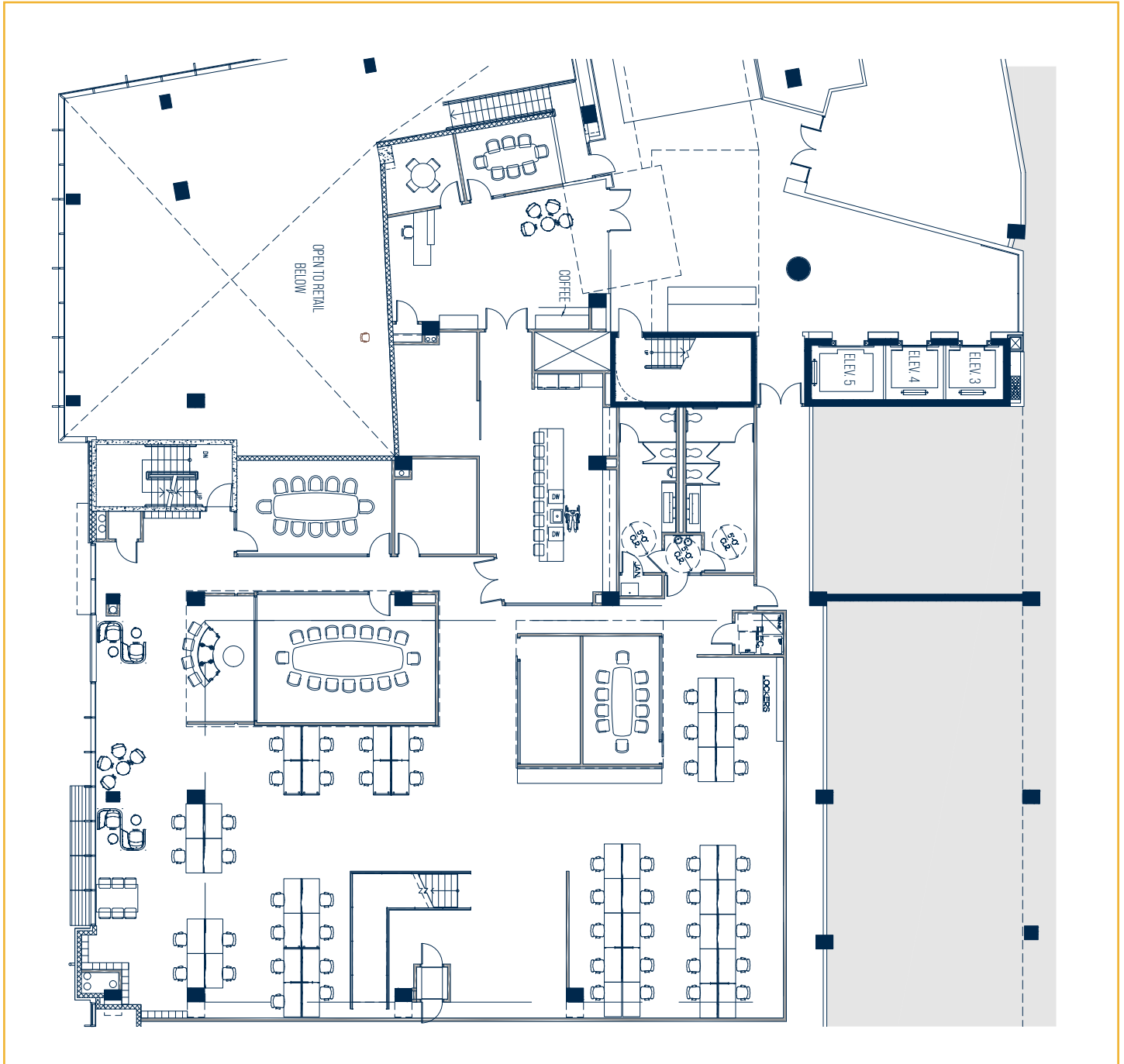

# FLOOR PLAN

## MEZZANINE

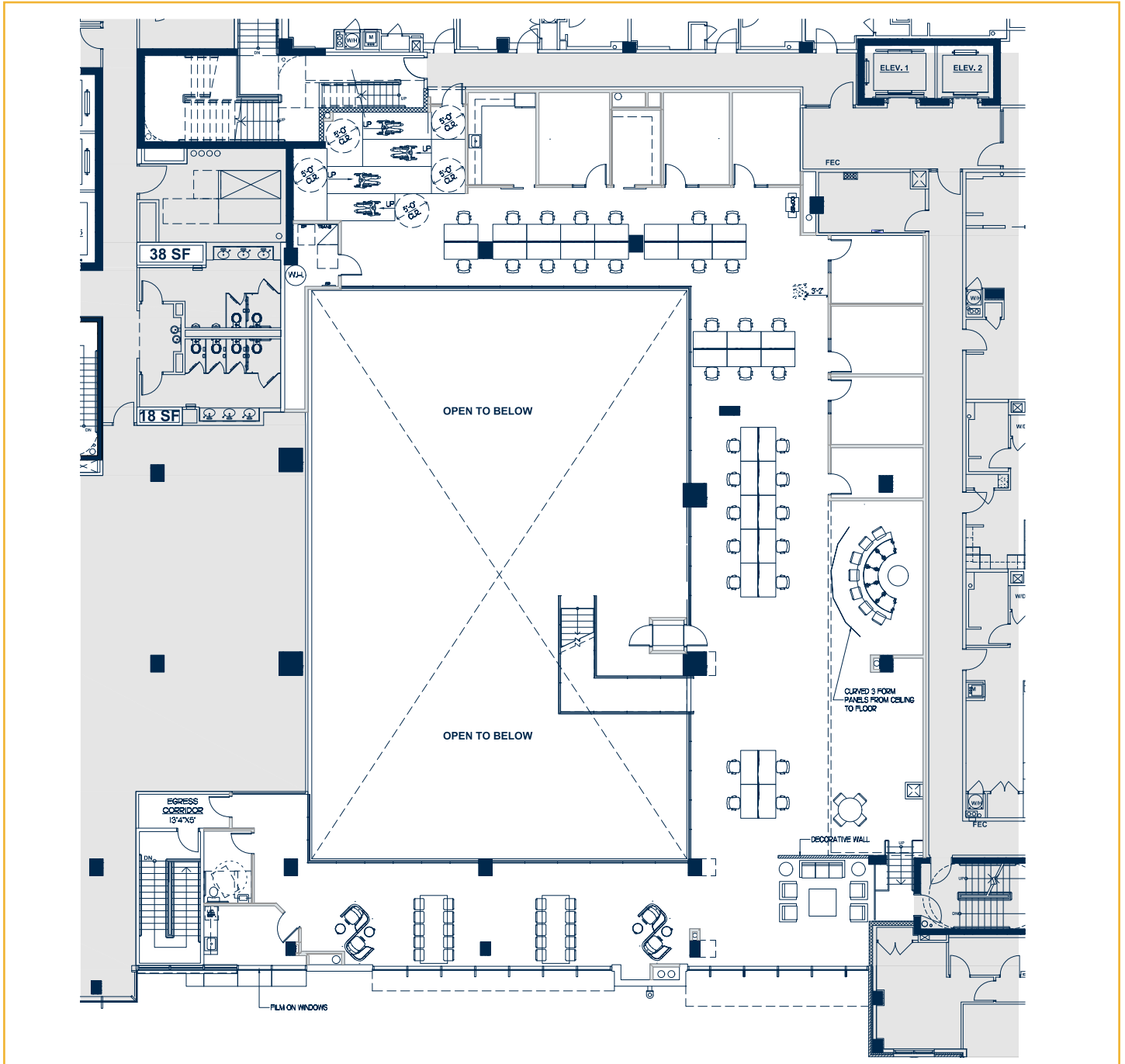





## CONTACT

### MATTHEW SEWARD

Senior Director

+1 410 347 7549

matthew.seward@cushwake.com

### ALEXANDER MITCHELL

Director

+1 410 347 7546

alexander.mitchell@cushwake.com

One East Pratt Street, Suite 700

Baltimore, MD 21202

+1 410 752 4285

[cushmanwakefield.com](http://cushmanwakefield.com)

©2025 Cushman & Wakefield. All rights reserved. The information contained in this communication is strictly confidential. This information has been obtained from sources believed to be reliable but has not been verified. NO WARRANTY OR REPRESENTATION, EXPRESS OR IMPLIED, IS MADE AS TO THE CONDITION OF THE PROPERTY (OR PROPERTIES) REFERENCED HEREIN OR AS TO THE ACCURACY OR COMPLETENESS OF THE INFORMATION CONTAINED HEREIN, AND SAME IS SUBMITTED SUBJECT TO ERRORS, OMISSIONS, CHANGE OF PRICE, RENTAL OR OTHER CONDITIONS, WITHDRAWAL WITHOUT NOTICE, AND TO ANY SPECIAL LISTING CONDITIONS IMPOSED BY THE PROPERTY OWNER(S). ANY PROJECTIONS, OPINIONS OR ESTIMATES ARE SUBJECT TO UNCERTAINTY AND DO NOT SIGNIFY CURRENT OR FUTURE PROPERTY PERFORMANCE.



**CUSHMAN &  
WAKEFIELD**