

Reflection Lakes Commons

13550 Reflections Pkwy

Fort Myers, FL



CUSHMAN &
WAKEFIELD

COMMERCIAL
PROPERTY
SOUTHWEST FLORIDA



For Lease

Property Highlights

- Excellent exposure at a signalized intersection
- Busy, mixed-use center!
- Desirable retail and office corridor
- High traffic and demographics
- Easy access to major corridors
- Pylon signage and property directory
- Ample parking
- Jason's Deli on long-term lease
- Other tenants include Jet's Pizza, Ninja Sushi, Indra Yoga, Slim Now, Mon Paris French Bakery & more...

PROPERTY TYPE

Retail

YEAR BUILT

2001

ZONING

CC

PARKING

7.54/1,000 sf

SUBMARKET

S Ft Myers / San Carlos

GARY TASMAN
CEO & Principal Broker
(239) 489-3600
gtasman@cpswfl.com

GRETCHEN SMITH
Senior Director
(239) 489-3600
gsmith@cpswfl.com

Better never settles

Reflection Lakes Commons

13550 Reflections Pkwy

Fort Myers, FL

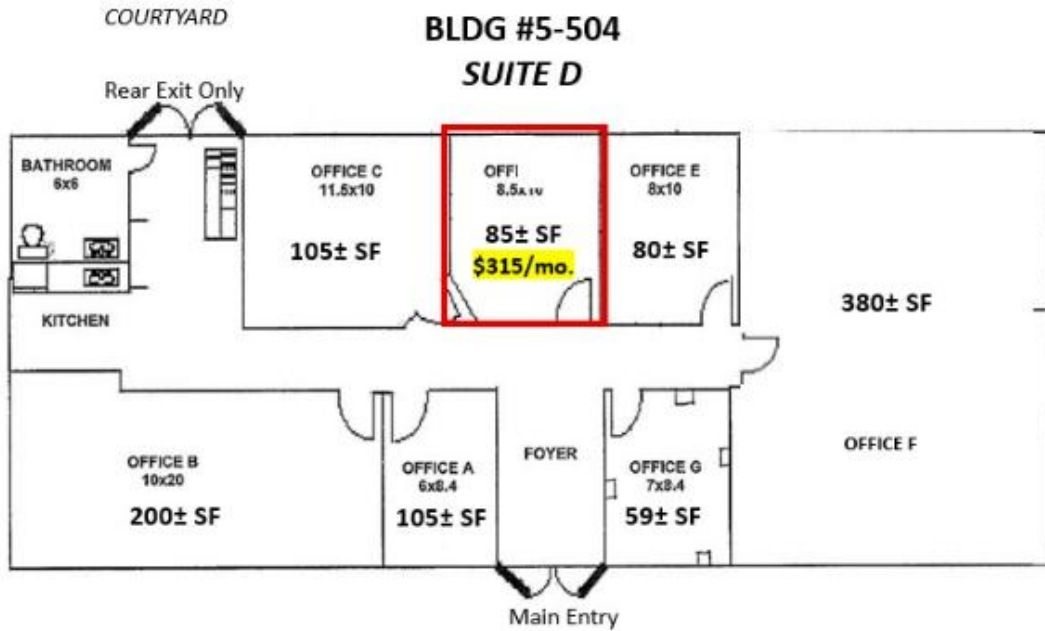

Unit	Unit Size	Monthly Rent	Available
5-504D	85 SF	\$315.00	07/01/2026



GARY TASMAN
 CEO & Principal Broker
 (239) 489-3600
gtasman@cpswfl.com

GRETCHEN SMITH
 Senior Director
 (239) 489-3600
gsmith@cpswfl.com

Better never settles