



ONE  
POST



# FIRST IMPRESSION



424,000 square feet office tower



striking two-story glass lobby



modern, collaborative lobby space



destination dispatch elevators



24/7 security

# M O V E SEAMLESSLY



 exclusive tenant-only fitness facility with showers and lockers

 secured bike storage room

 direct access to mass transit

1 min walk to BART

7 min walk to Ferry Building

2 blocks from Union Square



**100% OF THE ELECTRICITY REQUIREMENTS FOR THE SAN FRANCISCO OFFICE PORTFOLIO SUPPLIED THROUGH LOCAL SOLAR AND WIND POWER BY 2026.**

BROOKFIELD PROPERTIES

**ESG**

## BENEFITS TO TENANTS

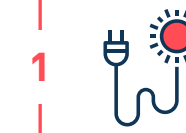

**INCREASES** demand for finite zero emissions electricity supply, incentivizing new development and improving the mix of in-state clean energy sources.



**SUPPORTS** the development of new community-focused clean energy supply, green jobs, and investment into the local community.

**WE WILL ACHIEVE** this by procuring power through the Clean Power SF "Super Green Program", a local community choice aggregation program provided from the SF public utilities commission that provides renewable electricity from solar and wind power facilities to customers.



**Zero Emissions Electricity**





# ELEVATE YOUR SPACE



-  range of customizable suites
-  panoramic city and bay views
-  11,000 square foot floor plates



Rendering by HLW

# E N H A N C E Y O U R EXPERIENCE



Rendering by HLW



Rendering by HLW

## ELEVATE YOUR WORKDAY AT ONE POST'S NEW AMENITY SPACE.

- Tenant Lounge
- Conference Center  
with Boardroom
- Cafe Dining Space
- Casual Meeting &  
Collaboration Areas

## ARRIVE READY.

Furnished and expertly designed workspaces that seamlessly transform to move-in ready space with integrated technology and more.

- + **In-Suite Amenities:** AV-equipped meeting rooms, pantries, offices, lounges, and more
- + **Furniture:** Elevated, high-quality solutions
- + **Technology:** Enterprise AV, security and high-speed networks
- + **Workplace:** Custom refreshment programs, vendor management and support



# A V A I L A B L E SUITES

2900	11,800 RSF	shell condition
2685	1,144 RSF	
2160	967 RSF	
2150	2,855 RSF	perimeter private office intensive
2000	11,109 RSF	to be delivered fully furnished
1050	4,693 RSF	
1025	2,582 RSF	mix of private offices & open space
950	4,183 RSF	private office intensive
850	2,904 RSF	
825	5,685 RSF	
650**	3,244 RSF	to be delivered in shell condition
600**	8,193 RSF	private office intensive
500	4,498 RSF	private office intensive space
375	4,614 RSF	
200	11,437 RSF	amenity space

\*\*Suite 600 & Suite 650 can be leased separately or together as one full floor for a total of 11,383 RSF

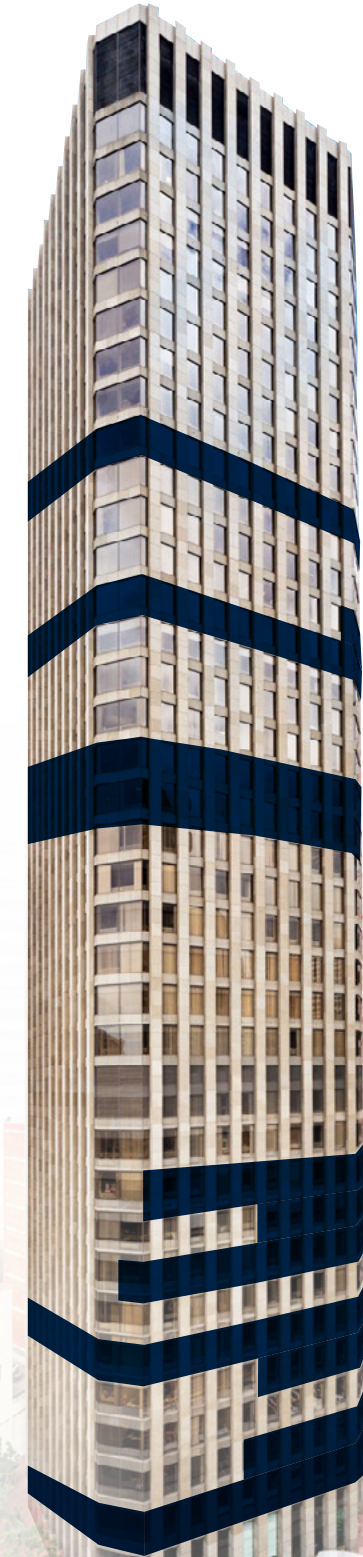

# 2ND FLOOR

Tenant Lounge and Conferencing Center

ONE  
POST

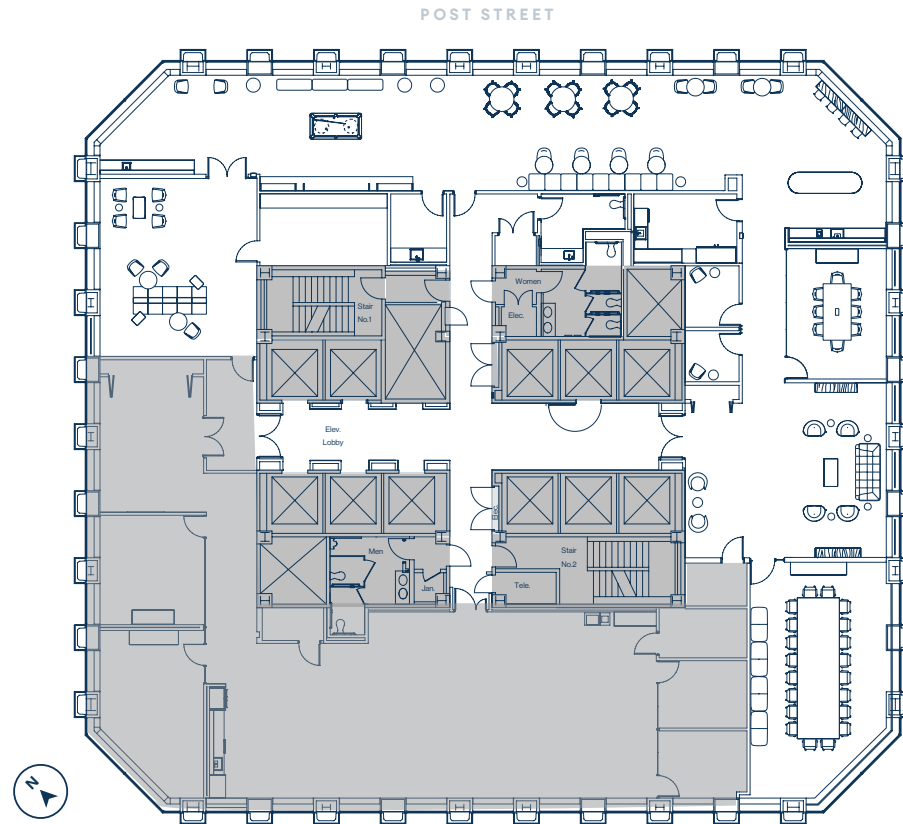

# 3RD FLOOR

Suite	375
Size (RSF)	4,614
Date Available	Now

- 3 Meeting rooms
- 3 Private offices
- Great natural light
- Views overlooking One Montgomery Public Park

ONE  
POST

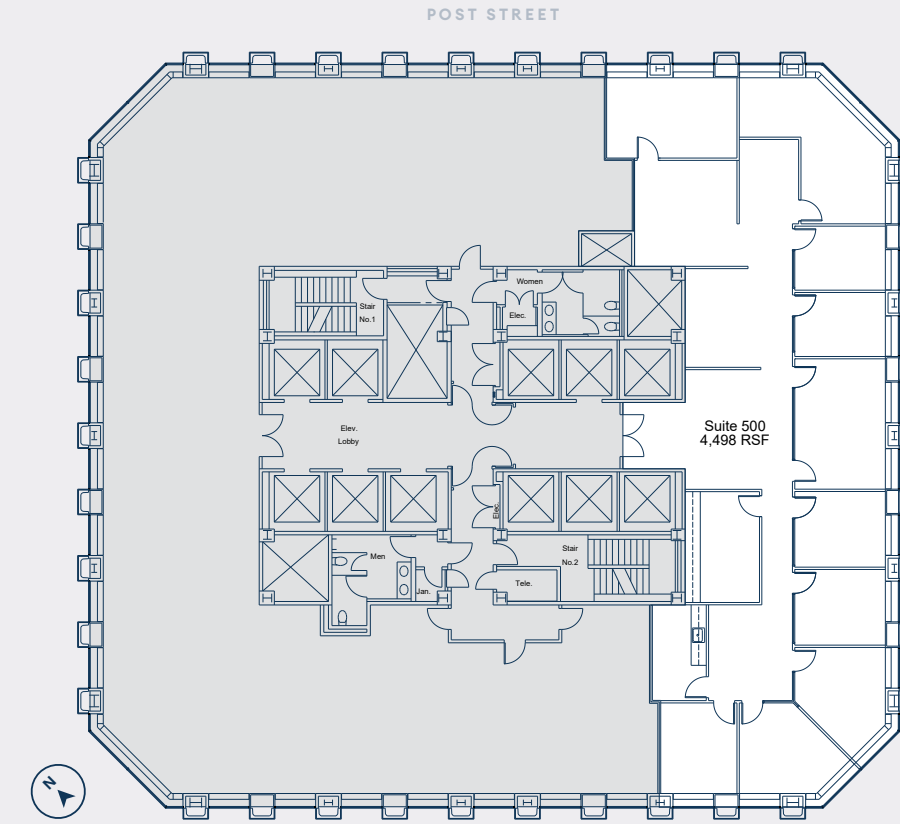

**MATTHEW SHEWEY**  
Senior Managing Director  
415.395.7255  
matt.shewey@jll.com  
License 01445125

**JAK CHURTON**  
Managing Director  
415.395.7292  
jak.churton@jll.com  
License 01277724

**CHARLIE HANAFIN**  
Senior Vice President  
415.395.4951  
charlie.hanafin@jll.com  
License 01996121

**CHRISTOPHER T. ROEDER**  
Vice Chairman  
415.395.4971  
chris.roeder@jll.com  
License 01190523

**JLL** | **Brookfield Properties**  
Jones Lang LaSalle Americas, Inc.  
Real Estate License #01856260

**MATTHEW SHEWEY**  
Senior Managing Director  
415.395.7255  
matt.shewey@jll.com  
License 01445125

**JAK CHURTON**  
Managing Director  
415.395.7292  
jak.churton@jll.com  
License 01277724

**CHARLIE HANAFIN**  
Senior Vice President  
415.395.4951  
charlie.hanafin@jll.com  
License 01996121

**CHRISTOPHER T. ROEDER**  
Vice Chairman  
415.395.4971  
chris.roeder@jll.com  
License 01190523

**JLL** | **Brookfield Properties**  
Jones Lang LaSalle Americas, Inc.  
Real Estate License #01856260

# 5TH FLOOR

ONE  
POST

Suite	500	Great outlooks Private office intensive space
Size (RSF)	4,498	9 Private offices 1 conference room Kitchen
Date Available	Now	Production area

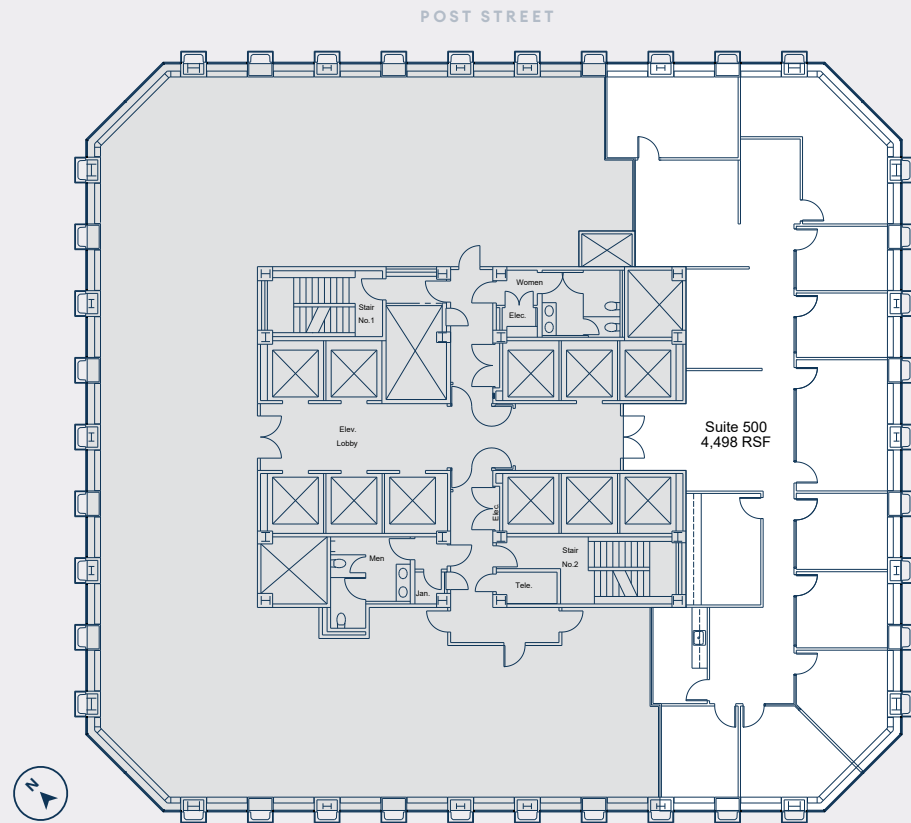

# 6TH FLOOR

ONE  
POST

Suite	600	15 Window-lined private offices 3 Internal conference rooms, 1 Large board room
Size (RSF)	8,193	Double door identity Private office intensive
Date Available	Now	**Can be combined with Suite 650 for a total of 11,437 RSF.

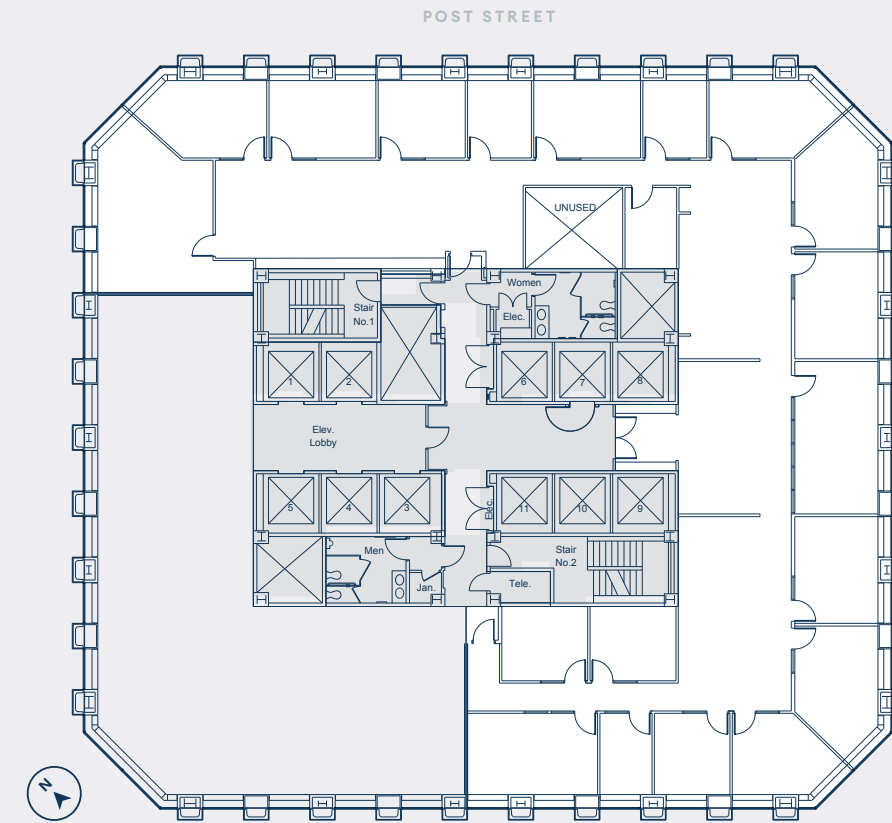

[Click for Virtual Tour](#)

**MATTHEW SHEWEY**  
Senior Managing Director  
415.395.7255  
matt.shewey@jll.com  
License 01445125

**JAK CHURTON**  
Managing Director  
415.395.7292  
jak.churton@jll.com  
License 01277724

**CHARLIE HANAFIN**  
Senior Vice President  
415.395.4951  
charlie.hanafin@jll.com  
License 01996121

**CHRISTOPHER T. ROEDER**  
Vice Chairman  
415.395.4971  
chris.roeder@jll.com  
License 01190523

**JLL** | **Brookfield Properties**  
Jones Lang LaSalle Americas, Inc.  
Real Estate License #01856260

**MATTHEW SHEWEY**  
Senior Managing Director  
415.395.7255  
matt.shewey@jll.com  
License 01445125

**JAK CHURTON**  
Managing Director  
415.395.7292  
jak.churton@jll.com  
License 01277724

**CHARLIE HANAFIN**  
Senior Vice President  
415.395.4951  
charlie.hanafin@jll.com  
License 01996121

**CHRISTOPHER T. ROEDER**  
Vice Chairman  
415.395.4971  
chris.roeder@jll.com  
License 01190523

**JLL** | **Brookfield Properties**  
Jones Lang LaSalle Americas, Inc.  
Real Estate License #01856260

# 6TH FLOOR

Suite	650
Size (RSF)	3,244
Date Available	Now

Second generation space

\*\*Can be combined with Suite 600 for a total of 11,437 RSF.

ONE  
POST

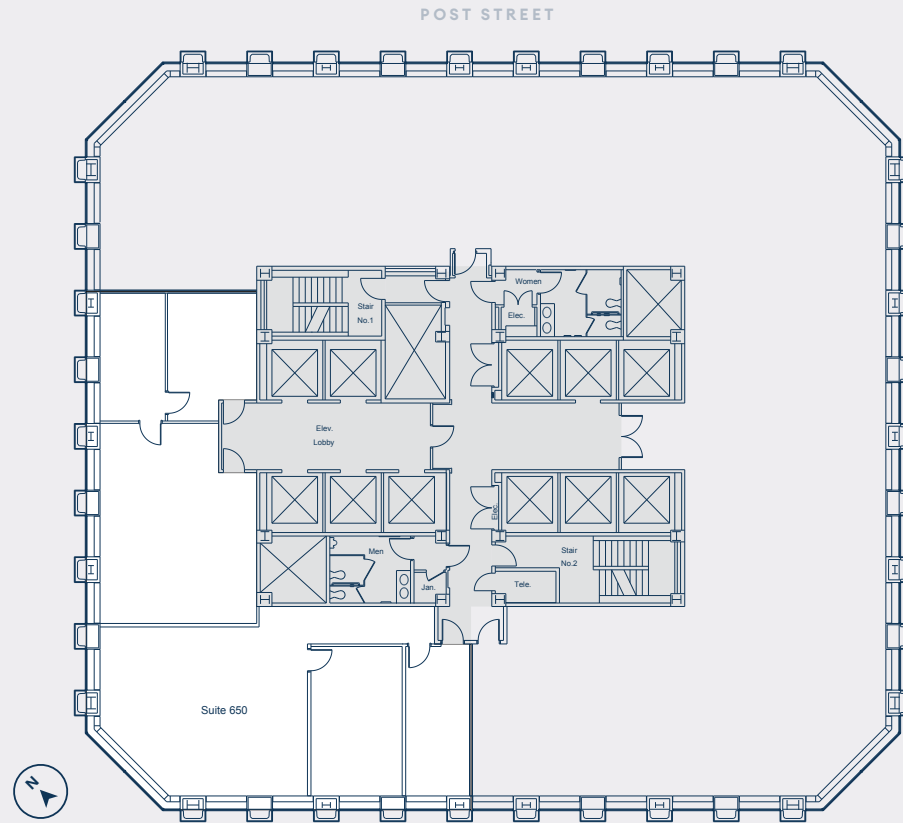

# 8TH FLOOR

Suite	825
Size (RSF)	5,685
Date Available	Now

1 Board room  
7 Private offices / meeting rooms  
Significant open space  
Double door entry

ONE  
POST

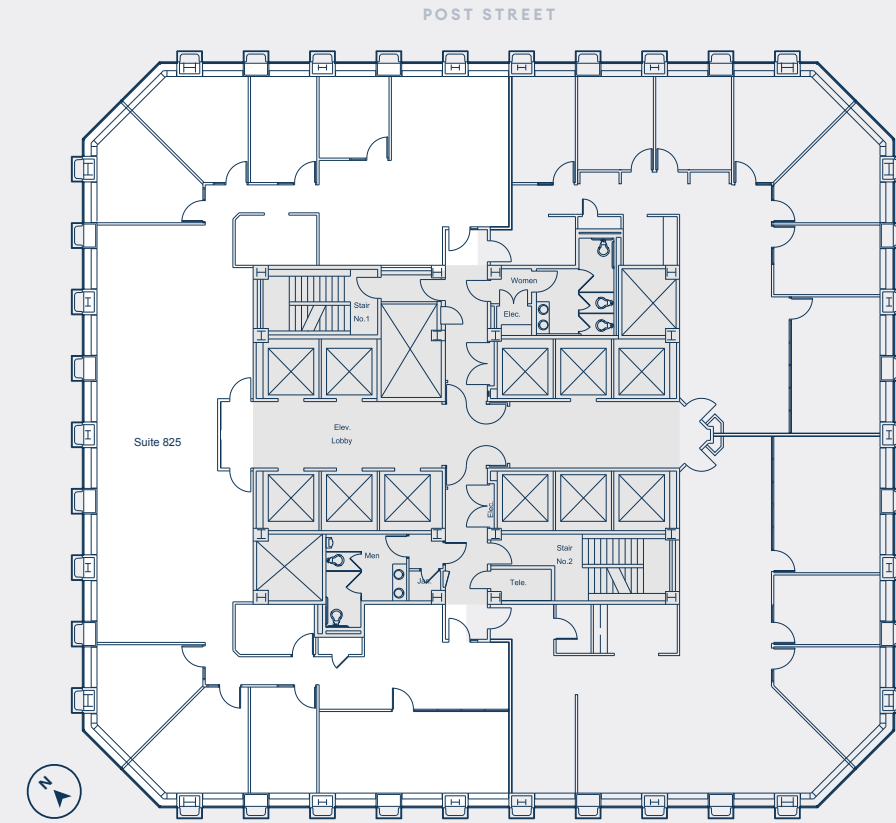

[Click for Virtual Tour](#)

**MATTHEW SHEWEY**  
Senior Managing Director  
415.395.7255  
matt.shewey@jll.com  
License 01445125

**JAK CHURTON**  
Managing Director  
415.395.7292  
jak.churton@jll.com  
License 01277724

**CHARLIE HANAFIN**  
Senior Vice President  
415.395.4951  
charlie.hanafin@jll.com  
License 01996121

**CHRISTOPHER T. ROEDER**  
Vice Chairman  
415.395.4971  
chris.roeder@jll.com  
License 01190523

**JLL** | **Brookfield Properties**  
Jones Lang LaSalle Americas, Inc.  
Real Estate License #01856260

**MATTHEW SHEWEY**  
Senior Managing Director  
415.395.7255  
matt.shewey@jll.com  
License 01445125

**JAK CHURTON**  
Managing Director  
415.395.7292  
jak.churton@jll.com  
License 01277724

**CHARLIE HANAFIN**  
Senior Vice President  
415.395.4951  
charlie.hanafin@jll.com  
License 01996121

**CHRISTOPHER T. ROEDER**  
Vice Chairman  
415.395.4971  
chris.roeder@jll.com  
License 01190523

**JLL** | **Brookfield Properties**  
Jones Lang LaSalle Americas, Inc.  
Real Estate License #01856260

# 8TH FLOOR

Suite	850	Improved law firm space 6 Window-lined private offices
Size (RSF)	2,904	1 Boardroom Great natural light
Date Available	Now	

ONE  
POST

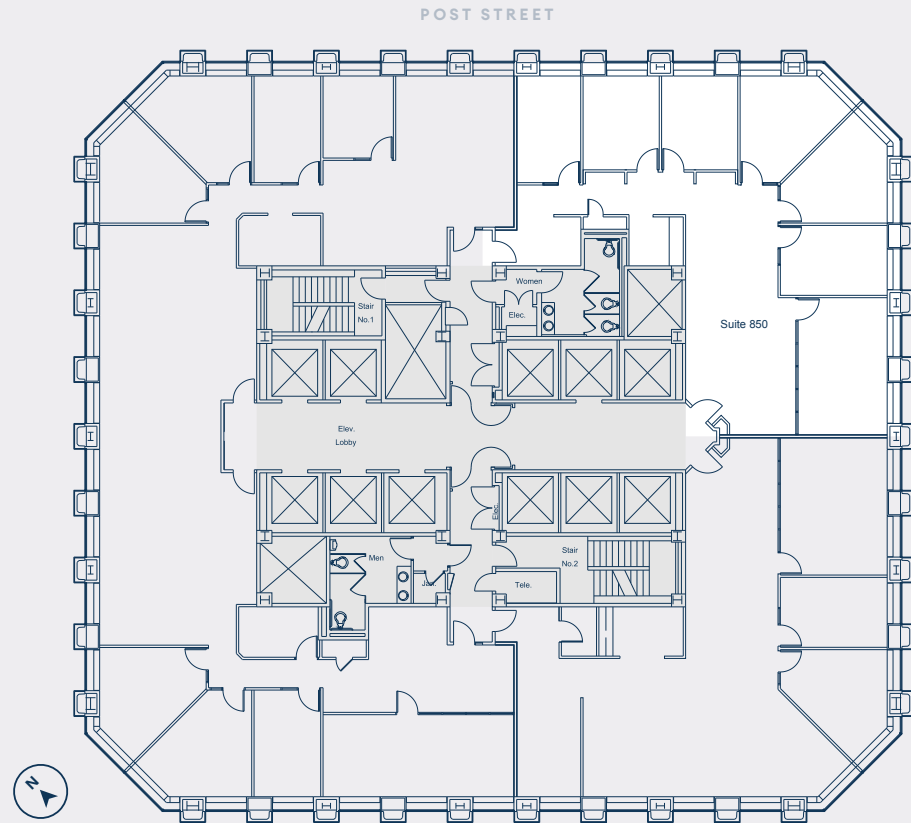

# 9TH FLOOR

Suite	950	Improved law firm space 12 Private offices
Size (RSF)	4,183	1 Boardroom
Date Available	Now	

ONE  
POST

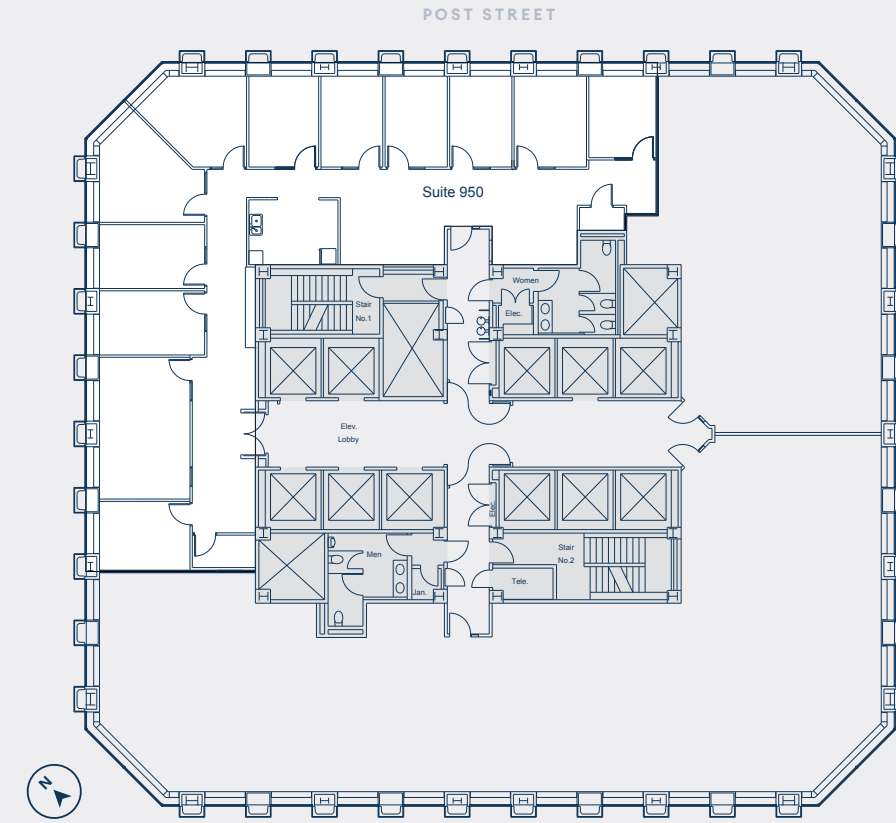

Click for Virtual Tour

**MATTHEW SHEWEY**  
Senior Managing Director  
415.395.7255  
matt.shewey@jll.com  
License 01445125

**JAK CHURTON**  
Managing Director  
415.395.7292  
jak.churton@jll.com  
License 01277724

**CHARLIE HANAFIN**  
Senior Vice President  
415.395.4951  
charlie.hanafin@jll.com  
License 01996121

**CHRISTOPHER T. ROEDER**  
Vice Chairman  
415.395.4971  
chris.roeder@jll.com  
License 01190523

**JLL** | **Brookfield Properties**  
Jones Lang LaSalle Americas, Inc.  
Real Estate License #01856260

**MATTHEW SHEWEY**  
Senior Managing Director  
415.395.7255  
matt.shewey@jll.com  
License 01445125

**JAK CHURTON**  
Managing Director  
415.395.7292  
jak.churton@jll.com  
License 01277724

**CHARLIE HANAFIN**  
Senior Vice President  
415.395.4951  
charlie.hanafin@jll.com  
License 01996121

**CHRISTOPHER T. ROEDER**  
Vice Chairman  
415.395.4971  
chris.roeder@jll.com  
License 01190523

**JLL** | **Brookfield Properties**  
Jones Lang LaSalle Americas, Inc.  
Real Estate License #01856260

# 10TH FLOOR

Suite	1025	1 Boardroom 2 Private offices Open space
Size (RSF)	2,582	
Date Available	Now	**Can be combined with Suite 1050 for a total of 7,275 RSF.

ONE  
POST

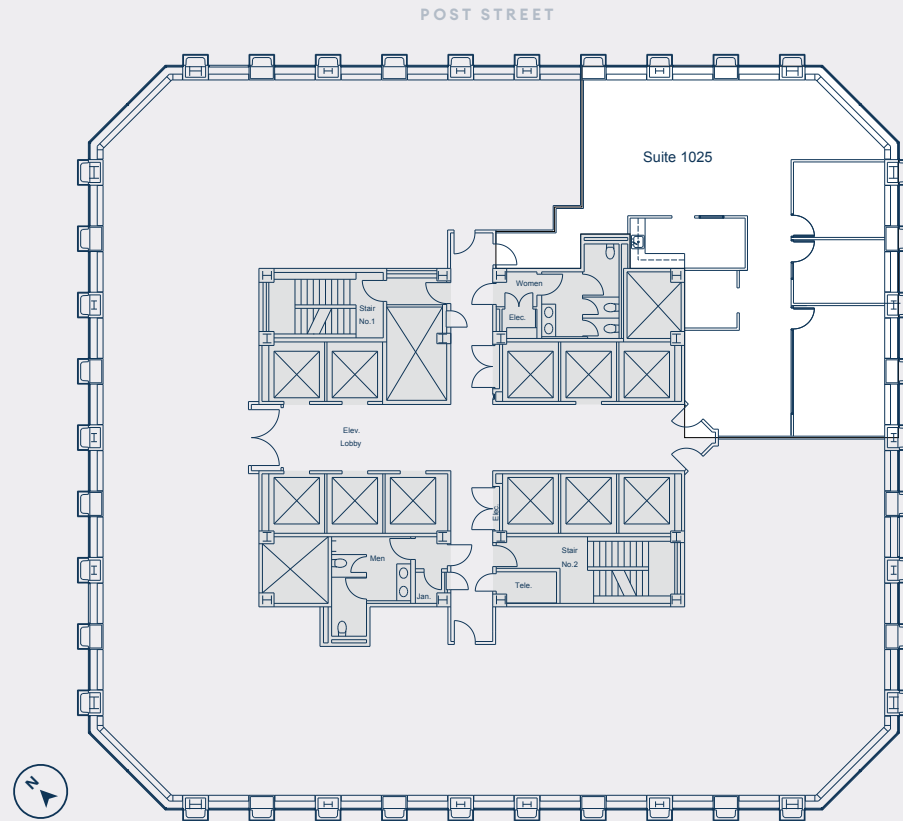

# 10TH FLOOR

Suite	1050	3 offices 1 large conference 1 medium conference Open kitchen
Size (RSF)	4,693	
Date Available	Now	**Can be combined with Suite 1025 for a total of 7,275 RSF.

ONE  
POST

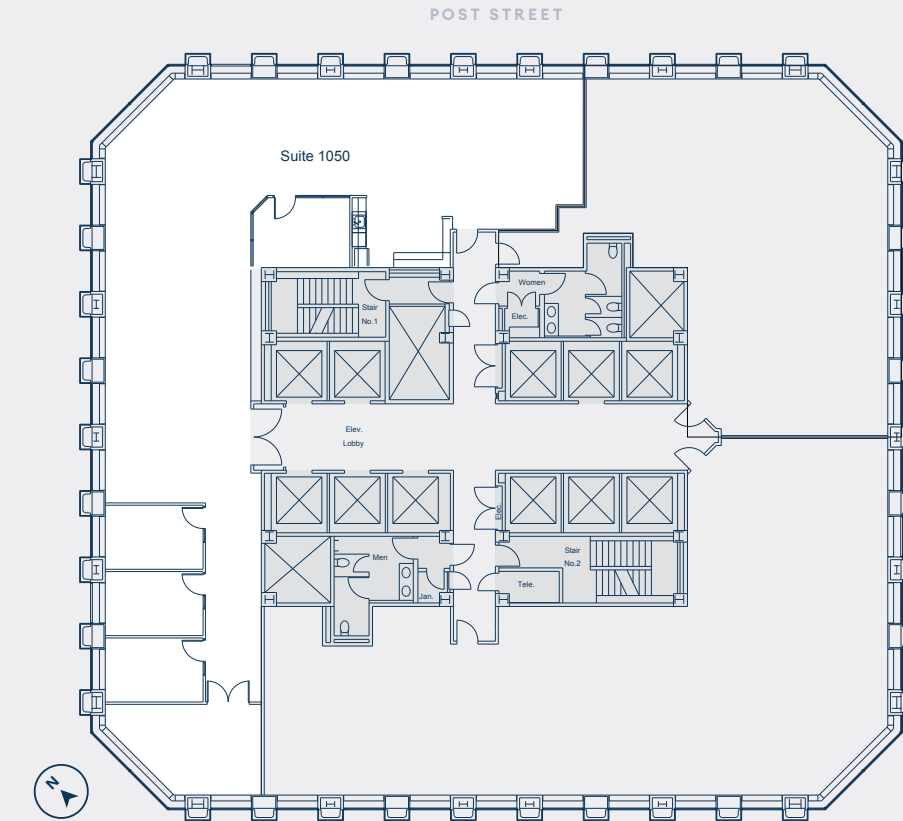

Click for Virtual Tour

**MATTHEW SHEWEY**  
Senior Managing Director  
415.395.7255  
matt.shewey@jll.com  
License 01445125

**JAK CHURTON**  
Managing Director  
415.395.7292  
jak.churton@jll.com  
License 01277724

**CHARLIE HANAFIN**  
Senior Vice President  
415.395.4951  
charlie.hanafin@jll.com  
License 01996121

**CHRISTOPHER T. ROEDER**  
Vice Chairman  
415.395.4971  
chris.roeder@jll.com  
License 01190523

**JLL** | **Brookfield Properties**  
Jones Lang LaSalle Americas, Inc.  
Real Estate License #01856260

**MATTHEW SHEWEY**  
Senior Managing Director  
415.395.7255  
matt.shewey@jll.com  
License 01445125

**JAK CHURTON**  
Managing Director  
415.395.7292  
jak.churton@jll.com  
License 01277724

**CHARLIE HANAFIN**  
Senior Vice President  
415.395.4951  
charlie.hanafin@jll.com  
License 01996121

**CHRISTOPHER T. ROEDER**  
Vice Chairman  
415.395.4971  
chris.roeder@jll.com  
License 01190523

**JLL** | **Brookfield Properties**  
Jones Lang LaSalle Americas, Inc.  
Real Estate License #01856260

# 20TH FLOOR

Suite	2000	Full floor creative spec suite to be delivered fully furnished
Size (RSF)	11,109	
Date Available	8/1/26	

ONE  
POST



# 21ST FLOOR

Suite	2150	Former law firm space Grand reception 4 Private offices 1 Large conference room
Size (RSF)	2,855	
Date Available	Now	**Can be leased separately or together with Suite 2160.

ONE  
POST

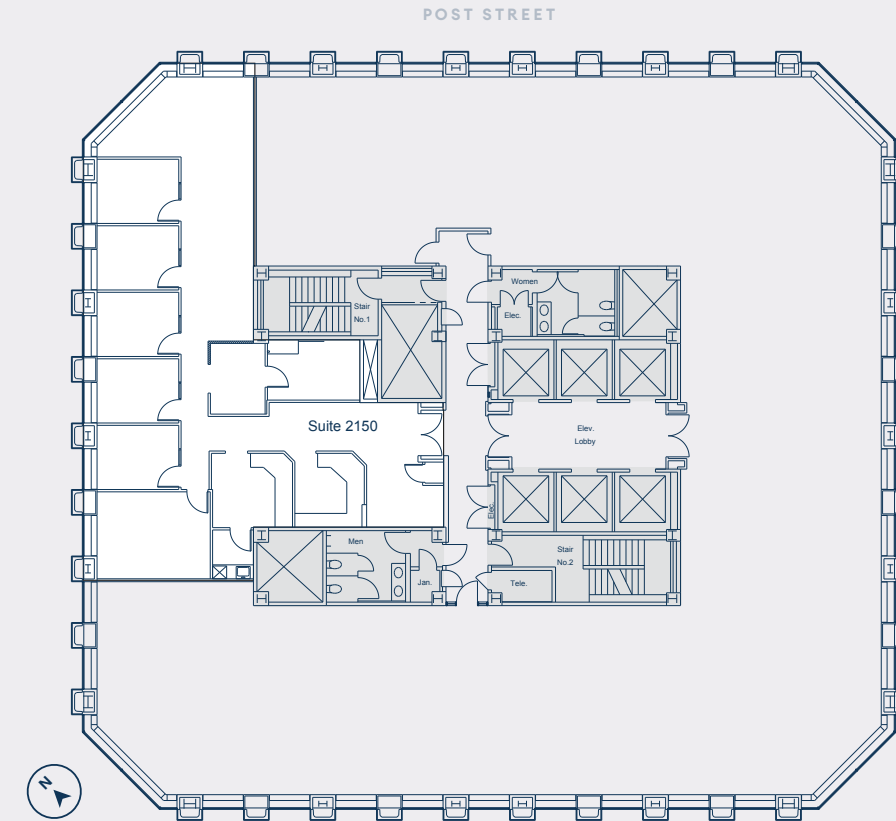

Click for Virtual Tour

**MATTHEW SHEWEY**  
Senior Managing Director  
415.395.7255  
matt.shewey@jll.com  
License 01445125

**JAK CHURTON**  
Managing Director  
415.395.7292  
jak.churton@jll.com  
License 01277724

**CHARLIE HANAFIN**  
Senior Vice President  
415.395.4951  
charlie.hanafin@jll.com  
License 01996121

**CHRISTOPHER T. ROEDER**  
Vice Chairman  
415.395.4971  
chris.roeder@jll.com  
License 01190523

**JLL** | **Brookfield Properties**  
Jones Lang LaSalle Americas, Inc.  
Real Estate License #01856260

**MATTHEW SHEWEY**  
Senior Managing Director  
415.395.7255  
matt.shewey@jll.com  
License 01445125

**JAK CHURTON**  
Managing Director  
415.395.7292  
jak.churton@jll.com  
License 01277724

**CHARLIE HANAFIN**  
Senior Vice President  
415.395.4951  
charlie.hanafin@jll.com  
License 01996121

**CHRISTOPHER T. ROEDER**  
Vice Chairman  
415.395.4971  
chris.roeder@jll.com  
License 01190523

**JLL** | **Brookfield Properties**  
Jones Lang LaSalle Americas, Inc.  
Real Estate License #01856260

# 21ST FLOOR

Suite	2160
Size (RSF)	967
Date Available	Now

Can be leased separately or together with Suite 2150

ONE  
POST

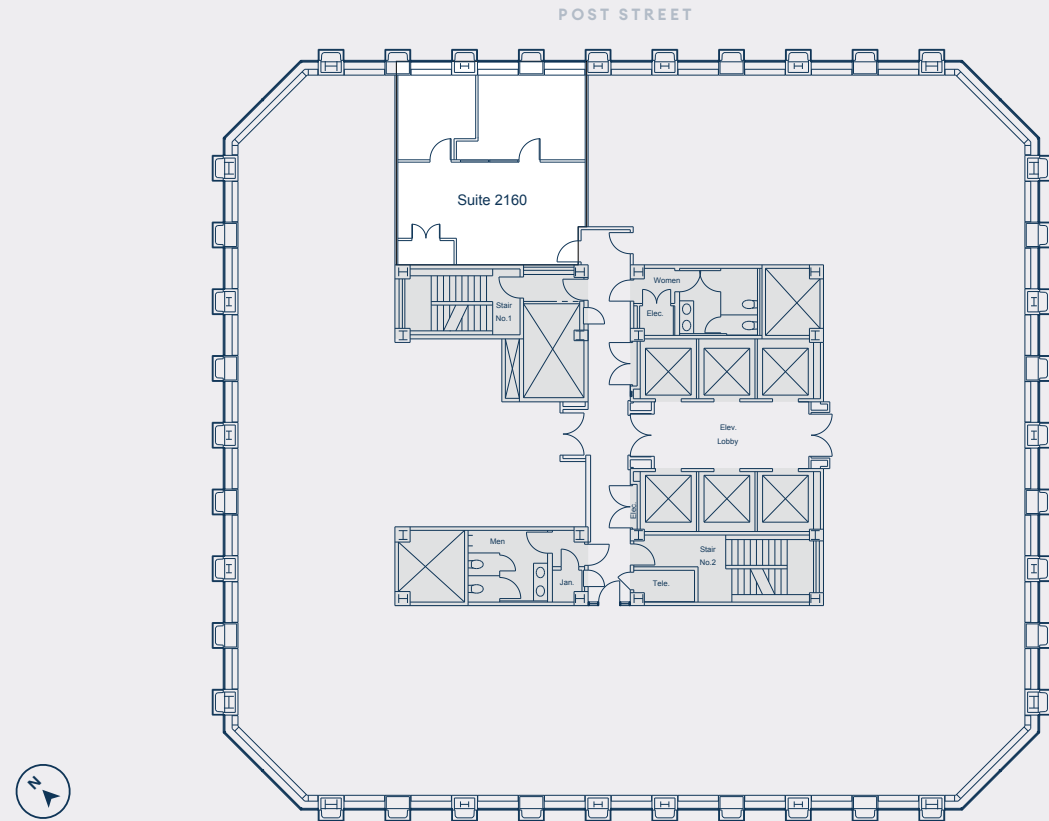

# 29TH FLOOR

Suite	2900
Size (RSF)	11,800
Date Available	Now

To be delivered in shell condition  
Full 360 San Francisco Bay & city views

ONE  
POST

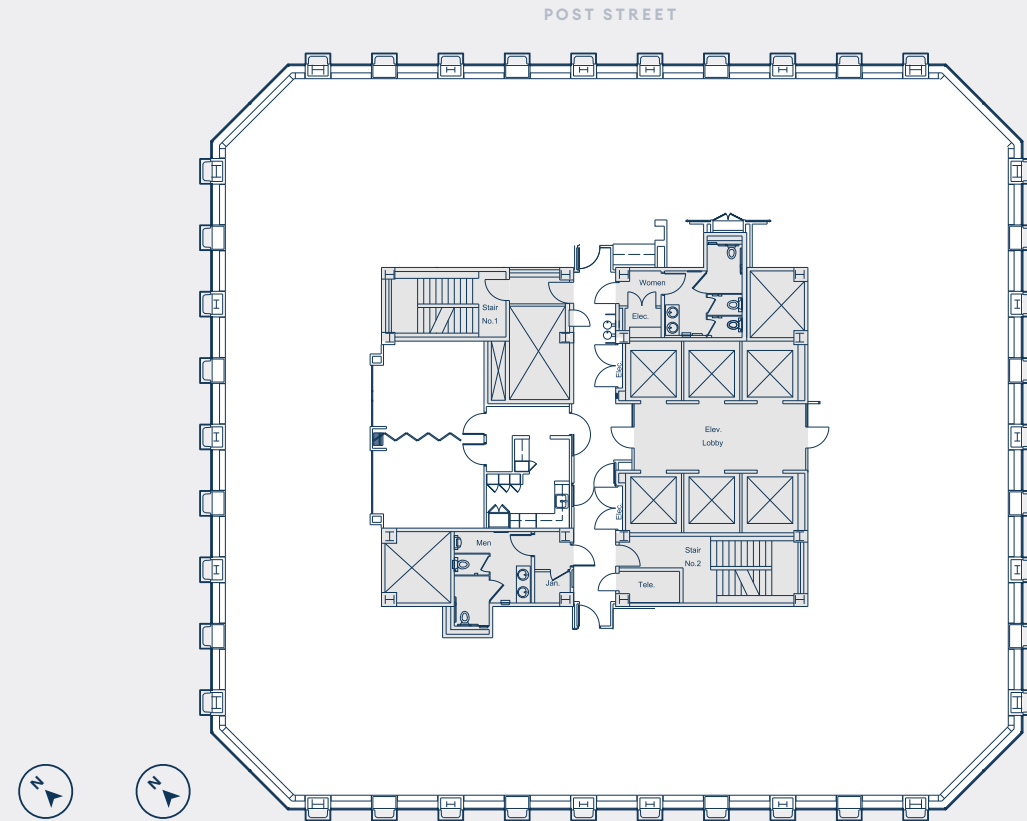

**MATTHEW SHEWEY**  
Senior Managing Director  
415.395.7255  
matt.shewey@jll.com  
License 01445125

**JAK CHURTON**  
Managing Director  
415.395.7292  
jak.churton@jll.com  
License 01277724

**CHARLIE HANAFIN**  
Senior Vice President  
415.395.4951  
charlie.hanafin@jll.com  
License 01996121

**CHRISTOPHER T. ROEDER**  
Vice Chairman  
415.395.4971  
chris.roeder@jll.com  
License 01190523

**JLL** | **Brookfield Properties**  
Jones Lang LaSalle Americas, Inc.  
Real Estate License #01856260

**MATTHEW SHEWEY**  
Senior Managing Director  
415.395.7255  
matt.shewey@jll.com  
License 01445125

**JAK CHURTON**  
Managing Director  
415.395.7292  
jak.churton@jll.com  
License 01277724

**CHARLIE HANAFIN**  
Senior Vice President  
415.395.4951  
charlie.hanafin@jll.com  
License 01996121

**CHRISTOPHER T. ROEDER**  
Vice Chairman  
415.395.4971  
chris.roeder@jll.com  
License 01190523

**JLL** | **Brookfield Properties**  
Jones Lang LaSalle Americas, Inc.  
Real Estate License #01856260



ield  
es

s, Inc.  
6260

## LEASING INFORMATION

**MATTHEW SHEWEY**  
Senior Managing Director  
☎ 415.395.7255  
✉ matt.shewey@jll.com  
# License 01445125

**JAK CHURTON**  
Managing Director  
☎ 415.395.7292  
✉ jak.churton@jll.com  
# License 01277724

**CHARLIE HANAFIN**  
Senior Vice President  
☎ 415.395.4951  
✉ charlie.hanafin@jll.com  
# License 01996121

**CHRISTOPHER T. ROEDER**  
Vice Chairman  
☎ 415.395.4971  
✉ chris.roeder@jll.com  
# License 01190523

