

THE CENTRE AT NAVARRRO

UNITS FOR LEASE



**SOUTH
TEXAS**
RENTALS.COM

NORTH NAVARRO RD

Jason's deli

**Jack
in the box**

**63,000+ DAILY
TRAFFIC COUNT**

**UP TO 18,000 SQFT
PAD SITE AVAILABLE**

**1050 SQFT
AVAILABLE**

**2500 SQFT
AVAILABLE**

Walgreens

**H-E-B
TOYOTA**

**SUPERCUTS
NUTRI-FUEL
SMOOTHIES & SUPPLEMENTS
WING-STOP**

ALDI

**planet
fitness**

AVAILABLE SPACES

Unit	SQFT	NNN
Pad Site	Up to 18,000 SQFT	\$25.00 / SF / YR
Rose Nail	1050 SQFT	\$25.00 / SF / YR
Vacant Suite	2500 SQFT	\$25.00 / SF / YR



ABOUT THE PROPERTY

The Centre at Navarro, a 25,000 square foot retail center located in the affluent and rapidly growing community of Victoria, TX is composed of a mix of national and regional quick service restaurants, personal care, and service tenants. The Centre at Navarro is strategically located in a high traffic area (63,000+ Average Daily Traffic Count), surrounded by many national retail brands including Walgreens, Aldi, and many others.

DEMOGRAPHICS

- Traffic Count: 63,419
- Total Population: 92,678 (25 mi)
- Population Projection 2026: 94,047

\$25/ SF / YR

Vacant Suite | 1050+ SQFT

This commercial property is located in the hub of North Navarro on a traffic controlled intersection, with a daily traffic count of 63,000+. Located in The Centre at Navarro along with Planet Fitness, WingStop, Supercuts, Nutri-Fuel, and many more stores, making this a perfect location for any business. 1,050 sq. feet with a nice, open floor plan offering endless possibilities! Pylon sign slot is available. *Terms are negotiable*

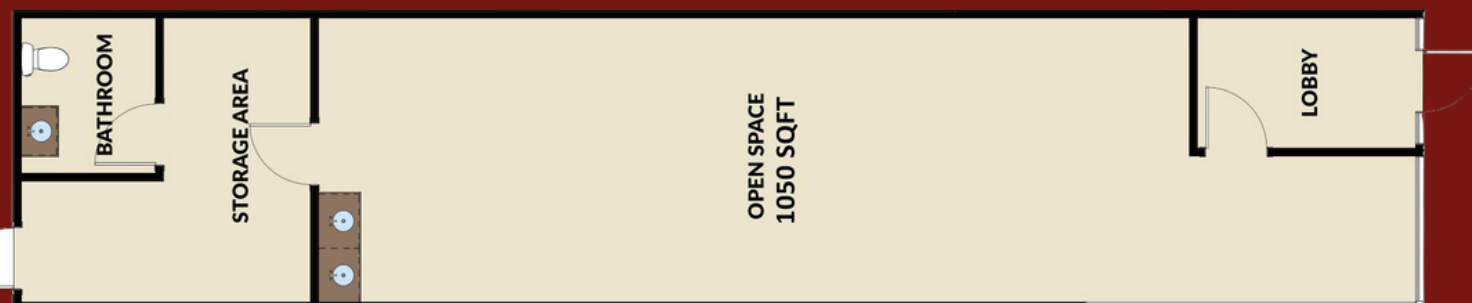

\$25/ SF / YR

Vacant Suite | 2500 SQFT

This commercial property is located in the hub of North Navarro on a traffic controlled intersection, with a daily traffic count of 63,000+. Located in The Centre at Navarro along with Planet Fitness, WingStop, Supercuts, Nutri-Fuel, and many more stores, making this a perfect location for any business. 2500 sq. feet with a nice, open floor plan offering endless possibilities! Pylon sign slot is available. The rate will include tenant build out or allowance. *Terms are negotiable*

AVAILABLE SPACE
2,500 SQ FT



\$25/ SF / YR

Pad Site | Up To 18,000 SQFT

This vacant pad site is located in the hub of North Navarro on a traffic controlled intersection, with a daily traffic count of 63,000+. Located in The Centre at Navarro along with Planet Fitness, WingStop, Supercuts, Nutri-Fuel, and many more stores, making this a perfect location for any business. Pylon sign slot is available. The rate will include tenant build to suit or allowance. *Terms are negotiable*



CONTACT



**SOUTH
TEXAS**
RENTALS.COM

PHONE

(361) 333-2002

WEBSITE

www.SouthTexasRentals.com

EMAIL

leasing@SouthTexasRentals.com

ADDRESS

4800 N Navarro St, Victoria, TX 77983