

FOR SALE | INDUSTRIAL PARK | 231,605SF +/- | ONLY \$23.75 PER SQ FT
1 Glass Street, Bridgeton, NJ – Cumberland County – Approximately 10.85 acres

- Industrial park with multiple buildings. Building dimensions identified in plan below.
- Total square footage of approximately 231,605
- South Jersey site within proximity of Philadelphia and Atlantic City
- Property will be delivered vacant. Amazing opportunity to lease up and make great return.
- Ceiling heights vary from 16', 24' and 30' in various areas
- Can be used for warehouse or manufacturing
- Current owner uses for his warehousing and car restoration business but will close business and deliver vacant upon closing of title.





©2021, SITES USA Inc., Chandler, AZ (480) 491-1112. All Rights Reserved.

Lat: 39.42452, Long: 75.29416, Zoom: 0.28 m

Logos are for identification purposes only and may be trademarks of their respective companies.

This map was produced using data from private and government sources deemed to be reliable. The information herein is provided without representation or warranty.

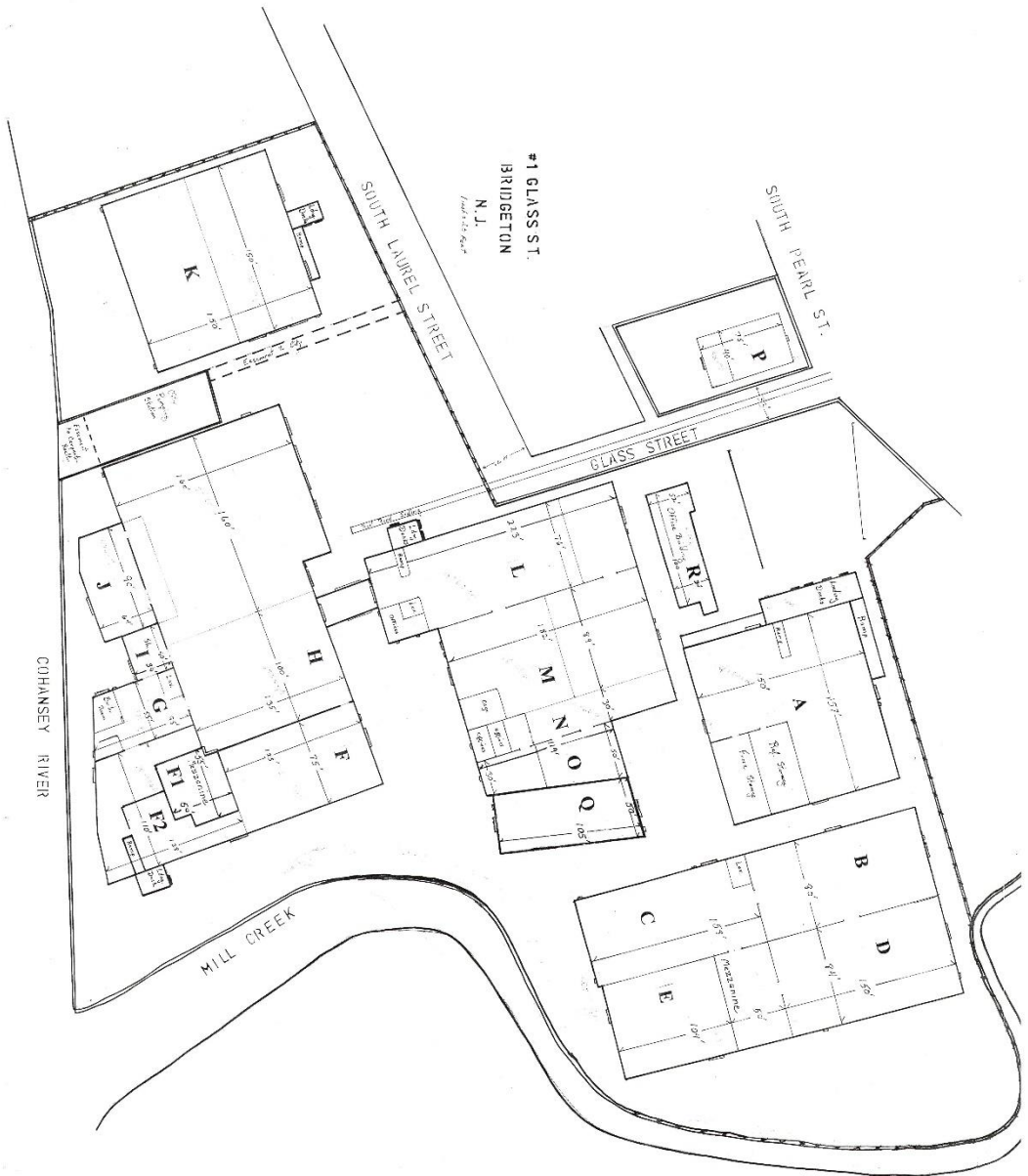

#1 GLASS ST.
BRIDGETON
N. J.
Land & Survey

SOUTH LAUREL STREET

SOUTH PEARL ST.

GLASS STREET

COHANSEY RIVER

MILL CREEK

K

P

J

H

L

R

I

G

F

M

N

A

F1

F2

O

Q

B

C

D

E

1 Glass Street, Bridgeton, NJ



Demographics

	1 mi radius	3 mi radius	5 mi radius
Population	15,993	32,669	41,012
Households	4,491	9,499	12,319
Population Median Age	27.6	33.1	35.1
5 Yr Pop Growth (Total%)	-2.5%	-2.8%	-2.9%

5 Mile Information



12,027

Employees



\$56,892

Median HH Income



1,054

Businesses

Contact Information

Name: **Jamie DiOrio**
 Email: **james.diorio@bhhsnj.com**
 Phone: **201.696.5363**
 Prepared By: **Jamie DiOrio**
 Prepared For: **Market**

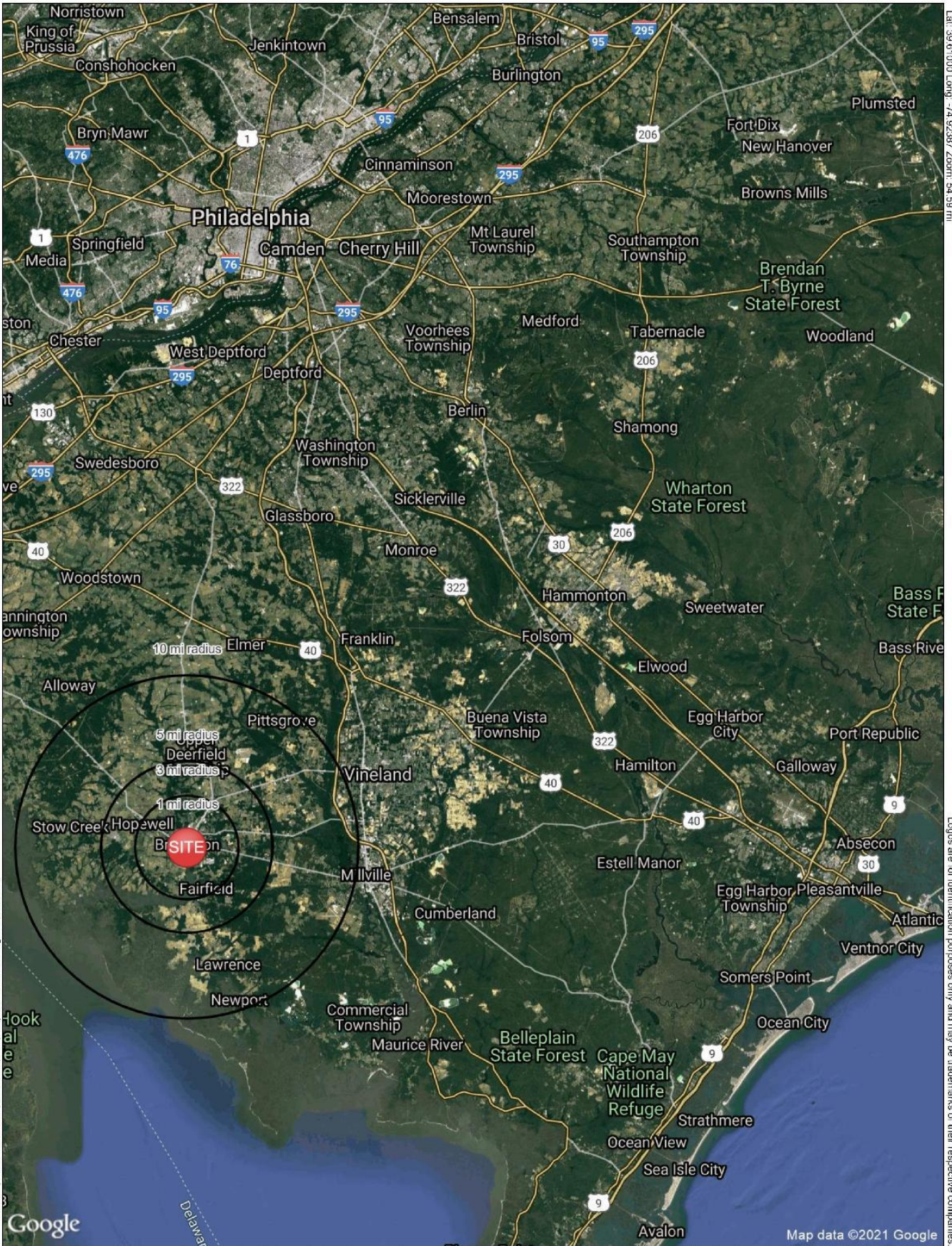

©2021, SITES USA, Inc., Chandler, AZ 480-491-1112. All Rights Reserved.

Google

Map data ©2021 Google

This map was produced using data from private and government sources deemed to be reliable. The information herein is provided without representation or warranty

Lat: 39.670001 Long: -74.92387 Zoom: 54.59 m

Logos are for identification purposes only and may be trademarks of their respective companies.







