

FOR LEASE  
**PRIME RETAIL LOCATION**  
FORMER RITE AID | ± 10,908 SF AVAILABLE



## PROPERTY HIGHLIGHTS

- + Former Rite Aid building
- + On corner with great visibility to US 278
- + All offers to be approved by Walgreens Real Estate Committee if commencement before December
- + Close proximity to Piedmont Hospital

## PROPERTY SNAPSHOT

<b>ADDRESS:</b>	3215 Hwy 278 NW   Covington, GA
<b>BUILDING SF:</b>	10,908 SF
<b>LOT SIZE:</b>	± 1.6 acres
<b>LEASE RATE:</b>	Negotiable
<b>PARKING:</b>	64 spaces

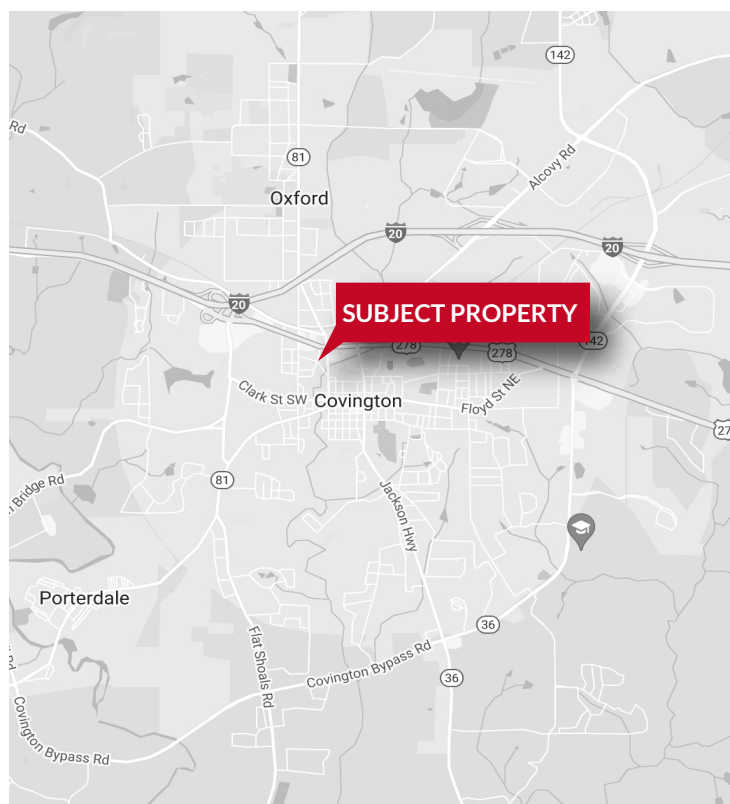

**CHANDLER POPE**  
VICE PRESIDENT

📞 | 404.313.2444  
📞 | 678.597.9312  
✉ | [cpope@highgatepartners.net](mailto:cpope@highgatepartners.net)

**NATHAN WANG**  
VICE PRESIDENT

📞 | 404.313.2444  
📞 | 678.597.9238  
✉ | [nathan@highgatepartners.net](mailto:nathan@highgatepartners.net)

**HIGHGATE PARTNERS**  
BROKERAGE | INVESTMENT | DEVELOPMENT

📍 | 5887 Glenridge Dr. NE, Suite 350  
Atlanta, GA 30328  
[www.highgatepartners.net](http://www.highgatepartners.net)

FOR LEASE  
PRIME RETAIL LOCATION

3215 HIGHWAY 278  
COVINGTON, GA 30014



## PROPERTY OVERVIEW



## PROPERTY PLAT

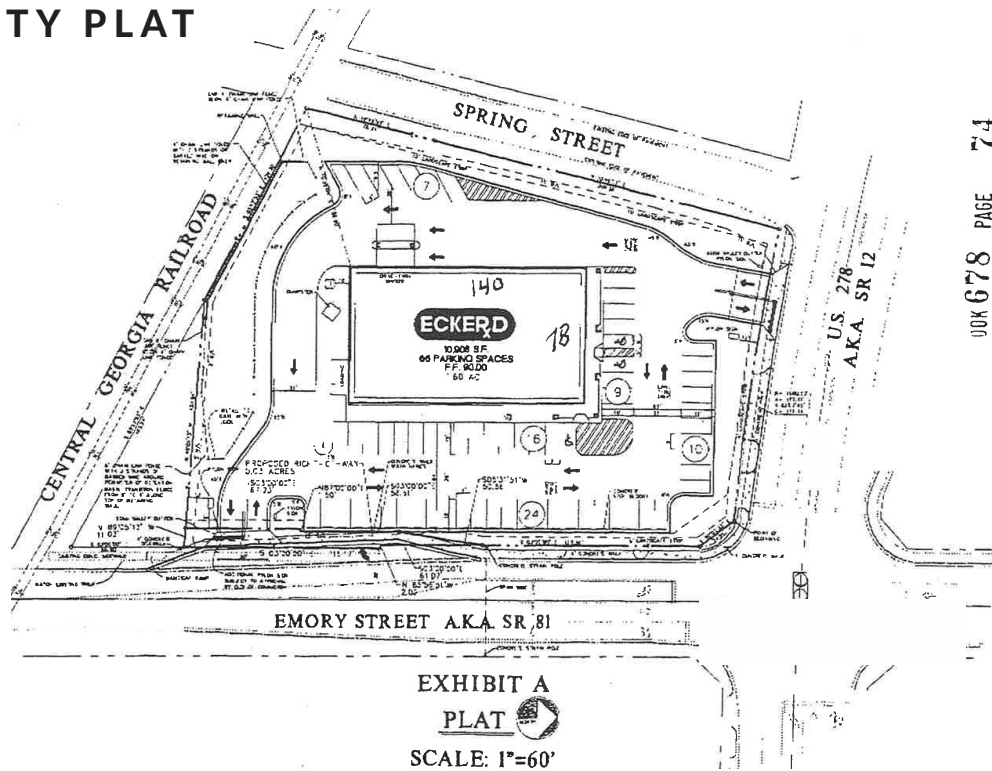

BOOK 678 PAGE 74  
BOOK 686 PAGE 640



FOR LEASE  
PRIME RETAIL LOCATION

3215 HIGHWAY 278  
COVINGTON, GA 30014



## PROPERTY PHOTOS





# FOR LEASE PRIME RETAIL LOCATION

3215 HIGHWAY 278  
COVINGTON, GA 30014

## MARKET SNAPSHOT MAP



## DEMOGRAPHICS

