

# AVAILABLE FOR SUBLEASE

## 26523 DANTI COURT | HAYWARD, CA



### LISTING DATA

- 36,864± SF Warehouse/Distribution
- 2,000± SF Office
- 10 Dock High Doors
- 1 Drive In Door
- 24' Clear Height

### ECONOMIC DATA

- Sublease Rate: \$0.80/SF, NNN  
+ \$0.15/SF, Operating Expenses
- Sublease Expires: 12/31/2022
- Direct Deal with Ownership Possible
- Available Now

### EXCLUSIVE AGENTS

CRAIG HAGGLUND, SIOR  
chagglund@lee-associates.com  
510.903.7611 | LIC# 01090730

NATHAN VANCE  
nvance@lee-associates.com  
510.907.3021 | LIC# 02039163

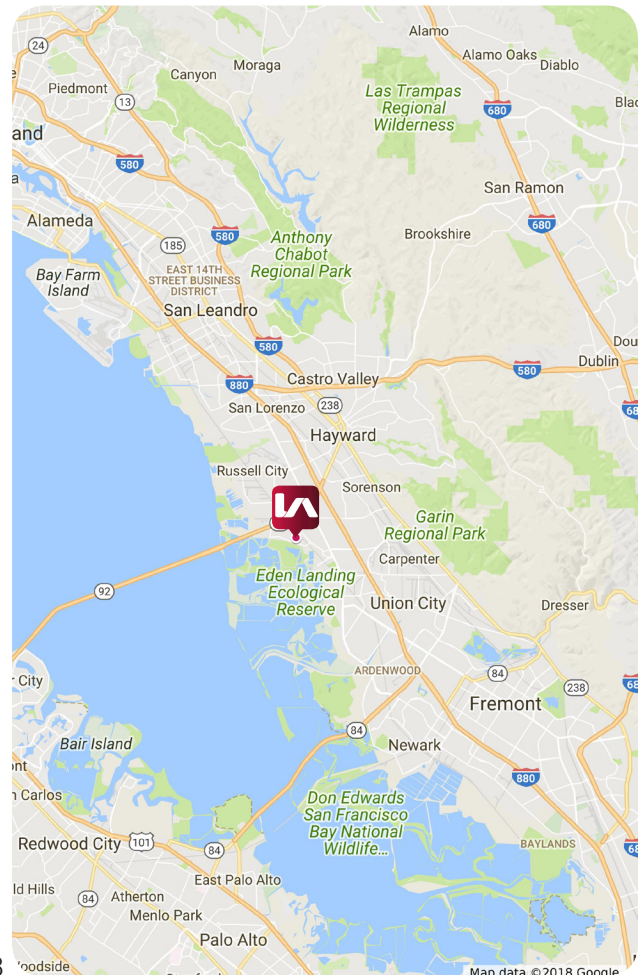
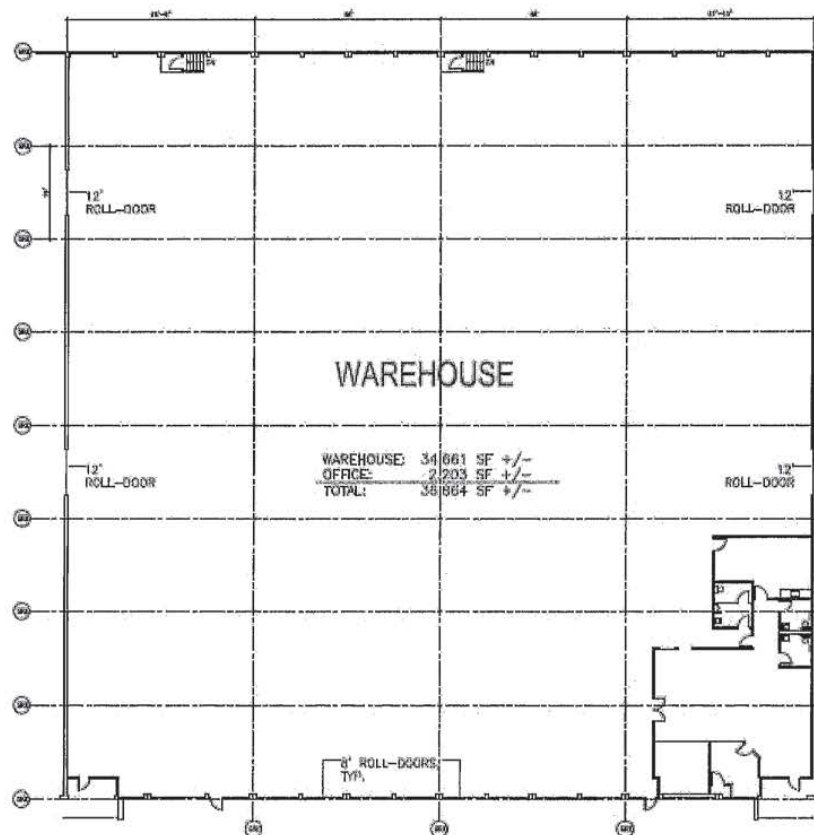

EXHIBIT A

DIAGRAM OF THE PREMISES



FLOOR PLAN  
SCALE 1/16"=1'-0"

EXCLUSIVE AGENTS

CRAIG HAGGLUND, SIOR  
chagglund@lee-associates.com  
510.903.7611 | LIC# 01090730

NATHAN VANCE  
nvance@lee-associates.com  
510.907.3021 | LIC# 02039163

BB