



NATIONAL AVENUE

FOR LEASE

1961-1967 National Avenue

Hayward, CA 94545



CONTACT US

Mark Maguire

Executive Vice President
+1 510 219 7854
mark.maguire@colliers.com
CA Lic. No. 01190597

Garrett Dunn

Associate
+1 9252979449
garrett.dunn@colliers.com
CA Lic. No. 02229225

Colliers

Industrial Space with Fenced & Secured Yard

Project Highlights

- ±21,884 SF total
- Fenced and secured, concrete yard
- Two (2) separate units
- 400 amp, 120-208 volt, 3 phase (Tenant to confirm)
- Six (6) grade level doors (side and rear)
- ±17' minimum clear height
- I-880 access via W Winton Avenue
- HWY-92 access via Clawiter Road

PRICE: \$1.30/SF/Month NNN
\$0.33/SF/Month Estimated Expenses

FOR LEASE



1961-1967 National Avenue

Hayward, CA 94545

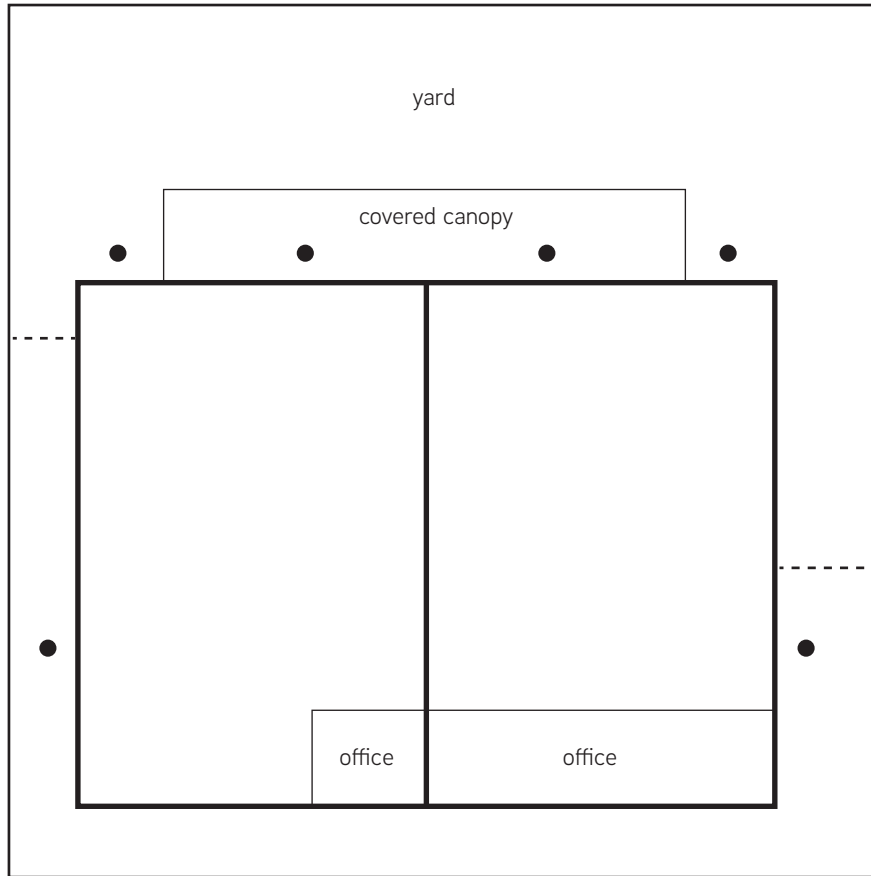

- grade level loading door
- secured gate



Fenced and secured yard area with a covered canopy

CONTACT US

Mark Maguire
Executive Vice President
+1 510 219 7854
mark.maguire@colliers.com
CA Lic. No. 01190597

Garrett Dunn
Associate
+1 9252979449
garrett.dunn@colliers.com
CA Lic. No. 02229225

This document/email has been prepared by Colliers for advertising and general information only. Colliers makes no guarantees, representations or warranties of any kind, expressed or implied, regarding the information including, but not limited to, warranties of content, accuracy and reliability. Any interested party should undertake their own inquiries as to the accuracy of the information. Colliers excludes unequivocally all inferred or implied terms, conditions and warranties arising out of this document and excludes all liability for loss and damages arising there from. This publication is the copyrighted property of Colliers and /or its licensor(s). © 2024. All rights reserved. This communication is not intended to cause or induce breach of an existing listing agreement. Colliers International.