

- POINT OF COMMENCEMENT
NORTHWEST CORNER
NW 1/4, NW 1/4
SECTION 21, T14N, R4E

COMMENCING AT THE NORTHWEST CORNER OF THE NORTHWEST QUARTER OF THE NORTHWEST QUARTER OF SECTION 21, TOWNSHIP 14 NORTH, RANGE 4 EAST, CRAIGHEAD COUNTY, ARKANSAS; THENCE SOUTH 00°14'58" EAST ALONG THE WEST LINE OF THE NORTHWEST QUARTER OF THE NORTHWEST QUARTER OF SECTION 21, AFORESAID, 484.50 FEET TO THE SOUTHERLY RIGHT OF WAY LINE OF MATTHEWS AVENUE; THENCE NORTH 00°00'00" EAST 64.00 FEET TO THE SOUTHERLY RIGHT OF WAY LINE OF SECTION 21, AFORESAID, BEGINNING. THENCE CONTINUE NORTH 00°00'00" EAST 20.00 FEET; THENCE SOUTH 00°14'58" EAST DEPARTING SAID RIGHT OF WAY LINE, 42.00 FEET; THENCE NORTH 00°00'00" WEST 70.00 FEET; THENCE NORTH 00°14'58" WEST 42.00 FEET TO THE POINT OF BEGINNING.

SUBJECT TO EASEMENTS, RESTRICTIONS, RESERVATIONS AND RIGHTS-OF-WAY OF RECORD.



BEARING BASIS
PREVIOUS SURVEY



IN FEET

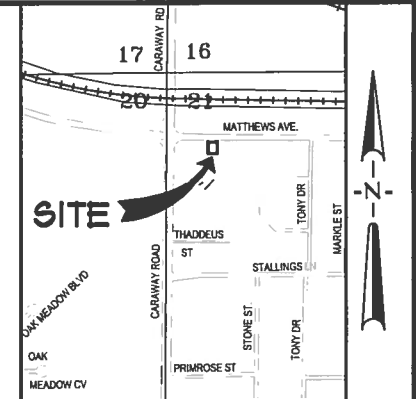

NOT TO SCALE

I HEREBY CERTIFY THAT ASSOCIATED ENGINEERING AND TESTING, LLC HAS THIS DATE MADE A BOUNDARY SURVEY OF THE ABOVE DESCRIBED PROPERTY AS SHOWN HEREON AND THAT SAID SURVEY IS ACCURATE AND CORRECT TO THE BEST OF MY KNOWLEDGE AND BELIEF. THERE ARE NO APPARENT ABOVE GROUND ENCROACHMENTS OTHER THAN AS SHOWN OR STATED HEREON AND THAT THIS SURVEY WAS MADE IN ACCORDANCE WITH THE "ARKANSAS MINIMUM STANDARDS FOR PROPERTY SURVEYS AND PLATS" IN EFFECT ON THIS DATE.

DATE OF BOUNDARY SURVEY: 03/01/07

PATRICK W. LEMLEY
PROFESSIONAL SURVEYOR
ARKANSAS CERTIFICATE NO. 1549

NOTE: TO BE VALID, COPIES MUST HAVE ORIGINAL SURVEYOR'S SIGNATURE AND SURVEYOR'S SEAL.

ASSOCIATED ENGINEERING AND TESTING, LLC
CIVIL ENGINEERING, LAND SURVEYING AND MATERIALS TESTING
103 SOUTH CHURCH STREET - P.O. BOX 1462 - JONESBORO, AR 72403
PH: 870-932-3594 FAX: 870-935-1263

HALSEY OUTDOOR ADVERTISING, INC.
BILLBOARD 2315 E. MATTHEWS
COUNTY, ARKANSAS

- BOUNDARY LINE
- SET 1 1/4" IRON PIPE W/ PLS #549 CAP

© Copyright 2007 AETLLC

PART OF THE NORTHWEST QUARTER OF THE NORTHWEST QUARTER OF SECTION 21, TOWNSHIP 14 NORTH, RANGE 4 EAST, CRAIGHEAD COUNTY, ARKANSAS, BEING MORE PARTICULARLY DESCRIBED AS FOLLOWS:

CONTINUING AT THE NORTHWEST CORNER OF THE NORTHWEST QUARTER OF THE NORTHWEST QUARTER OF SECTION 21, TOWNSHIP 14 NORTH, RANGE 4 EAST, CRAIGHEAD COUNTY, ARKANSAS; THENCE SOUTH 00°14'58" EAST ALONG THE WEST LINE OF THE NORTHWEST QUARTER OF THE NORTHWEST QUARTER OF SECTION 21, AFORESAID, 484.50 FEET TO THE SOUTHERLY RIGHT OF WAY LINE OF MATTHEWS AVENUE; THENCE NORTH 90°00'00" EAST ALONG SAID SOUTHERLY RIGHT OF WAY LINE, 300.00 FEET TO THE POINT OF BEGINNING; THENCE CONTINUE NORTH 90°00'00" EAST 1322.00 FEET; THENCE SOUTH 00°14'58" EAST DEPARTING SAID RIGHT OF WAY LINE, 42.01 FEET; THENCE NORTH 90°00'00" EAST 20.00 FEET; THENCE SOUTH 00°14'58" EAST 148.50 FEET; THENCE SOUTH 90°00'00" WEST 1522.00 FEET; THENCE NORTH 00°14'58" WEST 191.00 FEET TO THE POINT OF BEGINNING.

CONTAINING IN ALL 28228 SQ. FT. OR 0.65 ACRES, MORE OR LESS.

SUBJECT TO EASEMENTS, RESTRICTIONS, RESERVATIONS AND RIGHTS-OF-WAY OF RECORD.

1. THIS SURVEY WAS PREPARED FOR THE EXCLUSIVE USE OF HALSEY OUTDOOR ADVERTISING, INC. AND IS NOT ASSIGNABLE.

DATE	REVISIONS	BY

DRAWN: KUG	CHECKED: PWL	DATE: 03/02/07	SHEET 1 OF 1
SCALE: 1" = 50'	CADD FILE: 07135-001	DWG#: 0414214.0063	

Please Return To:

Lenders Title Company
2207 Fowler Avenue
Jonesboro AR, 72401
Phone: 870-935-7410
Fax: 870-935-6548

File Number:

#01-049376-300

Approved as to form by:

Dan Boland, Attorney-at-Law

Transactional data completed by Lenders Title Company

Partial Release Corporation.rtf

FOR RECORDER'S USE ONLY

PARTIAL RELEASE DEED CORPORATION

KNOW ALL MEN BY THESE PRESENTS:

That Pulaski Bank and Trust Company f/k/a First Community Bank, a corporation organized under the laws of the State of Arkansas and doing business under and by virtue of the laws of the State of Arkansas, in consideration of the partial payment of all indebtedness mentioned in a certain Mortgage dated October 10, 2003, and recorded in Book # 1023 Page # 465 in the Recorder's office in and for Craighead County, Arkansas, said indebtedness originally having been owed by Halsey Properties, LLC to First Community Bank and secured by a lien on the following property located in Craighead County, Arkansas:

BB

Part of the Northwest Quarter of the Northwest Quarter of Section 21, Township 14 North, Range 4 East, Craighead County, Arkansas, being more particularly described as follows: Commencing at the Northwest corner of the Northwest Quarter of the Northwest Quarter of Section 21, Township 14 North, Range 4 East, Craighead County, Arkansas; thence South 00 degrees 14' 58" East along the West line of the Northwest Quarter of the Northwest Quarter of Section 21, aforesaid, 484.50 feet to the Southerly right of way line of Matthews Avenue; thence North 90 degrees 00' 00" East along said Southerly right of way line 432.20 feet to the point of beginning; thence continue North 90 degrees 00' 00" East 20.00 feet; thence South 00 degrees 14' 58" East departing said right of way line 42.10 feet; thence North 90 degrees 00' 00" West 20.00 feet; thence North 00 degrees 14' 58" West 42.01 feet to the point of beginning; containing in all 842 square feet or 0.02 acres, more or less., and being a part of Lot 3 of Cobb and Lee's Survey of the Northwest Quarter of Section 21, Township 14 North, Range 4 East, Jonesboro, Craighead County, Arkansas. Subject to easements, restrictions, reservations and rights-of-way of record.

AND

land

Part of the Northwest Quarter of the Northwest Quarter of Section 21, Township 14 North, Range 4 East, Craighead County, Arkansas, being more particularly described as follows: Commencing at the Northwest corner of the Northwest Quarter of the Northwest Quarter of Section 21, Township 14 North, Range 4 East, Craighead County, Arkansas; thence South 00 degrees 14' 58" East along the West line of the Northwest Quarter of the Northwest Quarter of Section 21, aforesaid, 484.50 feet to the Southerly right of way line of Matthews Avenue; thence North 90 degrees 00' 00" East along said Southerly right of way line, 300.00 feet to the point of beginning; thence continue North 90 degrees 00' 00" East 132.20 feet; thence South 00 degrees 14' 58" East departing said right of way line 42.01 feet; thence North 90 degrees 00' 00" East 20.00 feet; thence South 00 degrees 14' 58" East 148.90 feet; thence South 90 degrees 00' 00" West 152.20 feet; thence North 00 degrees 14' 58" West 191.00 feet to the point of beginning, containing in all 28,228 square feet or 0.65 acres, more or less and being a part of Lot 3 of Cobb and Lee's Survey of the Northwest Quarter of Section 21, Township 14 North, Range 4 East, Jonesboro, Craighead County, Arkansas. Subject to easements, restrictions, reservations and rights-of-way of record

THIS INSTRUMENT IS INTENDED TO RELEASE ONLY THAT PROPERTY SHOWN ABOVE AND DOES NOT RELEASE ANY OTHER PROPERTY COVERED BY THE ABOVE DESCRIBED MORTGAGE.

Said lien on the above described property is hereby released and discharged in full 29 day of May, 2007.

IN TESTIMONY WHEREOF, said Pulaski Bank and Trust Company f/k/a First Community Bank by its Sa Vice Pres, who are duly authorized by its By-Laws, has hereunto signed its Corporate name and affixed its Corporate seal on this 29 day of May, 2007.

Pulaski Bank and Trust Company f/k/a First Community Bank

By: Jai Cullum

By: _____

ACKNOWLEDGMENT

STATE OF ARKANSAS

COUNTY OF Craighead

SS.

On this 29 day of May, 2007, came before me, the undersigned, a Notary Public, duly commissioned, qualified and acting, within and for the said County and State, Joe Cullum and SA Vice President to me personally well known (or satisfactorily proven to be), who stated that they were the SA Vice President and SA Vice President of the Pulaski Bank and Trust Company f/k/a First Community Bank, a corporation, and are duly authorized in their capacities to execute the foregoing instrument for and in the name and behalf of said corporation, and further stated and acknowledged that they had so signed, executed and delivered said foregoing instrument for the consideration, uses and purposes therein mentioned and set forth.

IN TESTIMONY WHEREOF, I have hereunto set my hand and official seal this 29 day of

May, 2007.

Laura Ann McCain
Notary Public

My commission Expires:

12/31/07



DEED BK 749 PG 894 - 896
DATE 05/31/2007
TIME 12:05:19 PM
RECORDED IN
OFFICIAL RECORDS OF
CRAIGHEAD COUNTY
ANN HUDSON
CIRCUIT CLERK
RECEIPT# 162830, D.C.

EXHIBIT "A"

Part of the Northwest Quarter of the Northwest Quarter of Section 21, Township 14 North, Range 4 East, Craighead County, Arkansas, being more particularly described as follows: Commencing at the Northwest corner of the Northwest Quarter of the Northwest Quarter of Section 21, Township 14 North, Range 4 East, Craighead County, Arkansas; thence South 00 degrees 14' 58" East along the West line of the Northwest Quarter of the Northwest Quarter of Section 21, aforesaid, 484.50 feet to the Southerly right of way line of Matthews Avenue; thence North 90 degrees 00' 00" East along said Southerly right of way line, 300.00 feet to the point of beginning; thence continue North 90 degrees 00' 00" East 132.20 feet; thence South 00 degrees 14' 58" East departing said right of way line 42.01 feet; thence North 90 degrees 00' 00" East 20.00 feet; thence South 00 degrees 14' 58" East 148.90 feet; thence South 90 degrees 00' 00" West 152.20 feet; thence North 00 degrees 14' 58" West 191.00 feet to the point of beginning, containing in all 28,228 square feet or 0.65 acres, more or less and being a part of Lot 3 of Cobb and Lee's Survey of the Northwest Quarter of Section 21, Township 14 North, Range 4 East, Jonesboro, Craighead County, Arkansas. Subject to easements, restrictions, reservations and rights-of-way of record

*Land
only*