

100,683 SF

Industrial Space For Lease

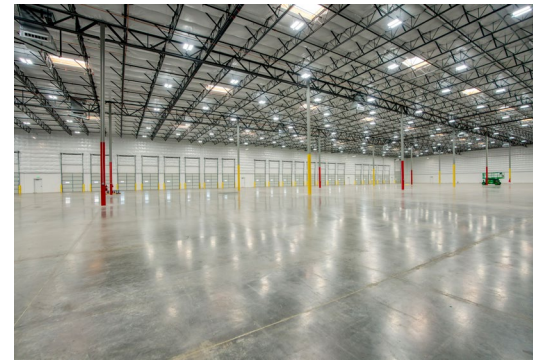

Prologis I-17 Logistics Center II



1100 East Hammond Lane
Building 7
Phoenix, AZ 85034 USA



LOCATION

- Amazing access with 9 points of ingress/egress
- 7-minute drive from Sky Harbor Airport
- Visibility at the center of Phoenix with $\pm 125,000$ VPD off I-17
- Minutes from I-10, I-17, State Route 143, and SR-60
- Connected to a strong labor force
- ± 2 million people within a 30-minute drive
- A-2 City of Phoenix Zoning

FACILITY

- $\pm 25,000$ SF divisibility
- $\pm 2,795$ SF spec office with restrooms
- 100% air-conditioned
- 32' minimum clear height
- 27 dock-high doors
- 2 grade-level doors
- 8 pit-levelers
- 60' speed bay
- LED motion-sensing lighting
- R-38 insulation
- 3-acres yard / trailer storage
- ESFR K-25 sprinkler system
- 50' x 52' column spacing
- 3,000 amps, 277/480v, 3 phase power
- 99 auto parking spaces

Your single-source service for efficient move-in and operations: prologisessentials.com

100,683 SF

Industrial Space For Lease



Prologis I-17 Logistics Center II

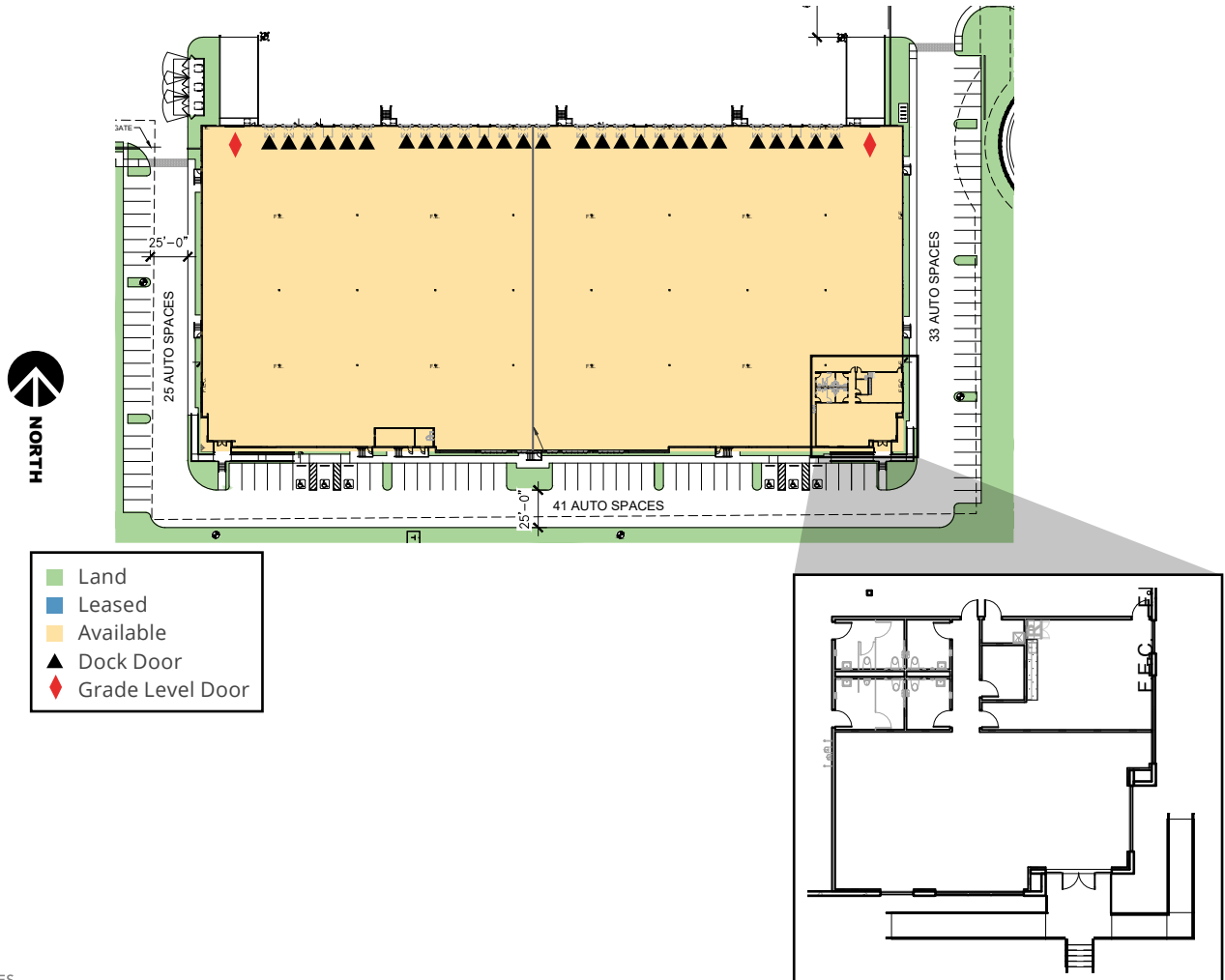

Lee & Associates

Ken McQueen
kmcqueen@leearizona.com
ph +1 602 474 9564
cell +1 602 920 6042
3200 E Camelback Road
Suite 100
Phoenix, AZ 85018 USA

Lee & Associates

Chris McClurg, SIOR
cmclurg@leearizona.com
ph +1 602 954 3766
cell +1 602 741 2665
3200 E Camelback Road
Suite 100
Phoenix, AZ 85018 USA

Lee & Associates

Stein Koss, SIOR
skoss@leearizona.com
ph +1 602 912 3520
cell +1 602 510 1999
3200 E Camelback Road
Suite 100
Phoenix, AZ 85018 USA

Lee & Associates

Tom Louer, SIOR
tlouer@leearizona.com
ph +1 602 954 3779
cell +1 602 684 6909
3200 E Camelback Road
Suite 100
Phoenix, AZ 85018 USA

Prologis

Jeff Foster
jfoster@prologis.com
ph +1 602 474 8383
cell +1 480 280 4919
2525 E Camelback Road
Suite 400
Phoenix, AZ 85016 USA

Prologis

Alicia Saxby
asaxby@prologis.com
ph +1 602 474 8364
cell +1 602 284 3435
2525 E Camelback Road
Suite 400
Phoenix, AZ 85016 USA