

0 100 200 300  
GRAPHIC SCALE: 1" = 100'

**SURVEYOR'S NOTES**

- SUBSURFACE AND ENVIRONMENTAL CONDITIONS WERE NOT SURVEYED OR EXAMINED OR CONSIDERED AS PART OF THIS SURVEY. NO EVIDENCE OR STATEMENT IS MADE CONCERNING THE EXISTENCE OF UNDERGROUND OR OVERHEAD CONDITIONS, CONTAINERS OR FACILITIES THAT MAY AFFECT THE USE OR DEVELOPMENT OF THIS PROPERTY.
- IN PREPARING THIS SURVEY, NO ATTEMPT HAS BEEN MADE TO OBTAIN OR SHOW DATA CONCERNING EXISTENCE, SIZE, DEPTH, CONDITION, CAPACITY OR LOCATION OF ANY UTILITY EXISTING ON THE SITE, WHETHER PRIVATE, MUNICIPAL OR PUBLIC OWNED.
- THE PROFESSIONAL SURVEYOR HAS MADE NO INVESTIGATION OR INDEPENDENT SEARCH FOR EASEMENTS OF RECORD, ENCUMBRANCES, RESTRICTIVE COVENANTS, OWNERSHIP TITLE EVIDENCE, OR ANY OTHER FACTS THAT AN ACCURATE AND CURRENT TITLE SEARCH MAY DISCLOSE.
- BEARINGS ARE BASED ON GPS OBSERVATIONS. MONUMENTATION ARE TIED INTO THE CITY'S CONTROL SYSTEM WHICH ARE ASSUMED TO BE ON THE TEXAS NORTH CENTRAL STATE PLANE COORDINATE SYSTEM USING THE NAD '83 HORIZONTAL DATUM.
- COPYRIGHT EDWARDS SURVEYING, L.L.C. ALL RIGHTS RESERVED. NO PART OF THIS DRAWING MAY BE REPRODUCED BY PHOTOCOPYING, RECORDING OR BY ANY OTHER MEANS, OR STORED, PROCESSED OR TRANSMITTED IN OR BY ANY COMPUTER OR OTHER SYSTEM WITHOUT THE PRIOR WRITTEN PERMISSION OF THE SURVEYOR. COPIES OF THIS PLAT WITHOUT AN ORIGINAL SIGNATURE AND IMPRESSION SEAL ARE NOT VALID.
- NO ZONING INFORMATION IN THE E.T.J. OF THE CITY OF DECATUR, WISE COUNTY, TEXAS.
- ADDITION TO CREATE TWO LOTS.
- FLOODWAY EASEMENT AND MINIMUM FINISH FLOOR ELEVATION WAS FROM DESIGN FROM PROJECT ENGINEER.
- APPROXIMATE PURPOSE OF THIS AMENDED PLAT IS TO CREATE ONE LOT FROM TWO. 08 MAY 20.

**OWNER / DEVELOPER:**  
FULL LIFE FELLOWSHIP ASSEMBLY OF GOD  
CHURCH OF DECATUR, TEXAS  
P.O. BOX 812  
DECATUR, TEXAS 76234  
(940)-300-1771 PHO.

**PROJECT ENGINEER:**  
TIM HODGES, P.E.  
ADAMS ENGINEERING, INC  
500 NOLEN DRIVE, SUITE 550  
SOUTH LAKE, TEXAS 76092  
P. 817.329.6990  
F. 817.329.7671  
TIM.HODGES@ADAMS-ENGINEERING.COM  
WWW.ADAMS-ENGINEERING.COM

**LEGEND**

- FENCE
  - GAS LINE
  - ELECTRIC LINE
  - TELEPHONE LINE
  - CABLE TV
  - UTILITIES
  - SEWER LINE
  - WATER LINE
  - POLITICAL BOUNDARY
  - RIPARIAN / LITTORAL BOUNDARY
  - ORIGINAL SURVEY BOUNDARY
  - INTERIOR BOUNDARY
- (RED CHALK)**
- ORIF CAPPED IRON ROD FOUND
  - ORIS CAPPED IRON ROD SET
  - IRF IRON ROD FOUND
  - RORF REFERENCE CAPPED IRON ROD FOUND
  - RORIS REFERENCE CAPPED IRON ROD SET
  - CM CONTROL MONUMENT

**DRAINAGE EASEMENT RESTRICTION**  
NO CONSTRUCTION, OR FILING, WITHOUT THE WRITTEN APPROVAL OF THE CITY OF DECATUR, SHALL BE ALLOWED WITHIN A DRAINAGE EASEMENT, AND THEN ONLY AFTER DETAILED ENGINEERING PLANS AND STUDIES SHOW THAT NO FLOODING WILL RESULT, THAT NO OBSTRUCTION OF THE NATURAL FLOW OF WATER WILL RESULT, AND SUBJECT TO ALL OWNERS OF PROPERTY AFFECTED BY SUCH CONSTRUCTION BECOMING A PARTY TO THE REQUEST. WHERE CONSTRUCTION IS PERMITTED, ALL FINISHED FLOOR ELEVATIONS SHALL BE A MINIMUM OF ONE (1) FOOT ABOVE THE 100-YEAR FLOOD ELEVATION.

**UTILITY EASEMENTS RESTRICTION**  
ANY PUBLIC UTILITY, INCLUDING THE CITY OF DECATUR, SHALL HAVE THE RIGHT TO REMOVE ALL OR PART OF ANY BUILDING, FENCES, TREES, SHRUBS, OTHER GROWTH OR IMPROVEMENTS WHICH IN ANY WAY ENDANGER OR INTERFERE WITH THE CONSTRUCTION, MAINTENANCE, OR EFFICIENCY OF ITS RESPECTIVE SYSTEMS ON ANY OF THE EASEMENTS SHOWN ON PLAT; AND ANY PUBLIC UTILITY, INCLUDING THE CITY OF DECATUR, SHALL HAVE THE RIGHT AT ALL TIMES OF ACCESS AND EGRESS TO AND FROM AND UPON SAID EASEMENTS FOR THE PURPOSE OF CONSTRUCTION, RECONSTRUCTION, INSPECTION, PATROLLING, MAINTAINING AND ADDING TO OR REMOVING ALL OR PART OF ITS RESPECTIVE SYSTEMS WITHOUT THE NECESSITY AT ANY TIME OF PROCURING THE PERMISSION OF ANYONE.

**PUBLIC OPEN SPACE EASEMENT RESTRICTION**  
NO STRUCTURE, OBJECT OR PLANT OF ANY TYPE MAY OBSTRUCT VISION FROM A HEIGHT OF THIRTY (30) INCHES TO A HEIGHT OF TEN (10) FEET ABOVE THE TOP OF CURB, INCLUDING, BUT NOT LIMITED TO BUILDINGS, FENCES, WALLS, SIGNS, TREES, SHRUBS, CARS, TRUCKS, ETC., IN THE PUBLIC OPEN SPACE EASEMENT AS SHOWN ON THE.

**LANDSCAPE RESTRICTION**  
LANDSCAPE AREAS ARE STRICTLY RESERVED AS LANDSCAPED, OPEN GREEN SPACES ONLY AND SHALL NEVER ALLOW INTRUSIONS OF ANY KIND THAT ARE NOT LANDSCAPE RELATED OR THAT IN ANYWAY LESSEN THE AMOUNT OF AREA OR LANDSCAPE MATERIAL WITHOUT THE EXPRESSED, WRITTEN PERMISSION OF THE CITY OF DECATUR.

**BUFFER RESTRICTION**  
BUFFER AREAS ARE STRICTLY RESERVED AS LANDSCAPED, OPEN GREEN SPACES ONLY AND SHALL NEVER ALLOW INTRUSIONS OF ANY KIND THAT ARE NOT LANDSCAPE RELATED OR THAT IN ANYWAY LESSEN THE AMOUNT OF AREA OR LANDSCAPE MATERIAL. BUFFER WALLS SHALL BE HEREINAFTER AND FOREVERMORE RETAINED UNLESS, SAID NEED DESSERVES AND EXPRESSED, WRITTEN PERMISSION FROM THE CITY IS GRANTED TO DO OTHERWISE.

**GREEN SPACE RESTRICTION**  
GREEN SPACE AREAS ARE STRICTLY RESERVED AS LANDSCAPED, OPEN GREEN SPACES ONLY AND SHALL NEVER ALLOW INTRUSIONS OF ANY KIND THAT ARE NOT LANDSCAPE RELATED OR THAT IN ANYWAY LESSEN THE AMOUNT OF AREA OR LANDSCAPE MATERIAL WITHOUT THE EXPRESSED, WRITTEN PERMISSION OF THE CITY OF DECATUR.

STATE OF TEXAS §  
§ OWNER'S ACKNOWLEDGMENT AND DEDICATION  
COUNTY OF WISE §

I, THE UNDERSIGNED, OWNER OF THE LAND SHOWN ON THIS PLAT WITHIN THE AREA DESCRIBED BY METES AND BOUNDS AS FOLLOWS:

BEING 8.000 ACRES OF LAND, MORE OR LESS, IN THE SAMUEL ISAACS SURVEY, ABSTRACT NO. 454, WISE COUNTY, TEXAS, BEING ALL OF THAT CERTAIN TRACT OF LAND AS DESCRIBED IN DEEDS TO FULL LIFE FELLOWSHIP ASSEMBLY OF GOD OF DECATUR, TEXAS, RECORDED IN VOLUME 1461, PAGES 482 AND 487, OFFICIAL RECORDS, WISE COUNTY, TEXAS; SAID TWO TRACTS OF LAND BEING MORE PARTICULARLY DESCRIBED BY METES AND BOUNDS AS FOLLOWS, TO WIT:

BEGINNING AT AN IRON STAKE FOUND FOR THE NORTHEAST CORNER OF THE TRACT DESCRIBED HEREIN, SAME BEING THE NORTHEAST CORNER OF A CALLED 135.50-ACRE TRACT OF LAND AS DESCRIBED IN DEED TO JRJ REINSURANCE COMPANY, LTD., RECORDED IN VOLUME 1327, PAGE 609, OFFICIAL RECORDS, WISE COUNTY, TEXAS, AND THE NORTHWEST CORNER OF A TRACT OF LAND AS DESCRIBED IN DEED TO STEPHEN WREN IN VOLUME 1121, PAGE 282, OFFICIAL RECORDS, WISE COUNTY, TEXAS; SAID STAKE BEING FURTHER LOCATED IN THE SOUTH LINE OF A TRACT OF LAND AS DESCRIBED IN DEED TO THE COUNTY OF WISE (HEREINAFTER REFERRED TO AS WISE COUNTY TRACT), RECORDED IN VOLUME 6, PAGE 4, DEED RECORDS, WISE COUNTY, TEXAS;

THENCE WITH THE SOUTHWEST LINE OF SAID WREN TRACT, SAME BEING THE NORTHEAST LINE OF SAID 135.50-ACRE TRACT AND THE NORTHEAST LINE OF THE TRACT DESCRIBED HEREIN, AND ALONG A MEANDERING FENCE LINE MOST OF THE WAY, SOUTH 11° 14' 52" EAST, PASSING A FENCE, AND CONTINUING A TOTAL DISTANCE OF 539.81 FEET TO A CAPPED IRON STAKE SET FOR THE SOUTHEAST CORNER OF THE TRACT DESCRIBED HEREIN;

THENCE NORTH 69° 51' 23" WEST, PASSING A FENCE, AND CONTINUING A TOTAL DISTANCE OF 1308.13 FEET TO A CAPPED IRON STAKE SET FOR THE SOUTHWEST CORNER OF THE TRACT DESCRIBED HEREIN; SAID STAKE BEING FURTHER LOCATED IN THE SOUTHEAST RIGHT OF WAY LINE OF FM HIGHWAY NO. 51, SAME BEING THE NORTHWEST LINE OF SAID 135.05-ACRE TRACT, AND BEING IN A CURVE TO THE LEFT HAVING A RADIUS OF 5789.58 FEET;

THENCE WITH THE NORTHWEST LINE OF SAID 135.50-ACRE, SAME BEING THE NORTHWEST LINE OF THE TRACT DESCRIBED HEREIN, AND THE SOUTHEAST RIGHT OF WAY LINE OF FM HIGHWAY NO. 51, AND WITH SAID CURVE TO THE LEFT HAVING A RADIUS OF 5789.58 FEET, AN ARC LENGTH OF 100.00 FEET (CHORD: NORTH 29°08'10" EAST - 99.98 FEET) TO A CAPPED IRON STAKE SET FOR THE NORTHWEST CORNER OF THE TRACT DESCRIBED HEREIN, SAME BEING THE NORTHWEST CORNER OF SAID 135.50-ACRE TRACT, AND THE SOUTHWEST CORNER OF SAID WISE COUNTY TRACT;

THENCE WITH THE SOUTH LINE OF SAID WISE COUNTY TRACT, SAME BEING THE NORTH LINE OF SAID 135.50-ACRE TRACT AND THE NORTH LINE OF THE TRACT DESCRIBED HEREIN, SOUTH 89° 33' 12" EAST, AT 5.73 FEET PASSING THE CORNER OF A FENCE, AND CONTINUING WITH AND GENERALLY ALONG SAID FENCE A TOTAL DISTANCE OF 1074.18 FEET TO THE POINT OF BEGINNING, CONTAINING 8.000 ACRES OF LAND, MORE OR LESS, AND DESIGNATED HEREIN AS THE FULL LIFE FELLOWSHIP ADDITION TO THE CITY OF DECATUR, WISE COUNTY, TEXAS, AND WHOSE NAME IS SUBSCRIBED HERETO, HEREBY DEDICATE TO THE USE OF THE PUBLIC FOREVER ALL STREETS, ALLEYS, PARKS, WATER COURSES, DRAINS, EASEMENTS, RIGHTS-OF-WAY AND PUBLIC PLACES THEREON SHOWN FOR THE PURPOSE AND CONSIDERATION THEREIN EXPRESSED.

Chris Brown  
CHRIS BROWN, REPRESENTATIVE FOR FULL LIFE FELLOWSHIP ASSEMBLY OF GOD CHURCH OF DECATUR, TEXAS.

DATE: May 29, 2008

STATE OF TEXAS §  
COUNTY OF WISE §

BEFORE ME, THE UNDERSIGNED AUTHORITY, ON THIS DAY PERSONALLY APPEARED Chris Brown, KNOWN TO ME TO BE THE PERSON WHOSE NAME IS SUBSCRIBED TO THE FOREGOING INSTRUMENT, AND ACKNOWLEDGED TO ME THAT HE EXECUTED THE SAME FOR THE PURPOSES AND CONSIDERATIONS THEREIN STATED.

GIVEN UNDER MY HAND AND SEAL OF OFFICE THIS 29th DAY OF May, 2008

NOTARY PUBLIC

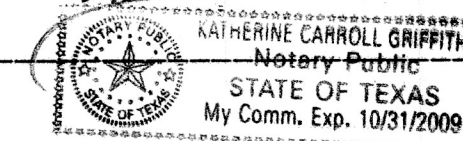

COUNTY, TEXAS.

AMENDED PLAT SHOWING:  
**LOT 1R, BLOCK 1,  
FULL LIFE FELLOWSHIP ADDITION**  
E.T.J. OF THE CITY OF DECATUR, WISE COUNTY, TEXAS

BEING 8.000 ACRES OF LAND, MORE OR LESS, IN THE SAMUEL ISAACS SURVEY, ABSTRACT NO. 454, WISE COUNTY, TEXAS, BEING ALL OF THAT CERTAIN TRACT OF LAND AS DESCRIBED IN DEEDS TO FULL LIFE FELLOWSHIP ASSEMBLY OF GOD OF DECATUR, TEXAS, RECORDED IN VOLUME 1461, PAGES 482 AND 487, OFFICIAL RECORDS, WISE COUNTY, TEXAS.

STATE OF TEXAS §  
COUNTY OF WISE §  
CERTIFICATE OF SURVEYOR

I, THE UNDERSIGNED, A REGISTERED PROFESSIONAL LAND SURVEYOR IN THE STATE OF TEXAS, HEREBY CERTIFY THAT THIS PLAT IS TRUE AND CORRECT AND WAS PREPARED FROM AN ACTUAL SURVEY OF THE PROPERTY MADE UNDER MY SUPERVISION ON THE GROUND.

REGISTERED PROFESSIONAL LAND SURVEYOR  
DATE: May 20, 2008

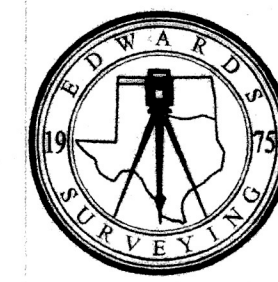
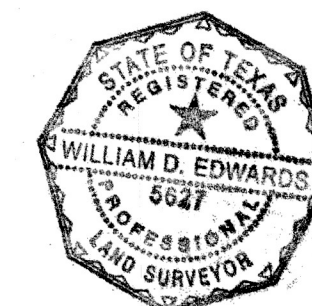

REVISION: MAY 20, 2008 PER CITY REVIEW (AP2008-01)  
REVISION: APR. 24, 2008 CREATION OF AMENDED PLAT  
REVISION: MAR. 26, 2007 PER ENGINEER PLANS  
REVISION: JUL. 25, 2006 PER CITY REVIEW (RP2006-05)

JOB # 2006-144 PLAT  
SURVEY DATE JUN 30, 2006  
DRAWING SCALE: 1" = 100'

OKLAHOMA CERT. AUTH. # 4780 EXP. DATE: JUN 30, 2006

PROFESSIONAL SURVEYORS SINCE 1975  
**EDWARDS SURVEYING, L.L.C.**  
TEXAS REGISTERED PROFESSIONAL LAND SURVEYORS  
OKLAHOMA LICENSED PROFESSIONAL LAND SURVEYORS  
P.O. BOX 618  
208 WEST WALNUT STREET  
DECATUR, WISE COUNTY, TEXAS 76234  
(940)-627-2961 OFFICE  
(940)-627-3951 FAX  
www.edwardsurveying.com

ON THE 30th DAY OF MAY, 2008, THIS AMENDING PLAT WAS DULY APPROVED BY THE PLANNING DIRECTOR OF THE CITY OF DECATUR, TEXAS.  
Richard England  
PLANNING DIRECTOR  
ATTEST: James A. Hull  
CITY SECRETARY

