

# **FLEX BUILDING FOR SALE**

## **320 Gateway Park Dr., N. Syracuse**

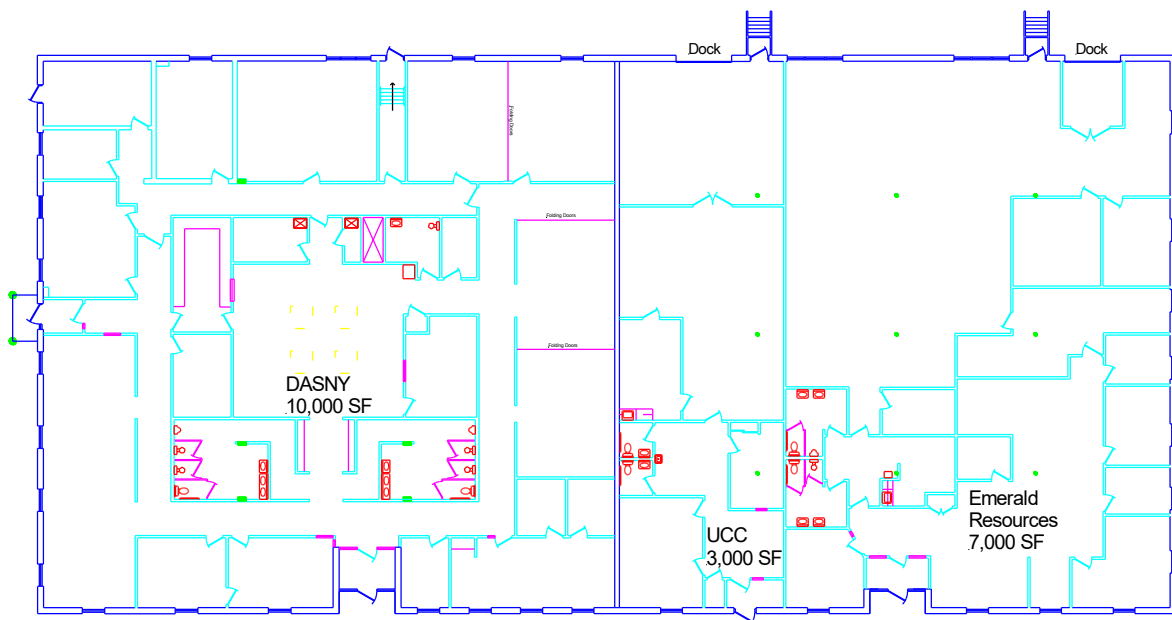

- 20,000 SF Office/Warehouse Building
- Fully Leased, Three (3) Tenant Spaces
- Great Access to Interstate 81
- New TPO Roof in 2021



6724 Thompson Road • Syracuse, NY 13211

For more info contact:  
Ed Rogers  
Phone: 315-463-8684  
Cell: 315-427-8510  
E-mail: [Ed@olivaco.com](mailto:Ed@olivaco.com)  
[www.olivaco.com](http://www.olivaco.com)

*All information is believed to be accurate. We are not responsible for misstatements of facts, errors or omissions, prior sales, and changes of price or withdrawal from the market without notice.*