

Retail Endcap For Lease

7808 N. Division Street Suite D.
Spokane WA, 99208

sds
COMMERCIAL



Levi McCormick
W: 509.462.9306
levi@sdsrealty.com

Carlos Herrera
C: 509.714.2593
carlos@sdsrealty.com

www.sdsrealty.com

SDS REALTY INC 108 N WASHINGTON #600, SPOKANE WA. 99201

This information has been secured from sources we believe to be reliable, but we make no representations or warranties, express or implied, as to the accuracy of the information. References to square footage or age are approximate. Buyer/tenant must verify the information and bears all risks for any inaccuracies.

OVERVIEW

Suite 4 – 2,062 square feet.

Located on the corner of Division and Lincoln.

Former restaurant.

Co-Tenants Crumbl Cookie and Eye Mart

Equipment and fixtures may be included.

Great parking, reciprocal with the center.

Patio seating.

Lease Rate \$25.00 PSF NNN
NNN estimated at \$8.00 PSF



RETAIL FOR LEASE

Carlos Herrera
C: 509.714.2593
Carlos@sdsrealty.com

Levi McCormick
W: 509.462.9306
levi@sdsrealty.com

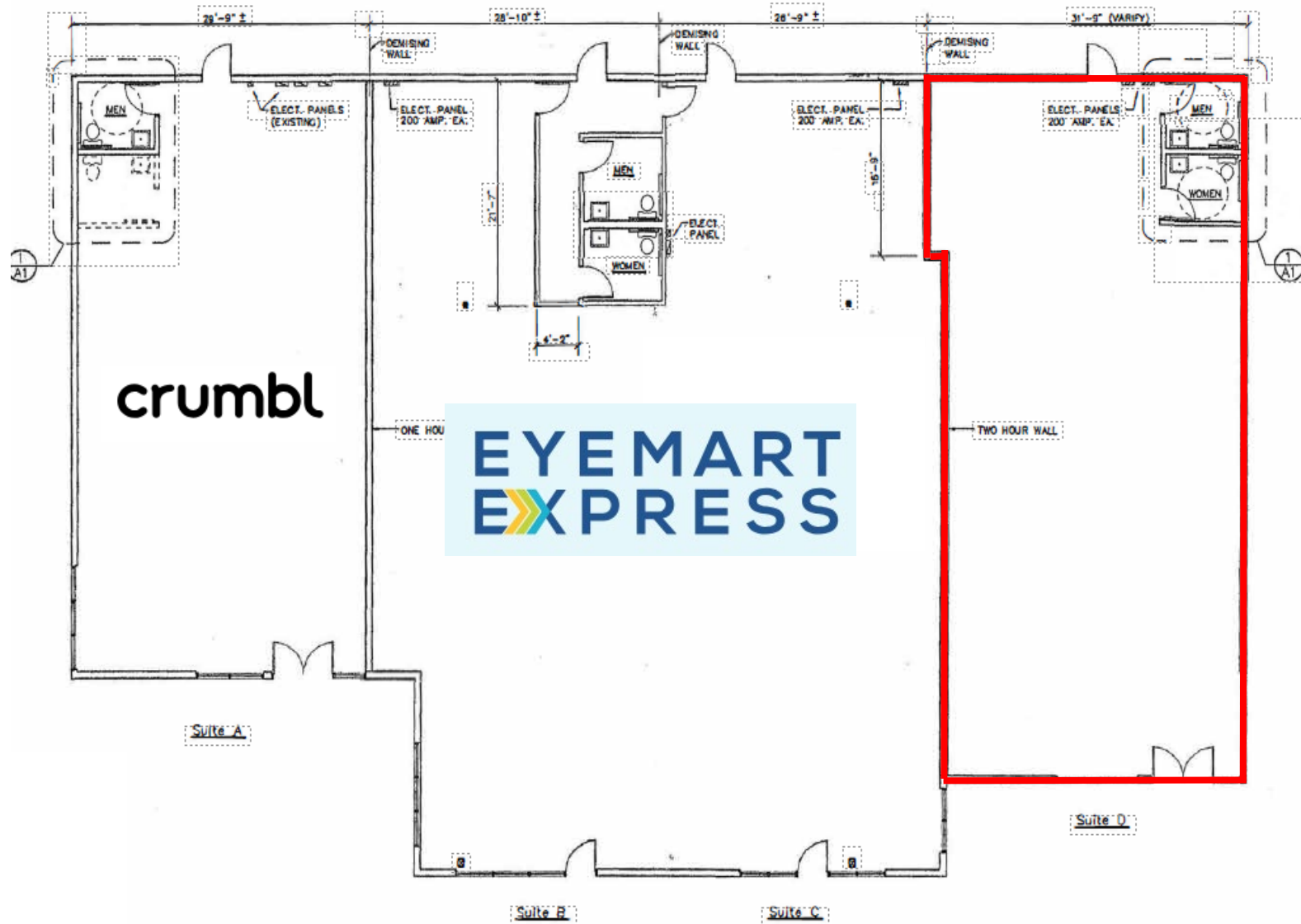

RETAIL FOR LEASE

Carlos Herrera
C: 509.714.2593
Carlos@sdsrealty.com

Levi McCormick
W: 509.462.9306
levi@sdsrealty.com

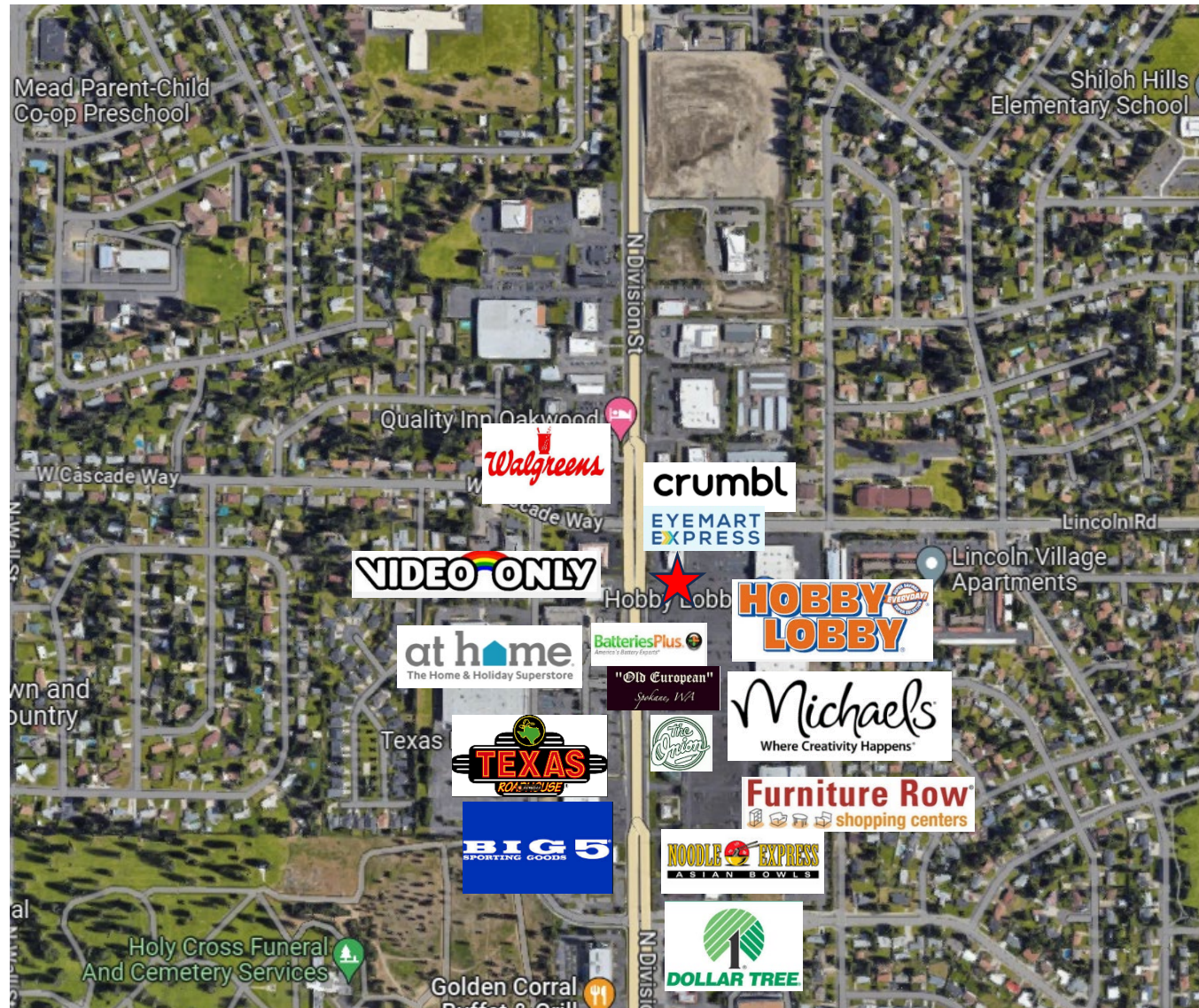

www.sdsrealty.com

SDS REALTY INC 108 N WASHINGTON #600, SPOKANE WA. 99201

This information has been secured from sources we believe to be reliable, but we make no representations or warranties, express or implied, as to the accuracy of the information. References to square footage or age are approximate. Buyer/tenant must verify the information and bears all risks for any inaccuracies.

RETAIL FOR LEASE

Carlos Herrera
C: 509.714.2593
Carlos@sdsrealty.com

Levi McCormick
W: 509.462.9306
levi@sdsrealty.com

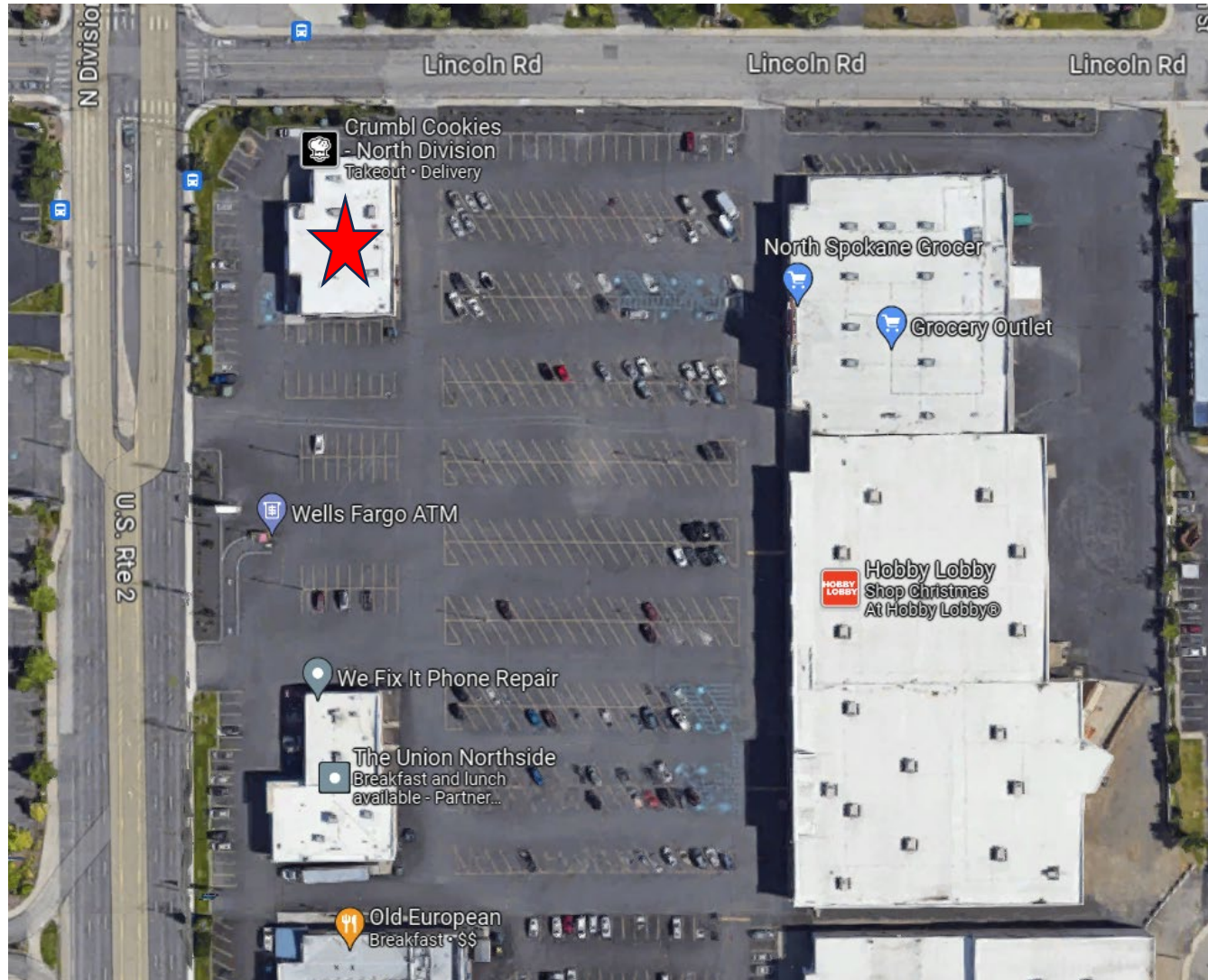

RETAIL FOR LEASE

Carlos Herrera
C: 509.714.2593
Carlos@sdsrealty.com

Levi McCormick
W: 509.462.9306
levi@sdsrealty.com



www.sdsrealty.com

SDS REALTY INC 108 N WASHINGTON #600, SPOKANE WA. 99201

This information has been secured from sources we believe to be reliable, but we make no representations or warranties, express or implied, as to the accuracy of the information. References to square footage or age are approximate. Buyer/tenant must verify the information and bears all risks for any inaccuracies.