

DAWSONVILLE OUTPARCELS

GA 400 & Blue Ridge Pkwy, Dawsonville, GA 30534



LAND AVAILABLE
0.8 - 3.6 Acres

PROPERTY HIGHLIGHTS

- Less than one mile from North Georgia Premium Outlets
- Graded pads with utilities
- High visibility and signage on GA 400
- Several new residential developments near the site, including a brand new 300 unit development directly behind the sites

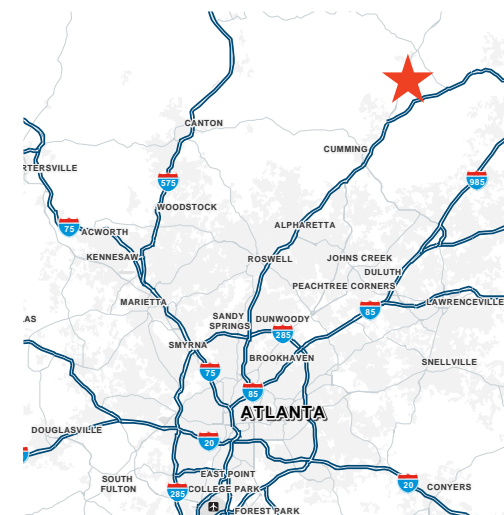

MARISA ROY

P: 770.913.3905

E: mroy@ackermanco.net

BRIAN LEFKOFF

P: 770.913.3937

E: blefkoff@ackermanco.net

Ackerman Retail
A DIVISION OF ACKERMAN & CO

DAWSONVILLE OUTPARCELS

GA 400 & Blue Ridge Pkwy, Dawsonville, GA 30534

Retail/Residential Market Aerial



Ackerman Retail

MARISA ROY

P: 770.913.3905

E: mroy@ackermanco.net

BRIAN LEFKOFF

P: 770.913.3937

E: blefkoff@ackermanco.net

©2025 Ackerman & Co. All rights reserved. While we have no reason to doubt the accuracy of the information provided from sources we deem reliable, but neither ownership nor we guarantee it and therefore assume no liability for errors, omissions or changes to this content. Sources include CoStar, SitesUSA, ESRI, and Georgia DOT.

GA 400 & Blue Ridge Pkwy, Dawsonville, GA 30534

MARISA ROY

P: 770.913.3905

E: mroy@ackermanco.net

BRIAN LEFKOFF

P: 770.913.3937

E: blefkoff@ackermanco.net

©2025 Ackerman & Co. All rights reserved. While we have no reason to doubt the accuracy of the information provided from sources we deem reliable, but neither ownership nor we guarantee it and therefore assume no liability for errors, omissions or changes to this content. Sources include CoStar, SitesUSA, ESRI, and Georgia DOT.

DAWSONVILLE OUTPARCELS

GA 400 & Blue Ridge Pkwy, Dawsonville, GA 30534

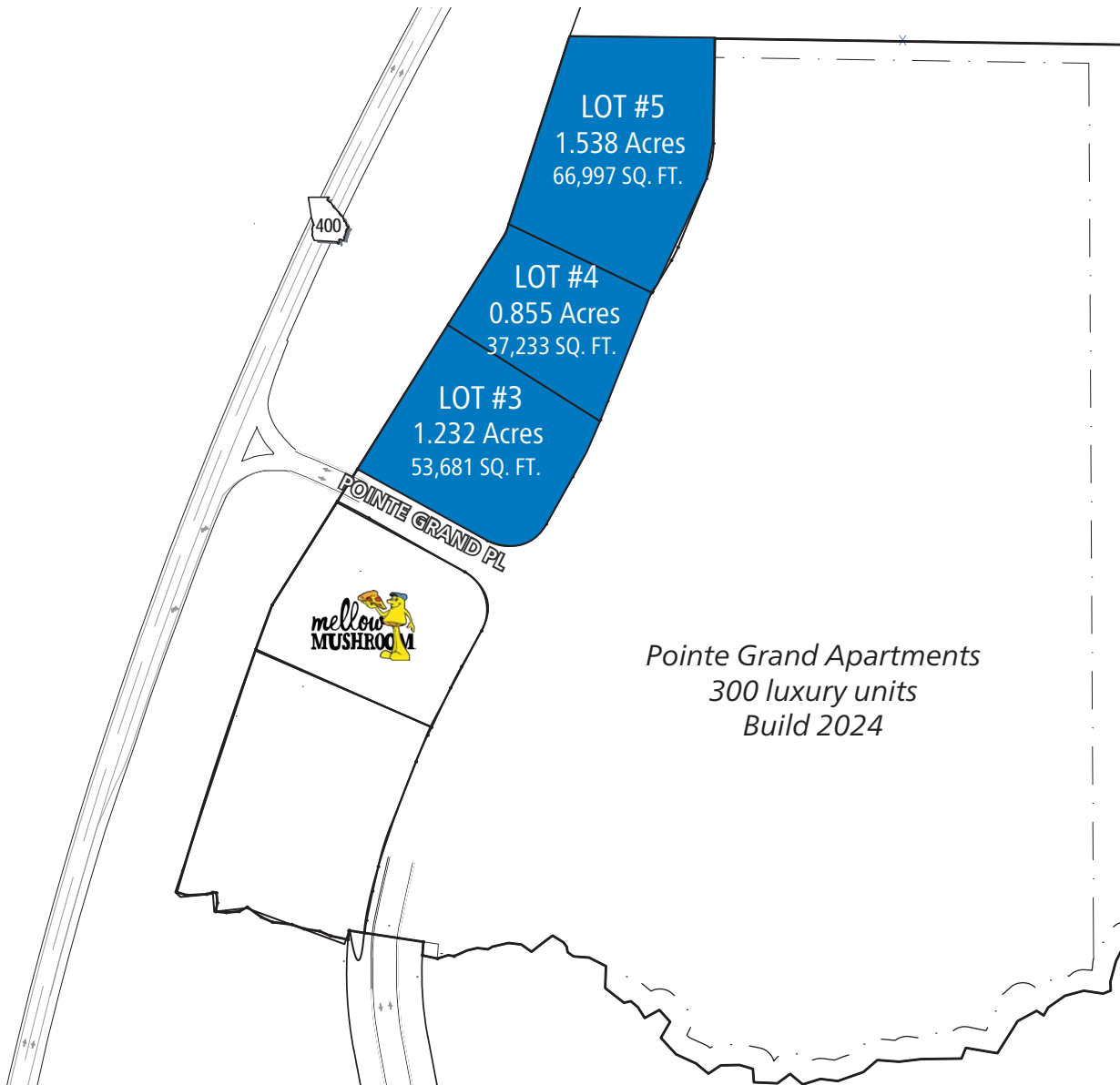

AREA DEMOGRAPHICS (2025):

	1-MILE	3-MILE	5-MILE
POPULATION	2,016	19,494	42,886
HOUSEHOLDS	795	6,926	15,207
AVG HH INCOME	\$106,024	\$137,853	\$141,004

Ackerman Retail

MARISA ROY

P: 770.913.3905

E: mroy@ackermanco.net

BRIAN LEFKOFF

P: 770.913.3937

E: blefkoff@ackermanco.net

©2025 Ackerman & Co. All rights reserved. While we have no reason to doubt the accuracy of the information provided from sources we deem reliable, but neither ownership nor we guarantee it and therefore assume no liability for errors, omissions or changes to this content. Sources include CoStar, SitesUSA, ESRI, and Georgia DOT.