

East Glendale Avenue

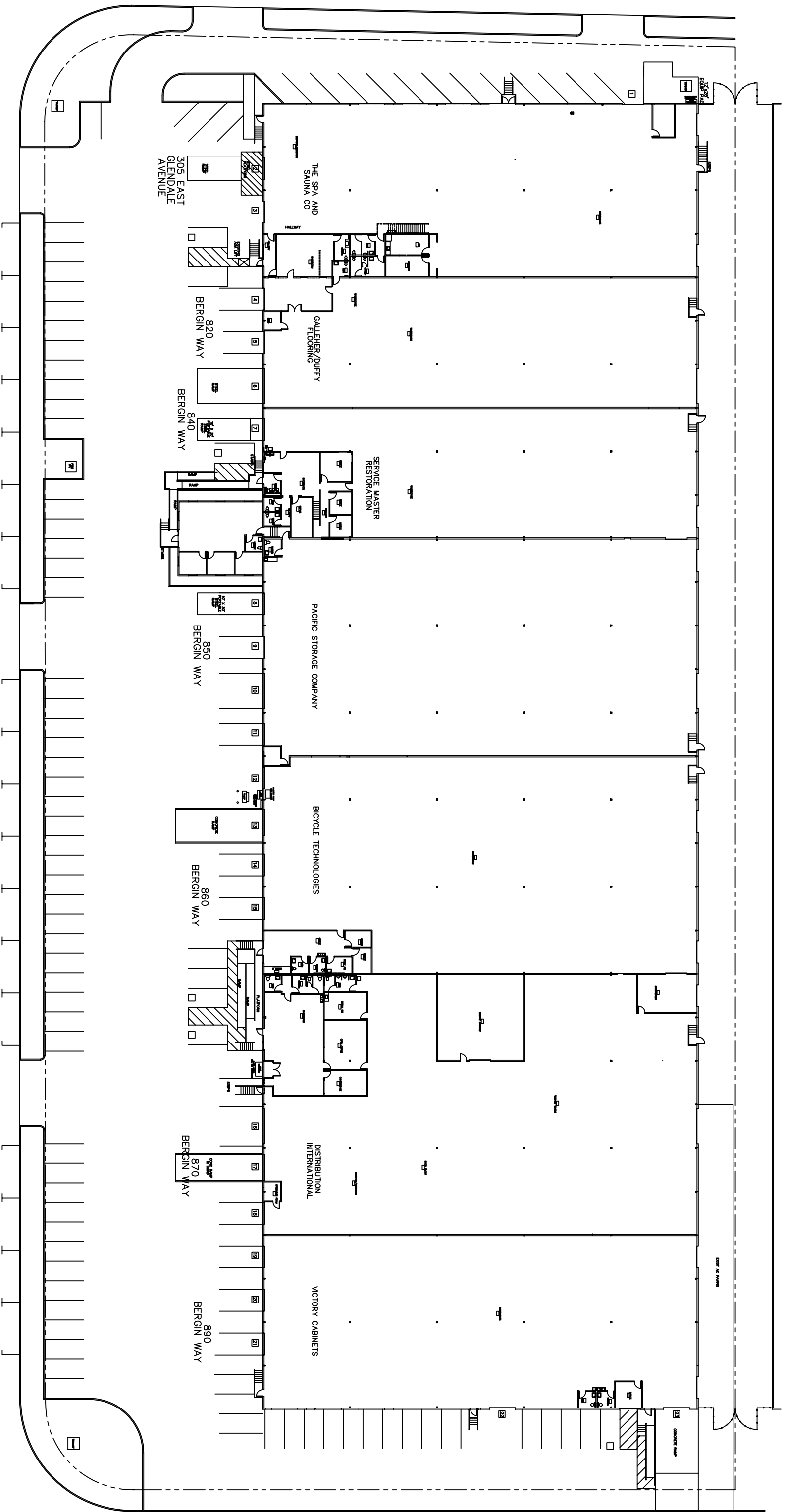

Bergin Way

Overmeyer Road

Crossroads Industrial Building

305 East Glendale Avenue
820-890 Bergin Way
Sparks, Nevada

Site Plan

0 20 50

Scale: 1" = 50'-0"

Sheet Size: 11x17

Date: 10/01/25



800 Stillwell Ave
Suite 30
Reno, Nevada 89512
(775) 750 3966
License 35002