



AVAILABLE FOR SALE OR LEASE

19466 FLIGHTPATH WAY  
**BAKERSFIELD, CA**



# FOR SALE OR LEASE

## 19466 FLIGHTPATH WAY



- Class A Industrial/Flex facility, featuring three buildings: (1) Admin/Office; (2) Warehouse; (3) Warehouse/Shop
- Conveniently surrounded by a strong mix of industrial operators, restaurant amenities, gas stations, and hotels.
- Close proximity to the Meadows Field Airport. Easy access to major travel corridors - Hwy 99 & Hwy 65

### PROPERTY FEATURES

<b>Total Building Size:</b>	±35,517 SF	<b>Main Power:</b>	2000 Amp, 480/277 V, 3 Phase, 4 Wire
<b>Lot Size:</b>	6.62 Acres	<b>APNs:</b>	482-180-17-00-7 & 482-180-20-00-5
<b>Admin/Office:</b>	±24,456 SF	<b>Zoning:</b>	M-1 PD H, County of Kern
<b>Warehouse:</b>	±8,741 SF (HVAC conditioned)	<b>Asking Rent:</b>	\$1.60psf/month, Industrial Gross
<b>Warehouse Shop:</b>	±2,320 SF	<b>Asking Price:</b>	\$7,000,000



# FOR SALE OR LEASE

## 19466 FLIGHTPATH WAY



### SITE PLAN

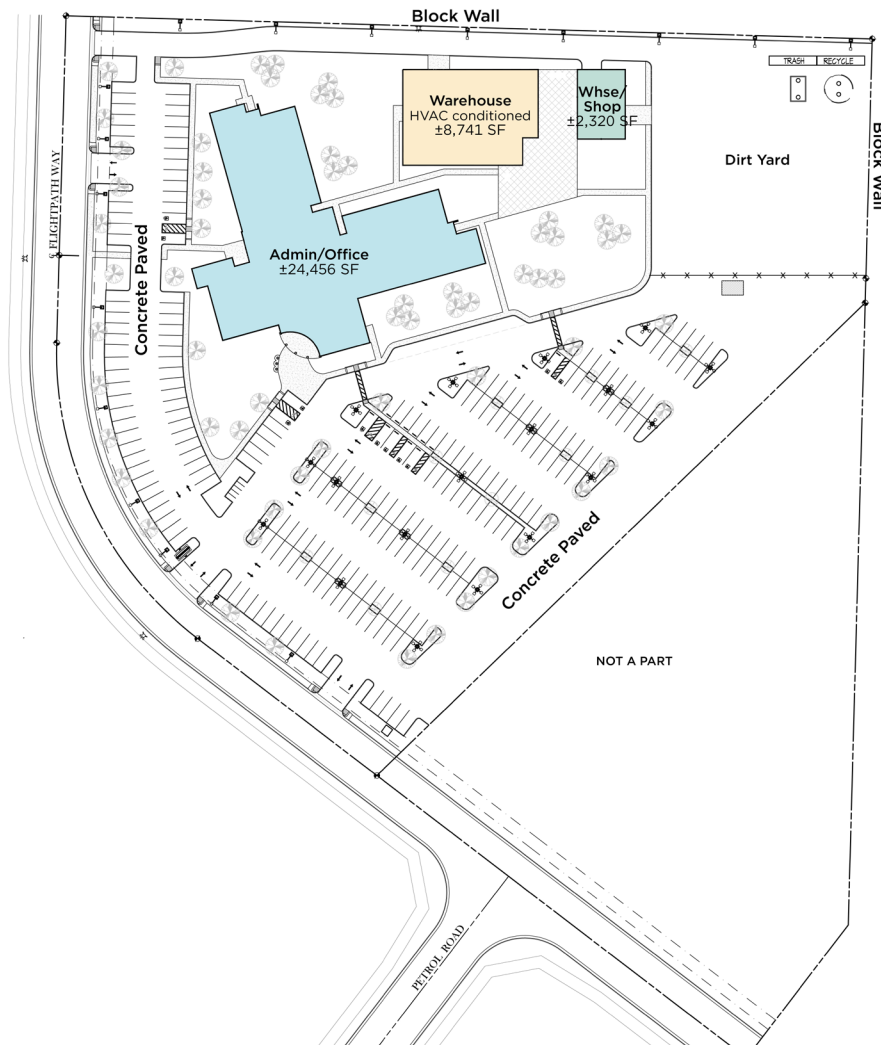

**Total Building Size:** ±35,517 SF

**Lot Size:** 6.62 Acres

**Admin/Office:** ±24,456 SF

**Admin Power:** 600 Amps, 480/277 V, 3 Ph

**Warehouse:** ±8,741 SF (HVAC conditioned)

**Warehouse Power:** 200 Amps, 480/277 V, 3 Ph

**Warehouse/Shop:** ±2,320 SF

**Warehouse/Shop Power:** 400 Amps, 480/277 V, 3 Ph

# FOR SALE OR LEASE

## 19466 FLIGHTPATH WAY

### FLOOR PLAN - ADMIN/OFFICE

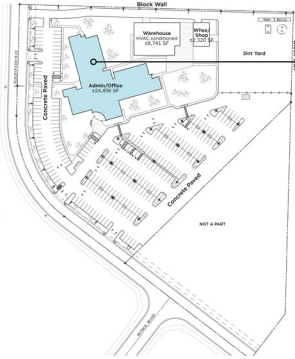

- Admin/Office  
±24,456 SF
- Power  
600 Amps, 480/277 V, 3 Ph



# FOR SALE OR LEASE

## 19466 FLIGHTPATH WAY

### FLOOR PLAN - WAREHOUSE (HVAC CONDITIONED)

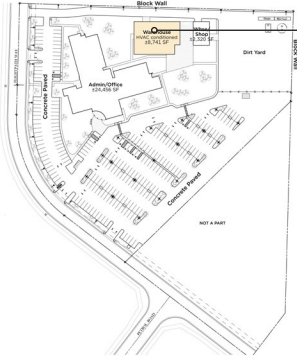

- **Warehouse**  
±8,741 SF
- **Power**  
200 Amps, 480/277 V, 3 Ph
- **Loading**  
(2) 14' x 16' Roll-Up Doors

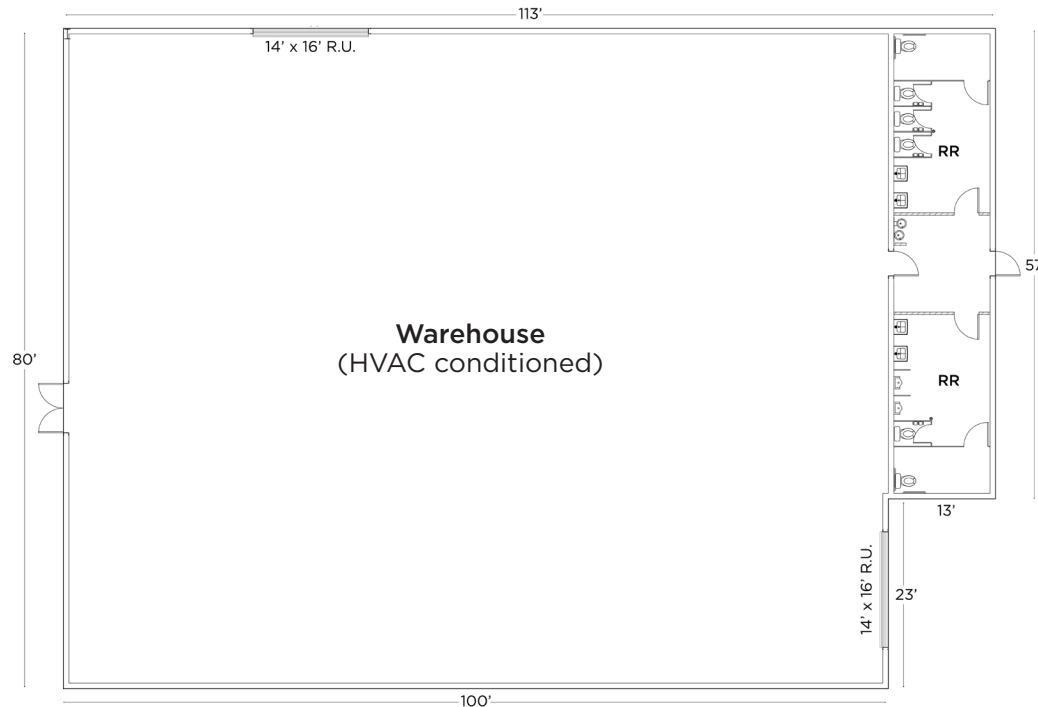



# FOR SALE OR LEASE

## 19466 FLIGHTPATH WAY

### FLOOR PLAN - WAREHOUSE/SHOP



- **Warehouse/Shop**  
±2,320 SF
- **Power**  
400 Amps, 480/277 V, 3 Ph
- **Loading**  
(2) 14' x 16' Roll-Up Doors





# FOR SALE OR LEASE

## 19466 FLIGHTPATH WAY







**For more information, please contact:**

**WAYNE KRESS, SIOR**

Executive Director  
wayne.kress@cushwake.com  
+1 661 706 5692  
Lic. #00834680

**COBY VANCE**

Senior Director  
coby.vance@cushwake.com  
+1 661 203 4400  
Lic. #01449929

**SCOTT REYNOLDS**

Director  
scott.reynolds@cushwake.com  
+1 661 330 7616  
Lic. #01382493

5060 California Avenue  
Suite 1000  
Bakersfield, CA 93309  
Lic. #01880493  
cushmanwakefield.com

©2025 Cushman & Wakefield. All rights reserved. The information contained in this communication is strictly confidential. This information has been obtained from sources believed to be reliable but has not been verified. NO WARRANTY OR REPRESENTATION, EXPRESS OR IMPLIED, IS MADE AS TO THE CONDITION OF THE PROPERTY (OR PROPERTIES) REFERENCED HEREIN OR AS TO THE ACCURACY OR COMPLETENESS OF THE INFORMATION CONTAINED HEREIN, AND SAME IS SUBMITTED SUBJECT TO ERRORS, OMISSIONS, CHANGE OF PRICE, RENTAL OR OTHER CONDITIONS, WITHDRAWAL WITHOUT NOTICE, AND TO ANY SPECIAL LISTING CONDITIONS IMPOSED BY THE PROPERTY OWNER(S). ANY PROJECTIONS, OPINIONS OR ESTIMATES ARE SUBJECT TO UNCERTAINTY AND DO NOT SIGNIFY CURRENT OR FUTURE PROPERTY PERFORMANCE.

