

# Well Located Industrial Space

Full Building Opportunity

2620 W Henrietta Rd  
Henrietta, NY 14623

Warehouse With Office Space In The Town Of Henrietta



## Property Overview

Approximately 51,643 square foot industrial building with high bay warehouse (27' clear), low bay warehouse (14' clear) and office space. The building features 4 loading docks, 1 grade level door, sprinklers throughout, 400 amps at 240v, 3 phase power, a concrete truck court and a fenced outdoor storage area. The property is centrally located on West Henrietta Road, providing convenient access to the Greater Rochester Market and I-90 (The New York State Thruway)

## Offering Details

- + 51,643± SF Available
- + High Bay Warehouse Up To 27' Clear, Low Bay 14' Clear
- + 4 Docks & 1 Grade Level Door
- + Sale Price: \$3,900,000
- + Lease Rate: Negotiable

## Industrial Space

2620 W Henrietta Rd | Henrietta, NY 14623

# For Sale or Lease



## Property Details

- + 51,643± SF on 5.3 Acres
- + Zoned BF-2 (General Commercial District)
- + 400 amps at 240v, 3 Phase
- + Sprinklers Throughout
- + High Bay 23'-27' Clear, Low Bay 14' Clear
- + 4 Docks, 2 with Levelers, all have enclosures, 1 Overhead Door
- + Concrete Truck Court
- + Small Fenced Outside Storage Area
- + Built in 1960, Expanded in 1993
- + Warehouse Areas Are Heat Only
- + Parcel ID 148.16-1-14

## Contact Us

### Patrick Wahl

+1 585 784 3633

patrick.wahl@cbre-rochester.com

Licensed Real Estate Salesperson

### Harry Gleason, SIOR

+1 585 784 3639

harry.gleason@cbre-rochester.com

Licensed Associate Real Estate Broker

© 2026 CBRE Upstate NY, part of the CBRE Affiliate Network. All rights reserved. This information has been obtained from sources believed reliable, but has not been verified for accuracy or completeness. You should conduct a careful, independent investigation of the property and verify all information. Any reliance on this information is solely at your own risk. CBRE Upstate NY and the CBRE Upstate NY logo are service marks of CBRE Upstate NY. All other marks displayed on this document are the property of their respective owners, and the use of such logos does not imply any affiliation with or endorsement of CBRE Upstate NY. Photos herein are the property of their respective owners. Use of these images without the express written consent of the owner is prohibited.

### CBRE Upstate NY

1350 University Ave, Ste 100

Rochester, NY 14607

+1 585 240 8080

www.cbre.com/rochester

# CBRE Upstate NY

PART OF THE AFFILIATE NETWORK

## Industrial Space

2620 W Henrietta Rd | Henrietta, NY 14623

# For Sale or Lease



## Contact Us

### Patrick Wahl

+1 585 784 3633

patrick.wahl@cbre-rochester.com

Licensed Real Estate Salesperson

### Harry Gleason, SIOR

+1 585 784 3639

harry.gleason@cbre-rochester.com

Licensed Associate Real Estate Broker

### CBRE Upstate NY

1350 University Ave, Ste 100

Rochester, NY 14607

+1 585 240 8080

www.cbre.com/rochester

# CBRE Upstate NY

PART OF THE AFFILIATE NETWORK

## Industrial Space

2620 W Henrietta Rd | Henrietta, NY 14623

# For Sale or Lease

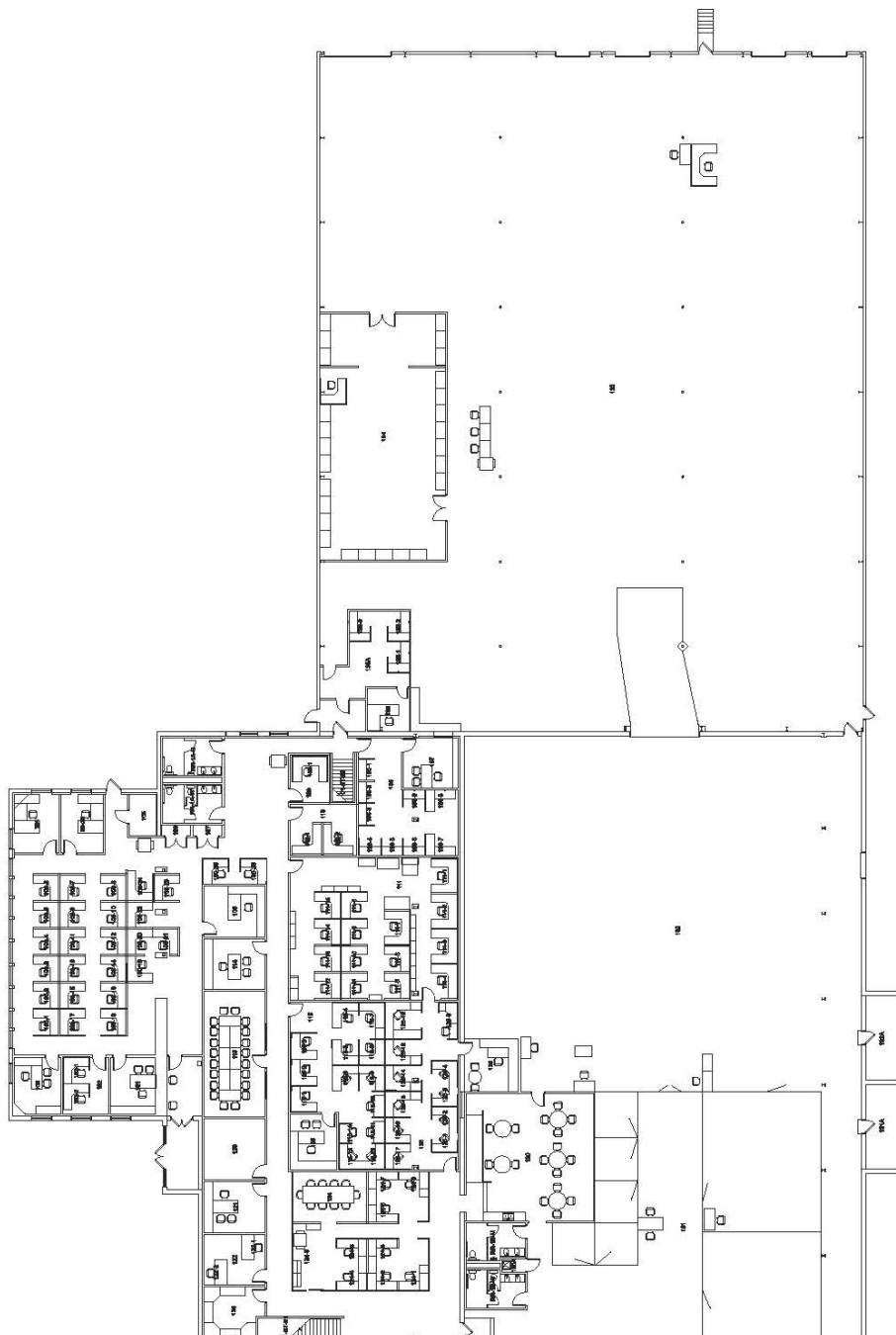

## Contact Us

### Patrick Wahl

+1 585 784 3633

[patrick.wahl@cbre-rochester.com](mailto:patrick.wahl@cbre-rochester.com)

Licensed Real Estate Salesperson

### Harry Gleason, SIOR

+1 585 784 3639

[harry.gleason@cbre-rochester.com](mailto:harry.gleason@cbre-rochester.com)

Licensed Associate Real Estate Broker

### CBRE Upstate NY

1350 University Ave, Ste 100

Rochester, NY 14607

+1 585 240 8080

[www.cbre.com/rochester](http://www.cbre.com/rochester)

# CBRE Upstate NY

PART OF THE AFFILIATE NETWORK

## Industrial Space

2620 W Henrietta Rd | Henrietta, NY 14623

# For Sale or Lease

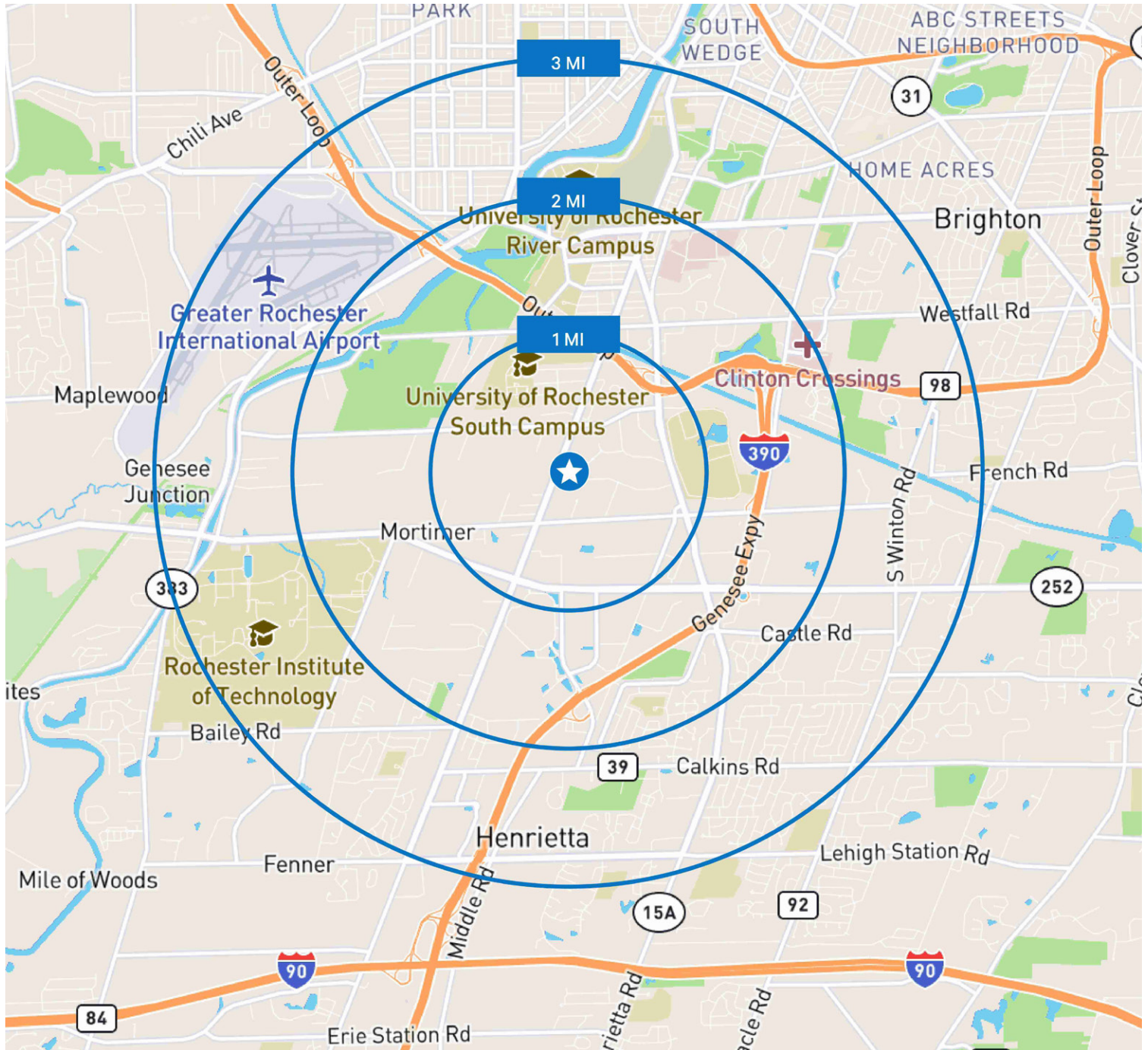

## Contact Us

### Patrick Wahl

+1 585 784 3633

patrick.wahl@cbre-rochester.com

Licensed Real Estate Salesperson

### Harry Gleason, SIOR

+1 585 784 3639

harry.gleason@cbre-rochester.com

Licensed Associate Real Estate Broker

### CBRE Upstate NY

1350 University Ave, Ste 100

Rochester, NY 14607

+1 585 240 8080

www.cbre.com/rochester

# CBRE Upstate NY

PART OF THE AFFILIATE NETWORK