

Red River Business Park

5501 Bonham St, Paris, TX 75460

Presented by
Red River Business Park



Price: \$10.00 /SF/YR

Red River Business Park features security cameras onsite, Energy efficient LED lighting inside and out.

Flexible Office/Warehouse Space perfect for a small business owner.

Office size is 9x13 includes A/C and Heat with a restroom behind it.

Warehouses are fully insulated.

Grade level loading with 12x14 overhead door.
1,250 - 5,000 SF available

Ready to service the NE Texas and Red River Valley trade area.

Phase 1 is fully leased.

Pre-Leasing now for Phase 2 and will be available January 2024.

Be sure to get your spot reserved as they are going fast.

Red River Business Park

5501 Bonham St, Paris, TX 75460



Red River Business Park is a new construction Class A warehouse cluster in the Paris area.

Each building is 5,000 SF divisible down to 1,250 SF. Custom sizes are available.

Each unit consists of an air-conditioned office with a restroom and fully insulated warehouse.

Conveniently located on Hwy 82 just 1 mile West of Loop 286.

Phase 1 is fully leased.

Pre-leasing Phase 2 available January 2024. Reserve your unit now as they are leasing up fast.



Dale Smith

info@storageparis.com

(903) 914-0850

Red River Business Park

5501 Bonham St
Paris, TX 75460

Red River Business Park

5501 Bonham St, Paris, TX 75460

5501 Bonham St, Paris, TX 75460



OW Exterior 1 Suite



OW 3 Buildings from East

Listing spaces

1st Floor Ste A

| | |
|-----------------|------------------|
| Space Available | 1,250 - 5,000 SF |
| Rental Rate | \$10.00 /SF/YR |
| Date Available | January 01, 2024 |
| Service Type | Industrial Gross |
| Space Type | Relet |
| Space Use | Flex |
| Lease Term | 1 - 3 Years |

New construction! Pre-leasing Phase 2! Expected delivery Q1 2024! Custom Building sizes available.

Ste B

| | |
|-----------------|------------------|
| Space Available | 1,250 SF |
| Rental Rate | \$10.00 /SF/YR |
| Date Available | Now |
| Service Type | Industrial Gross |
| Space Type | Relet |
| Space Use | Flex |
| Lease Term | 1 - 3 Years |

One 1,250 square foot space available in building one! 2,500 square foot suite - leased! 1,250 square foot suite - leased! Building three entirely leased.

5501 Bonham St, Paris, TX 75460



OW Inside large office

Listing spaces

Ste C+D

| | |
|-----------------|------------------|
| Space Available | 1,250 - 5,000 SF |
| Rental Rate | \$10.00 /SF/YR |
| Date Available | Now |
| Service Type | Industrial Gross |
| Space Type | Relet |
| Space Use | Flex |
| Lease Term | 1 - 3 Years |

One 2,500 square foot space available in building two! Both 1,250 square foot suites in building two have leased! Building 3 entirely leased.

Red River Business Park

5501 Bonham St, Paris, TX 75460

Property Photos



OW office small full



OW restroom

Red River Business Park

5501 Bonham St, Paris, TX 75460

Property Photos



OW warehouse looking at office full



OW warehouse full

Red River Business Park

5501 Bonham St, Paris, TX 75460

Property Photos



OW warehouse looking at office



Drone of OW, CC and BT from East

Red River Business Park

5501 Bonham St, Paris, TX 75460

Property Photos



Drone overhead from NE



OW warehouse dumptruck

Red River Business Park

5501 Bonham St, Paris, TX 75460

Property Photos



OW Empty warehouse



OW warehouse

Red River Business Park

5501 Bonham St, Paris, TX 75460

Property Photos



OW warehouse - 2



OW nighttime 2 buildings - 2

Red River Business Park

5501 Bonham St, Paris, TX 75460

Property Photos

**Red River Business Park
Office & Warehouse Suites**

Standard
Office: 11'-11" x 11'-4"

Upgrade
Reception: 11'-11" x 11'-4"
Office: 14'-2" x 11'-4"

Premium
Reception: 11'-11" x 11'-4"
Office: 21'-6" x 11'-4"

Each Suite will offer:

- LED Lighting inside and out
- Fully Insulated Warehouse
- 1,250 sq ft each office/warehouse suite
- 9 ft drop ceiling
- AC & heated office area
- Signage available for each suite
- 12 x 14 ft Roll Up Door
- Restroom with sink and toilet
- 1,250 - 5,000 sq ft available

Build out unit options

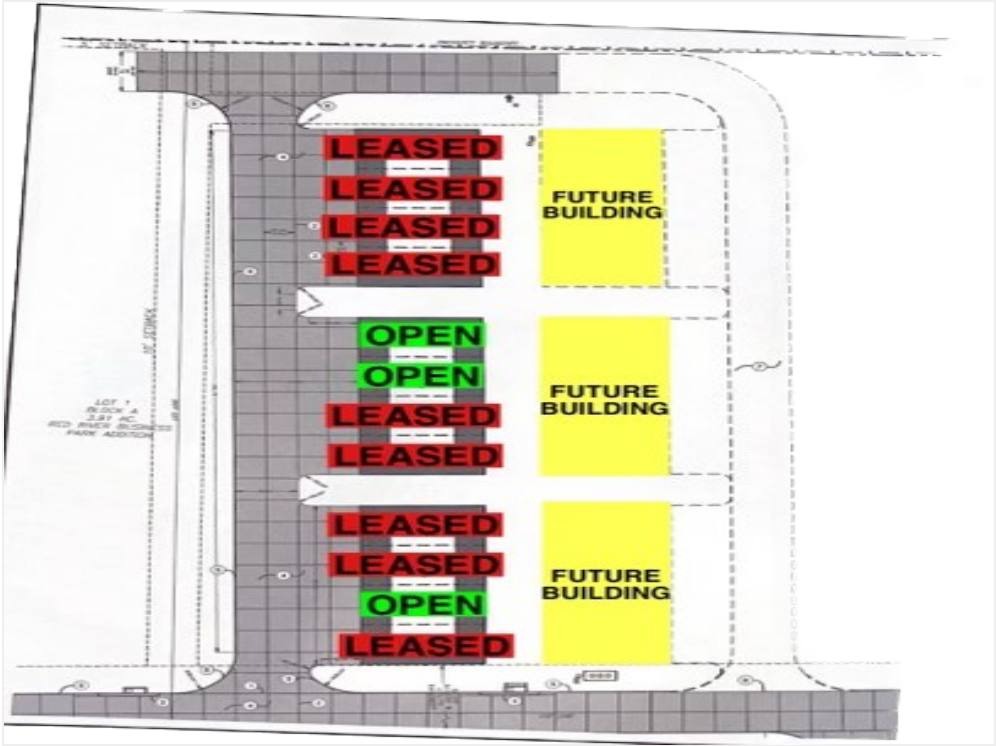

Building Photo

Red River Business Park

5501 Bonham St, Paris, TX 75460

Location

