



Available For Lease

Jeff Smart

Senior Executive Vice President
Lic. 00918873
+1 310 321 1812
jeffrey.smart@colliers.com

Elizabeth Capati

Senior Associate
Lic. 02109628
+1 310 321 1855
elizabeth.capati@colliers.com

2051 E. Maple Ave
El Segundo, CA 90245

Property Features

Total SF	32,081
Office SF	7,200
Clear Height	14'
Power	1600 Amps
Loading Doors	4 DH / 1 GL
Sprinklers	Yes
Parking	34
Location	Close to LAX with great 105 & 405 Freeway access
Rate / NNN	\$2.25 NNN + approx. \$.40 OpEx
Possession	Now



2051 E. Maple Avenue

Site Plan

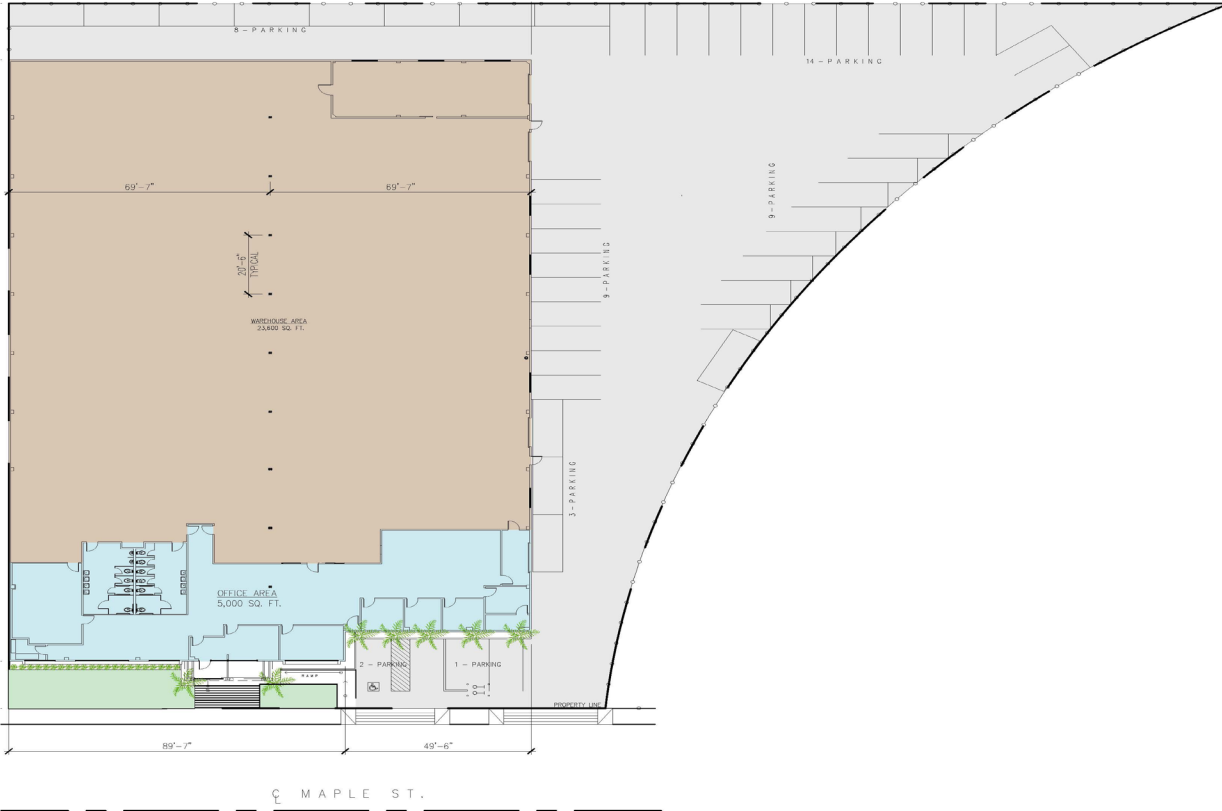

This document has been prepared by Colliers International for advertising and general information only. Colliers International makes no guarantees, representations or warranties of any kind, expressed or implied, regarding the information including, but not limited to, warranties of content, accuracy and reliability. Any interested party should undertake their own inquiries as to the accuracy of the information. Colliers International excludes unequivocally all inferred or implied terms, conditions and warranties arising out of this document and excludes all liability for loss and damages arising there from. This publication is the copyrighted property of Colliers International and/or its licensor(s). ©2021. All rights reserved.

Get In Touch

Jeff Smart

Senior Executive Vice President

Lic. 00918873

+1 310 321 1812

jeffrey.smart@colliers.com

Elizabeth Capati

Senior Associate

Lic. 02109628

+1 310 321 1855

elizabeth.capati@colliers.com



2051 E. Maple Avenue

Aerial View

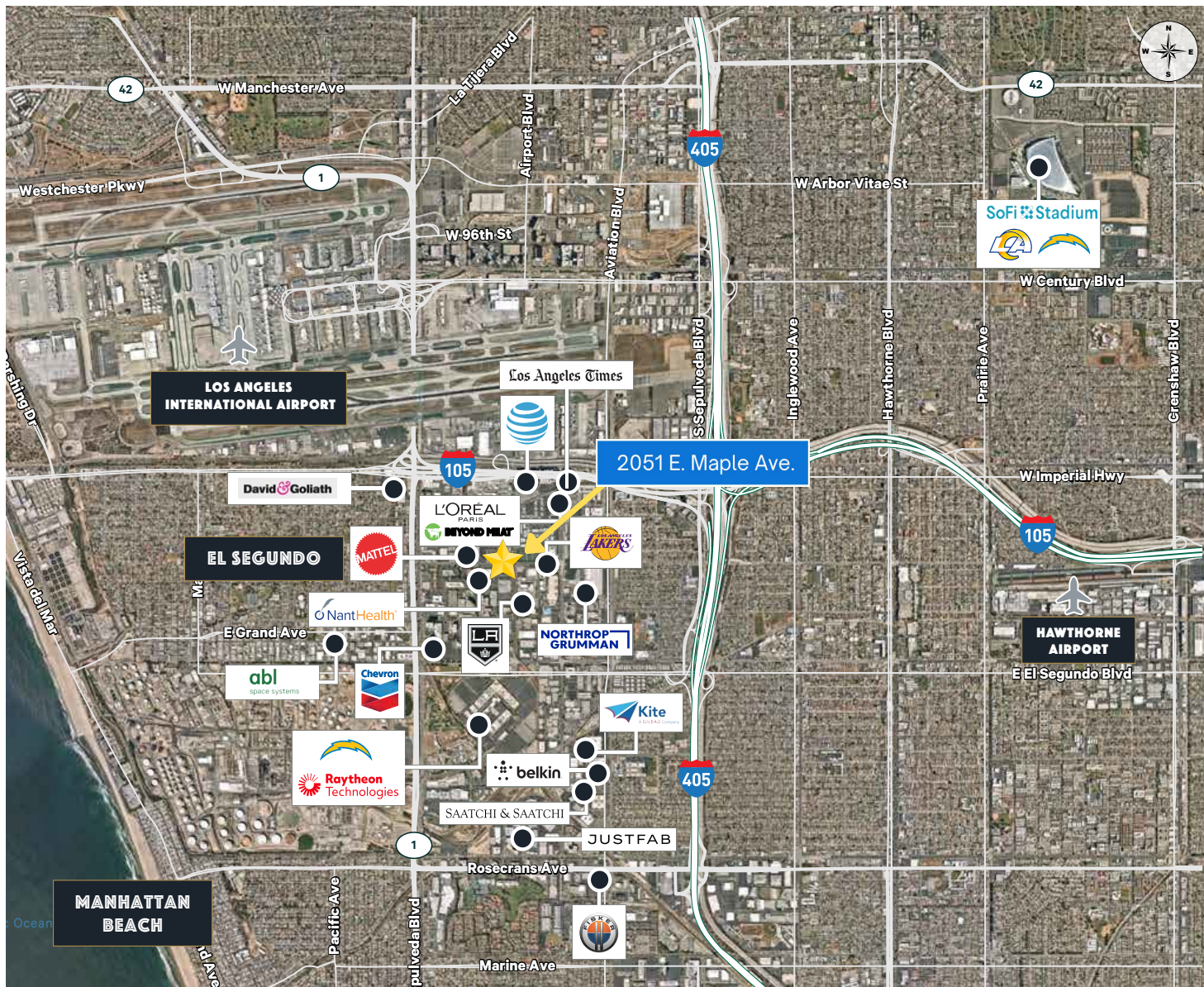

Jeff Smart

Senior Executive Vice President
+1 310 321 1812
jeffrey.smart@colliers.com
License No. 00918873

Elizabeth Capati

Senior Associate
+1 310 321 1855
elizabeth.capati@colliers.com
License No. 02109628

Colliers International

2121 Rosecrans Ave | Suite 1120
El Segundo, CA 90245
P: +1 310 787 1000

Copyright © 2021 Colliers International. Information herein has been obtained from sources deemed reliable, however its accuracy cannot be guaranteed. The user is required to conduct their own due diligence and verification.