

# For lease

Riverside Commerce Center IV  
1040 Riverside Pkwy  
West Sacramento, CA 95605

Riverside Commerce Center  
owned by:



**Available April 1, 2026: Suite 130 | ±5,861 SF | with ±1,532 SF office**

- Building Size: ±47,630 SF; ±380' x 142'
- Zoning: BP (City of West Sacramento)
- Concrete tilt-up
- 6' reinforced concrete slab
- Ceiling clear height: 24'
- Column spacing: 50' x 40'
- Fiber ready
- Skylights
- Grade-level doors: 12' x 14'
- Loading docks: 10' x 10'
- Parking: 2.8/1,000
- Fire protection: wet system (0.64 gpm/2,000 SF)
- Roof: metal truss with wood overlay, 4-ply

## Site plan

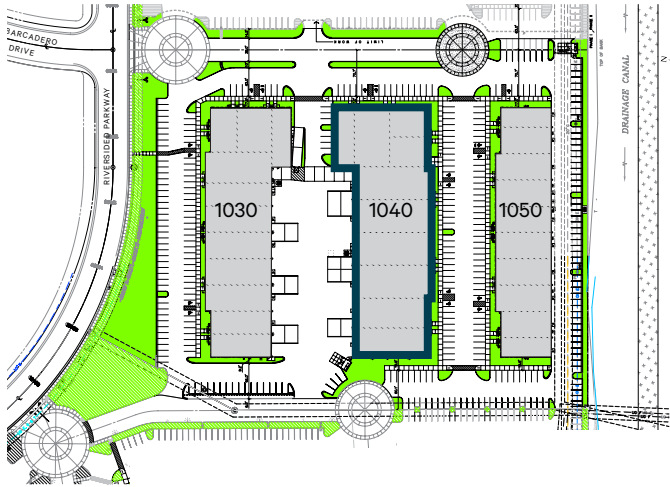

## Location map



## Floor plan



SITE PLAN NOT TO SCALE. ALL DIMENSIONS ARE APPROXIMATE.

## JLL Sacramento Industrial Team

### Dominic Smith

Senior Associate

[Dominic.Smith@jll.com](mailto:Dominic.Smith@jll.com)

+1 916 995 9396

RE Lic. 02106714

### RJ Jimenez

Associate

[RJ.Jimenez@jll.com](mailto:RJ.Jimenez@jll.com)

+1 940 597 9341

RE Lic. 02248675

### Mike Luca, SIOR

Senior Managing Director

[Mike.Luca@jll.com](mailto:Mike.Luca@jll.com)

+1 916 214 0466

RE Lic. 01447904

Jones Lang LaSalle

Brokerage, Inc.

CA Real Estate License #01856260

Although information has been obtained from sources deemed reliable, JLL does not make any guarantees, warranties or representations, express or implied, as to the completeness or accuracy as to the information contained herein. Any projections, opinions, assumptions or estimates used are for example only. There may be differences between projected and actual results, and those differences may be material. JLL does not accept any liability for any loss or damage suffered by any party resulting from reliance on this information. If the recipient of this information has signed a confidentiality agreement with JLL regarding this matter, this information is subject to the terms of that agreement. ©2025. Jones Lang LaSalle Brokerage, Inc. All rights reserved. JMYERS RiversideCommerceCenter@Marketing