



info@gullo.com
www.gullo.com

890 Wood Dale Road

Wood Dale, IL 60143



Proposed Building Highlights

- Free Standing Building
- Excellent Visibility
- DuPage County Real Estate Taxes
- 48,242 S.F. Building +/-
- 9,800 S.F. Office +/-
- 25' Clear at Low Point +/-
- (6) Exterior Docks (9' x 10')
- (1) DID
- 82 Car Stalls +/-
- 600 Amps, 120/240 Volt, 3 Phase, 4 Wire
- Gas Unit Heaters, AC
- Wet System
- I-2 Industrial Zoning
- Rental Rate: Subject to Offer
- CAM: Lessee Responsibility
- Ideal Sales Office/Showroom, Distribution, Freight Forwarding
- I-390 + Wood Dale



Building a Better Image

For more information contact: Giovanni Gullo or Mariann Gullo | Phone: 847.364.7000 | Email: info@gullo.com
Gullo International | Development Corporation | Realty Group • 1100 Landmeier Road • Elk Grove Village, IL 60007
LinkedIn: www.linkedin.com/company/gullo-international-development-corporation
Website: www.gullo.com

All information herein is from sources deemed reliable but not guaranteed accurate. Subject to errors, omissions, and to change of price and terms, prior sale or lease, all without notice.
In compliance with Illinois law, Gullo International Realty Group (broker) hereby gives written notice of the existence of an agency relationship between broker and the owner of the above referenced property.
All Gullo International Realty Group real estate agents represent the owner of the above property in negotiation of price terms, conditions, and the consummation of any lease or sale contract.



880 WOOD DALE ROAD, WOOD DALE, ILLINOIS

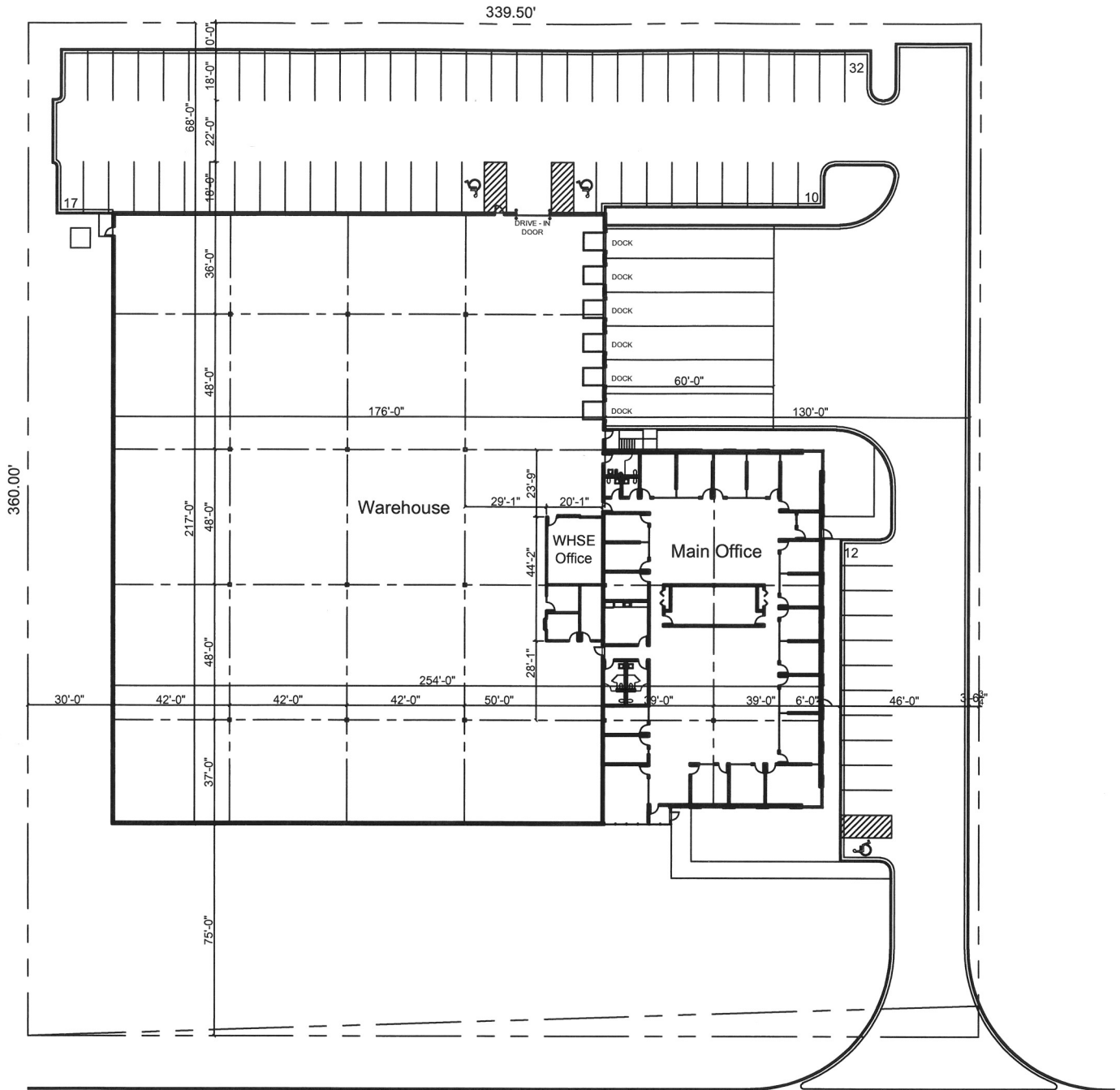

WOOD DALE ROAD