

FOR LEASE | EXECUTIVE SUITES | 2550 GRAY FALLS DR.

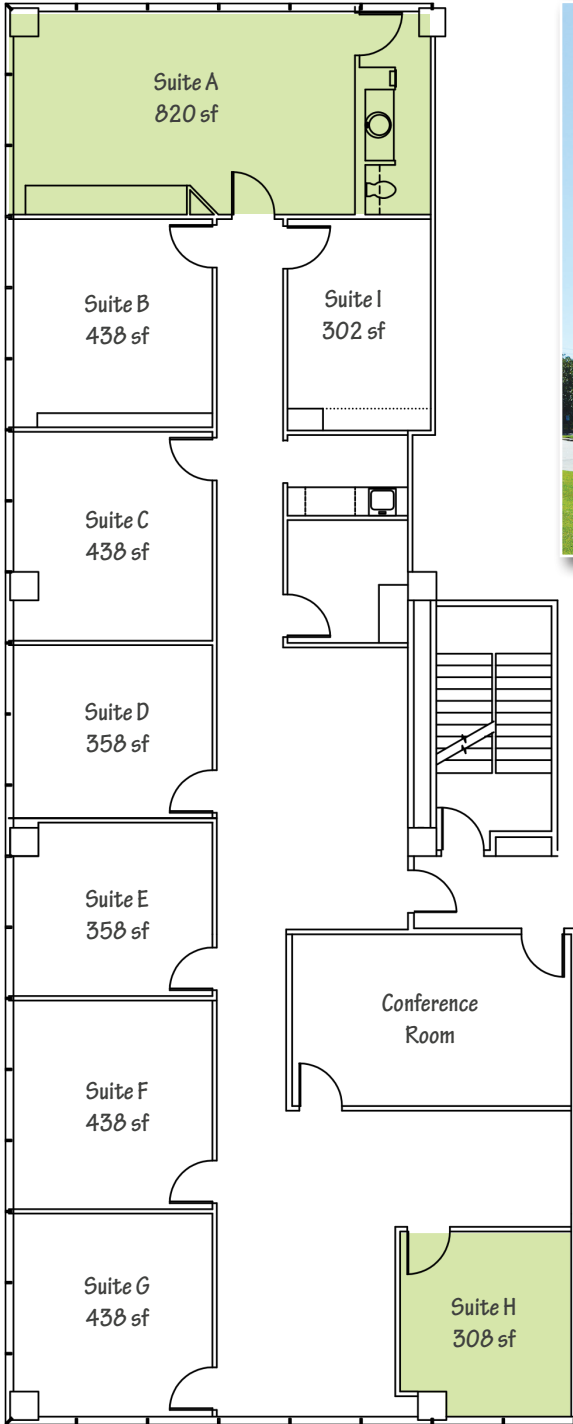

**SPACE AVAILABLE:**

- Private Offices Ranging From 302 sf to 820 sf.
- Monthly Rates Starting at \$500/mo
- Short Lease Term Options

Suite	SF		
200-A	820 SF		<a href="#">More Info</a>
200-H	308 SF		<a href="#">More Info</a>

**EXECUTIVE OFFICE BENEFITS:**

- High-Speed Internet
- Conference Facility
- Shared Break-Room
- Shared Reception Area

**PROPERTY FEATURES:**

- Four Level Office Building
- Garage, Covered, Surface Parking
- 24/7 Card-Key Access
- On-Site Management
- On-Site Leasing
- On-Site Maintenance
- Immediate Access to Westpark Toll, Beltway 8, IH-10



**Stone Mountain Business Center**  
 2550 Gray Falls Drive Suite 200 • Houston, TX 77077

**MATT EASTERLING**  
 713.325.4112  
[measterling@landparkco.com](mailto:measterling@landparkco.com)

**RYAN BURNAMAN**  
 281.598.9856  
[rburnaman@landparkco.com](mailto:rburnaman@landparkco.com)

**BILL MCGRATH, CCIM**  
 281.598.9860  
[bmcgrath@landparkco.com](mailto:bmcgrath@landparkco.com)