

FOR LEASE

1050 CHESTNUT STREET, MENLO PARK, CA

OFFICE SUITES FOR LEASE

SUITE 201 - ±1,096 SQ. FT

SUITE 202C - ±292 SQ. FT

SUITE 203 - ±1,649 SQ. FT

SUITE 206 - ±285 SQ. FT

DUCA & HANLEY BUILDING
1050



**PREMIER
PROPERTIES**
COMMERCIAL
REAL ESTATE

BRAD EHIKIAN
Partner
dre license #01736391
| 650.618.3001
| brad.ehikian@prprop.com

JON GOLDMAN
Partner
dre license #01295503
| 650.618.3003
| jon.goldman@prprop.com

JESSE EBNER
Vice President
dre license #02055989
| 650.618.3017
| jesse.ebner@prprop.com

PROPERTY HIGHLIGHTS

- ▀ Second Floor Suites with Abundant Natural Light
- ▀ Excellent Downtown Menlo Park Location
- ▀ Mostly Open Layouts
- ▀ Large Windows
- ▀ Surrounded by Downtown Amenities, Restaurants, & Public Parking Lots
- ▀ Walking Distance to the Menlo Park Caltrain Station
- ▀ Suite 201: Two Meeting Rooms / Private Offices
- ▀ Suite 203: One Meeting Room & One Storage Room
- ▀ Suites 202C & 206: Single-Room Offices
- ▀ Available Immediately



1050 CHESTNUT STREET, MENLO PARK, CA

FLOOR PLAN

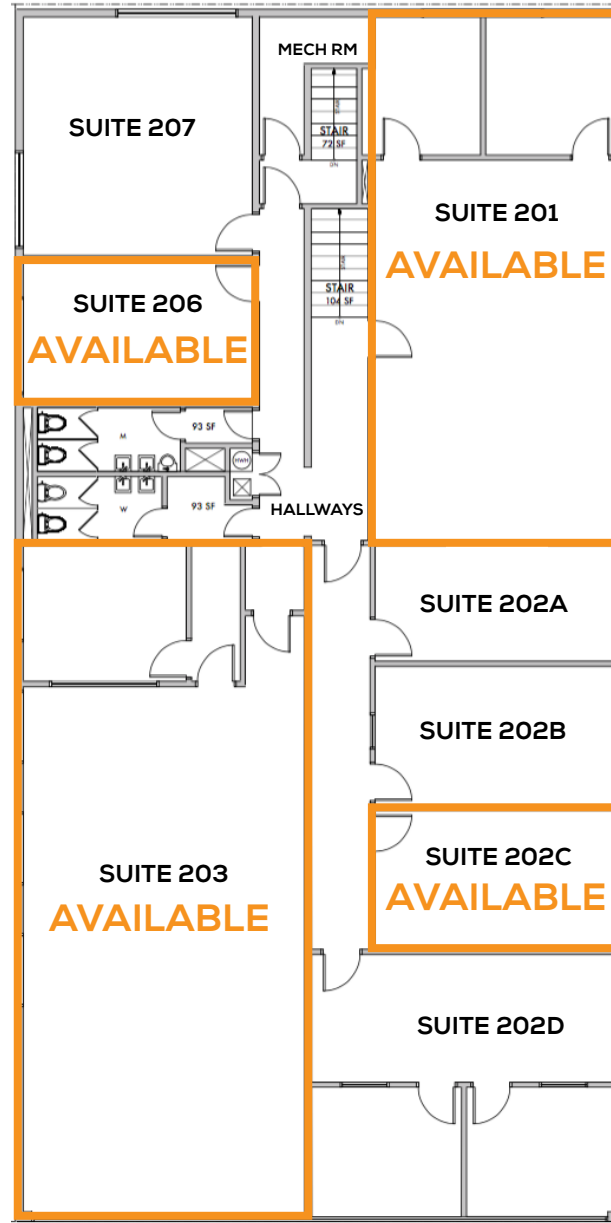

AMENITIES MAP

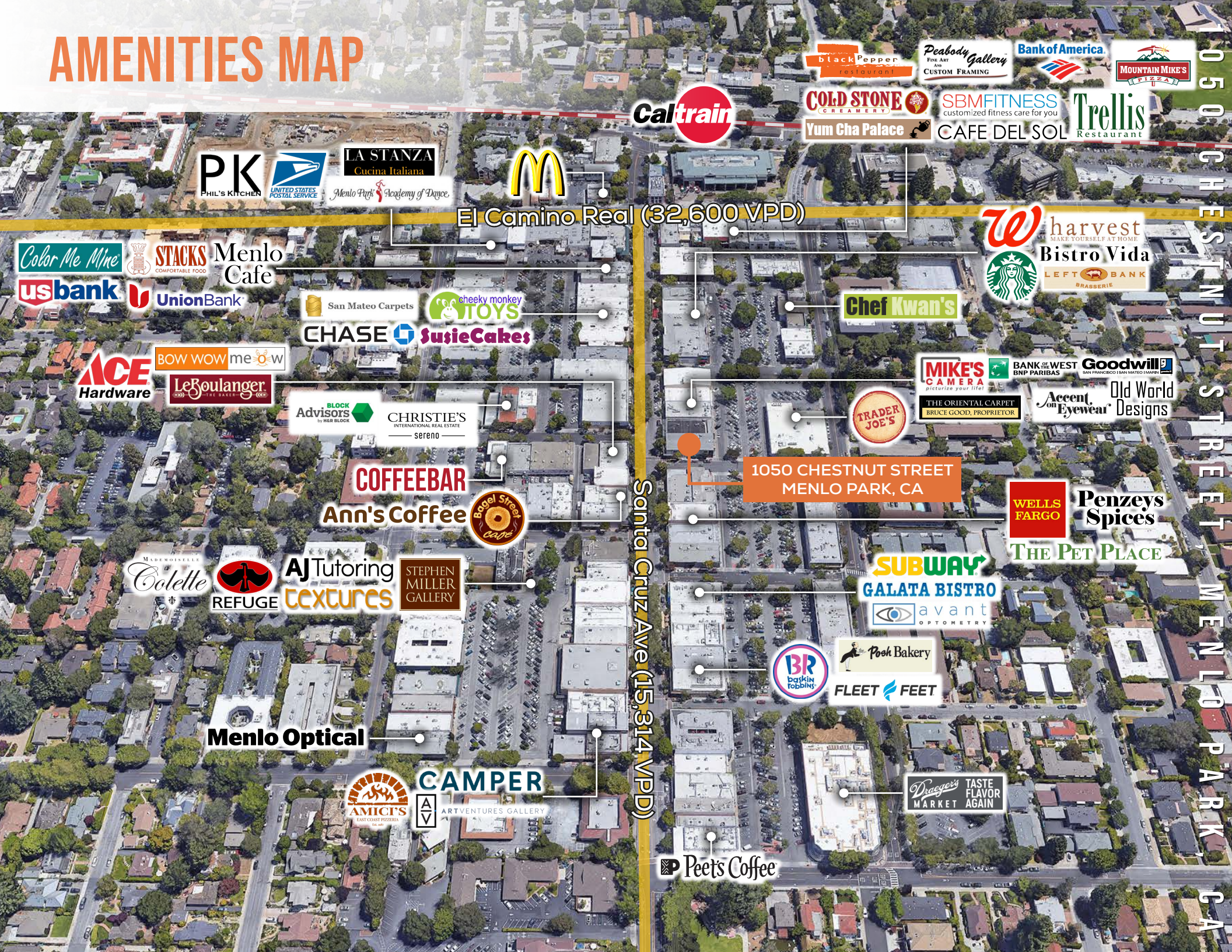

El Camino Real (32,600 VPD)

Santa Cruz Ave (15,314 VPD)

1050 CHESTNUT STREET
MENLO PARK, CA

- Black Pepper restaurant
- Peabody Gallery FINE ART CUSTOM FRAMING
- Bank of America
- MOUNTAIN MIKE'S PIZZA
- Caltrain
- COLD STONE CREAMERY
- SBM FITNESS customized fitness care for you
- Trellis Restaurant
- Yum Cha Palace
- CAFE DEL SOL
- PK PHIL'S KITCHEN
- UNITED STATES POSTAL SERVICE
- LA STANZA Cucina Italiana
- Menlo Park Academy of Dance
- McDonald's
- Color Me Mine
- STACKS COMFORTABLE FOOD
- Menlo Cafe
- usbank
- UnionBank
- San Mateo Carpets
- cheeky monkey TOYS
- CHASE
- SusieCakes
- ACE Hardware
- BOW WOW meow
- LeBoulangier THE BAKER
- BLOCK Advisors by HER BLOCK
- CHRISTIE'S INTERNATIONAL REAL ESTATE SERENO
- COFFEEBAR
- Ann's Coffee
- Bagel Street Cafe
- MIKE'S CAMERA picture your life! THE ORIENTAL CARPET BRUCE GOOD, PROPRIETOR
- BANK OF THE WEST BNP PARIBAS
- Goodwill
- Old World Accent on Eyewear Designs
- WELLS FARGO
- Penzeys Spices
- THE PET PLACE
- Colette
- REFUGE
- AJ Tutoring
- textures
- STEPHEN MILLER GALLERY
- SUBWAY
- GALATA BISTRO
- avant OPTOMETRY
- Menlo Optical
- AMICI'S EAST COAST PIZZERIA
- CAMPER ARTVENTURES GALLERY
- BR bobkin robbins
- Pook Bakery
- FLEET FEET
- Peets Coffee
- Draege's TASTE FLAVOR AGAIN MARKET AGAIN
- Starbucks
- harvest MAKE YOURSELF AT HOME
- Bistro Vida
- LEFT BANK BRASSERIE
- Chef Kwan's
- TRADER JOE'S
- Wells Fargo
- Penzeys Spices
- THE PET PLACE
- avant OPTOMETRY
- Pook Bakery
- FLEET FEET
- Draege's TASTE FLAVOR AGAIN MARKET AGAIN
- Peets Coffee

TRANSPORTATION MAP

1050 CHESTNUT STREET, MENLO PARK, CA



San Francisco
Int. Airport

Downtown
San Francisco

Downtown
Redwood City



Bayshore Fwy
(227,900 VPD)

PLANES

SJC - 18 miles San Francisco - 1 h 4 min
SFO - 18 miles Milbrae - 36 min
OAK - 28 miles San Jose - 45 min

TRAINS

AUTOMOBILES

San Francisco - 31 miles
Downtown San Jose - 21 miles
Downtown Oakland - 34 miles

El Camino Real (32,600 VPD)

Caltrain Rail-Line

Menlo Park
Train Station

Downtown
Menlo Park

Santa Cruz Ave (15,314 VPD)

1050 CHESTNUT STREET
MENLO PARK, CA

DEMOGRAPHICS



ONE-MILE POPULATION: 16,574

MEDIAN AGE

37.8

MEDIAN NET



\$308,111

HOUSEHOLD SIZE



2.4

INCOME



Per Capita Income

\$99,251



Median Net Worth

\$308,111

White Collar Employees:

94%

Blue Collar Employees:

2%

Services:

4%

Unemployment Rate:

2.8%

Total Employees:

21,178

MAJOR EMPLOYERS:

Data for all businesses in area	1 mile	3 miles	5 miles
Total Businesses:	1,544	8,735	14,908
Total Employees:	21,178	118,289	220,511
Total Residential Population:	16,574	169,520	278,835
Average Household Size	2.4	2.8	2.8



FOR LEASE

1050 CHESTNUT STREET, MENLO PARK, CA

OFFICE SUITES FOR LEASE

SUITE 201 - ±1,096 SQ. FT

SUITE 202C - ±292 SQ. FT

SUITE 203 - ±1,649 SQ. FT

SUITE 206 - ±285 SQ. FT



**PREMIER
PROPERTIES**
COMMERCIAL
REAL ESTATE

BRAD EHIKIAN
Partner
dre license #01736391
| 650.618.3001
| brad.ehikian@prprop.com

JON GOLDMAN
Partner
dre license #01295503
| 650.618.3003
| jon.goldman@prprop.com

JESSE EBNER
Vice President
dre license #02055989
| 650.618.3017
| jesse.ebner@prprop.com