

FOR LEASE

7458 Candlewood Road
Hanover, MD 21076

BALTIMORE COMMONS BUS PARK
BWI / ANNE ARUNDEL MARKET

FOR LEASE

SUITES C + D

±29,109 SF + ±21,000 SF



LEASED BY **CBRE**

FOR LEASE

7458 Candlewood Road
Hanover, MD 21076

FEATURES	±29,109 SF	±21,000 SF
Office SF	3,328 SF (+ MEZZ)	1,623 SF
Clear Height	28'	28'
Docks	4	7
Drive-ins	1	1
Column Spacing	40' x 50'	40' x 50'
Sprinkler	ESFR	ESFR

FOR LEASE

Ed Harris
Executive Vice President
ed.harris@cbre.com
410 244 3149

Jared Ross
First Vice President
jared.ross@cbre.com
240 994 6477

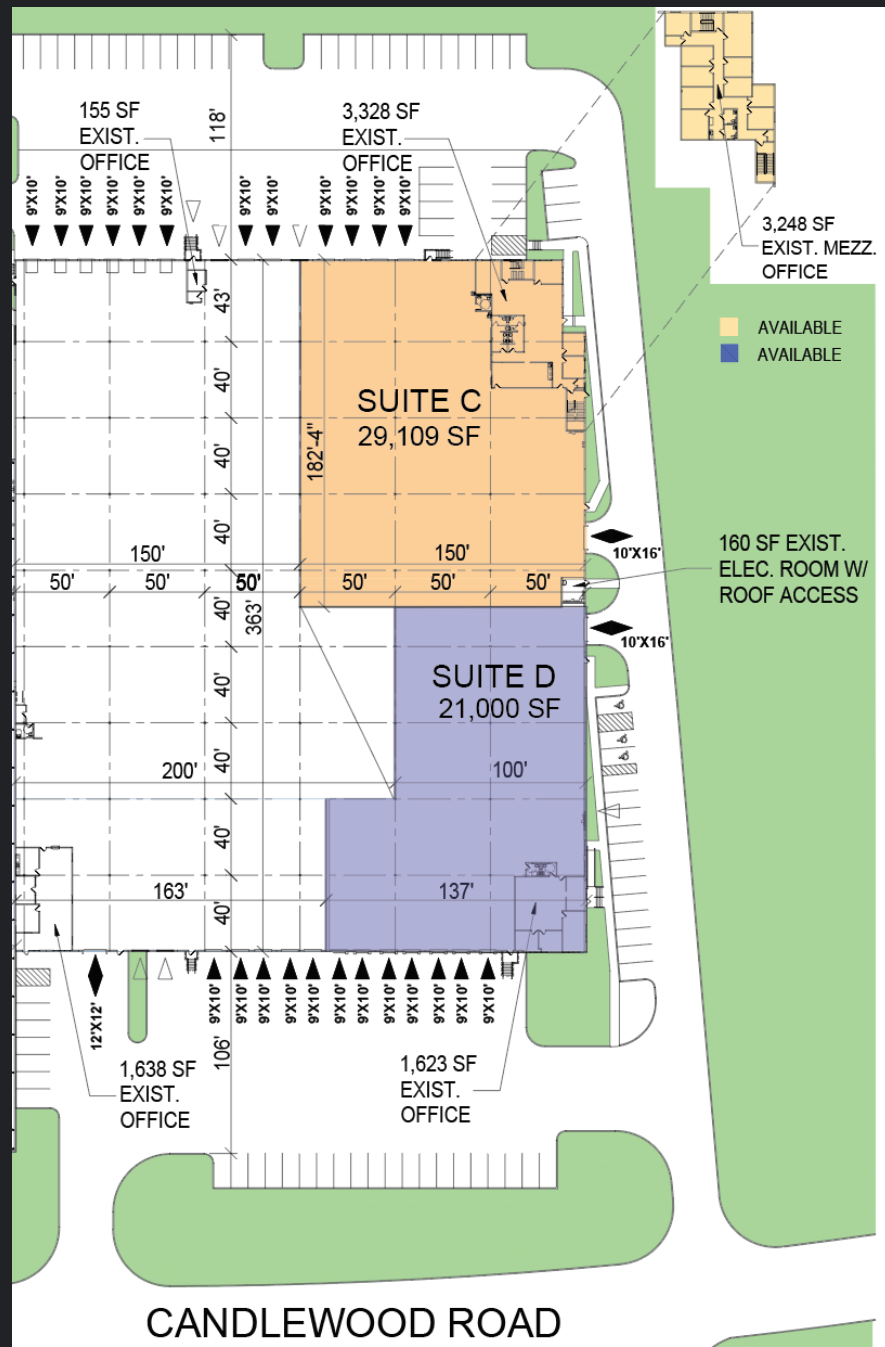

This is not an offer or acceptance of an offer to lease space. A lease will only be offered or made in a written agreement signed by landlord. No representation or warranty of any kind is made by landlord unless set forth in a written definitive lease executed by the landlord.

LEASED BY

CBRE